

North Carolina, Iredell County
The Town Council of the Town
Of Troutman, North Carolina
Meeting in Regular Session on
the 14th day of April, 2022
Approved the Extension of the
Corporate Limits of the Town
Of Troutman, North Carolina as
shown on this Plat and as
Recorded in Minute Book

Kimbal & Laws
TOWN CLERK
TOWN OF Troutman

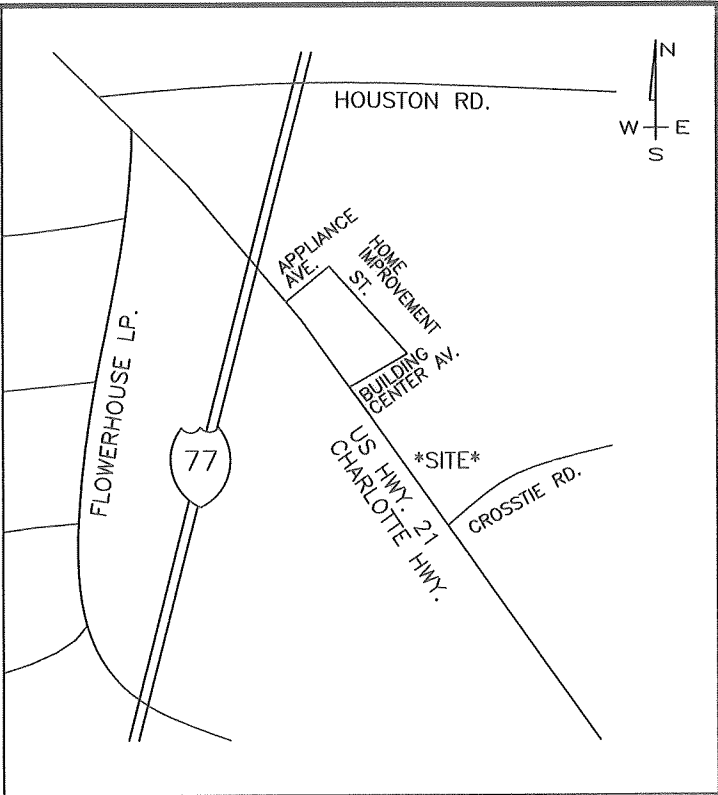

Doc ID: 018047500001 Type: CRP
Recorded: 04/20/2022 at 11:52:00 AM
Fee Amt: \$21.00 Page 1 of 1
Iredell County, NC
Maureen P. Purcell Register of Deeds
BK 76 PG 117

THE PROVISIONS OF G.S. 47-30 SHALL NOT APPLY TO BOUNDARY PLAT OF AREAS ANNEXED BY MUNICIPALITIES NOR TO PLATS OF MUNICIPAL BOUNDARIES, WHETHER OR NOT REQUIRED BY LAW TO BE RECORDED IN NORTH CAROLINA. MADE THE 29th DAY OF MARCH 2022.

W. Matthew Jordan
PROFESSIONAL LAND SURVEYOR

I, W. MATTHEW JORDAN, HEREBY CERTIFY THAT THE SURVEY IS OF ANOTHER CATEGORY, SUCH AS THE RECOMBINATION OF EXISTING PARCELS, A COURT ORDERED SURVEY, OR OTHER EXCEPTIONS TO THE DEFINITION OF SUBDIVISION

STATE OF NORTH CAROLINA
IREDELL COUNTY
I, W. MATTHEW JORDAN, CERTIFY THAT THIS PLAT WAS DRAWN UNDER MY SUPERVISION FROM AN ACTUAL SURVEY MADE UNDER MY SUPERVISION; THAT THE RATIO OF PRECISION IS 1: 10,000; THAT THE BOUNDARIES NOT SURVEYED ARE SHOWN AS BROKEN LINES PLOTTED FROM INFORMATION FOUND IN BOOK 2479, PAGE 2483 THAT THIS PLAT WAS PREPARED IN ACCORDANCE WITH GS. 47-30 AS AMENDED. WITNESS MY SIGNATURE, REGISTRATION NUMBER, AND SEAL THIS 19th DAY OF APRIL, 2022.

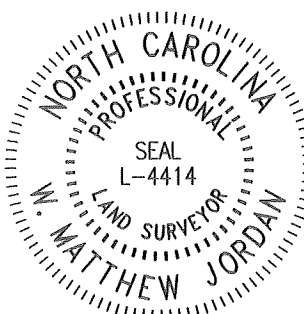

W. Matthew Jordan
SURVEYOR REG. NO. L-4414



- NOTES:
1. AS OF THE DATE OF THIS RECORDING, THE LOTS REPRESENTED ON THIS PLAT HAVE NOT BEEN INSPECTED OR APPROVED BY THE IREDELL COUNTY HEALTH DEPARTMENT. UNTIL INSPECTED, THERE IS NO ASSURANCE THAT A BUILDING PERMIT WILL BE ISSUED.
 2. THE SURVEYED PROPERTY DOES NOT LIE WITHIN A FLOOD HAZARD AREA AS DETERMINED BY FLOOD MAP 3710474000J, EFFECTIVE DATE 3/18/2008.
 3. THE LOTS IN THIS SUBDIVISION WILL BE SERVED BY INDIVIDUAL SEPTIC SYSTEMS AND WATER BY INDIVIDUAL WELLS.
 4. THE SURVEYED PROPERTY IS CURRENTLY ZONED RA (IC) (IREDELL COUNTY)
 5. THE SURVEYED PROPERTY DOES NOT LIE WITHIN THE U.S. DEPARTMENTS OF INTERIOR'S NATIONAL REGISTER OF HISTORIC PLACES.
 6. PROPERTY SUBJECT TO ANY FACTS THAT MAY BE DISCLOSED BY A FULL AND ACCURATE TITLE SEARCH.
 7. PROPERTY SUBJECT TO EASEMENTS AND RIGHTS OF WAY OF RECORD AND THOSE NOT OF RECORD, IF ANY EXIST.
 8. AREA BY COORDINATE COMPUTATION.
 9. PROPERTY MAY BE SUBJECT TO GOVERNMENTAL ORDINANCES, ZONING AND OTHER REGULATIONS CONCERNING THE DIVISION AND DEVELOPMENT OF REAL ESTATE.
 10. NO SUBTERRANEAN SURVEY PERFORMED AT THIS SITE.

PURPOSE STATEMENT:
THE PURPOSE OF THIS PLAT IS TO ANNEX THIS PARCEL INTO THE TOWN OF TROUTMAN TOWN LIMITS.

JORDAN GRANT
ENGINEERING • SURVEYING • PLANNING
JORDAN GRANT & ASSOCIATES, PLLC
P.O. BOX 151 * STATESVILLE, NC 28687
matt.grant@jordan-grant.com (704) 928-7919
FIRM # P-1227

Annexation Plat For:
Andrew & Christy Phillips

DRAWN BY: SMS	CHECKED BY: WMJ
SCALE: 1"=40'	
DEED REF: 2479-2483	PIN NO: 4750022170
DATE OF MAP: 03-29-22	SURVEY DATE: 03-08-22
REVISION:	DRAWING FILE: 20220215-ANNEX

CHARLOTTE HIGHWAY - TROUTMAN, N.C. 28166
BARRINGER TOWNSHIP --- IREDELL COUNTY --- NORTH CAROLINA