

3225 FORTUNE DRIVE

NORTH CHARLESTON, SC 29418



8,000 SF INDUSTRIAL WAREHOUSE FOR LEASE

CBRE

3225 FORTUNE DRIVE

NORTH CHARLESTON, SC 29418

Property Description

Approximately 38,000 SF precast concrete distribution warehouse facility situated on 3.04 acres of light industrial zoned land in Pepperdam Industrial Park. Facility is currently subdivided into 5 suites, with 8,000 SF available for lease. Facility provides 3-phase power, 8 dock high doors, and 2 drive-in doors. Site is partially fenced, and provides ample paved parking.

Building Specifications

AVAILABLE SF	8,000 SF
AVAILABILITY	Immediate
BUILDING SF	38,000 SF
TAX MAP	397-00-00-036
ZONING	Light Industrial
MUNICIPALITY	City of North Charleston
COUNTY	Charleston County

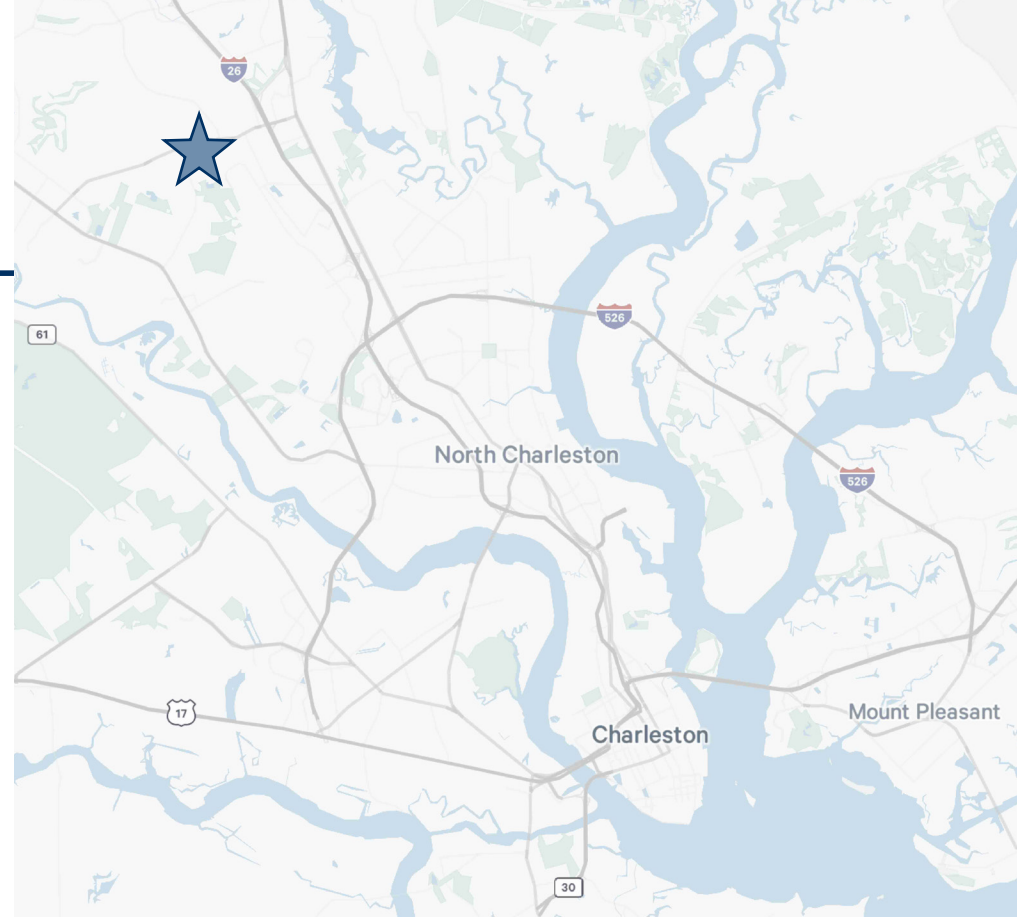

3225 FORTUNE DRIVE

NORTH CHARLESTON, SC 29418

Floor Plan

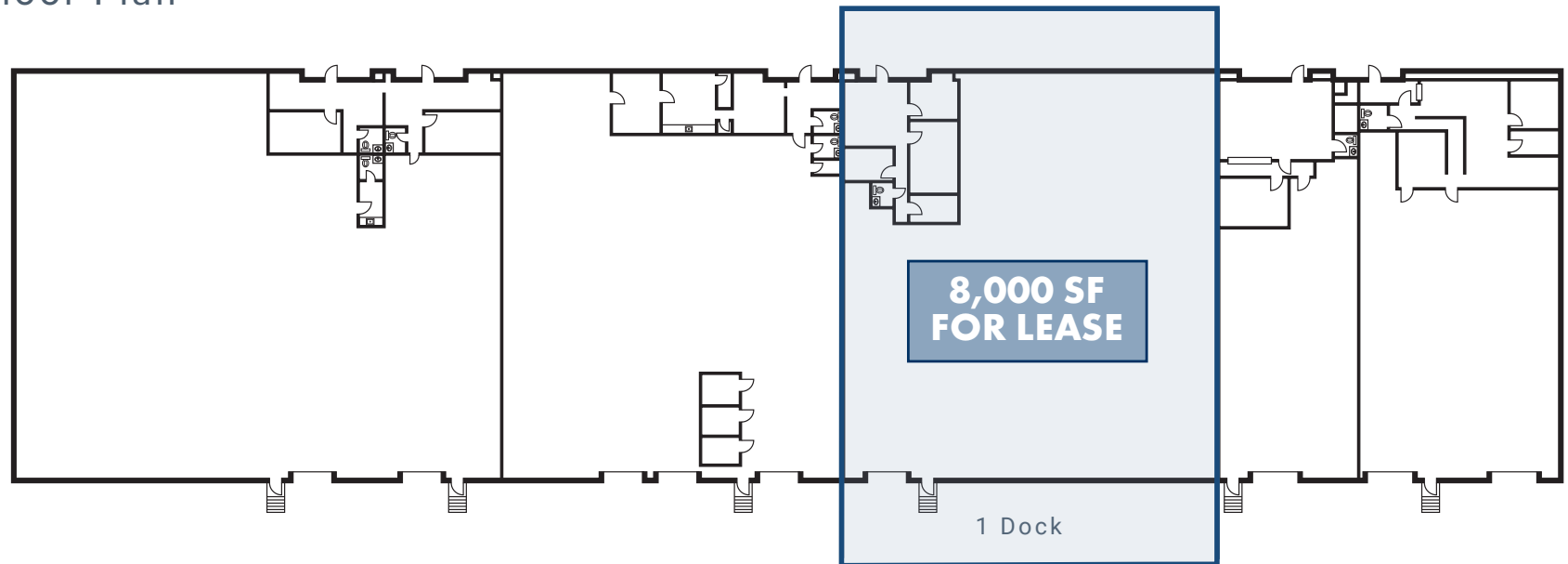

Property Amenities

AIR CONDITIONING	Office Only	FLOORS	6" Concrete
CLEARANCE	16'	LIGHTING	Flourescent
CONSTRUCTION STATUS	Existing	POWER	3-Phase
DOCK HIGH DOORS	1	SPRINKLER	None
DOCK HIGH DOOR SIZE	10' X 12'	WALLS	Pre Cast

3225 FORTUNE DRIVE

NORTH CHARLESTON, SC 29418

PLEASE CONTACT:

Robert Barrineau

Senior Vice President

+1 843 270 7851

robert.barrineau@cbre.com

Brendan Redeyoff, SIOR

Senior Vice President

+1 843 793 8839

brendan.redeyoff@cbre.com



© 2026 CBRE, Inc. All rights reserved. This information has been obtained from sources believed reliable but has not been verified for accuracy or completeness. CBRE, Inc. makes no guarantee, representation or warranty and accepts no responsibility or liability as to the accuracy, completeness, or reliability of the information contained herein. You should conduct a careful, independent investigation of the property and verify all information. Any reliance on this information is solely at your own risk. Some content was originally generated by GenAI and modified by the author.

CBRE