

FOR SALE



**6,625 SF LUXURY HANGAR
BRIDGEPORT AIRPORT KXBP**

527 LV SELZ RD, HANGAR 4, BRIDGEPORT, TX 76426

- New construction 2023!
- 6,400 SF total hangar footprint (80' wide x 80' deep)
- 1st floor full bath, walk in storage, & stainless steel utility sink
- 2nd floor 226 SF office/pilot's lounge
- 70' x 17' Schweiss bi-fold hangar door
- Fully encapsulated with 1.5 inch closed cell foam insulation
- Interior finish-out is separately insulated with 4 inches of open cell foam
- Extreme high-efficiency Mitsubishi mini-split HVAC systems in offices/pilot's lounge with independent remotes for each room
- Commercial grade wiring with 100% LED lighting; City water and sewer
- **Excellent private hangar or great location for an aviation business**
- Airport ground lease with the City of Bridgeport through October 24, 2052
- Direct access to the paved, lighted runway 18/36, dimensions 5,005' x 75'
- RNAV (GPS); VOR/DME approach runway 18
- Bridgeport Airport is located about 42 miles northwest of Fort Worth Texas

AIRSPACE 

www.AirSpaceTexas.com

Ryan Cox, Broker

+1-682-225-3262

Ryan@AirSpaceTexas.com







HANGAR FLOOR PLAN

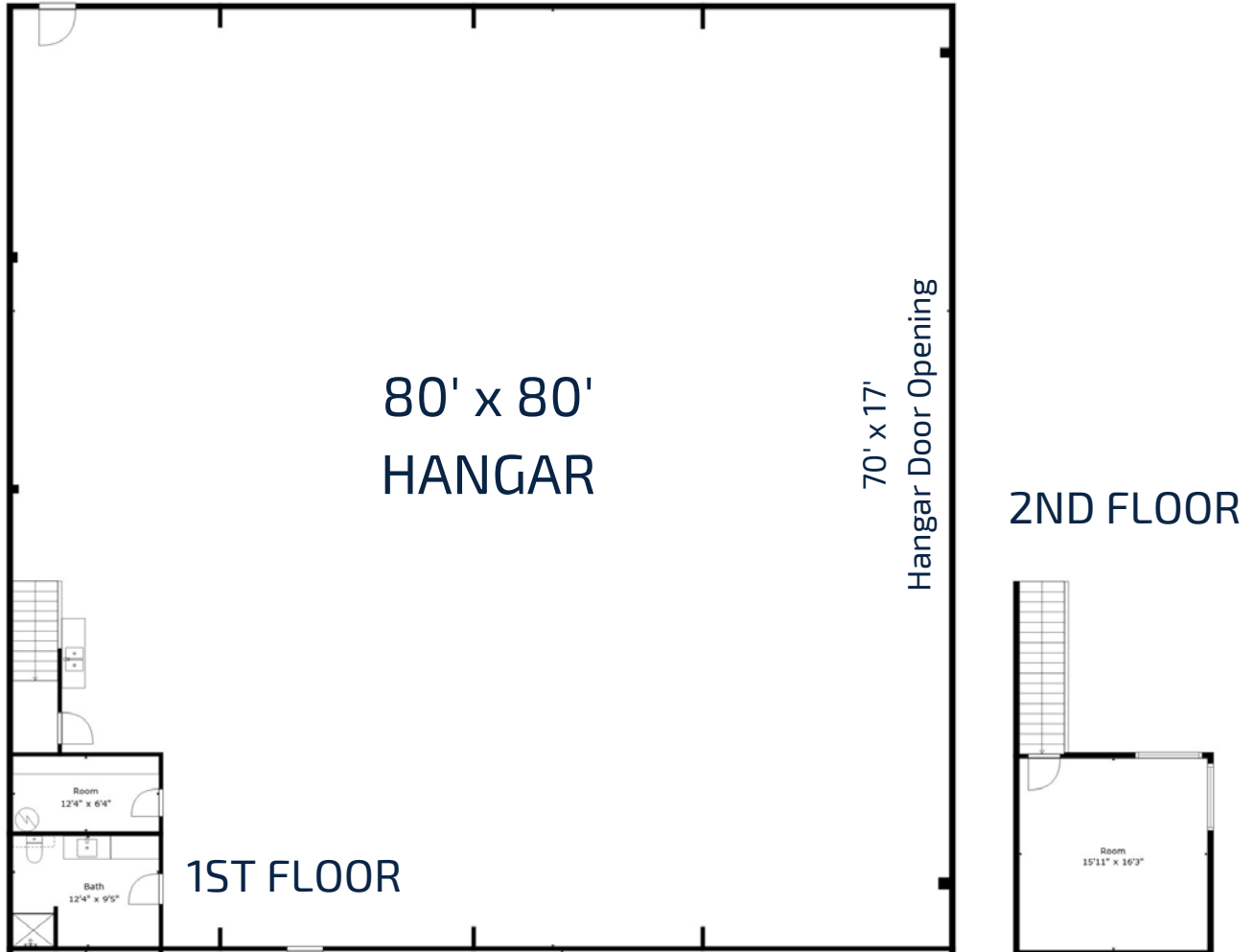

**6,625 SF LUXURY
AIRCRAFT HANGAR**

**BRIDGEPORT
MUNICIPAL
AIRPORT
KXBP**



FOR SALE

AIRSPACE 

Ryan Cox, Broker
529 Aviator Drive
Fort Worth, TX 76179
682-225-3262 mobile
Ryan@AirSpaceTexas.com
[AirSpaceTexas.com](https://www.AirSpaceTexas.com)



Copyright © 2024 AIRSPACE

DISCLAIMER: The information in this brochure has been obtained from sources believed reliable, however, we make no representations or warranties, expressed or implied, as to the completeness or accuracy of the information. This information is submitted subject to the possibility of errors, omissions, change of price, rental or other conditions, prior sale, lease or financing, or withdrawal without notice. The projections, opinions, assumptions, square footage and estimates are included as examples only; they may not represent current or future status or performance of the property.