

2600 S HARDY DR - AIR-CONDITIONED INDUSTRIAL BUILDING

Tempe, AZ 85282

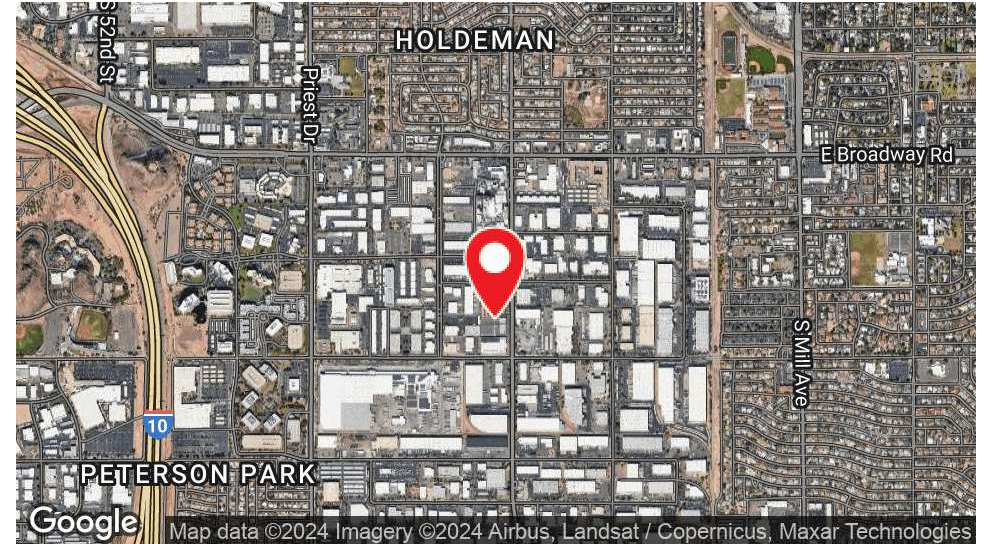

Property Summary



PROPERTY DESCRIPTION 16,528 ± SQUARE FOOT

- Fully Air Conditioned
- Reception, Eight (8) Offices, Conference Room, Break Room, IT Room, Copy/File Room and Storage (Proposed Floor Plan)
- Fire Sprinklered
- Fenced Parking/Loading Area
- 1200 Amps (120/208v) 3-Phase
- Grade Level Loading - One Overhead Door
- Zoned I-1
- Parking - 40 +/- Spaces
- Clear Height 12' ft



ROD CROTTY

Associate Broker | 602.386.1225 (D)
rcrotty@cutlercommercial.com

CUTLER COMMERCIAL

2150 East Highland Avenue, Suite 207, Phoenix, AZ 85016
602.955.3500 | cutlercommercial.com

2600 S HARDY DR

Tempe, AZ 85282



Site And Floor Plan

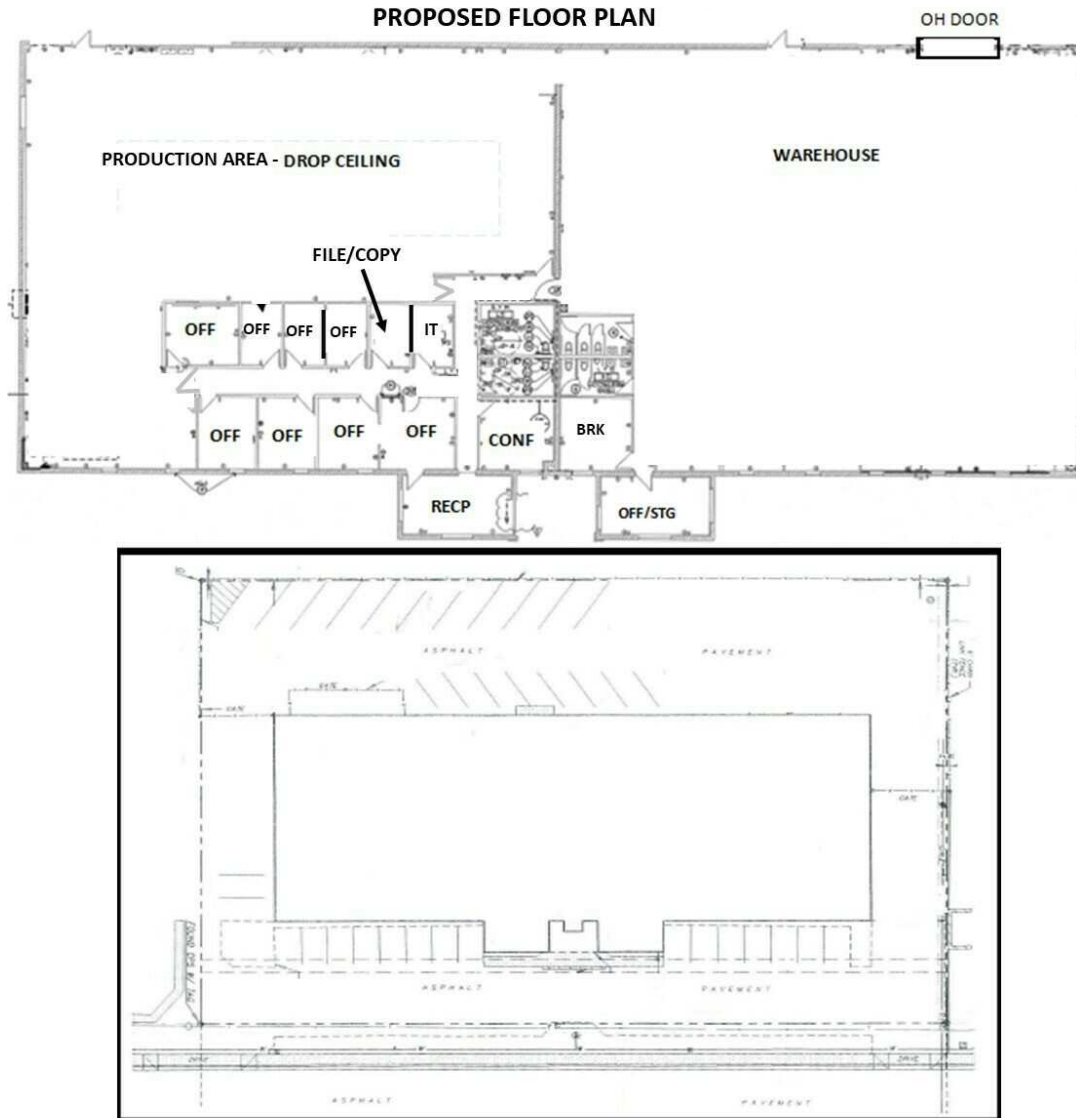

ROD CROTTY

Associate Broker | 602.386.1225 (D)
rcroty@cutlercommercial.com

CUTLER COMMERCIAL

2150 East Highland Avenue, Suite 207, Phoenix, AZ 85016
602.955.3500 | cutlercommercial.com