

CARLSBAD OAKS COMMERCE CENTER

5931-5933 Sea Lion Place,
Carlsbad, CA 92010

CIP REAL ESTATE



FOR LEASE

INDUSTRIAL BUSINESS PARK

±1,746 - ±1,919 SF AVAILABLE

 CUSHMAN &
WAKEFIELD

PROPERTY HIGHLIGHTS



Clear Height: 18'



Flex/Industrial Suites



Gas Potentially Available



Exterior Improvements Underway



Grade-Level Loading



Central North County Location



Sprinkered Suites



Close proximity to Palomar-McClellan Airport, Shopping, Restaurants, and Housing



Landscaping Improvements Underway

AVAILABILITIES

INDUSTRIAL				
UNIT	SIZE	DESCRIPTION	LEASE RATE	AVAILABILITY
5931 Sea Lion Place // Suite 102	1,746 SF	Warehouse, Restroom, Private Offices, Reception Area, Break Room, and Roll-Up Door	\$1.65/SF + *Est NNN	Now
5931 Sea Lion Place // Suite 109	1,919 SF	Warehouse, Restroom, Private Offices, Open Office, Reception Area, and Roll-Up Door	\$1.65/SF + *Est NNN	Now

*Est. NNN: \$0.65/SF



FLOOR PLAN

5931 SEA LION PLACE

102

SUITE AVAILABLE

1,746

TOTAL SQUARE FEET

\$1.65/ SF NNN

LEASE RATE + *Est NNN: \$0.65/SF

NOW

DATE AVAILABLE

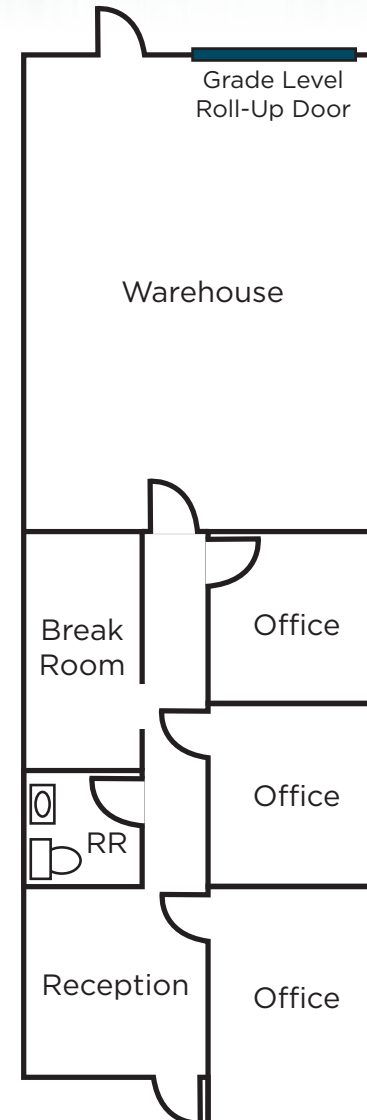

FLOOR PLAN

5931 SEA LION PLACE

109

SUITE AVAILABLE

1,919

TOTAL SQUARE FEET

\$1.65/ SF NNN

LEASE RATE + *Est NNN: \$0.65/SF

NOW

DATE AVAILABLE

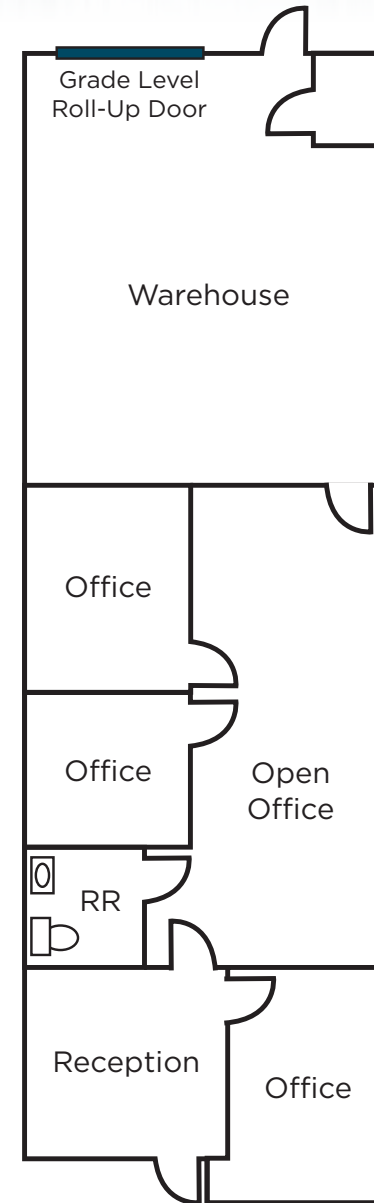
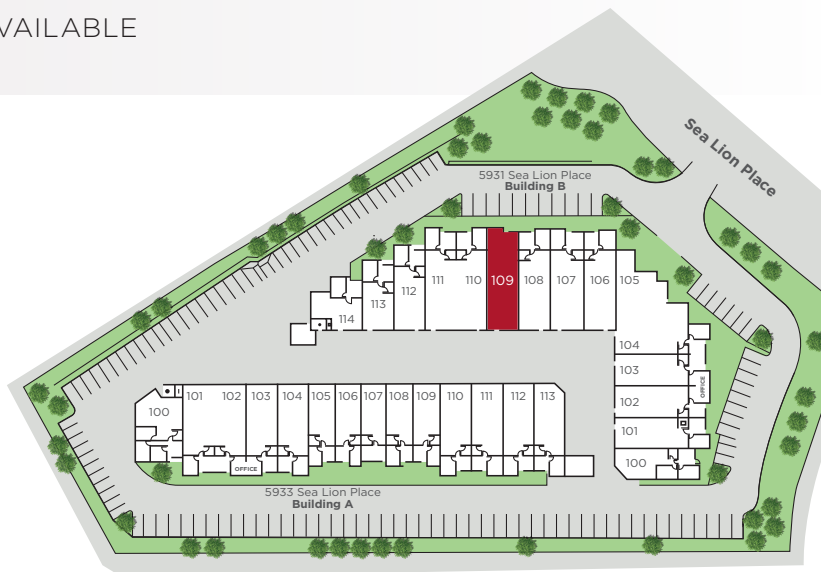

PHOTOS

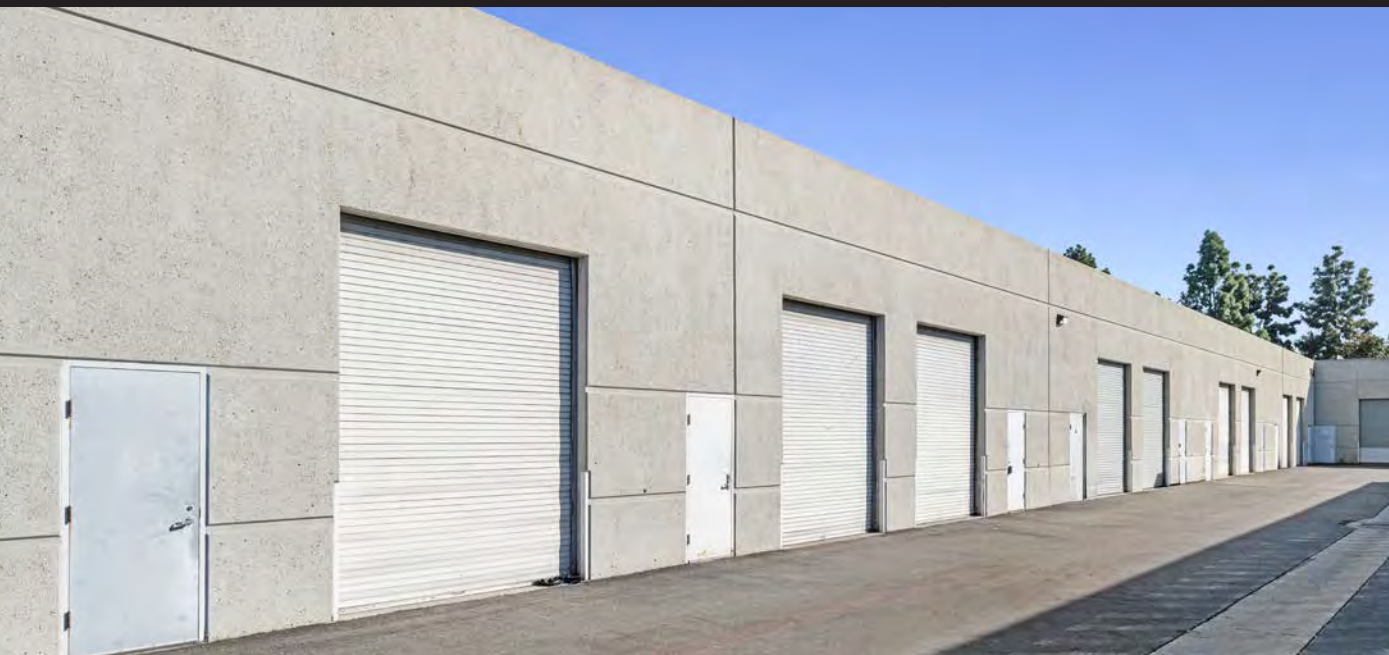

LOCATION



CARLSBAD OAKS COMMERCE CENTER

FOR LEASE

CIP REAL ESTATE

CONTACT BROKERS:

CONOR BOYLE

760.458.5739
conor.boyle@cushwake.com
Lic. No.01813305

TYLER STEMLEY

760.908.4270
tyler.stemley@cushwake.com
Lic. No.02003867

CARSON ODABASHIAN

760.431.3836
carson.odabashian@cushwake.com
Lic. No.02207230

©2025 Cushman & Wakefield. All rights reserved. The information contained in this communication is strictly confidential. This information has been obtained from sources believed to be reliable but has not been verified. NO WARRANTY OR REPRESENTATION, EXPRESS OR IMPLIED, IS MADE AS TO THE CONDITION OF THE PROPERTY (OR PROPERTIES) REFERENCED HEREIN OR AS TO THE ACCURACY OR COMPLETENESS OF THE INFORMATION CONTAINED HEREIN, AND SAME IS SUBMITTED SUBJECT TO ERRORS, OMISSIONS, CHANGE OF PRICE, RENTAL OR OTHER CONDITIONS, WITHDRAWAL WITHOUT NOTICE, AND TO ANY SPECIAL LISTING CONDITIONS IMPOSED BY THE PROPERTY OWNER(S). ANY PROJECTIONS, OPINIONS OR ESTIMATES ARE SUBJECT TO UNCERTAINTY AND DO NOT SIGNIFY CURRENT OR FUTURE PROPERTY PERFORMANCE.



**CUSHMAN &
WAKEFIELD**