

# JONATHAN — PARK —

3311 MEADE AVENUE &  
3542 SIRIUS AVENUE  
LAS VEGAS, NV 89102

**FOR LEASE**

**15,400 - 18,000 SF AVAILABLE**



**LAUREN WILLMORE**, Member Associate,  
Society of Industrial and Office Realtors®  
Senior Associate  
Lic. # S.0188698  
+1 702 369 4825  
lauren.willmore@cbre.com

**KYLE KIRCHMEIER**  
Senior Associate  
Lic. # S.0197013  
+1 702 369 4862  
kyle.kirchmeier@cbre.com

**ALEX STANISIC, SIOR**  
First Vice President  
Lic. # S.0179950  
+1 702 369 4874  
alex.stanisic@cbre.com

**CBRE**





Jonathan Park is located less than 5 minutes from the I-15 Freeway and I-215 Freeway Interchange and the Las Vegas Strip. The park is conveniently located near multiple retail and service amenities.

### Property Highlights

- $\pm 124,458$  SF project on  $\pm 6.62$  acres
- $\pm 15,400$  -  $\pm 18,000$  SF Units Available
- $\pm 16,661$  SF Yard available
- 30' x 60' column spacing (average)
- Grade level loading doors
- Dock level loading doors
- Skylights
- 120/208 volt, 3-phase power
- $\pm 18'$  -  $\pm 32'$  minimum clearance
- Fully fire sprinklered
- Paved, secured yard space
- Evaporative cooled warehouse
- Concrete tilt-up construction
- Zoned M (City of Las Vegas Manufacturing District)
- APN: 162-08-303-004, 027

# Site Plan

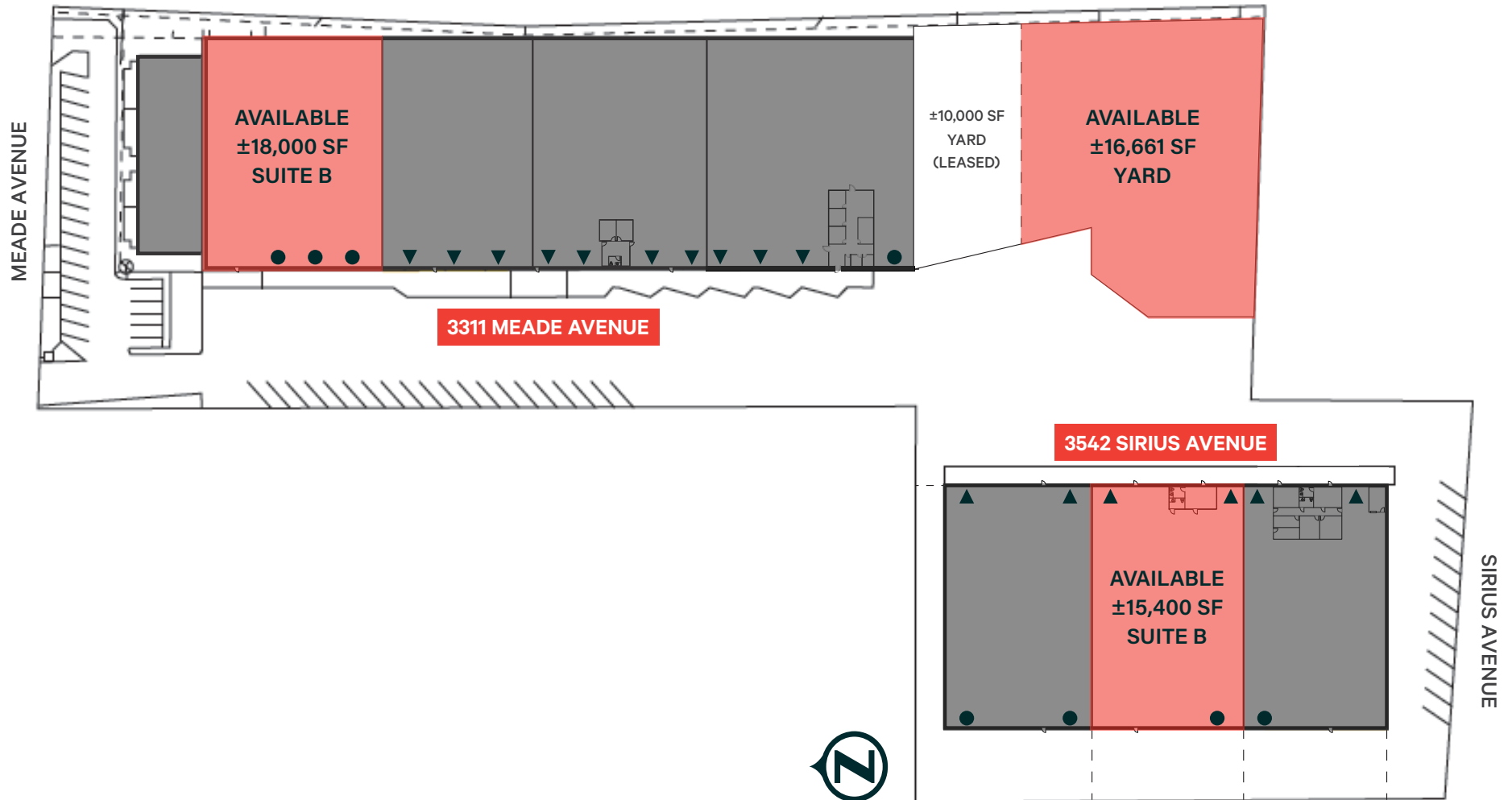

- = AVAILABLE
- = LEASED
- = DOCK-HI DOOR
- = GRADE LEVEL DOOR

\*not to scale  
\*all measurements are approximate

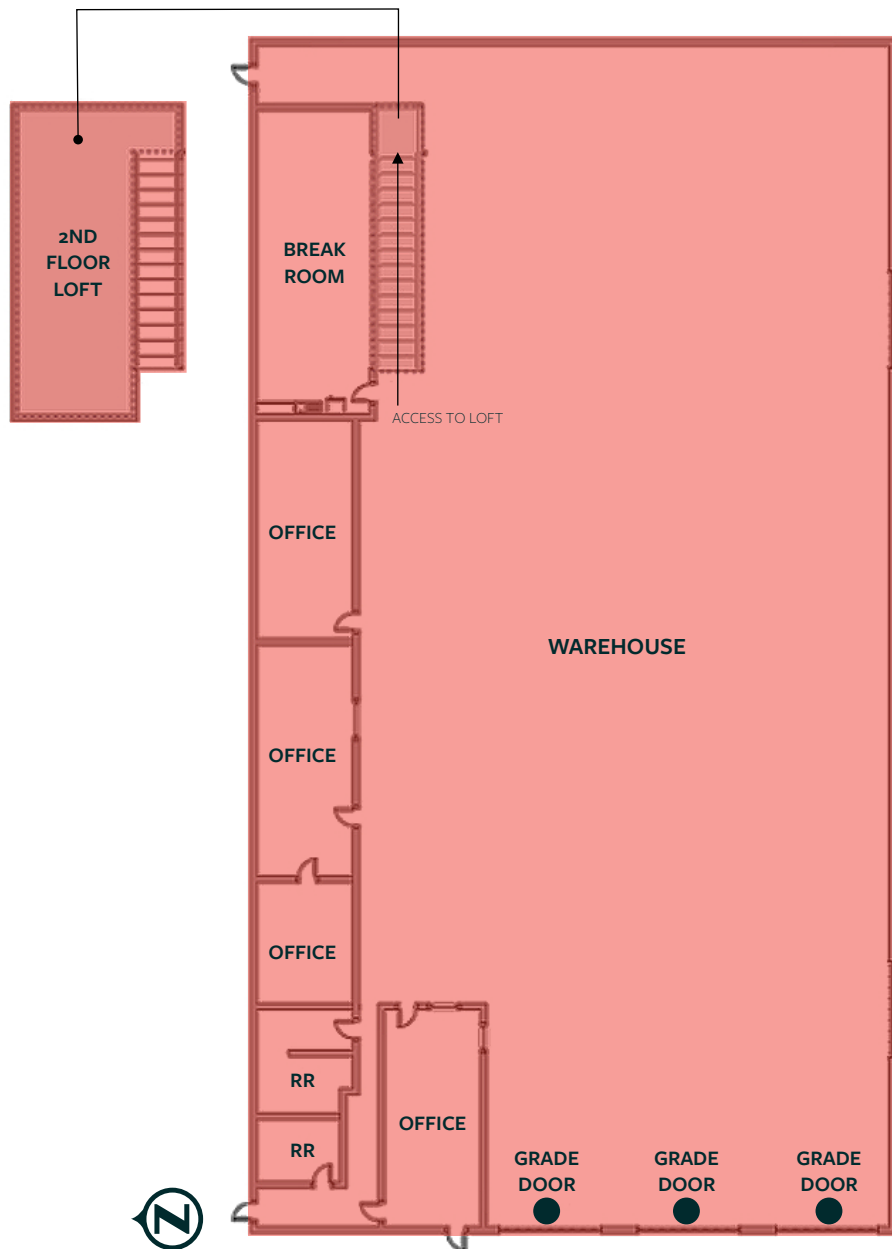

\*not to scale  
\*all measurements are approximate

● = GRADE LEVEL DOOR

## 3311 Meade Suite B

- ±18,000 SF Total
- ±1,263 SF of office area
- ±16,737 SF of evap cooled warehouse
- Three (3) 12' x 14' Grade-Level doors
- Four (4) private offices
- Break Room
- 2nd floor Loft
- Two (2) Restrooms
- 28' clear height
- Fire sprinkered

**BASE RENT: \$1.15/SF (NNN)**

**NNN: \$0.2024/SF**

**TOTAL MONTHLY: \$24,343.20**

**AVAILABLE: (30) Day's Notice**

\*not to scale  
\*all measurements are approximate

● = GRADE LEVEL DOOR ▲ = DOCK-HI DOOR

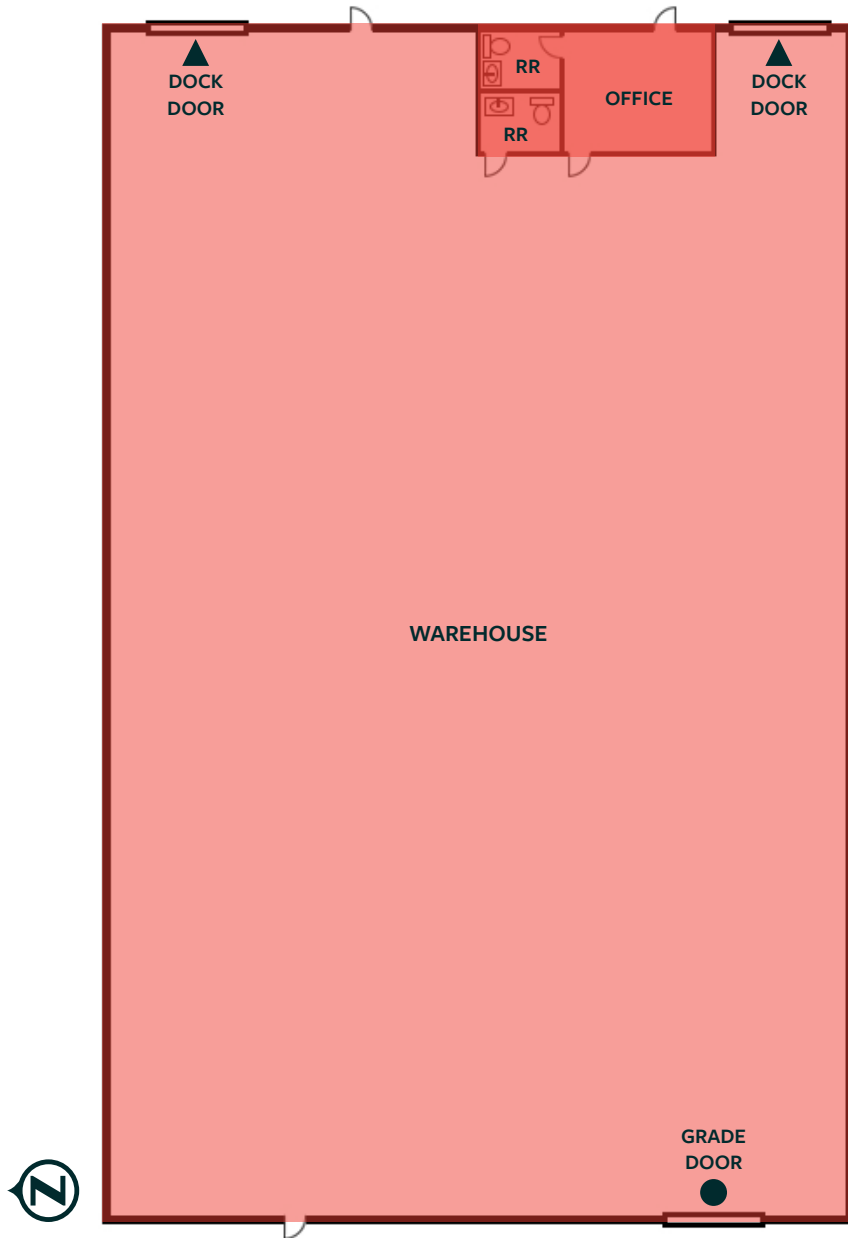

## 3542 Sirius Suite B

- ±15,400 SF Total
- ±500 SF of HVAC Office
- ±14,900 SF of Evaporative Cooled Warehouse
- Two (2) Restrooms
- Two (2) 12' x 14' dock-hi truck doors
- One (1) 12' x 14' grade-level loading door
- ±18' Minimum Clear Height
- 120/208 volt, 3-phase power
- Fire sprinklers
- Skylights

**BASE RENT:** \$1.05/SF (NNN)

**NNN:** \$0.2024/SF

**TOTAL MONTHLY:** \$19,286.96

**AVAILABLE:** (30) Day's Notice

\*not to scale  
\*all measurements are approximate

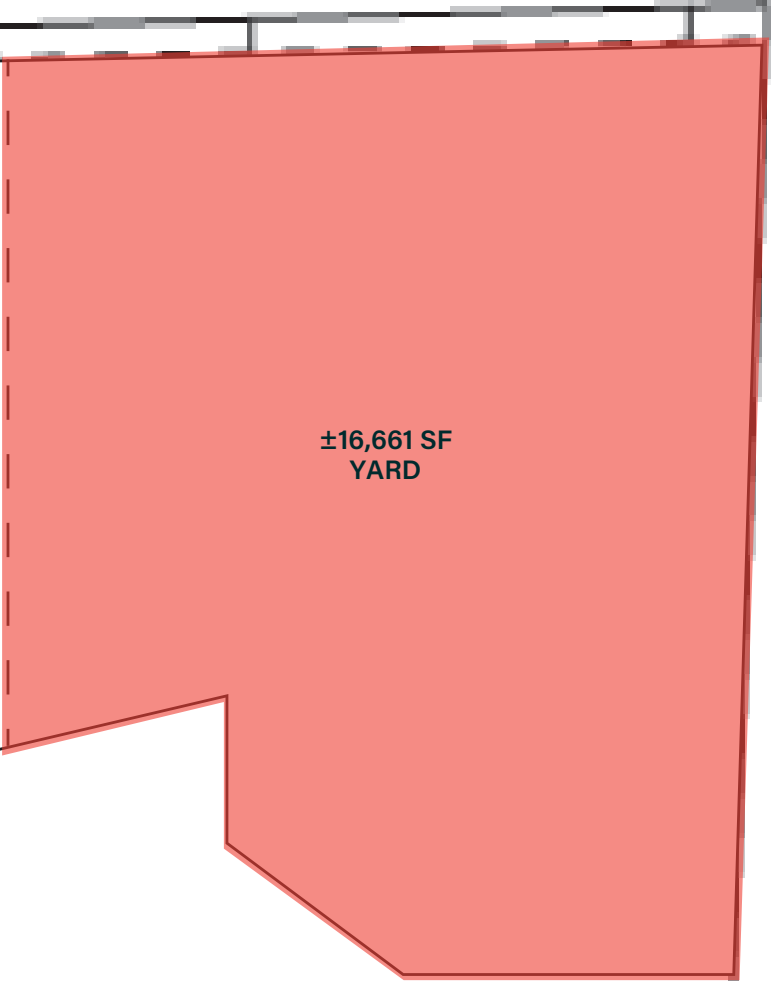

±16,661 SF  
YARD



## 3311 Meade - YARD

- ±16,661 SF Total
- Paved
- Fenced

**BASE RENT:** \$0.30/SF (GROSS)

**AVAILABLE:** Now Available!

**TOTAL MONTHLY:** \$4,998.30







# JONATHAN — PARK —

3311 MEADE AVENUE &  
3542 SIRIUS AVENUE  
LAS VEGAS, NV 89102

FOR LEASE

## CBRE LAS VEGAS

8548 Rozita Lee Avenue  
Suite 200  
Las Vegas, NV 89113  
[www.cbre.com/lasvegas](http://www.cbre.com/lasvegas)

## CONTACT US FOR MORE INFORMATION

**LAUREN WILLMORE**, Member Associate,  
Society of Industrial and Office Realtors®  
Senior Associate  
Lic. S0188698  
+1 702 369 4825  
[lauren.willmore@cbre.com](mailto:lauren.willmore@cbre.com)

**KYLE KIRCHMEIER**  
Associate  
Lic. S.0197013  
+1 702 369 4862  
[kyle.kirchmeier@cbre.com](mailto:kyle.kirchmeier@cbre.com)

**ALEX STANISIC, SIOR**  
First Vice President  
Lic. # S.0179950  
+1 702 369 4874  
[alex.stanisic@cbre.com](mailto:alex.stanisic@cbre.com)

© 2025 CBRE, Inc. All rights reserved. This information has been obtained from sources believed reliable but has not been verified for accuracy or completeness. You should conduct a careful, independent investigation of the property and verify all information. Any reliance on this information is solely at your own risk. CBRE and the CBRE logo are service marks of CBRE, Inc. All other marks displayed on this document are the property of their respective owners, and the use of such logos does not imply any affiliation with or endorsement of CBRE. Photos herein are the property of their respective owners. Use of these images without the express written consent of the owner is prohibited.

# CBRE