

# 100 Corporate Center Drive

Camp Hill, Pennsylvania

**One Suite Remaining: 5,005 SF**

41,800 SF Class A Office Building

Camp Hill Business District's Top Office Park

New Building Improvements





## FEATURES

- + Highly sought-after Class A Corporate Office Park
- + 5,005 SF of customizable office space available on the 2<sup>nd</sup> Floor
- + Recently renovated common areas, including refurbished modern restrooms & top-of-market building space finishing standards
- + Well-capitalized Landlord provides full construction services & tenant improvement allowances for a seamless move-in experience
- + 24/7 secure building access, abundant parking, and prominent monument & tenant signage
- + Located within walking distance of Camp Hill Commons amenities
- + Centrally located minutes from Downtown Harrisburg, Camp Hill Borough and Mechanicsburg.

## OFFICE SUITE AVAILABLE (FLOOR 2)

### SUITE 201: 5,005 RSF

Suite holds 6 private offices & an open floor plan, located directly off of the 2<sup>nd</sup> Floor lobby



## Suite 201 Floor Plan/Layout

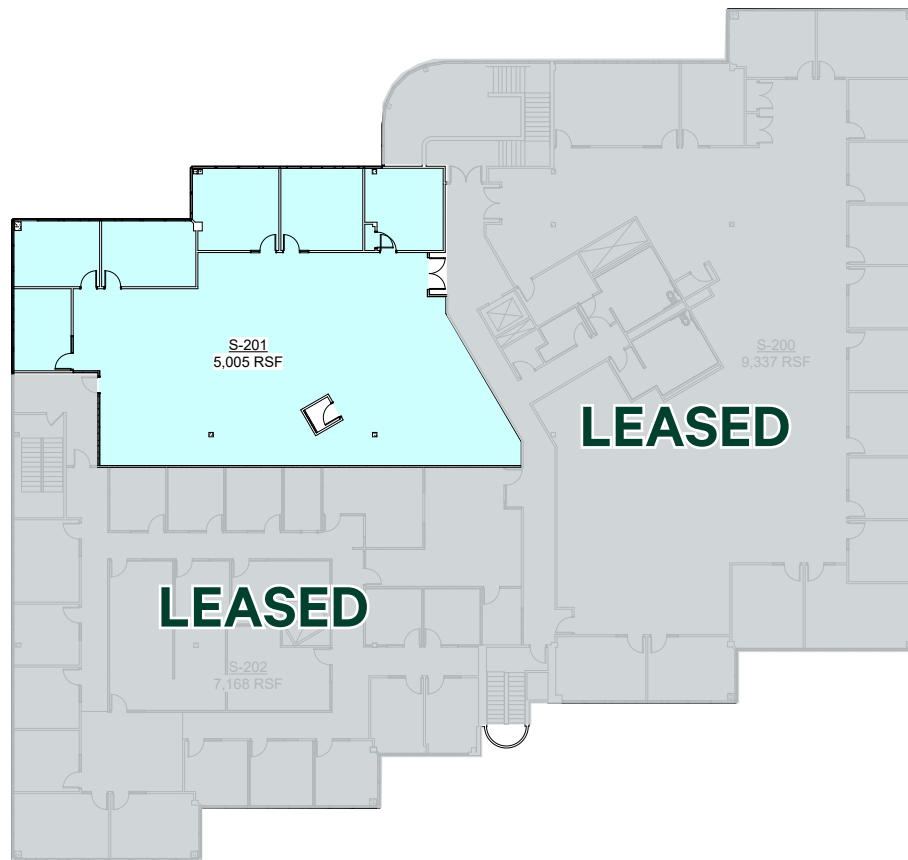

NOT TO SCALE



100 Corporate Center Drive  
Camp Hill, PA 17011

For Lease

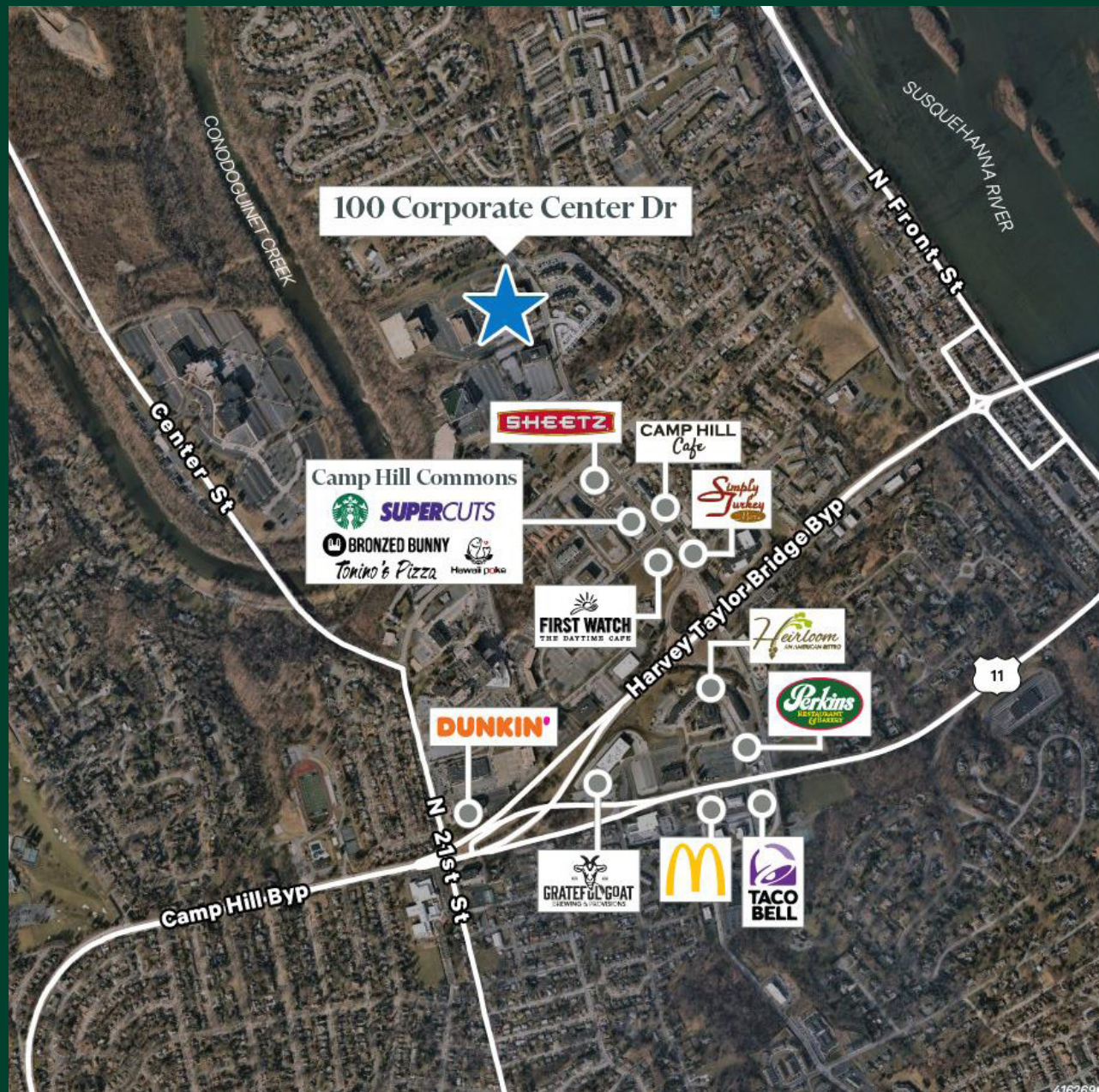

## Contact Us

**Jeremy Shyk**  
Senior Vice President  
+1 717 540 2701  
jeremy.shyk@cbre.com

**CBRE, Inc.**  
5 Capital Drive, Suite 201  
Harrisburg, PA 17110  
+1 717 540 2700 | www.cbre.com

© 2025 CBRE, Inc. All rights reserved. This information has been obtained from sources believed reliable, but has not been verified for accuracy or completeness. You should conduct a careful, independent investigation of the property and verify all information. Any reliance on this information is solely at your own risk. CBRE and the CBRE logo are service marks of CBRE, Inc. All other marks displayed on this document are the property of their respective owners, and the use of such logos does not imply any affiliation with or endorsement of CBRE. Photos herein are the property of their respective owners. Use of these images without the express written consent of the owner is prohibited.