

Beehive

8520 NATIONAL BLVD

@ CONJUNCTIVE POINTS
CULVER CITY + LA



FOR LEASING INFORMATION, CONTACT:

Micheal Geller
Managing Director
micheal.geller@jll.com
CA License 00800010
(310) 486-1976

Gabriel Brown
Executive Vice President
gabe.brown@jll.com
CA License 01441920
(310) 435-4344

Josh Bernstein
Managing Director
josh.bernstein@cushwake.com
CA License 01828093
(310) 795-5947

Alexa Delahooke
Senior Associate
alexa.delahooke@cushwake.com
CA License 02091695
(626) 340-5391



Jones Lang LaSalle Brokerage, Inc., Real estate license #01856260.
Cushman & Wakefield. All rights reserved



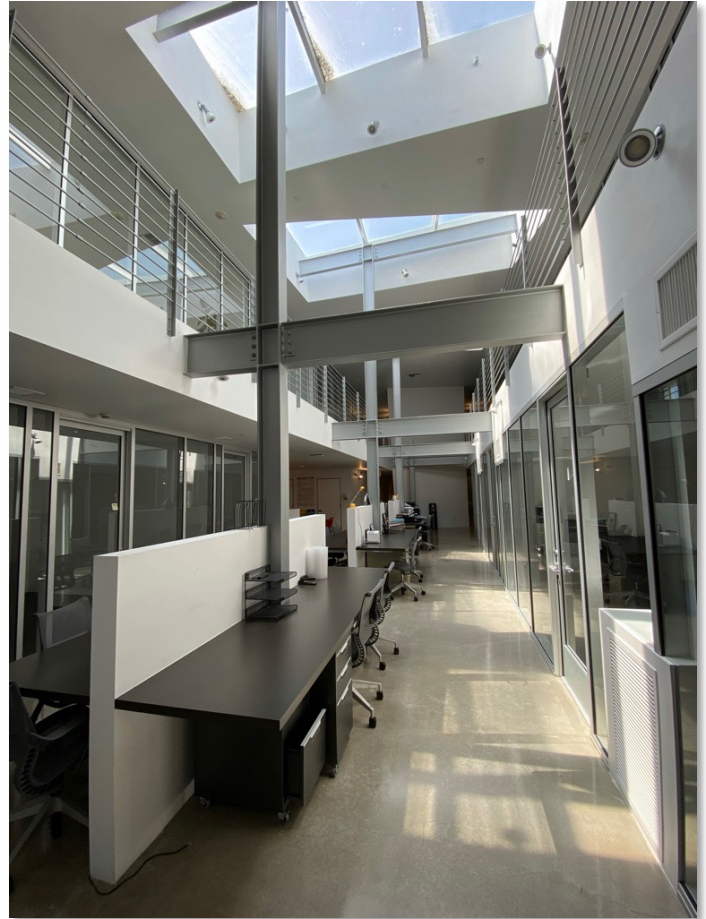

AVAILABLE SPACE: Suite B – 11,319 RSF

RENTAL RATE: **NEGOTIABLE**

PARKING: 3 spaces per 1,000 RSF
\$175 unreserved
\$275 reserved

GROUND FLOOR



SECOND FLOOR



IDEALLY LOCATED IN THE HEART OF CULVER CITY'S HAYDEN TRACT – THE VIBRANT CREATIVE OFFICE EPICENTER OF WEST LA



CONJUNCTIVE POINTS

Conjunctive Points is a community of creative tenants from such diverse fields as entertainment, technology, advertising and design. The common theme: the desire to grow and develop in a visually striking environment unlike anything else in the world.

