

*Flite*  
GOODYEAR



**1300 S LITCHFIELD RD, BLDG 270**  
GOODYEAR, ARIZONA 85338

UP TO 54,000 SF AVAILABLE (DIVISIBLE)

\$0.79 SF + NNN

HEAVY POWER

FOUR LOADING DOCKS

TWO GRADE LEVEL DOORS

AMPLE PARKING

**Scott Wiley**  
Associate Broker  
623.210.3749  
scott@citywidecre.com

**Kate Wiley**  
Sales & Leasing  
602.872.0943  
kate@citywidecre.com

**Ken Schawl**  
Sales & Leasing  
623.326.3755  
ken@citywidecre.com

**Todd Hamilton, SIOR, CCIM**  
Partner/Designated Broker  
602.909.8759  
todd@citywidecre.com

1645 E Missouri Avenue, Suite 230  
Phoenix, Arizona 85016  
602.313.1000 • citywidecre.com

**citywide**  
COMMERCIAL REAL ESTATE

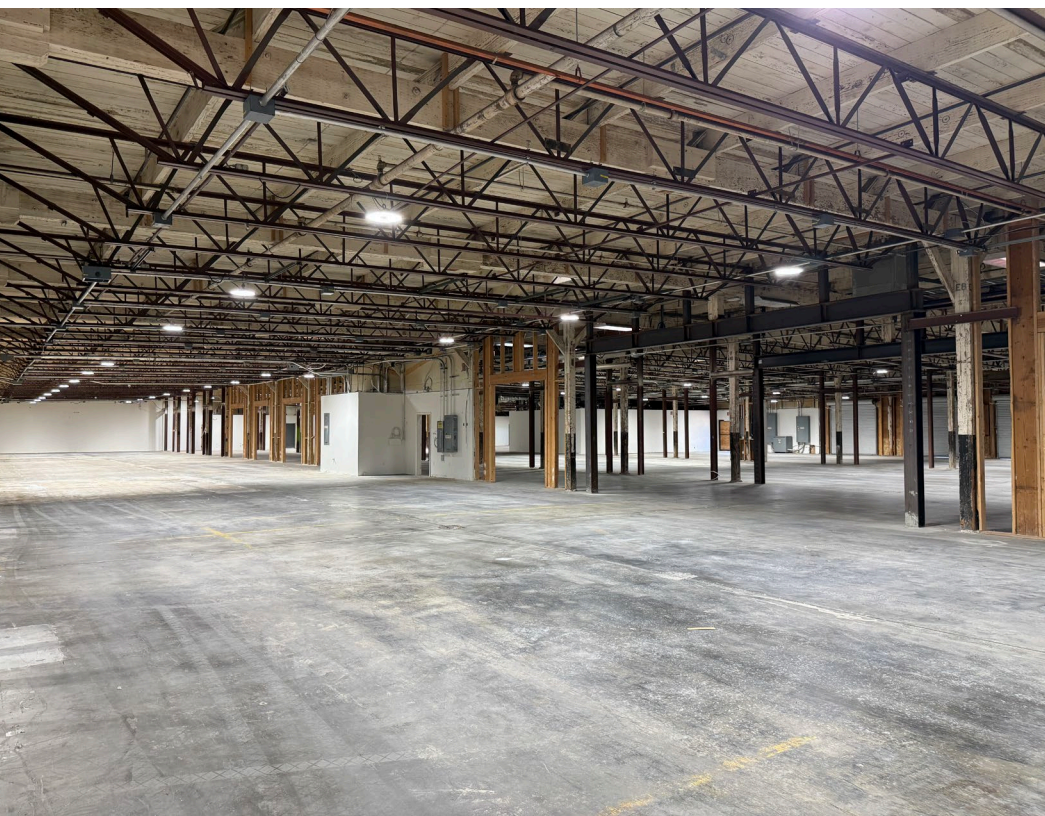

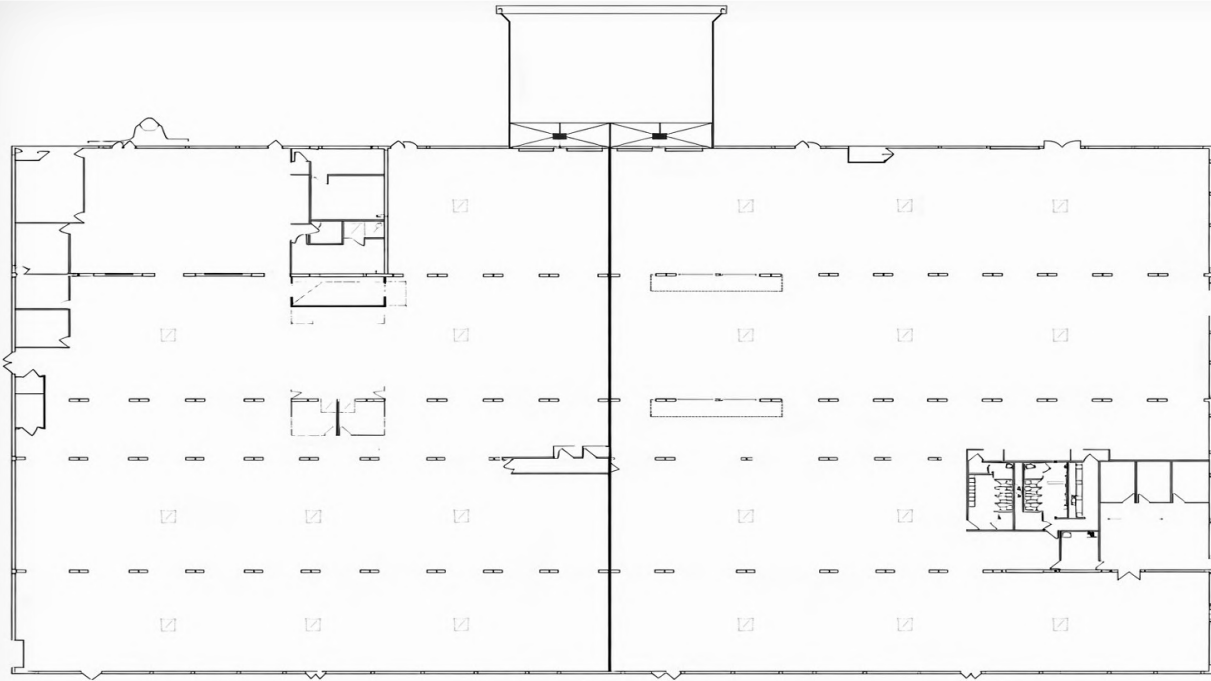

## PROPERTY DETAILS

- 270-A Suite - 30,047 SF
- 270-B Suite - 23,953 SF
- **54,000 SF Total**
- 100 kVa 277/480 3-Phase (270-A)
- 500 kVa 208/120 3-Phase (270-B)
- **3000 Amps Total**
- LED Warehouse Lighting
- 12' to 14' Ceiling Height
- Ample Parking

## CONTACT INFORMATION

**Scott Wiley**  
Associate Broker  
623.210.3749  
scott@citywidecre.com

**Kate Wiley**  
Sales & Leasing  
602.872.0943  
kate@citywidecre.com

**Ken Schawl**  
Sales & Leasing  
623.326.3755  
ken@citywidecre.com

**Todd Hamilton, SIOR, CCIM**  
Partner/Designated Broker  
602.909.8759  
todd@citywidecre.com

1645 E Missouri Avenue, Suite 230 • Phoenix, Arizona 85016  
602.313.1000 • citywidecre.com

# SITE PLAN

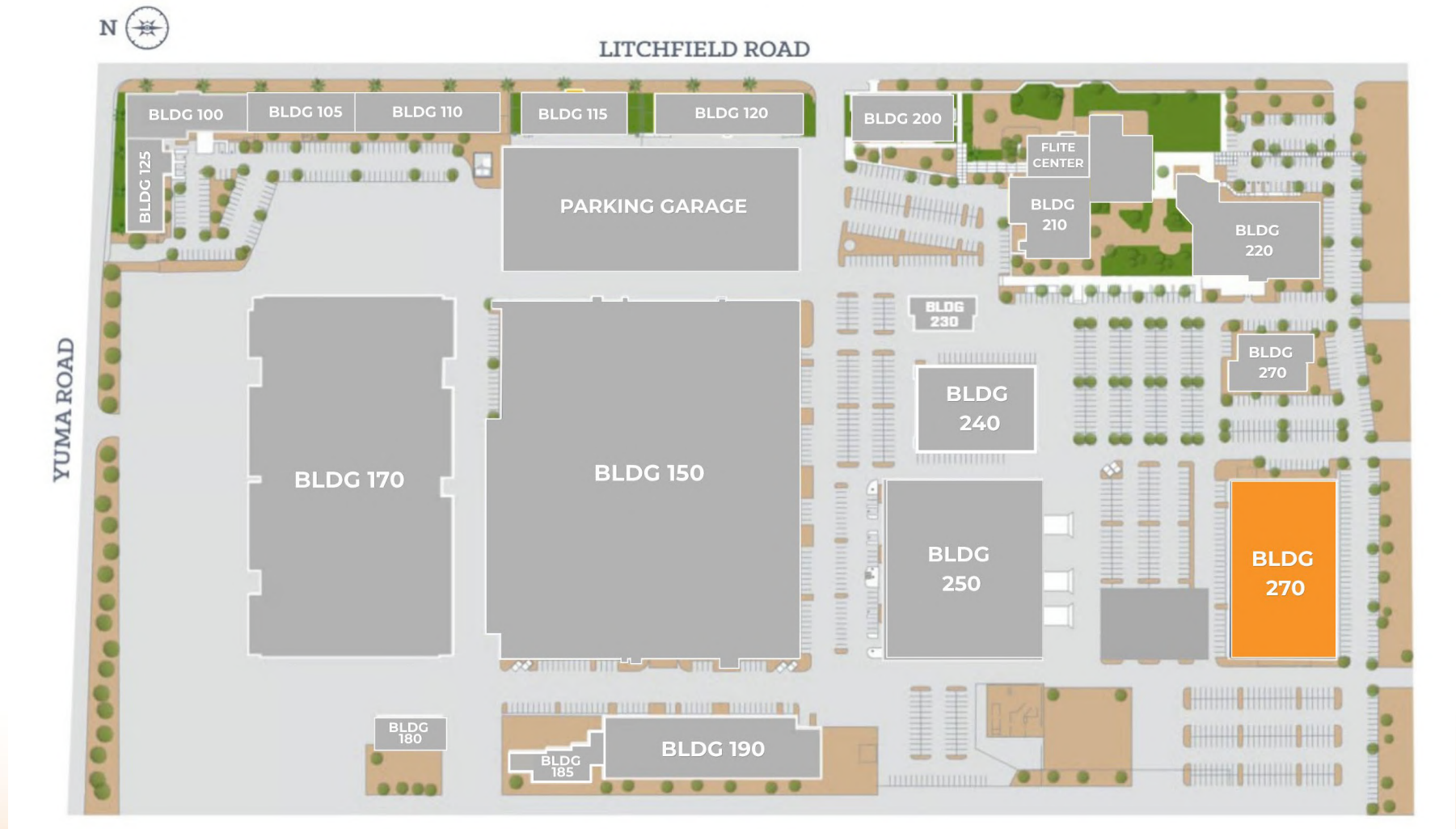

1645 E Missouri Avenue, Suite 230 • Phoenix, Arizona 85016  
602.313.1000 • citywidecre.com

**Scott Wiley**  
Associate Broker  
623.210.3749  
scott@citywidecre.com

**Kate Wiley**  
Sales & Leasing  
602.872.0943  
kate@citywidecre.com

**Ken Schawl**  
Sales & Leasing  
623.326.3755  
ken@citywidecre.com

**Todd Hamilton, SIOR, CCIM**  
Partner/Designated Broker  
602.909.8759  
todd@citywidecre.com



# HISTORY OF FLITE GOODYEAR

**This iconic Goodyear, Arizona site traces its roots to 1916 when Paul W. Litchfield and the Southwest Cotton Company established large-scale cotton production across 16,000 acres. During World War II, it transformed into a vital defense facility as Goodyear Aircraft Corporation, where the U.S. Navy modified and tested PB2Y-3 Coronado flying boats. Employing over 7,500 workers, the site spurred residential growth and the formal incorporation of the Town of Goodyear.**

**Over the decades, it evolved through Goodyear Aerospace (1963), Loral Corporation (1987), and Lockheed Martin (1993), pioneering advancements in radar, missile systems, and airborne surveillance technologies. Today, following a major 2016 modernization, the historic property proudly honors its rich aviation and industrial legacy while offering modern leasing opportunities.**

## CAMPUS AMENITIES



BEBIDA COFFEE +  
LITE BITES  
(BLDG 220)

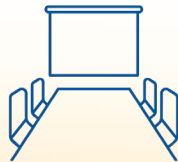

CONFERENCE  
FACILITIES WITH  
AV AVAILABLE



OUTDOOR  
COURTYARDS &  
SEATING AREAS  
WITH WIFI



PROPERTY  
MANAGEMENT  
OFFICE ON-SITE



NOTARY  
AVAILABLE BY  
APPOINTMENT



ROVING  
SECURITY &  
CONTROLLED  
ACCESS