



For Sale/Lease

16500 W 12 Mile Rd
Southfield, MI 48076

62,752 SF Value-Add Opportunity
Office/Medical/Flex





PROPERTY INFORMATION

PROPERTY SUMMARY	
Address	16500 W 12 Mile Rd, Southfield, MI
Building Area	62,752 SF
Sale/Lease Price	Contact Broker
Parking	250 Spots Available (3.98/1,000 SF)
Site Area	3.05 AC
Year Built	1969 (renovated 2012)
Slab to Slab	12'
Zoning	OS
Stories	2
Sprinkled	Yes
Annual Average Daily Traffic (AADT)	9,720 vehicles (Pierce St/W 12 Mile Rd)
Taxes	\$1.07/SF (2024)

SITE AERIAL



INTERSTATE AERIAL





SECOND FLOOR PLAN

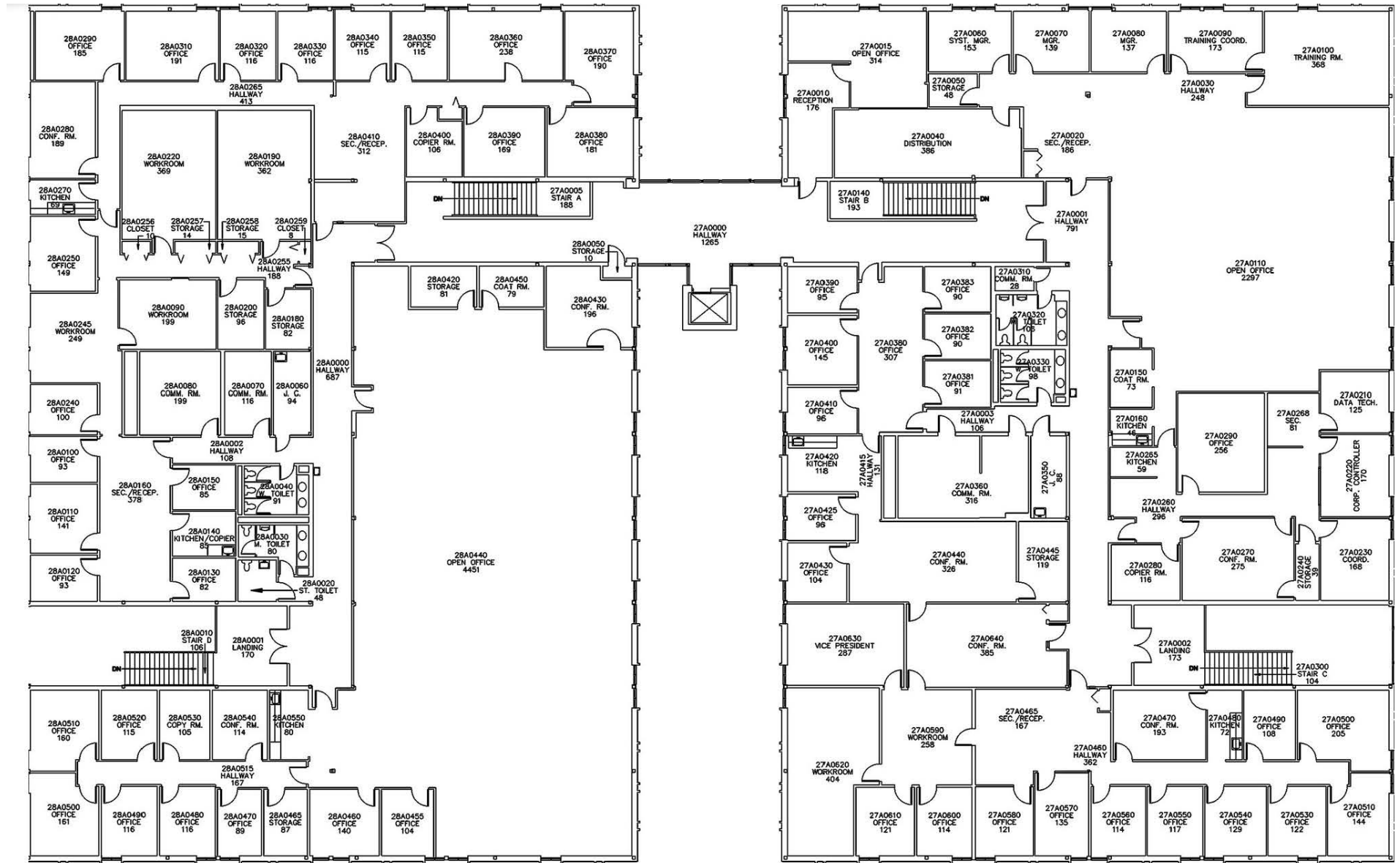



FOR MORE INFORMATION CONTACT PLANTE MORAN REALPOINT:

Mike Carl | Principal

Mike.Carl@plantemoran.com

248.603.5277

Sean Abelarde | Senior Consultant

Sean.Abelarde@plantemoran.com

248.223.3165

RJ Moran | Senior Consultant

RJ.Moran@plantemoran.com

248.223.3142

DISCLAIMER All rights reserved. This information has been obtained from sources believed reliable, but has not been verified for accuracy or completeness. Any projections, opinions, or estimates are subject to uncertainty. The information may not represent the current or future performance of the property. You and your advisors should conduct a careful, independent investigation of the property and verify all information. Any reliance on this information is solely at your own risk. All marks displayed on this document are the property of their respective owners. Photos herein are the property of their respective owners and use of these images without the express written consent of the owner is prohibited.