

BOTH END CAP UNITS AVAILABLE!



PILOT

PROPERTY GROUP

41560-41660 GARFIELD ROAD, CLINTON TWP, MI 48038

PROPERTY OVERVIEW:

- Well Maintained and Professionally Managed Plaza.
- 1,600 SF Former Pizza Unit End Cap.
- 6,200 SF Former Bar Unit End Cap Available - with Kitchen.
- Ample signage available.
- Contact Brokers for more details.

Property Type:	Retail
Cross Streets:	East side of Garfield, South of Canal Road
Total Square Footage:	14,449
Building Name:	Garfield Landing
Minimum Square Footage:	1,600
Maximum Square Footage:	6,200
Parcel Size:	3.053 Acres
Year Built:	1979
Zoning:	B-2
Parking Spaces:	Ample
Lease Rate:	\$12.00/SF
Lease Type:	NNN

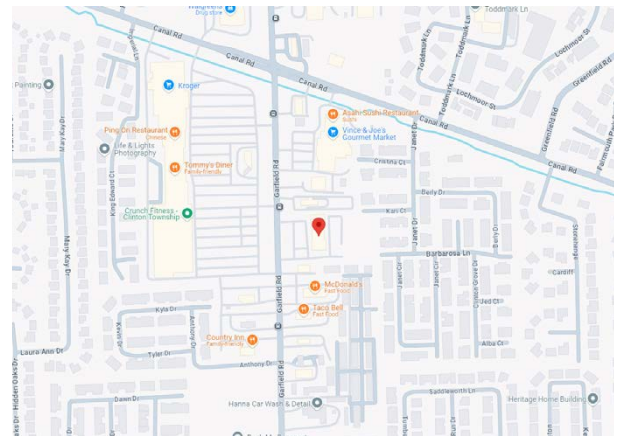

AGENT CONTACT INFO

ANTHONY RUBINO O: 586.254.0900 x101 • C: 586.873.5419 • anthony@pilotpg.com
ALEX TERMINI O: 586.254.0900 x104 • C: 586.291.0499 • alex@pilotpg.com

Matching the right people to the right place.

38600 Van Dyke, Suite 325, Sterling Heights, MI 48312 • 1530 Pine Grove, Suite 4, Port Huron, MI 48060
586.254.0900 • www.pilotpg.com

FLOOR PLAN

Garfield Landing
41560 Garfield Rd
Clinton Twp., MI

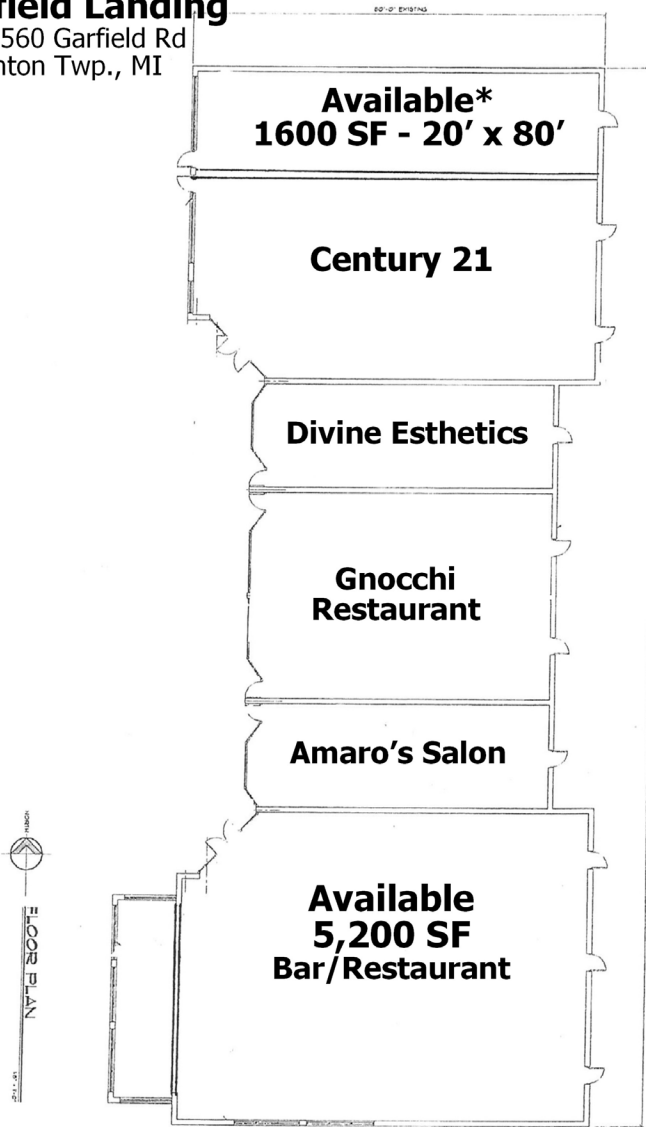

Matching the right people to the right place.

ADDITIONAL PHOTOS



Matching the right people to the right place.

ADDITIONAL PHOTOS



Matching the right people to the right place.