

FOR LEASE | 13,032 SF
16014 ADELANTE ST, UNIT B
Irwindale, CA 91702



PROPERTY HIGHLIGHTS

- Lease Rate/SF:** \$1.42 PSF
NNN/Op. Ex. + \$0.28
- Available SF:** 13,032 SF
- Office SF:** 600 SF
- Yard:** No
- Sprinklered:** No
- GL Doors/Dim:** 0
- DH Doors/Dim:** 2
- Parking Spaces:** 13
- Vacancy:** Immediate Availability
- Clearance Height:** 24'

Immediate Access to (210) Freeway via Irwindale Avenue

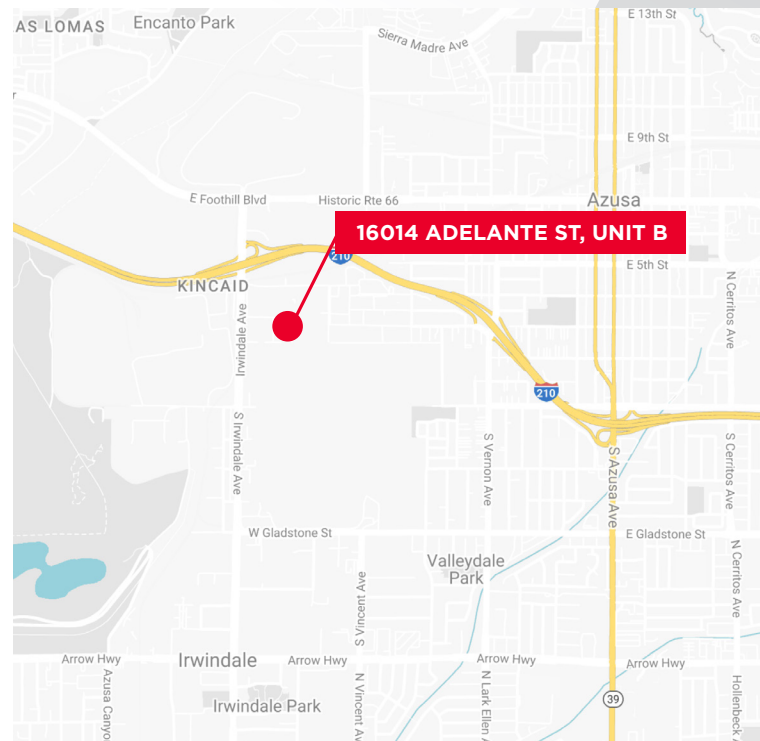

For more information contact:

CHRIS TOLLES
Executive Managing Director
Commercial Brokerage
+1 213 955 5129
chris.tolles@cushwake.com
CA Lic #01459899

MAYA SCHIRN
Associate - DTLA
+1 213 236 4931
+1 818 561 9588
maya.schirn@cushwake.com
CA Lic #02237054



FOR LEASE

16014 Adelante St, Unit B

IRWINDALE, CA 91702



SITE PLAN

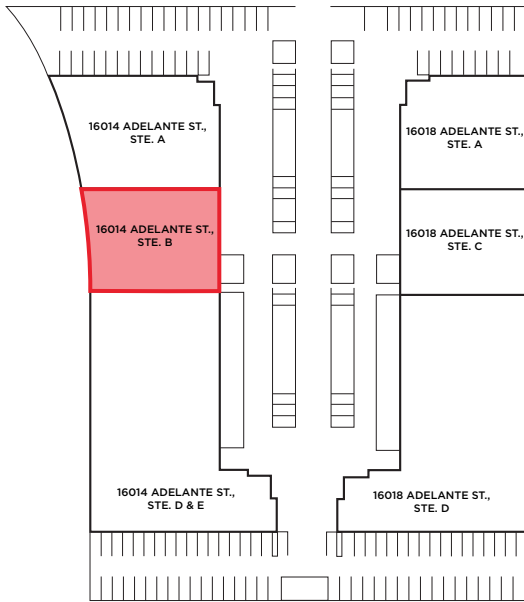

FLOOR PLAN

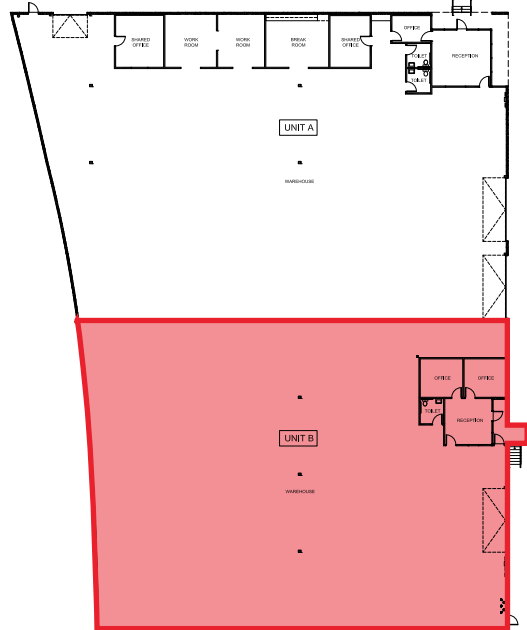

PHOTOS



For more information contact:

CHRIS TOLLES

Executive Managing Director
Commercial Brokerage
+1 213 955 5129
chris.tolles@cushwake.com
CA Lic #01459899

MAYA SCHIRN

Associate - DTLA
+1 213 236 4931
+1 818 561 9588
maya.schirn@cushwake.com
CA Lic #02237054

900 Wilshire Blvd, Suite 2400
Los Angeles, CA 90017
+1 213 955 5100
cushmanwakefield.com

©2024 Cushman & Wakefield. All rights reserved. The information contained in this communication is strictly confidential. This information has been obtained from sources believed to be reliable but has not been verified. NO WARRANTY OR REPRESENTATION, EXPRESS OR IMPLIED, IS MADE AS TO THE CONDITION OF THE PROPERTY (OR PROPERTIES) REFERENCED HEREIN OR AS TO THE ACCURACY OR COMPLETENESS OF THE INFORMATION CONTAINED HEREIN, AND SAME IS SUBMITTED SUBJECT TO ERRORS, OMISSIONS, CHANGE OF PRICE, RENTAL OR OTHER CONDITIONS, WITHDRAWAL WITHOUT NOTICE, AND TO ANY SPECIAL LISTING CONDITIONS IMPOSED BY THE PROPERTY OWNER(S). ANY PROJECTIONS, OPINIONS OR ESTIMATES ARE SUBJECT TO UNCERTAINTY AND DO NOT SIGNIFY CURRENT OR FUTURE PROPERTY PERFORMANCE.