

Catoosa County, GA

Homestead Application

Apply for Homestead Application

Summary

Parcel Number 00031037
Location Address 2 WEST HARKER ROAD
Legal Description FT OGLETHORPE AREA 35
(Note: Not to be used on legal documents)
Class E2-Exempt
(Note: This is for tax purposes only. Not to be used for zoning.)
Zoning For
Tax District Fort Oglethorpe (District 03)
Millage Rate 28.088
Acres 0.5
Neighborhood C5000 - Exempt CHURCHES & Cemeteries (5000)
Homestead Exemption No (S0)
Landlot/District 97 / 9

[View Map](#)



Owner

[LIBERTY BAPTIST CHURCH](#)
 OF WHITFIELD COUNTY INC
 4439 TIBBS BRIDGE ROAD SE
 DALTON, GA 37021

Land

Type	Description	Calculation Method	Square Footage	Frontage	Depth	Acres	Lots
Exempt	6000FTO FF REED \$800	Front Feet	21,600	200	108	0.5	0

Commercial Improvement Information

Description CHURCH
Value \$400,103
Actual Year Built 1980
Effective Year Built 1987
Square Feet 8288
Wall Height 10
Wall Frames WOOD
Exterior Wall BRICK VENEER
Roof Cover ASPHALT SHINGLES
Interior Walls SHEETROCK
Floor Construction OPEN WOOD JOISTS
Floor Finish CARPET/TILE
Ceiling Finish SHEETROCK
Lighting
Heating CENTRAL HEAT & AIR
Number of Buildings 1

Description CHURCH
Value \$182,384
Actual Year Built 1930
Effective Year Built 1980
Square Feet 3429
Wall Height 12
Wall Frames
Exterior Wall
Roof Cover
Interior Walls
Floor Construction
Floor Finish
Ceiling Finish
Lighting
Heating
Number of Buildings 1

Permits

Permit Date	Permit Number	Type	Description
09/02/2015	150294	RESIDENTIAL REMODEL	
09/02/2015	150294	RESIDENTIAL REMODEL	
09/27/2011	110144	RESIDENTIAL REMODEL	PERMIT STATES REROOF ADDITION

Sales

Sale Date	Deed Book / Page	Plat Book / Page	Sale Price	Reason	Grantor	Grantee
6/30/2015	1779 822	2 10	\$0	UT	CALVARY MEMORIAL BAPTIST	LIBERTY BAPTIST CHURCH
	81 291		\$0	UK		CALVARY MEMORIAL BAPTIST

Valuation

	2024	2023	2022	2021	2020
Previous Value	\$629,347	\$629,347	\$629,347	\$629,347	\$629,347
Land Value	\$140,160	\$140,160	\$140,160	\$140,160	\$140,160
+ Improvement Value	\$582,487	\$489,187	\$489,187	\$489,187	\$489,187
+ Accessory Value	\$0	\$0	\$0	\$0	\$0
= Current Value	\$722,647	\$629,347	\$629,347	\$629,347	\$629,347

Photos



Sketches

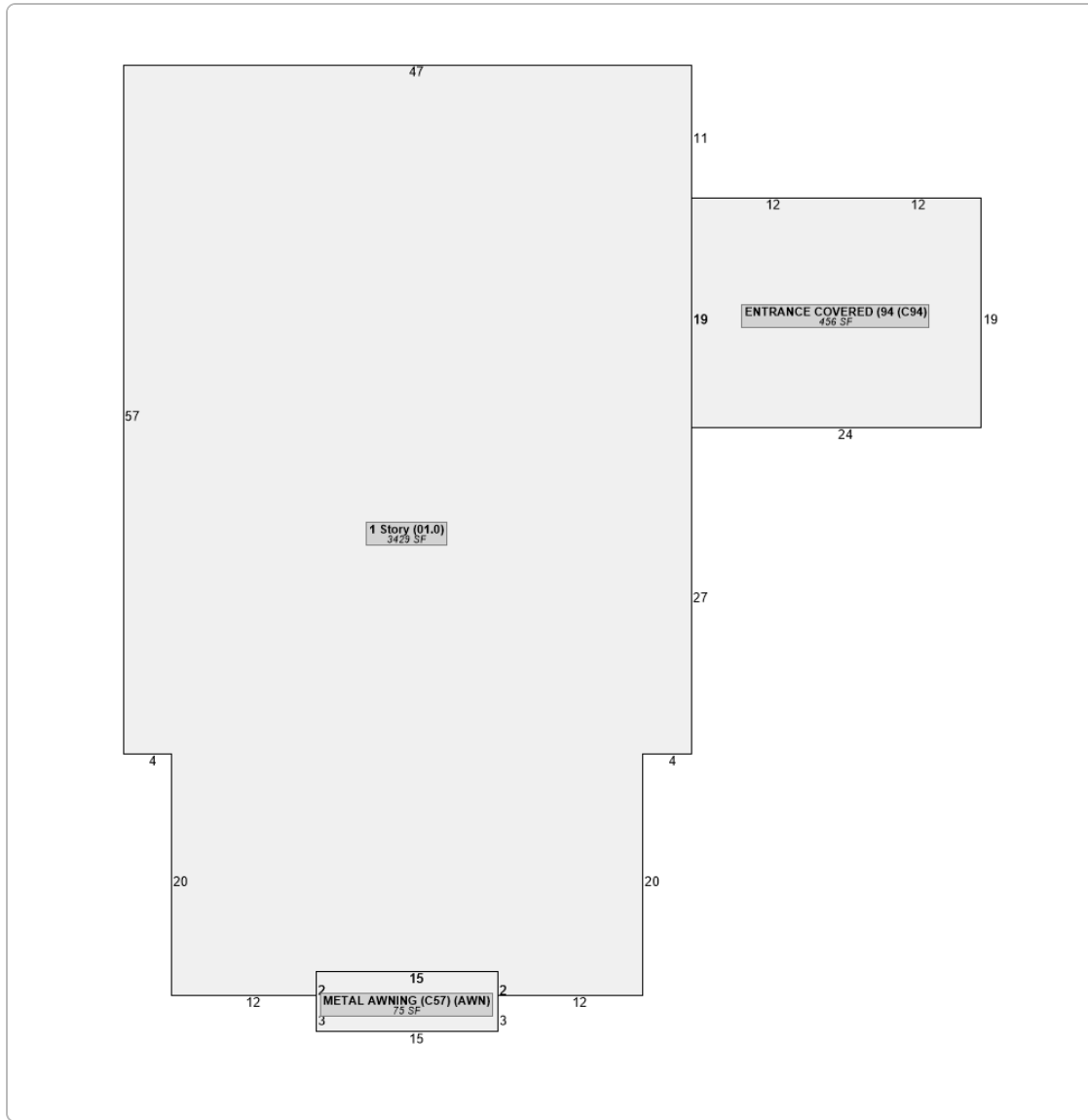

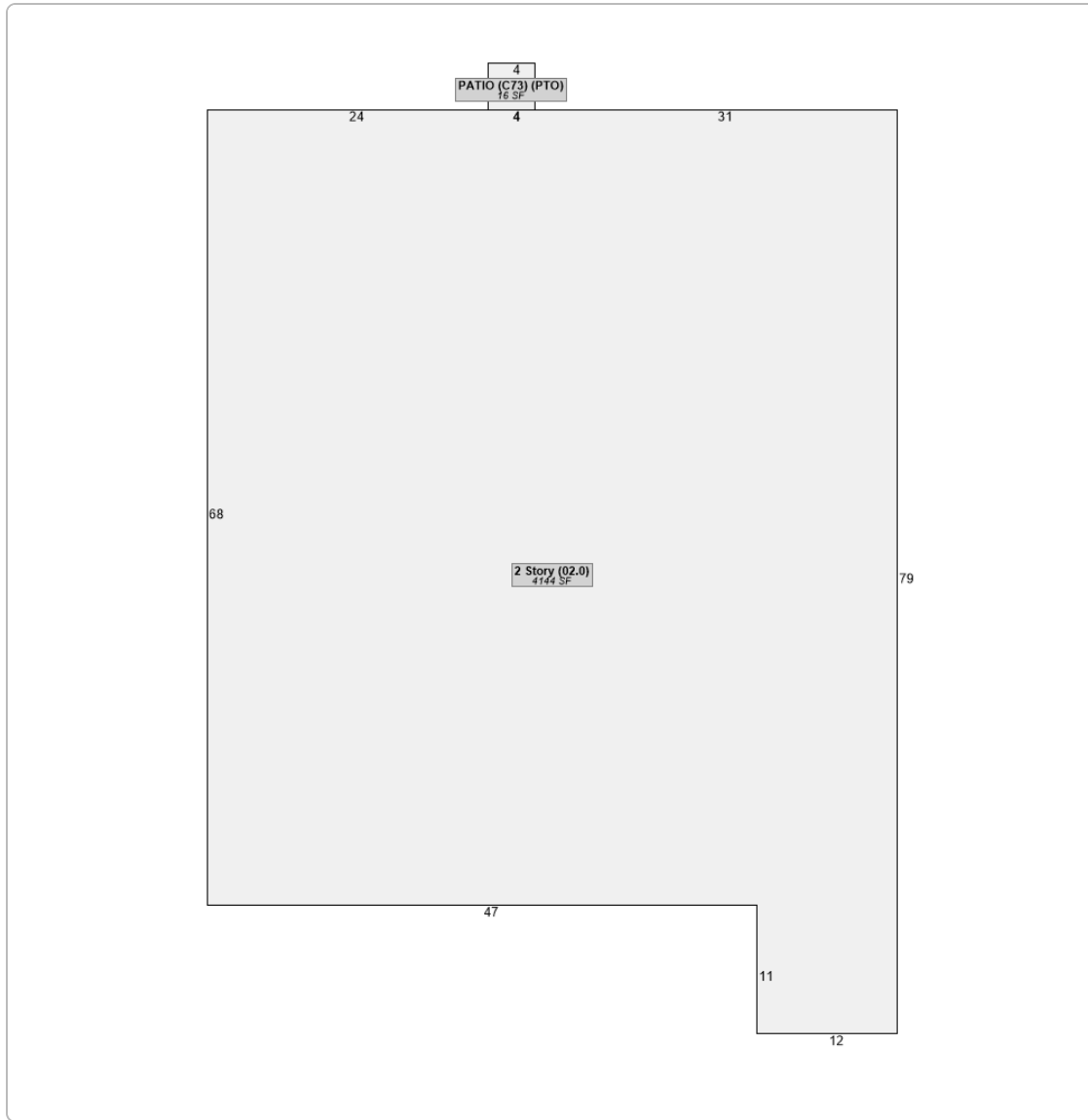

Comp Search

Start Comp Search

No data available for the following modules: Assessment Appeals Process, Rural Land, Conservation Use Rural Land, Residential Improvement Information, Mobile Homes, Accessory Information, Prebill Mobile Homes, Assessment Notices.

The Catoosa County Assessor makes every effort to produce the most accurate information possible. No warranties, expressed or implied are provided for the data herein, its use or interpretation. The assessment information is from the 2020 preliminary tax roll and subject to change until certified. All other data is subject to change.
| [User Privacy Policy](#) | [GDPR Privacy Notice](#)
[Last Data Upload: 9/21/2024, 3:14:19 AM](#)

Contact Us

