

BETHESDA PLACE

The Place That Has It All

Class A offices in Bethesda's
most convenient location

7600 & 7700
Wisconsin Avenue
Bethesda, MD





7600 Wisconsin Avenue



7700 Wisconsin Avenue



BUILDING FEATURES

- Renovations to the outdoor plaza and 7700 Wisconsin lobby & exterior facade complete
- Located near the intersection of Wisconsin Avenue and Old Georgetown Road
- One block to the Bethesda Metro Station (Red Line)
- Parking ratio of 2/1,000 SF; 200 covered spaces
- Superb Location - within walking distance to a wide variety of restaurants, shops, movie theatres, banks, and fitness facilities
- On-site amenities including: Fitness center, state-of-the-art conference facility, property management, concierge, security guard, courtyard, Lidl, tailor, deli, spa and The Original Pancake House
- Steel construction with column free space

NEWLY COMPLETED RENOVATIONS

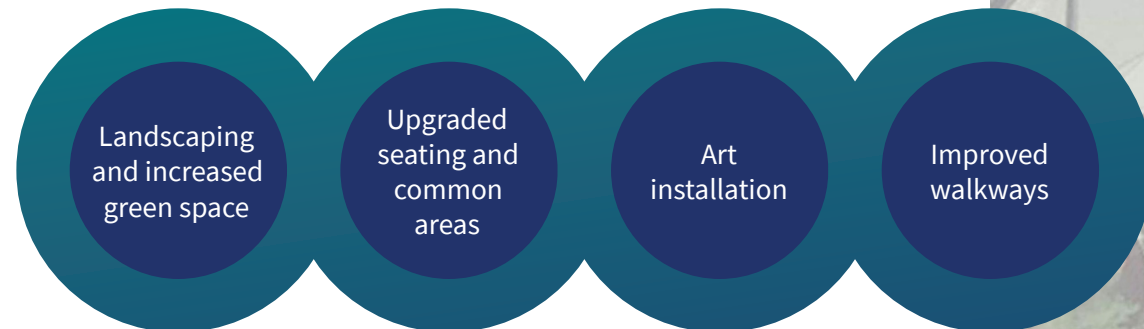

PLAZA RENOVATION & ON-SITE AMENITIES



**7600 WISCONSIN AVENUE
BETHESDA PLACE II**

AVAILABILITY

11	Suite 1100 19,172 RSF			
10	Leased	Suite 1010 10,796 RSF		
09	Leased			
08	Leased			
07	Leased			
06	Leased			
05	Suite 500 15,220 RSF		Leased	
04	Leased			
03	Leased			
02	Leased			
01	Suite 100 7,729 RSF	Lobby	Suite 125 2,256 RSF	Leased



**7700 WISCONSIN AVENUE
BETHESDA PLACE I**



AVAILABILITY

11	Leased				Suite 1150 8,829 RSF	
10	Suite 1050 12,627 RSF	Leased				
09	Leased					
08	Suite 800 29,254 RSF					
07	Suite 700 29,254 RSF					
06	Leased	Suite 650 19,422 RSF				
05	Leased					
04	Suite 410 5,414 RSF	Leased				
03	Suite 300* 2,970 RSF	Suite 310* 2,505 RSF	Leased	Suite 325 6,017 RSF	Suite 340* 4,412 RSF	Conference Center
02	Suite 200 8,106 RSF			Suite 250 10,718 RSF		
01	Fitness Center	Lobby			Retail 2,536 RSF	

*Denotes spec suites

LOCATION & AMENITIES

RETAIL & DINING

1. Black's Bar & Kitchen
2. Marriott Hotel & Hip Flask Rooftop Bar
3. Starbucks
4. The Original Pancake House
5. Tastee Diner
6. Woodmont Grill
7. Guapo's
8. Jetties
9. Trader Joe's
10. The Big Greek Café
11. Benihana
12. Olazzo
13. Corner Slice
14. Anthony's Coal Fired Pizza & Wings
15. Gringos & Mariachis
16. Alatri Bros
17. Bacchus of Lebanon
18. Tommy Joe's
19. Caddies
20. Medium Rare
21. Rock Bottom Restaurant & Brewery
22. Barrel & Crow
23. Pines of Rome
24. Lidl

WELLNESS

25. Crossfit Bethesda
26. Urban Boxing
27. Barre 3
28. Orangetheory Fitness
29. PureFire Yoga
30. SoulFire Collective
31. IGNITE Good Health

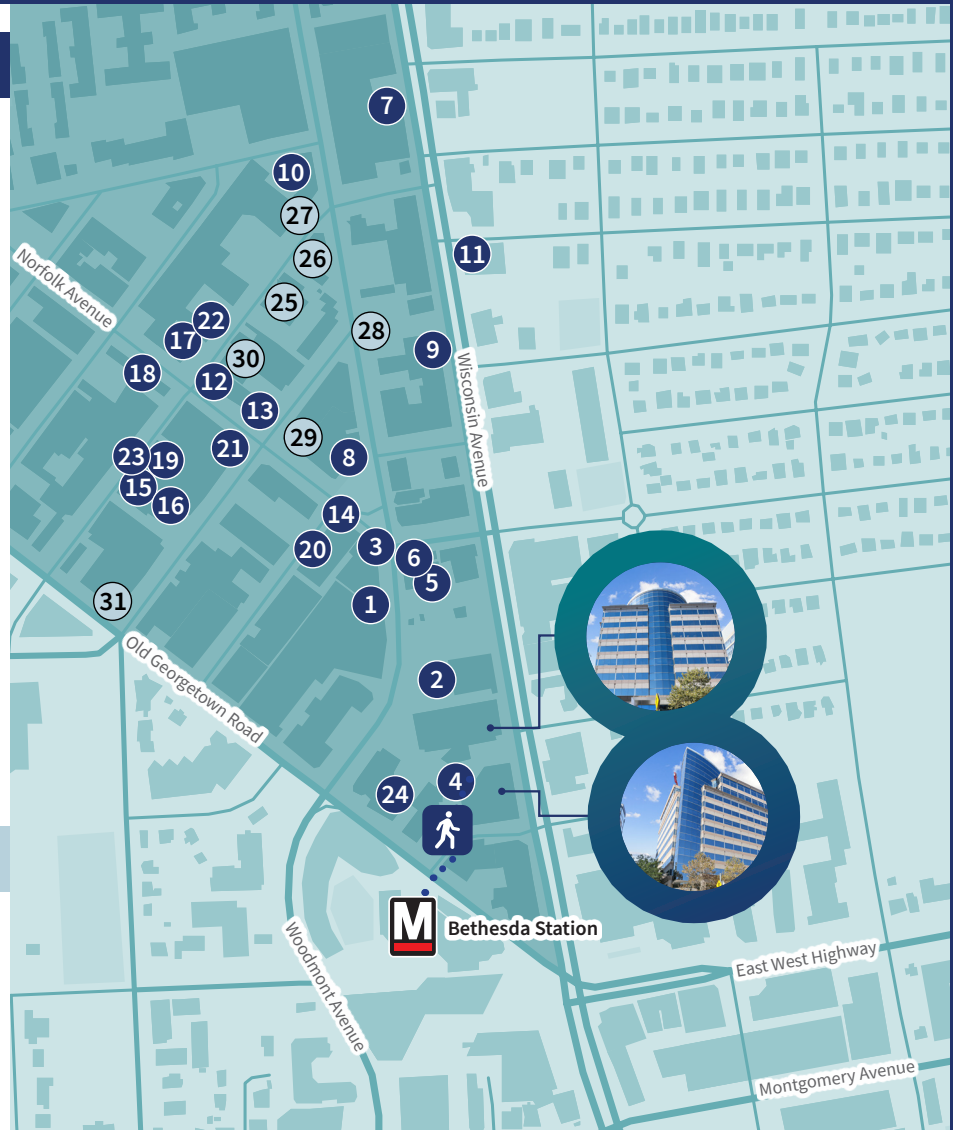

CONTACTS

JG Cahill

Senior Vice President
301 287 3245
jg.cahill@jll.com

Alden Stabb

Vice President
301 287 3241
alden.stabb@jll.com



Although information has been obtained from sources deemed reliable, JLL does not make any guarantees, warranties or representations, express or implied, as to the completeness or accuracy as to the information contained herein. Any projections, opinions, assumptions or estimates used are for example only. There may be differences between projected and actual results, and those differences may be material. JLL does not accept any liability for any loss or damage suffered by any party resulting from reliance on this information. If the recipient of this information has signed a confidentiality agreement with JLL regarding this matter, this information is subject to the terms of that agreement. ©2023. Jones Lang LaSalle IP, Inc. All rights reserved.