



LeMoyne Landing

MALLET RD & DAISY VESTRY RD
D'IBERVILLE, MS 39540

WHITNEY SPANGLER
+1 404 574 1046
whitney.spangler@colliers.com

DAVID MARTOS
+1 404 574 1003
david.martos@colliers.com



Property Overview

PROPERTY FEATURES

- 60 Acre Development located directly off I-10 with 78,000 VPD
- Located in the primary retail trade area in D'Iberville
- The region gets over 4.2 million visitors a year
- Anchored by a new Bass Pro Shops and Planet Fitness estimated to bring 12,000 people to the development a day
- Outparcel and Anchor spaces available

AREA DEMOGRAPHICS



1-Mile: 4,729
3-Mile: 27,271
5-Mile: 63,819



1-Mile: \$79,561
3-Mile: \$89,996
5-Mile: \$88,610



Traffic Counts



1-Mile: 1,903
3-Mile: 11,299
5-Mile: 26,107



1-Mile: 4,885
3-Mile: 24,902
5-Mile: 74,186

78,000 VPD
I-10

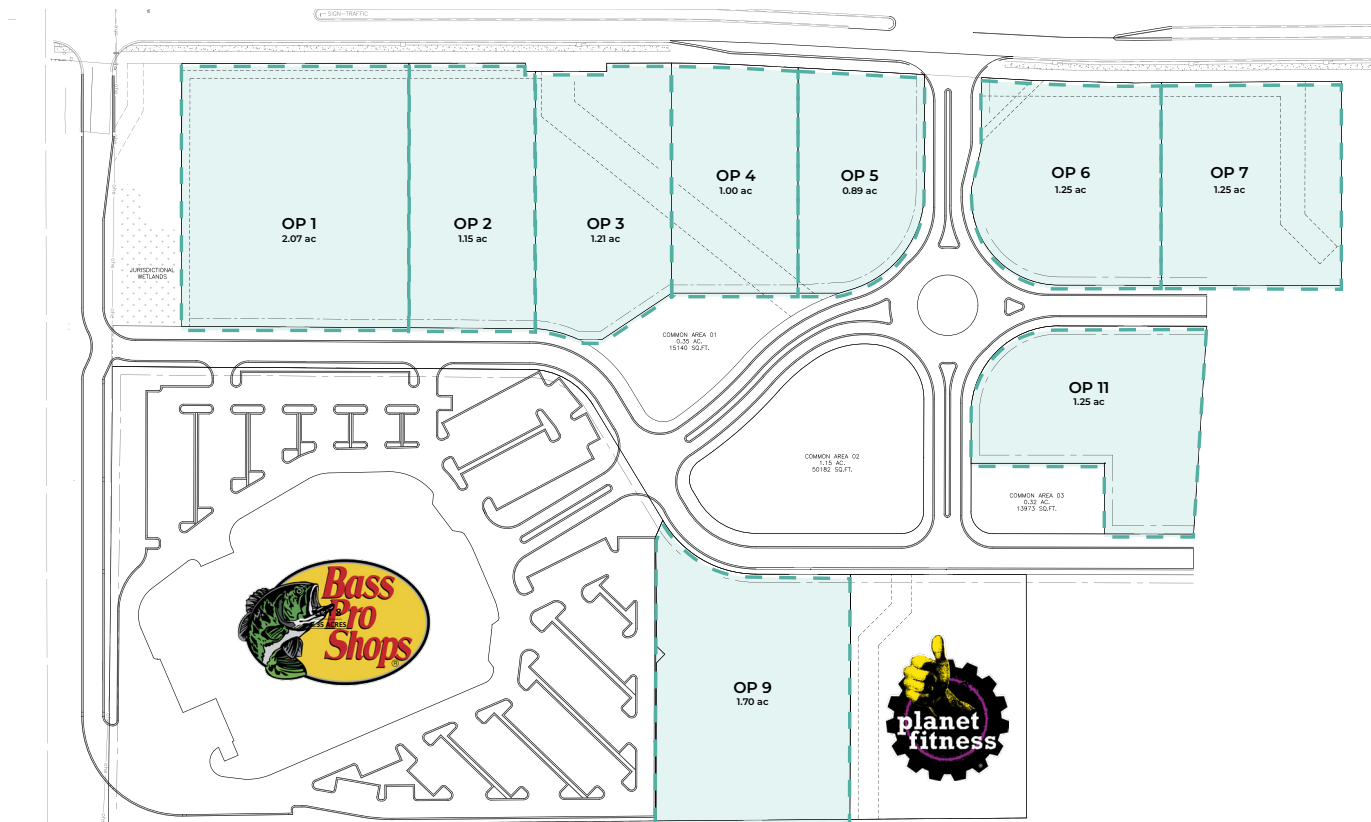

Trade Area

