

Wichita Commercial Retail Space for Lease



PESTINGER

Commercial Agency



ONE KELLOGG PLACE SHOPPING CENTER

11333 East Kellogg • Wichita, Kansas



CONTACT

Rob Pestinger

PHONE

316.650.2606

E-MAIL

Rob@PlazaRE.com

ONE KELLOGG PLACE SHOPPING CENTER

11333 East Kellogg • Wichita, Kansas



Commercial Agency

Highlights:

- Super Regional East Wichita Shopping Center
- Located within high traffic corridor
- Close highway access: East Kellogg/US Highway 54 • I 35 • K 96
- 45,753 Vehicles Per Day (Kellogg & Greenwich Rd)
- Retail development shadow anchored by:



Demographics	1 Mile	3 Miles	5 Miles	MSA
Population	5,597	55,729	138,389	643,765
Median Age	35.03	37.03	34.82	37.8
Households	2,676	28,190	70,922	220,420
Average HH Income	\$73,498	\$85,595	\$68,620	\$53,953

Available Spaces:

- Suite 100 ⇒ 4,500 SF
- Suite 300 ⇒ 1,400 SF
- Suite 400 ⇒ 1,400 SF
- Suite 900 ⇒ 2,100 SF (Available Summer 2020)

Base Lease Rate:

- \$18 per SF / YR (Suite 100, 300, 400)
- \$24 per SF / YR (Suite 900)

NNN Expenses:

\$4.20 per SF / YR

Existing Tenants:

Sprint, Dollar Tree, Petland, H&R Block, Sport Clips, Ivy Nails & Spa, Cartridge World, Vape 100

Total Building Size: 34,307 SF

Land Size: 133,729 SF

Year Built: 2002

Parking Spaces: 170

	CONTACT	Rob Pestinger
	PHONE	316.650.2606
	E-MAIL	Rob@PlazaRE.com

ONE KELLOGG PLACE SHOPPING CENTER

11333 East Kellogg • Wichita, Kansas



PESTINGER

Commercial Agency

Available Spaces:

Suite 100



Suite 300



Suite 400



Floor Plans: (Approx.)

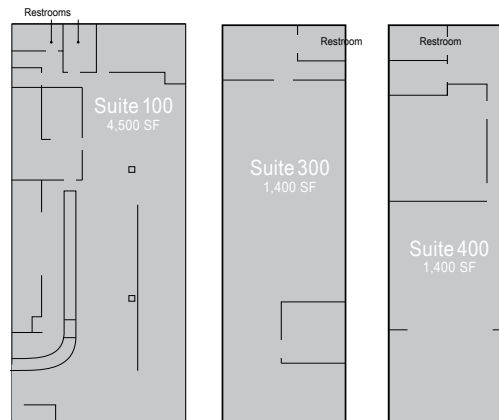

	CONTACT	Rob Pestinger
	PHONE	316.650.2606
	E-MAIL	Rob@PlazaRE.com

ONE KELLOGG PLACE SHOPPING CENTER

11333 East Kellogg • Wichita, Kansas



PESTINGER

Commercial Agency



★ 1333 E Kellogg Dr N



CONTACT	Rob Pestinger
PHONE	316.650.2606
E-MAIL	Rob@PlazaRE.com