

BAYSIDE REALTY PARTNERS PRESENTS

Park Place Medical

1761 Broadway Street, Vallejo, California

Healthcare Campus Adjacent MOB in North Bay



TRASK LEONARD
President and CEO
650.533.2591
tleonard@baysiderp.com
DRE#01152101



CAROLINE DOYLE
Senior Vice President
650.722.1495
cdoyle@baysiderp.com
DRE#01906397



Park Place Medical

1761 Broadway Street, Vallejo, California

LOCATION

- Immediately off Hwy 37 and Sonoma Blvd (Hwy 29)
- Great visibility from Broadway Street and access from Sonoma Blvd
- Next to public transportation, restaurants, pharmacies, Starbucks and supermarket
- Less than 0.5 mile from the 248-bed Kaiser Permanente Vallejo Medical Center and 1.5 miles from the 102-bed Sutter Solano Medical Center



BUILDING

2 story Class A medical office building — 58,000 sf

Security on premises

Building open 6 days a week

Spaces ready for built-out and move-in

Ample on-site parking; close proximity to retail services. 240 spaces

Park Place Medical

1761 Broadway Street, Vallejo, California

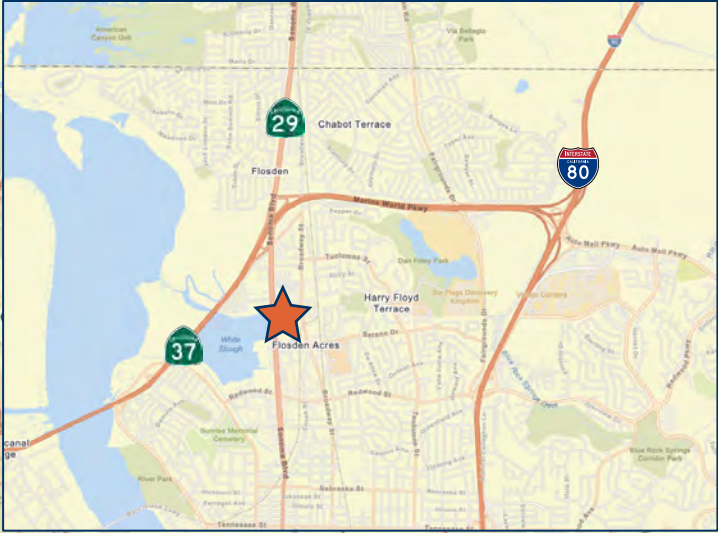

Park Place Medical

1761 Broadway Street, Vallejo, California

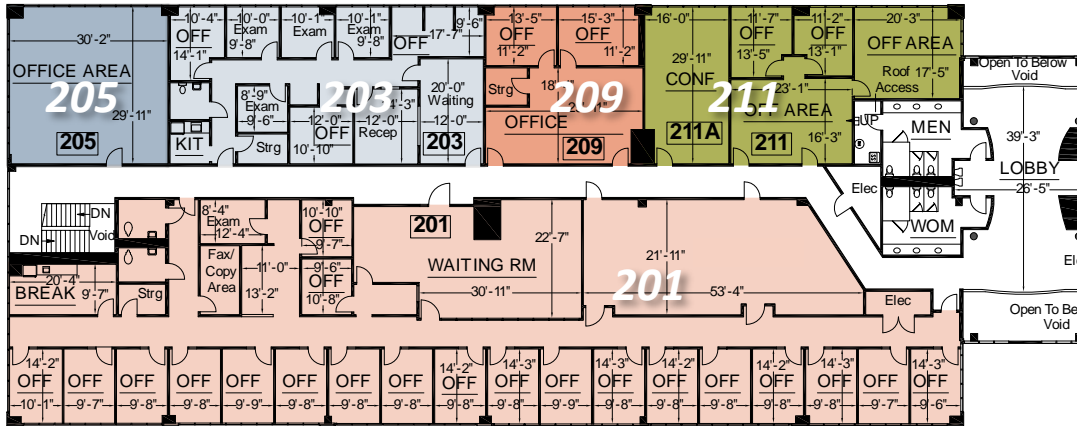

SECOND FLOOR

Suite 201 8,307 RSF
 21 office/exam rooms, large waiting room,
 large conference/training room, 2 restrooms,
 kitchen

Suite 203 2,141 RSF
 3 offices, 4 exam rooms, waiting room,
 reception, kitchen, 1 restroom

Suite 205 1,090 RSF
 Open office area

Suite 209 1,055 RSF
 3 office/exam rooms, storage

Suite 211 1,834 RSF
 4 office/exam rooms, conference room

Park Place Medical

1761 Broadway Street, Vallejo, California



SECOND FLOOR

- Suite 200** 2,397 RSF
Waiting room/reception, 5 office/exam rooms, lab area
- Suite 210** 6,227 RSF
10 office/exam rooms, reception, break room, storage, open space, 2 restrooms
- Suite 240** 1,688 RSF
Waiting room/reception, 8 office/exam rooms
- Suite 260** 273 RSF
Open office area

Meet Your Expert Team



TRASK LEONARD

President and CEO

650.533.2591

tleonard@baysiderp.com

DRE#01152101



CAROLINE DOYLE

Senior Vice President

650.722.1495

cdoyle@baysiderp.com

DRE#01906397

DOMINANT. EXPERT. INFLUENTIAL.

BAYSIDE REALTY PARTNERS

The preeminent provider of management, leasing, construction management and accounting services for healthcare properties.



MARKET LEADER

- Leasing & Property Management
- Investment Sales
- Tenant Representation
- Construction Management
- Property Repositioning



INFLUENTIAL NETWORK

- Institutional Investors
- Healthcare Systems and Healthcare Districts
- Physicians & Districts
- Private Investors



DOMINANT FOOTPRINT

- 2 million SF leased & managed
 - 50+ MOB portfolio
 - 10,000-240,000 SF
 - 500,000 SF portfolio
- San Francisco's largest MOBs
- 950+ leases executed
- 500+ medical and dental tenants

DOMINANT. EXPERT. INFLUENTIAL.