

# Ocean View Corporate Center

1440 Innovative Dr., Suite B-300  
San Diego, CA 92154

Available: ± 24,408 SF













## Ocean View Corporate Center

1440 Innovative Dr., Suite B-300 | San Diego, CA 92154

For Sublease

# Property Highlights

## Suite B-300

- + Total Size: ± 24,408 SF
- + Office Area: ± 3,130 SF (Includes ± 948 SF 2nd Floor Office)
- + Modern Office Improvements with New Finishes
- + Controlled Access
- + Reception
- + Two (2) Private Offices
- + Conference Room
- + Break Room
- + Open Office Work Area
- + Two (2) Restrooms
- + Clear Height: ± 24' – 26'
- + Five (5) Docks, One (1) Ramp (12' x 14')
- + Edge of Dock Levelers
- + ESFR Sprinklers
- + LED Warehouse Lighting
- + Column Spacing: ± 55' x 52'
- + Painted Warehouse Walls
- + Lease Rate: Contact Broker
- + NNN: ± \$0.25/SF
- + Term Through August 31, 2028
- + Contact Broker to Arrange Tour



# Floor Plan

Suite B-300

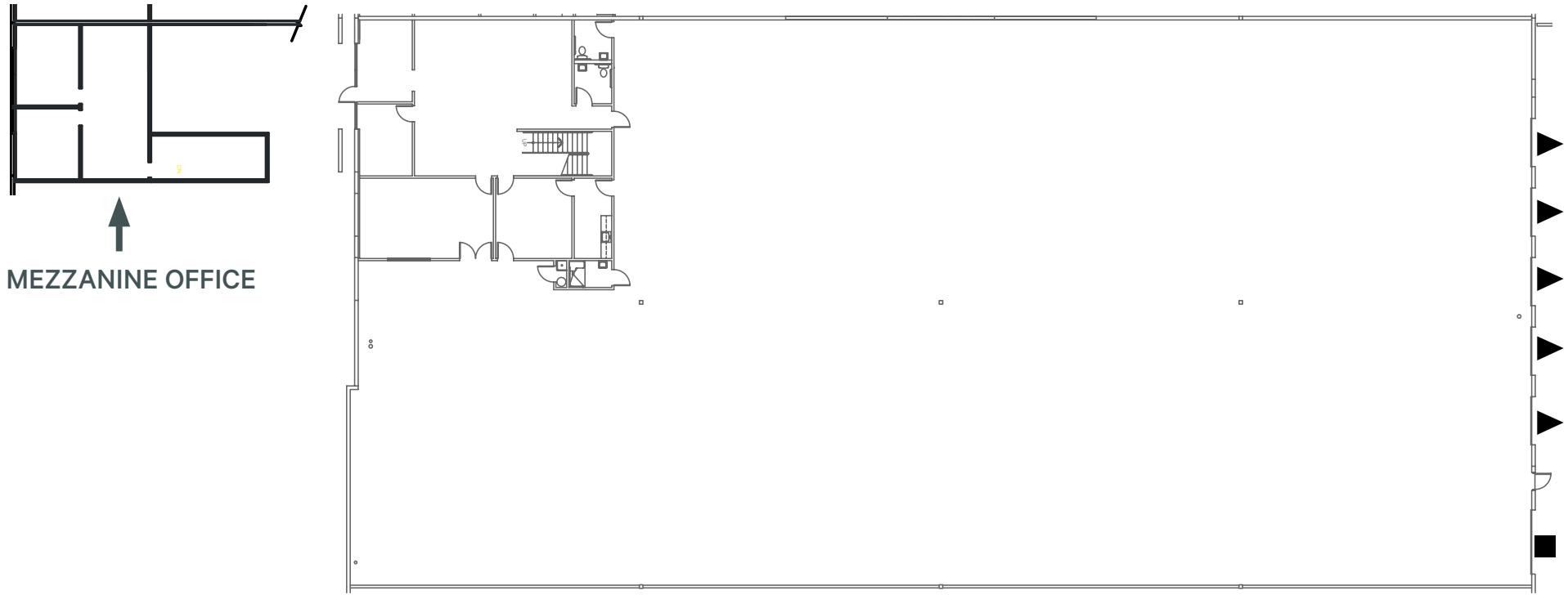

\* NOT TO SCALE

▲ DOCK ■ GRADE

# Site Plan

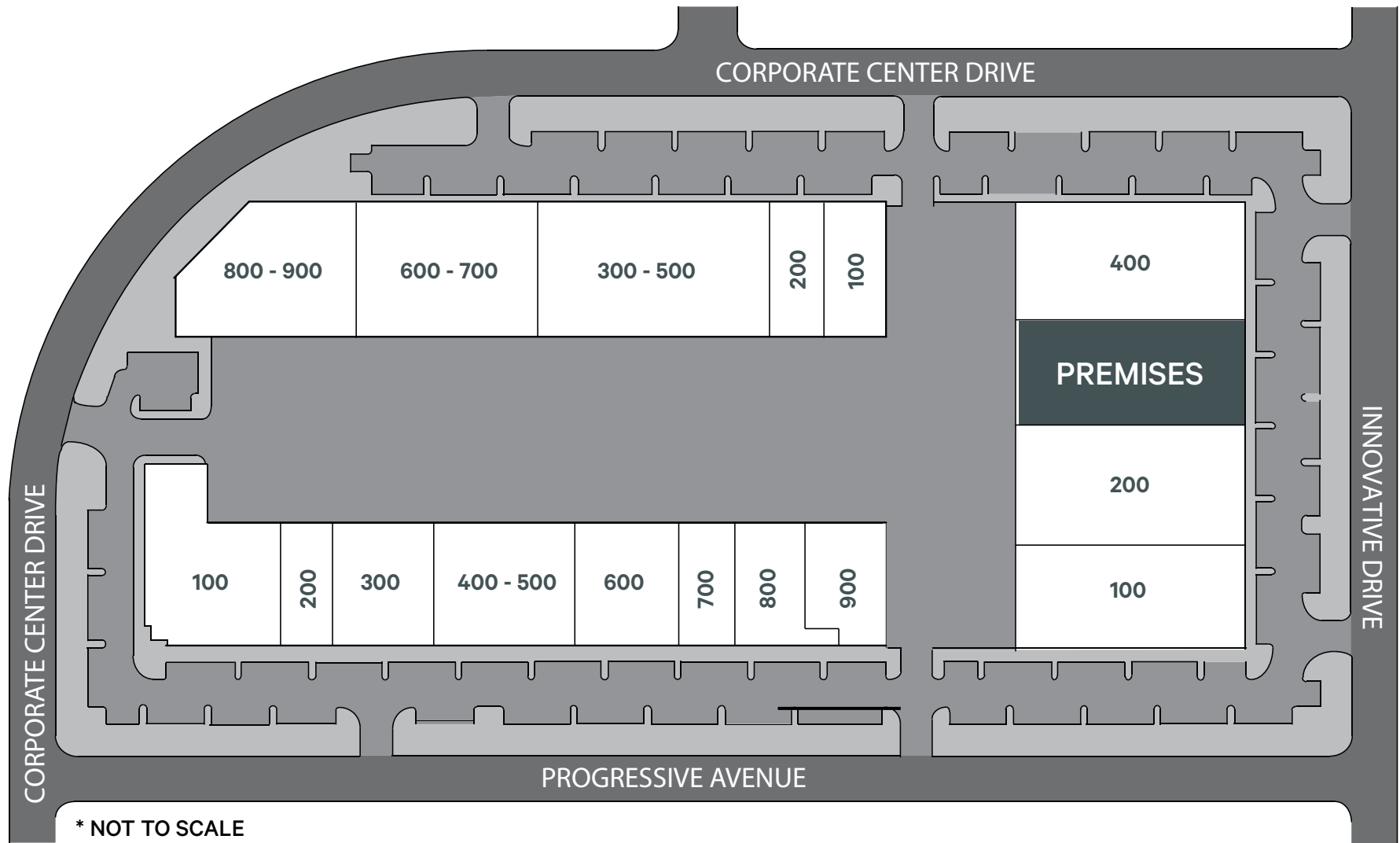



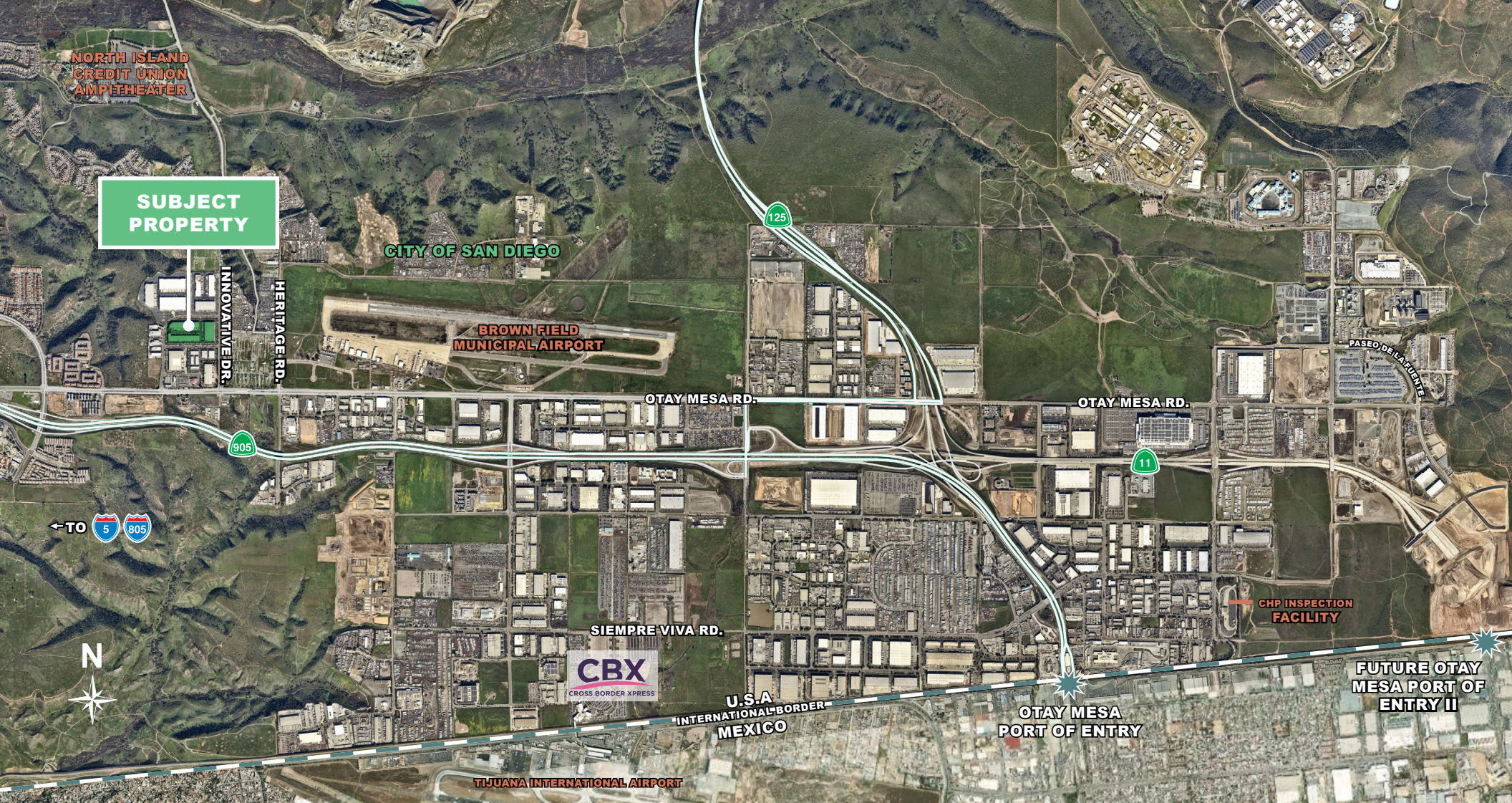

## Contact Us

**Erik Parker**  
First Vice President  
erik.parker@cbre.com  
Lic. 01315045

**CBRE, Inc.**  
4301 La Jolla Village Drive, Suite 3000  
San Diego, CA 92122  
www.cbre.com/sandiego

© 2024 CBRE, Inc. All rights reserved. This information has been obtained from sources believed reliable but has not been verified for accuracy or completeness. CBRE, Inc. makes no guarantee, representation or warranty and accepts no responsibility or liability as to the accuracy, completeness, or reliability of the information contained herein. You should conduct a careful, independent investigation of the property and verify all information. Any reliance on this information is solely at your own risk. CBRE and the CBRE logo are service marks of CBRE, Inc. All other marks displayed on this document are the property of their respective owners, and the use of such marks does not imply any affiliation with or endorsement of CBRE. Photos herein are the property of their respective owners. Use of these images without the express written consent of the owner is prohibited.

