

8620 LTC Parkway

Port St. Lucie, Florida 34986

±9,840 SF OFFICE / WAREHOUSE AVAILABLE



Property Features:

- » Class A Warehouse
- » Suite 106 — 9,840 SF
- » Available Now
- » Dock and Grade Level Loading
- » Tilt Wall Construction
- » Located in a Class A, Planned Business Park
- » Immediate Access to I-95 via Midway Road
- » 22' - 24' Clear Height
- » 3 Phase Power
- » Fully Fire Sprinklered

Contact Us

KIRK NELSON

Executive Vice President
+1 561 716 9936
kirk.nelson@cbre.com

ROBERT C. SMITH

Executive Vice President
+1 561 707 5558
robert.c.smith@cbre.com

Rental Rate — From \$14.50 NNN, \$3.67 psf opex

From ±9,840 SF Office / Warehouse Available in Port St Lucie, FL
8620 LTC Parkway | Port St Lucie, Florida 34986

For Lease

Additional Photos



From ±9,840 SF Office / Warehouse Available in Port St Lucie, FL

8620 LTC Parkway | Port St Lucie, Florida 34986

For Lease

Site Plan

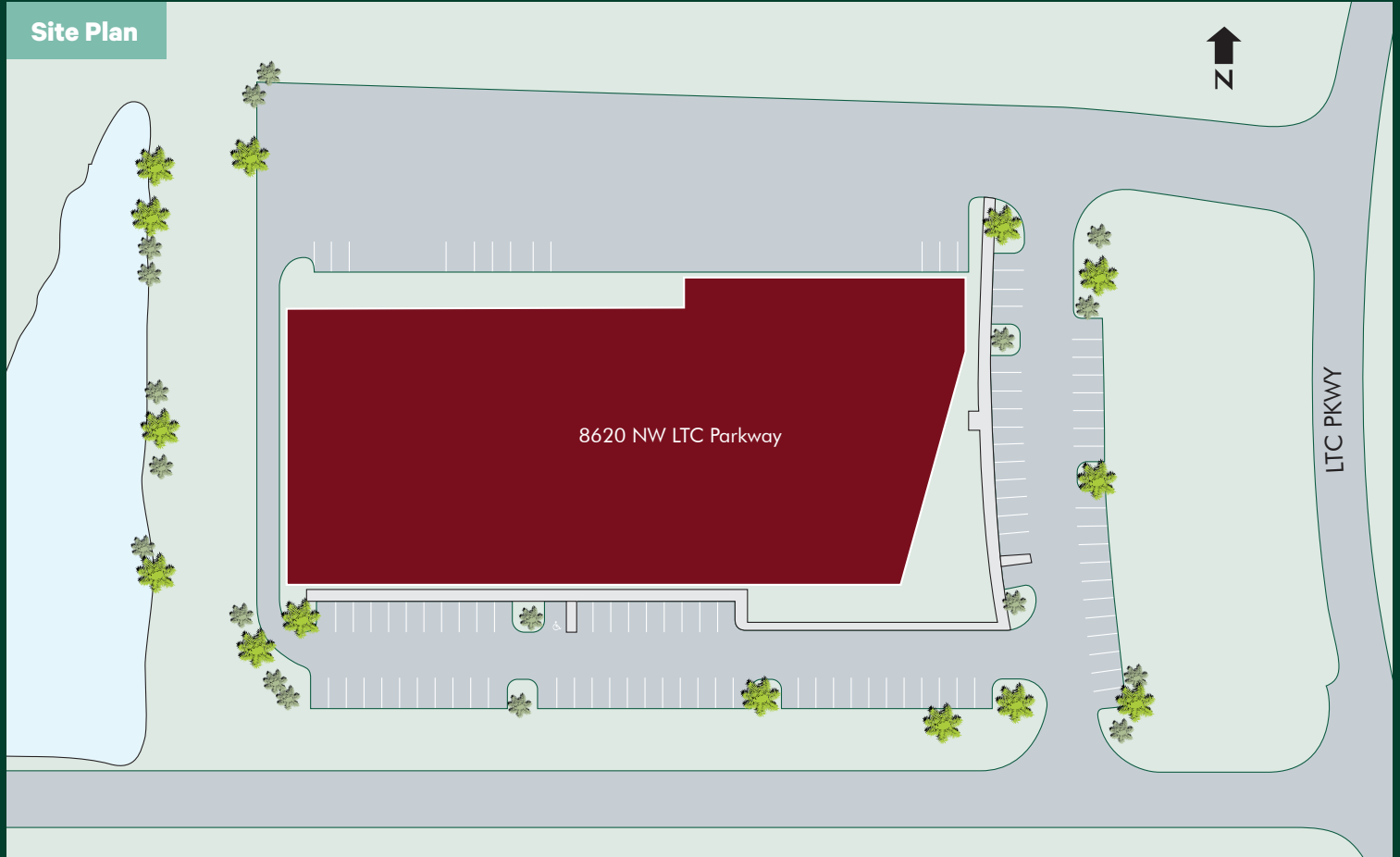

Floor Plan

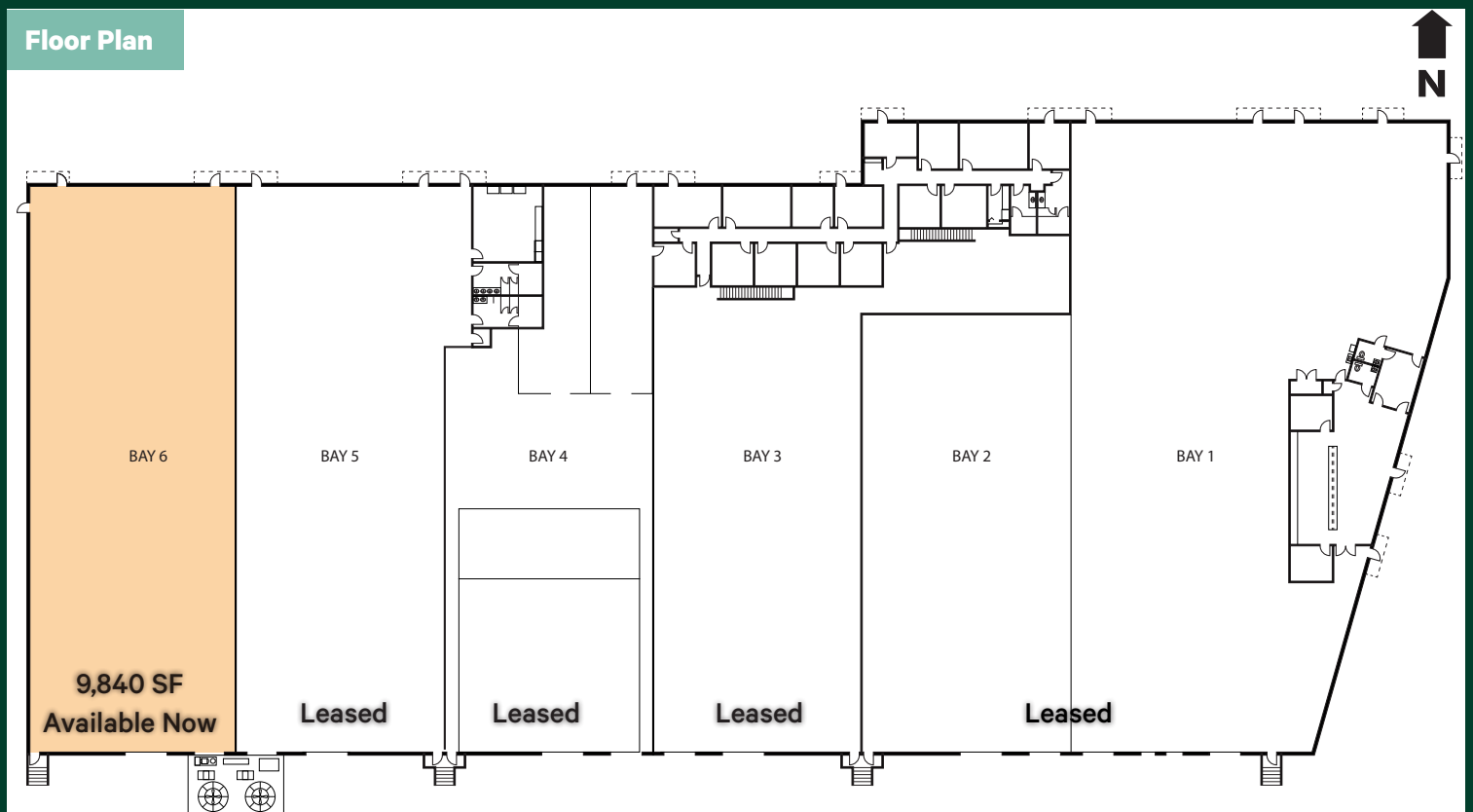

From ±9,840 SF to ±34,510 SF Office / Warehouse Available in Port St Lucie, FL
8620 LTC Parkway | Port St Lucie, Florida 34986

For Lease

Aerial Location Map



Contact Us

KIRK NELSON
Executive Vice President
+1 561 716 9936
kirk.nelson@cbre.com

ROBERT C. SMITH
Executive Vice President
+1 561 707 5558
robert.c.smith@cbre.com

© 2023 CBRE, Inc. All rights reserved. This information has been obtained from sources believed reliable, but has not been verified for accuracy or completeness. You should conduct a careful, independent investigation of the property and verify all information. Any reliance on this information is solely at your own risk. CBRE and the CBRE logo are service marks of CBRE, Inc. All other marks displayed on this document are the property of their respective owners, and the use of such logos does not imply any affiliation with or endorsement of CBRE. Photos herein are the property of their respective owners. Use of these images without the express written consent of the owner is prohibited.