

FOR SALE OR LEASE

2627 S 300 W | Salt Lake City, UT 84115



AVAILABLE

19,210 SF | \$4,295,000 Sale
\$1.40 PSF Lease

HIGHLIGHTS

- Office: 3,135 SF
- Showroom: 2,800 SF
- 50 Parking Stalls
- 22' Warehouse Clear Height
- M-1 Zoning
- 600 Amps, 280v/3-Phase Power
- 12 Grade Level Doors (12'x12')
- Secured Yard
- High Visibility
- LED Lighting
- Updated Insulation
- **1.21 Acres**

AVAILABLE JULY 1, 2026

CONTACT US

JEREMY TERRY

Vice President

801 671 9349

jeremy.terry@colliers.com

SKYLER SMITH

Senior Associate

801 946 6423

skyler.smith@colliers.com



Accelerating success.

SITE PLAN

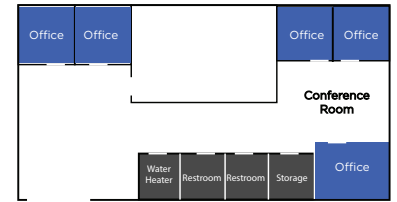
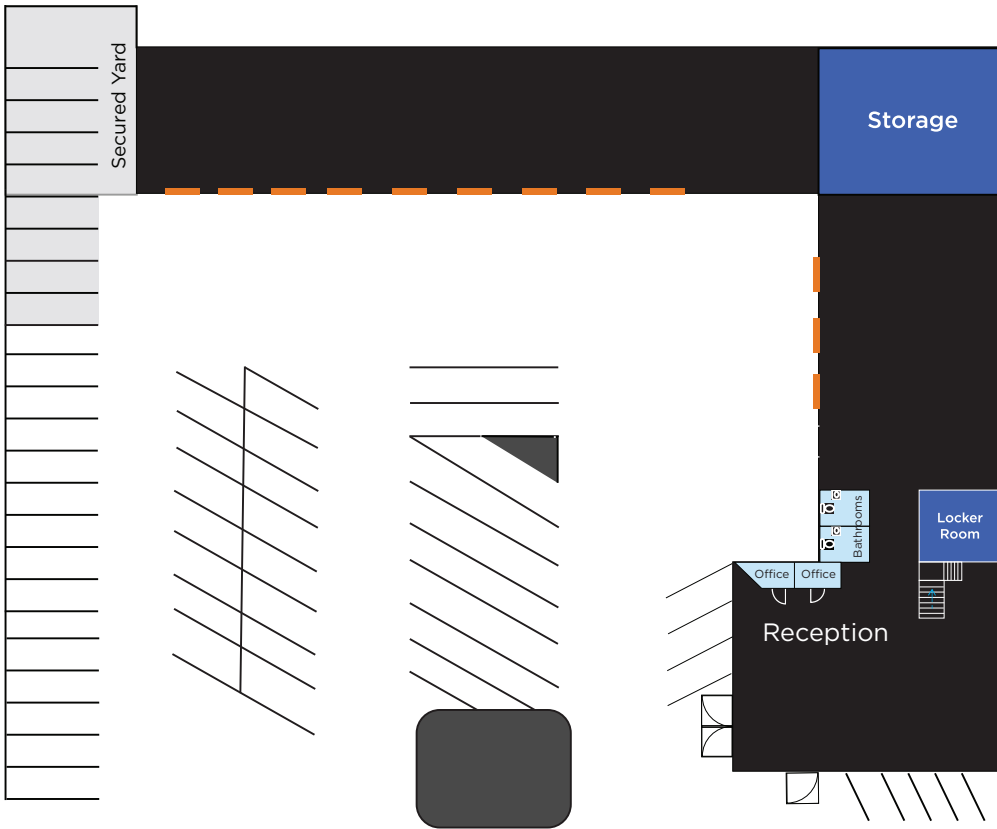

Grade Level Doors

300 WEST





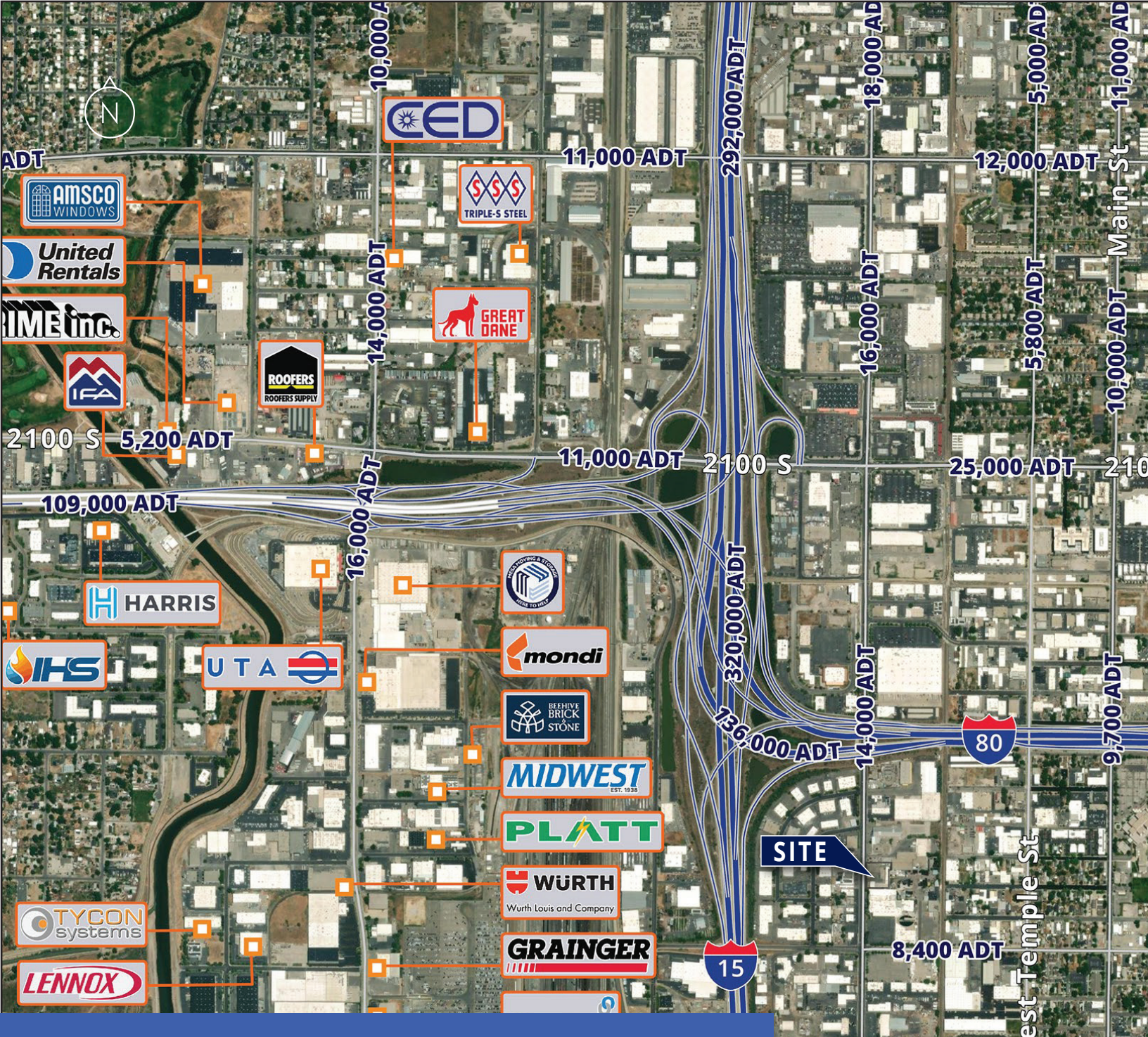

CONTACT US

Jeremy Terry

Vice President
801 671 9349
jeremy.terry@colliers.com

Skyler Smith

Senior Associate
801 946 6423
skyler.smith@colliers.com

Colliers

111 S Main Street, Suite 2200
Salt Lake City, Utah 84111



This document has been prepared by Colliers International for advertising and general information only. Colliers International makes no guarantees, representations or warranties of any kind, expressed or implied, regarding the information including, but not limited to, warranties of content, accuracy and reliability. Any interested party should undertake their own inquiries as to the accuracy of the information. Colliers International excludes unequivocally all inferred or implied terms, conditions and warranties arising out of this document and excludes all liability for loss and damages arising there from. This publication is the copyrighted property of Colliers International and/or its licensor(s). ©2026. All rights reserved.