



Full Floors and Spec Suites Available

NEWMARK

Hines



950 17th Street is centrally located with a prestigious 17th Street address and frontage on the newly completed 16th Street Mall with FreeRide connection to Union Station.

The building offers an updated lobby with modernized elevators and a new amenity floor.



26
STORIES

501,375 SF
BUILDING SIZE

1.42/1,000 SF
PARKING

20,015 SF
TYPICAL FLOOR SIZE



Secure Bike Facility



Outdoor Plaza



On-Site Food



Fitness Center



16th Street retail Access

3rd Floor 100-Person Conferencing



New Tenant Amenity Floor





18 Seat Boardroom



Pre-Function



Community Kitchen

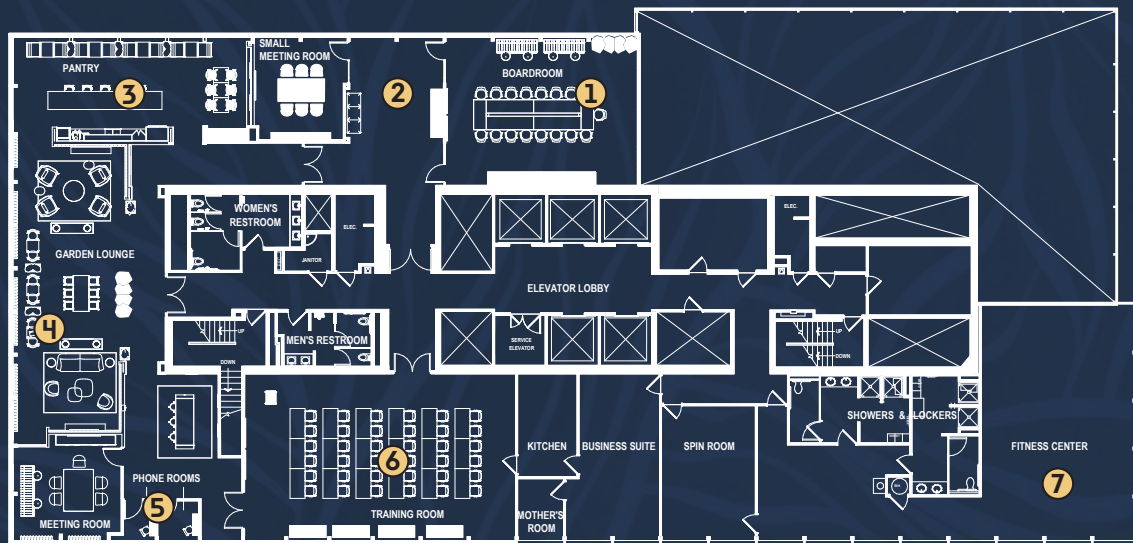

64 Seat Training Room



Fitness Center

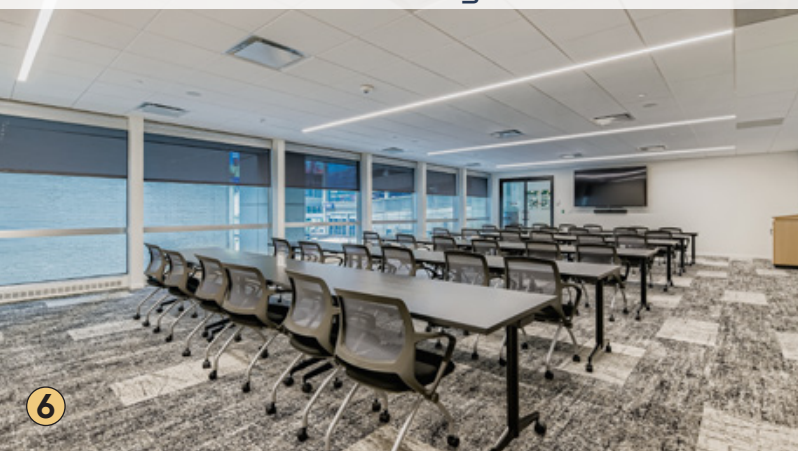

16th Street Improvements Complete!



Convenient Neighborhood Amenities



Walk Score

98



Transit Score

87



Bike Score

93





Newly delivered spec
suites offering Class
AA finishes





For Leasing contact:

Jamie Gard jamie.gard@nmrk.com 303-260-4341

Jeff Castleton jeff.castleton@nmrk.com 303-260-4391

NEWMARK

nmrk.com

Hines

hines.com

The information contained herein has been obtained from sources deemed reliable but has not been verified and no guarantee, warranty or representation, either express or implied, is made with respect to such information. Terms of sale or lease and availability are subject to change or withdrawal without notice.