

FREMONT

LAKE UNION CENTER

Plaza Building: 701 N 34th St | Seattle WA 98103

2nd Floor: 31,840 SF Sublease



COLLIERS INTERNATIONAL
601 Union St, Suite 5300
Seattle, WA, 98101
www.colliers.com

Connor McClain
Senior Vice President
(425) 785-5660
connor.mcclain@colliers.com

Joe Conner
Associate
(425) 698-7142
joe.conner@colliers.com



FREMONT
LAKE UNION CENTER
Plaza Building

Fremont Bridge

Burke-Gilman Trail

THE TRUE WORK- PLAY ADDRESS

- Expiration 6/30/2027
- Full 2nd Floor: 31,840 SF
- Furniture available
- 2.3/1,000 SF Parking
- On-site secure bike storage and locker rooms with showers
- Conveniently located near Hwy 99, with direct access to major bus routes
- Direct access to the 27-mile long Burke-Gilman Trail, connecting cyclists from North Puget Sound to the Ballard and Fremont neighborhoods



High-end Kitchen



High Ceilings

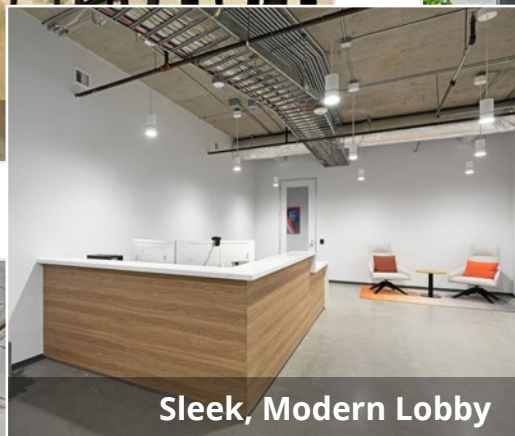

Sleek, Modern Lobby

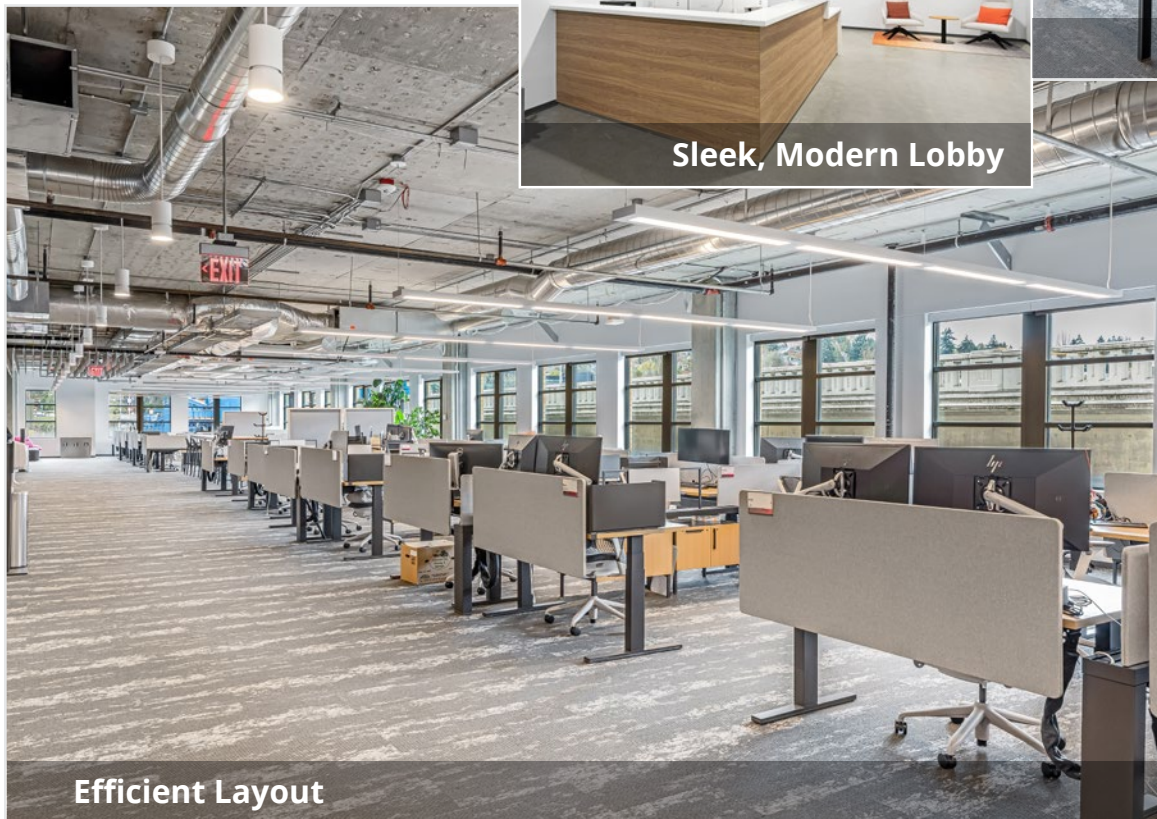

Efficient Layout



Conference Room

Plaza Building

2nd Floor: 31,840 SF

Expiration 6/30/2027

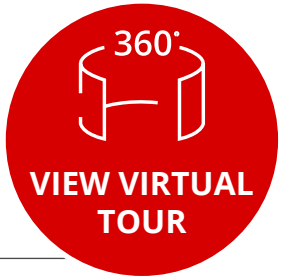

Layout

- 229 workstations
- 21 conference rooms
- 1 large conference room (fits 40+ people)
- 13 call rooms
- 1 large kitchen
- 1 mother room

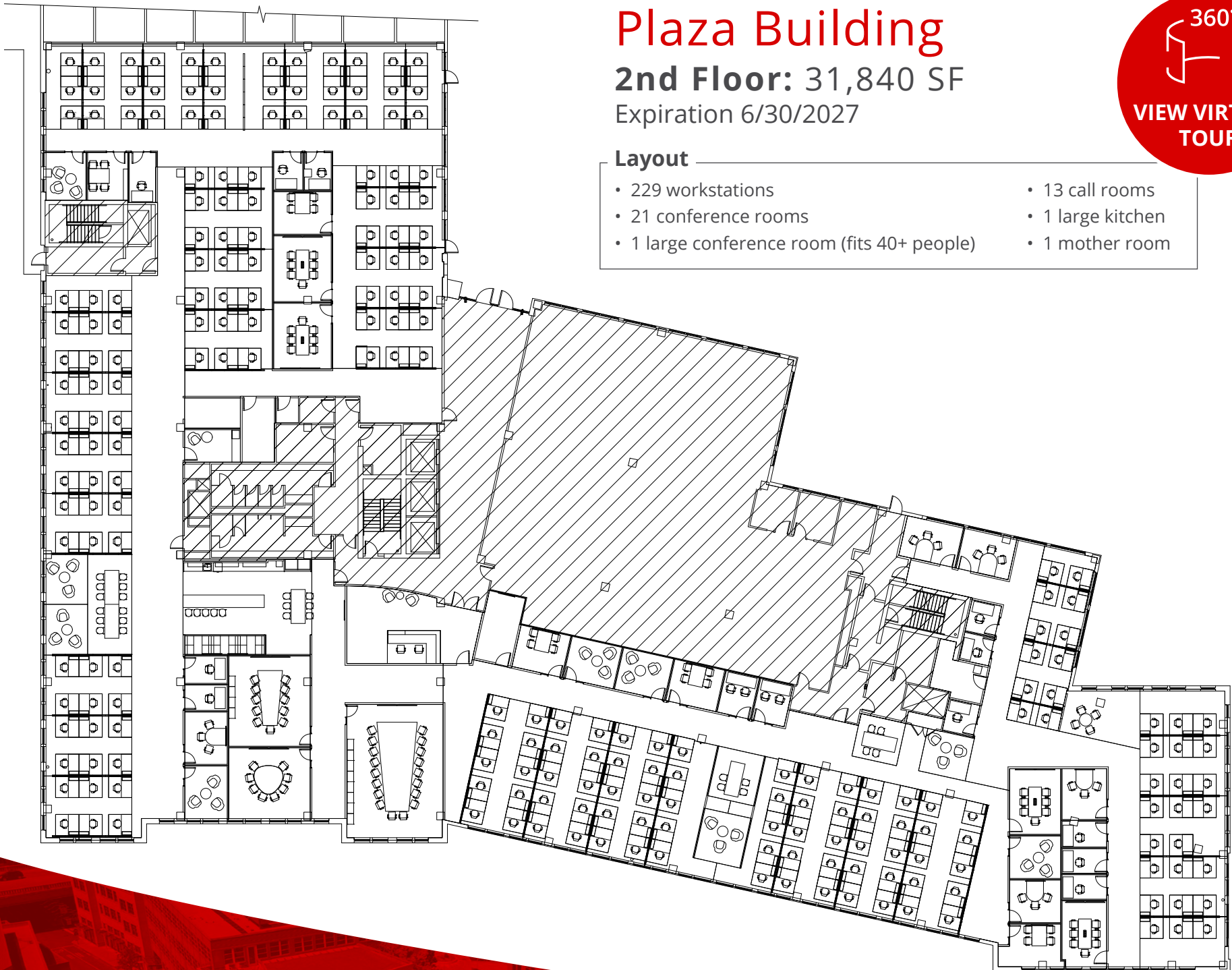

FREMONT - THE CENTER OF THE UNIVERSE

10 Minutes
to UW Campus

10 Minutes
to Seattle CBD

25 Minutes
to Bellevue CBD



Gas Works Park

Pablo y Pablo

The Whal Wins

Joule

Fiasco

Fremont Brewing

Cafe Turko

Just Burgers

Evergreens

Milstead Coffee

Kamakura

Fainting Goat Gelato

Kin Len Thai

Jai Thai

Pel Meni Dumpling

MOD Pizza

Eve Fremont

Red Star Taco

Triangle Spirits

Starbucks

Nuna Ramen

El Camino

PCC

Fremont Coffee Co.

The Barrel Thief

Brouwer's Cafe

Theo Chocolate



FREMONT

LAKE UNION CENTER

Plaza Building: 701 N 34th St | Seattle WA 98103

2nd Floor: 31,840 SF Sublease



COLLIERS INTERNATIONAL
601 Union St, Suite 5300
Seattle, WA, 98101
www.colliers.com

Connor McClain
Senior Vice President
(425) 785-5660
connor.mcclain@colliers.com

Joe Conner
Associate
(425) 698-7142
joe.conner@colliers.com