

31,141 SF on 3.38 Acres



For Lease/For Sale

# 234 E MOHAVE STREET

PHOENIX, AZ

**Chris McClurg, SIOR**  
Principal  
602.954.3766  
cmcclurg@leearizona.com

**Ken McQueen**  
Principal  
602.474.9564  
kmcqueen@leearizona.com

**Blake Peters**  
Principal  
602.619.3970  
bpeters@leearizona.com

**Jack Sims**  
Associate  
602.618.9245  
jsims@leearizona.com

 **LEE & ASSOCIATES**  
COMMERCIAL REAL ESTATE SERVICES



# PROPERTY OVERVIEW



## SUMMARY

*234 E. Mohave Street is an industrial property in a prime central Phoenix location, providing strong access throughout the metro area. Positioned west of Sky Harbor Airport and just north of I-17, the 3.88-acre site includes a metal building originally constructed in 1983, along with a freshly paved, secured, enclosed yard. The improvements offer roughly 5,000 square feet of office buildout in addition to approximately 26,141 square feet of manufacturing/warehouse space, supporting a variety of operational needs.*

- Great location for an owner user/tenant
- Approximately  $\pm 1.5$  - 2 acre yard
- Abundant power ( $\pm 1,600$  Amps/3 Phase)
- Centralized location to Metro Phoenix



# PROPERTY FEATURES

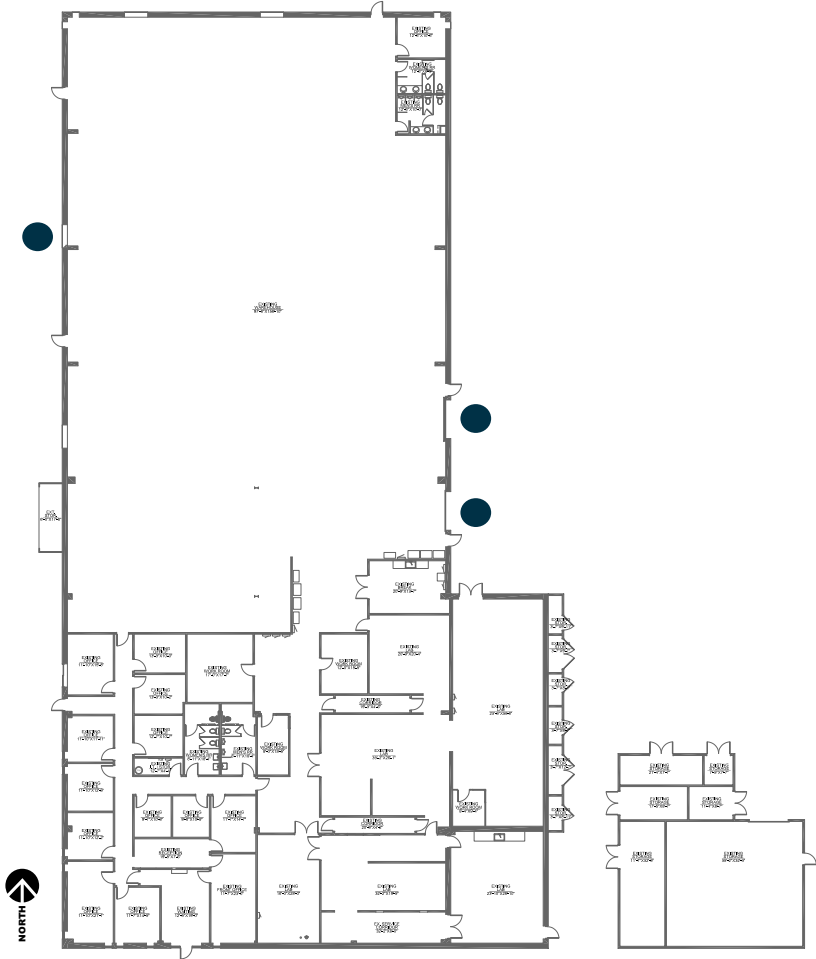

● - Grade Level

  
BUILDING SIZE:  
**±31,141 SF**

  
LOT SIZE:  
**±3.88 Acres**

  
OFFICE:  
**±5,000 SF**

  
POWER:  
**1,600 Amps/  
3 Phase**

  
LOADING:  
**(2) 10' x 10' Grade Level  
(1) 14' x 12' Grade Level**

  
PARKING:  
**±46 Spaces**

  
ZONING  
**A-1,  
City of Phoenix**

  
CLEAR  
HIEGHT:  
**15'8"**

  
BUILDING TYPE:  
**Metal Clear Span**

  
YEAR BUILT:  
**1983**





# PROPERTY PHOTOS





# PROPERTY LOCATION

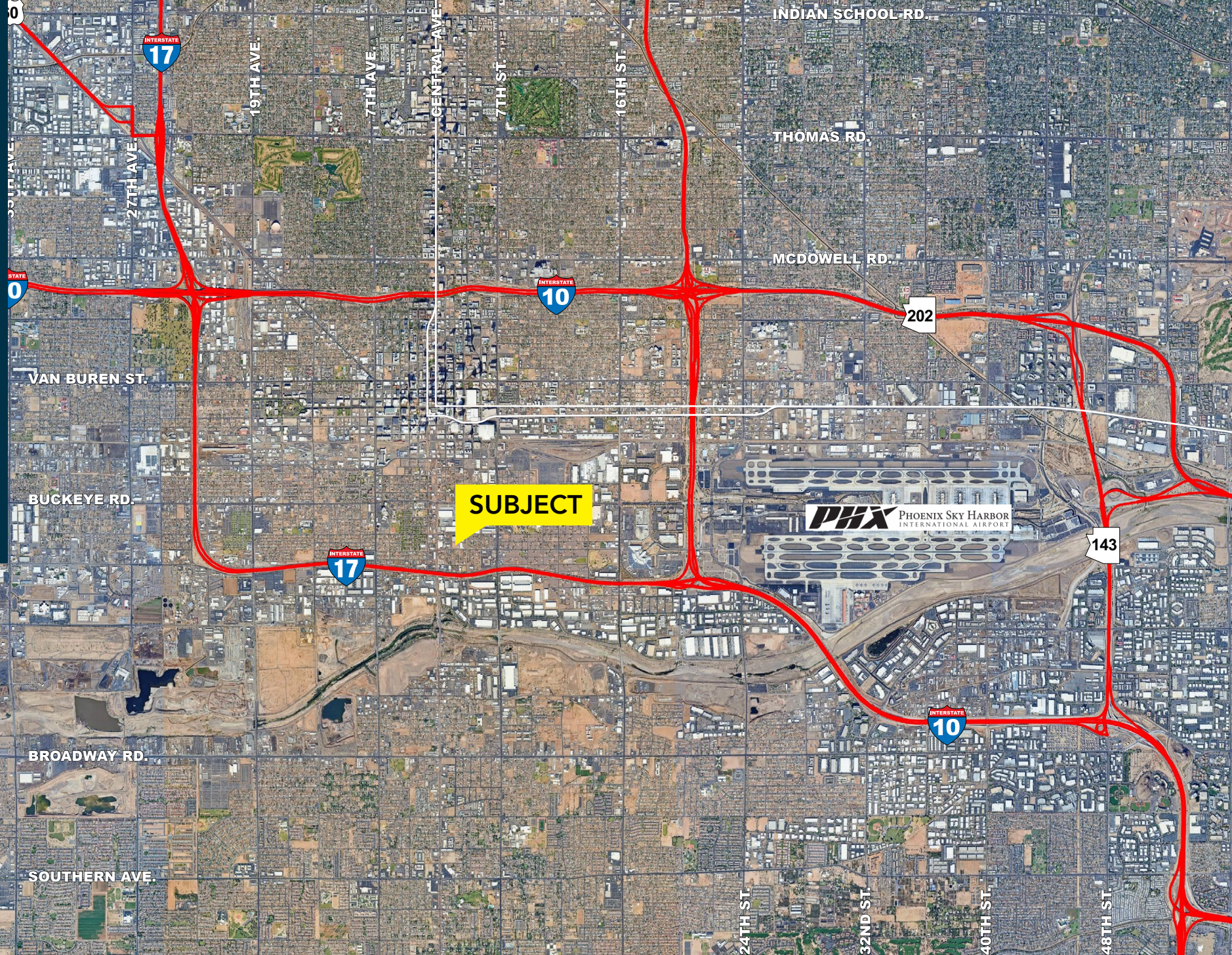

ALL INFORMATION FURNISHED REGARDING PROPERTY FOR SALE, RENTAL OR FINANCING IS FROM SOURCES DEEMED RELIABLE, BUT NO WARRANTY OR REPRESENTATION IS MADE TO THE ACCURACY THEREOF AND SAME IS SUBMITTED TO ERRORS, OMISSIONS, CHANGE OF PRICE, RENTAL OR OTHER CONDITIONS PRIOR TO SALE, LEASE OR FINANCING OR WITHDRAWAL WITHOUT NOTICE. NO LIABILITY OF ANY KIND IS TO BE IMPOSED ON THE BROKER HEREIN.