

# Executive Suite Offices & Co-Workin.



Presented By:  
ATLANTA COMMERCIAL REAL ESTATE BROKERS, LLC

Woodstock Holly Spgs, Canton, GA 30114



# Executive Suite Offices & Co-Working Space

Woodstock Holly Spgs, Canton, GA 30114

## Property Details

Individual offices for lease. Our private offices offer a variety of private offices with or without desks/furniture. A wide range of sizes and configurations to choose from with rents ranging from \$399 to \$650 per month depending on office configuration. Shared reception area, kitchen break room, access to conference/meeting area, elevator access, and convenient building parking. High-Speed WiFi, utilities, common area janitorial, and maintenance are all included in the base monthly rent. Business solutions for flexible individual offices short to long-term leases in a shared business, financial, and medical services environment.

### Price: Upon Request

- Business solutions for flexible individual offices short to long-term leases in a shared business, financial, and medical services environment.
- Individual offices are now available rents starting at \$399 to \$650 per month. Rents include all utilities, Wi-Fi, and common area cleaning.
- Our private offices offer a variety of private offices with or without desks/furniture.
- 24 Hour access - elevator access, shared kitchen area, reception area
- Short term leases available- no upfront security deposits - no buildout costs
- A wide range of sizes and configurations to choose.

View the full listing here: <https://www.loopnet.com/Listing/Woodstock-Holly-Spgs-Canton-GA/4209299/>

Rental Rate:	Upon Request
Min. Divisible:	88 SF
Property Type:	Office
Property Subtype:	Medical
Building Class:	B
Rentable Building Area	14,000 SF
:	
Year Built:	2008
Rental Rate Mo:	Upon Request

# Executive Suite Offices & Co-Working Space

Woodstock Holly Spgs, Canton, GA 30114

## Listing spaces

### 2nd Floor Ste 220

Space Available:	88 - 210 SF
Rental Rate:	Upon Request
Date Available:	Now
Service Type:	Negotiable
Built Out As:	Standard Office
Space Type:	Relet
Space Use:	Office
Lease Term:	Negotiable

### 2nd Floor Ste 220-240

Space Available:	120 - 210 SF
Rental Rate:	Upon Request
Date Available:	Now
Service Type:	Negotiable
Built Out As:	Standard Office
Space Type:	Relet
Space Use:	Office
Lease Term:	Negotiable

# **Executive Suite Offices & Co-Working Space**

Woodstock Holly Spgs, Canton, GA 30114

Location

# Executive Suite Offices & Co-Working Space

Woodstock Holly Spgs, Canton, GA 30114

## Property Photos



Primary Photo



Other



# Executive Suite Offices & Co-Working Space

Woodstock Holly Spgs, Canton, GA 30114

## Property Photos



Interior



Interior Photo

# Executive Suite Offices & Co-Working Space

Woodstock Holly Spgs, Canton, GA 30114

## Property Photos



Sixes Suite 201 IMG\_0776



Elevators

# Executive Suite Offices & Co-Working Space

Woodstock Holly Spgs, Canton, GA 30114

## Property Photos

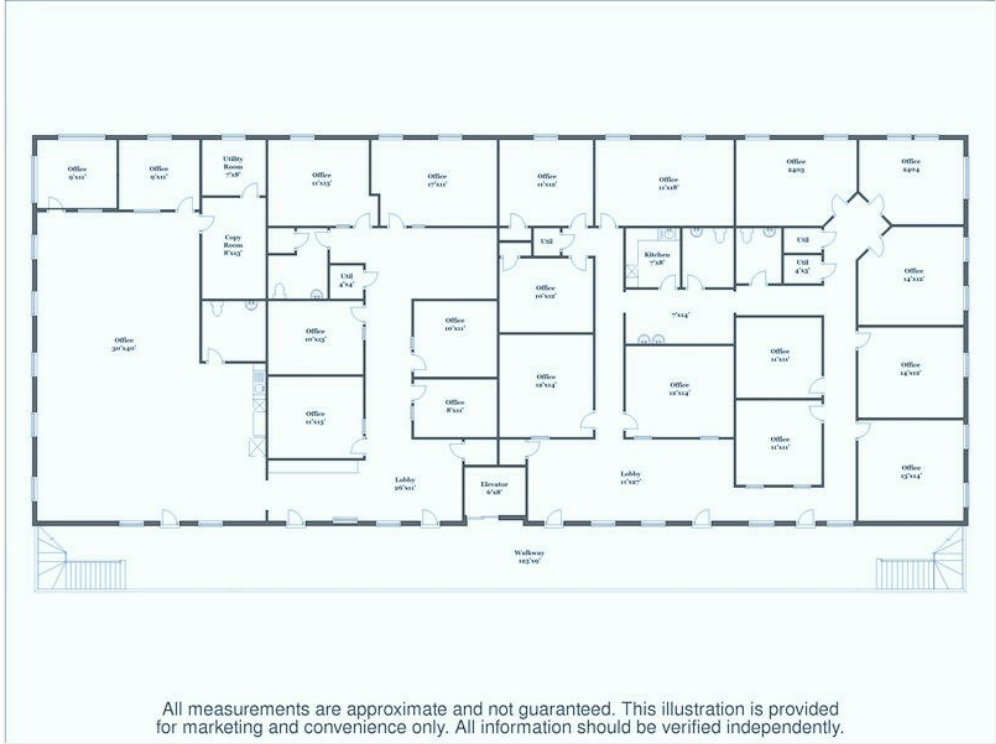

Sixes Upper-f125115



# Executive Suite Offices & Co-Working Space

Woodstock Holly Spgs, Canton, GA 30114



**Dan Gentz**

[dangentz@gmail.com](mailto:dangentz@gmail.com)

(770) 309-1204

**ATLANTA COMMERCIAL  
REAL ESTATE BROKERS,  
LLC**

3113 Roswell Rd, Suite 101  
Marietta, GA 30062

