



COMING SOON!

AVAILABLE
±2,366 RSF
(2,275 USF)



4209-4213

FIRST STREET | LIVERMORE, CA

retailwest

RETAIL WEST

HILARY PARKER

925.400.9930 ext 700

hparker@retailwestinc.com

DRE 01760862



JOIN THESE TENANTS & MORE:



4209-4213

FIRST STREET | LIVERMORE, CA

- ±2,366 SF for lease next to Dave's Hot Chicken
- Stand-alone pad building at First Street (31,153 ADT) & Mines Road (20,037 ADT)
- Co-tenants include Lowe's, Panda Express, Great Clips & Subway
- Adjacent to busy Safeway anchored Arroyo Park Shopping Center (15th busiest Safeway in California)
- Easy access to I-580 (201,163 CPD)



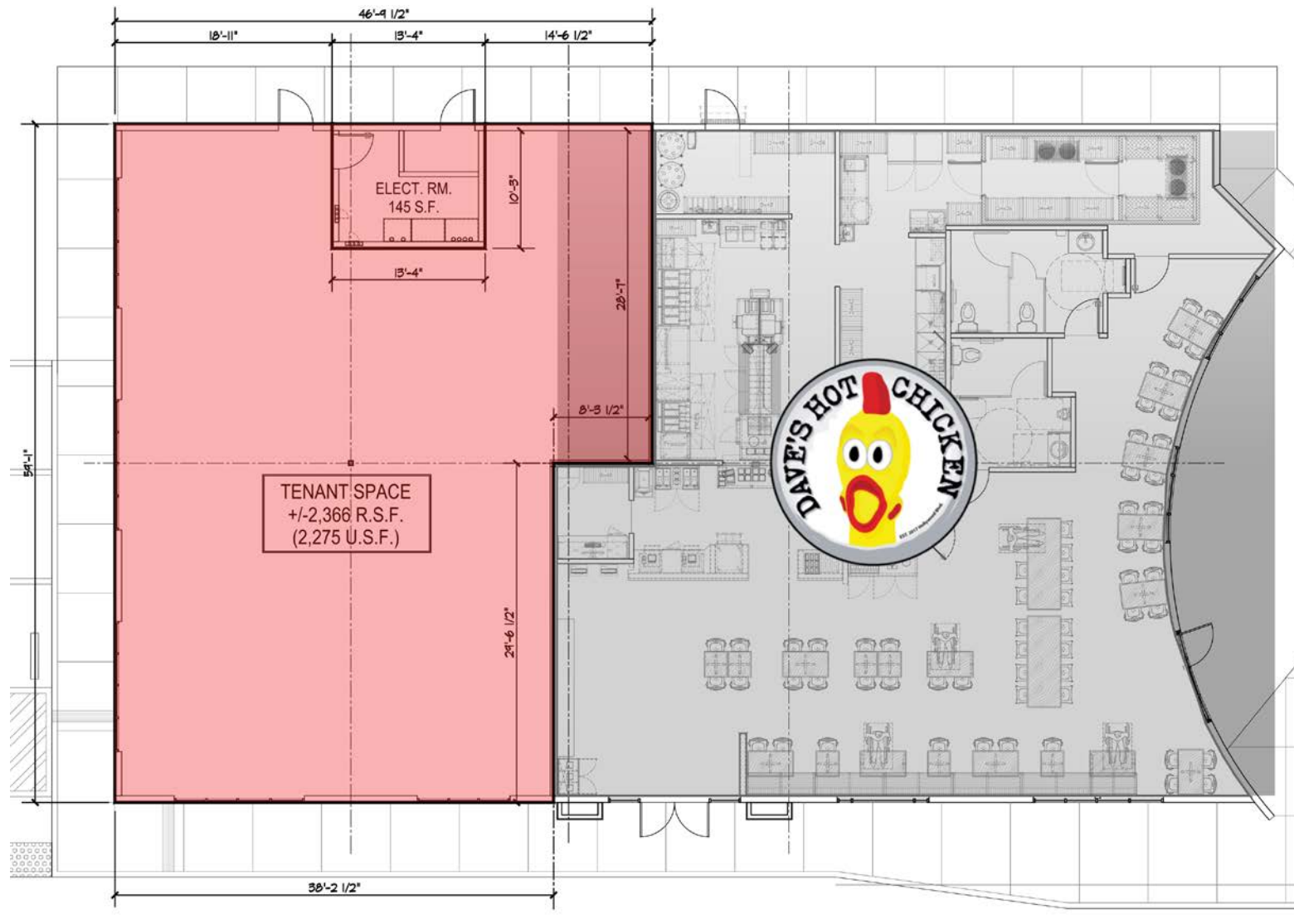

2025 DEMOGRAPHIC HIGHLIGHTS

\$1.04M

MEDIAN
HOME VALUE
(within 1 mile)

+48K

DAYTIME
EMPLOYEES
(within 5 miles)

\$197K

AVG. HH
INCOME
(within 1 mile)



201,163 ADT

36,588 ADT

PLAZA 580

TARGET

ROSS
DRESS FOR LESS

TJ-maxx

PETCO

BIG LOTS

DOLLAR TREE

BIG 5
SPORTING GOODS

FedEx Office

crumbl
cookies

BOOT BARN

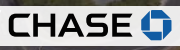

PANDA EXPRESS

Great Clips

SUBWAY

SAFEWAY

1.9 Million
annual visits

LOWE'S

691K
annual visits



SITE

retailwest





Neighboring tenant Chili's



Neighboring tenants



Anchored by Lowe's





Arthur H. Breed, Jr. 201,163 ADT



John P. Miller Memorial Hwy

ARROYO PLAZA

Walmart  

OfficeMax 

KOHL'S

PLAZA 580

TARGET  ROSS
DRESS FOR LESS

TJ-maxx  PETCO  BIG LOTS!

 DOLLAR TREE  BIG 5  SEPHORA

ARROYO SECO

  Panera BREAD

 IHOP

SITE

ARROYO PARK

 LOWE'S  SAFEWAY

 BevMo!  CVS pharmacy

 PANDA EXPRESS  Starbucks  Santitas

TRADER JOE'S

Michaels

SAFEWAY 

 PETCO  CVS pharmacy

PEPPERTREE PLAZA

NOB HILL.
FOODS

retailwest

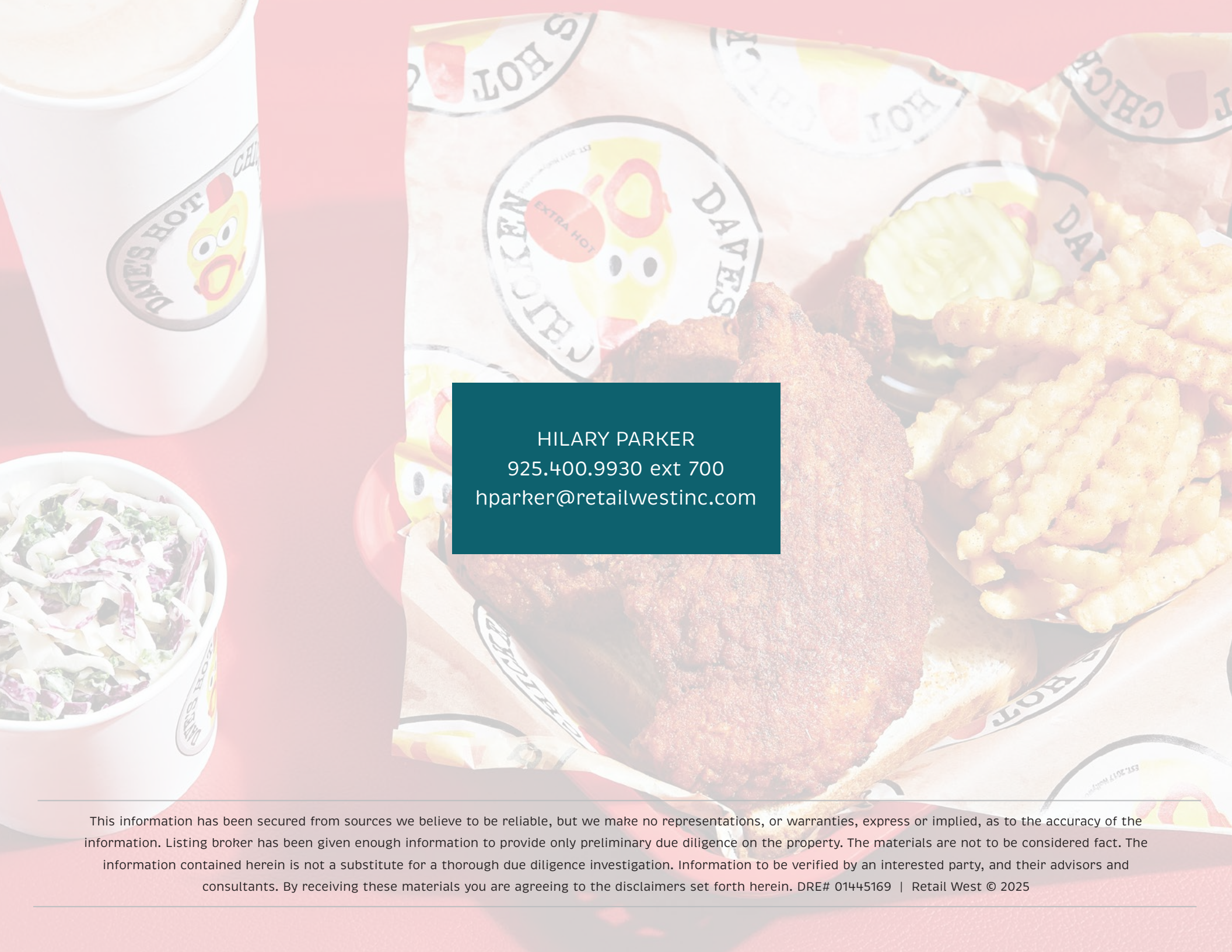

HILARY PARKER
925.400.9930 ext 700
hparker@retailwestinc.com

This information has been secured from sources we believe to be reliable, but we make no representations, or warranties, express or implied, as to the accuracy of the information. Listing broker has been given enough information to provide only preliminary due diligence on the property. The materials are not to be considered fact. The information contained herein is not a substitute for a thorough due diligence investigation. Information to be verified by an interested party, and their advisors and consultants. By receiving these materials you are agreeing to the disclaimers set forth herein. DRE# 01445169 | Retail West © 2025