

TOWN & COUNTRY MARKETPLACE

39 Town & Country Drive | Fredericksburg, VA

RETAIL FOR LEASE / PAD SITE FOR GROUND



Sharon Schmidt

Senior Associate | 540 322 4155
sharon.schmidt@thalhimer.com

PROPERTY FEATURES

- 87,306 SF Giant grocery anchored center with Giant 10-bleand gas station
- **1,200 SF retail space available**
- Two pad sites available for ground lease/sale: 1.015-acre parcel to the right of Nextcare Urgent Care & 1.351 AC to the left of the monument sign
- Zoned B-2
- Pylon signage available
- Located in Stafford County along Route 218, one of the fastest growing counties

TOWN & COUNTRY MARKETPLACE

39 Town & Country Drive | Fredericksburg, VA

JOIN TENANTS:



SPECIFICATIONS

Total Size: 87,306 SF

Available: 105: 1,200 SF

Pad Site 1: 1.015 AC

Pad Site 2: 1.351 AC

Lease Rate: \$24.00 PSF NNN (NNN = \$3.90)



NEIGHBORHOOD DEMOGRAPHICS



POPULATION



MEDIAN HOUSEHOLD INCOME



DAYTIME POPULATION

1 Mile

5,544

\$132,769

4,259

3 Miles

39,445

\$127,149

41,645

5 Miles

81,448

\$123,423

87,695

TOWN & COUNTRY MARKETPLACE

39 Town & Country Drive | Fredericksburg, VA

SITE PLAN



SUITE #	TENANT	SF
35	GIANT	SF
101	GOODWILL	10,228SF
103	GOODWILL	-
101A	UNIT B BQ	1,800 SF
105	VACANT	1,200 SF
107	TOBACCO & VAPE	1,200 SF
109	TOP CHEF	1,200 SF
111	WARHAMMER	1,200 SF
113	MASTER HA'S TAE KWON DO	1,200 SF
115	3 STARS CLEANERS	2,400 SF
119	THE UPS STORE	1,200 SF
121	HAIR CUTTERY	1,200 SF
123	TOP TEN NAILS	1,200 SF
125	VA ABC	2,666 SF

TOWN & COUNTRY MARKETPLACE

39 Town & Country Drive | Fredericksburg, VA

PAD SITE PLAN

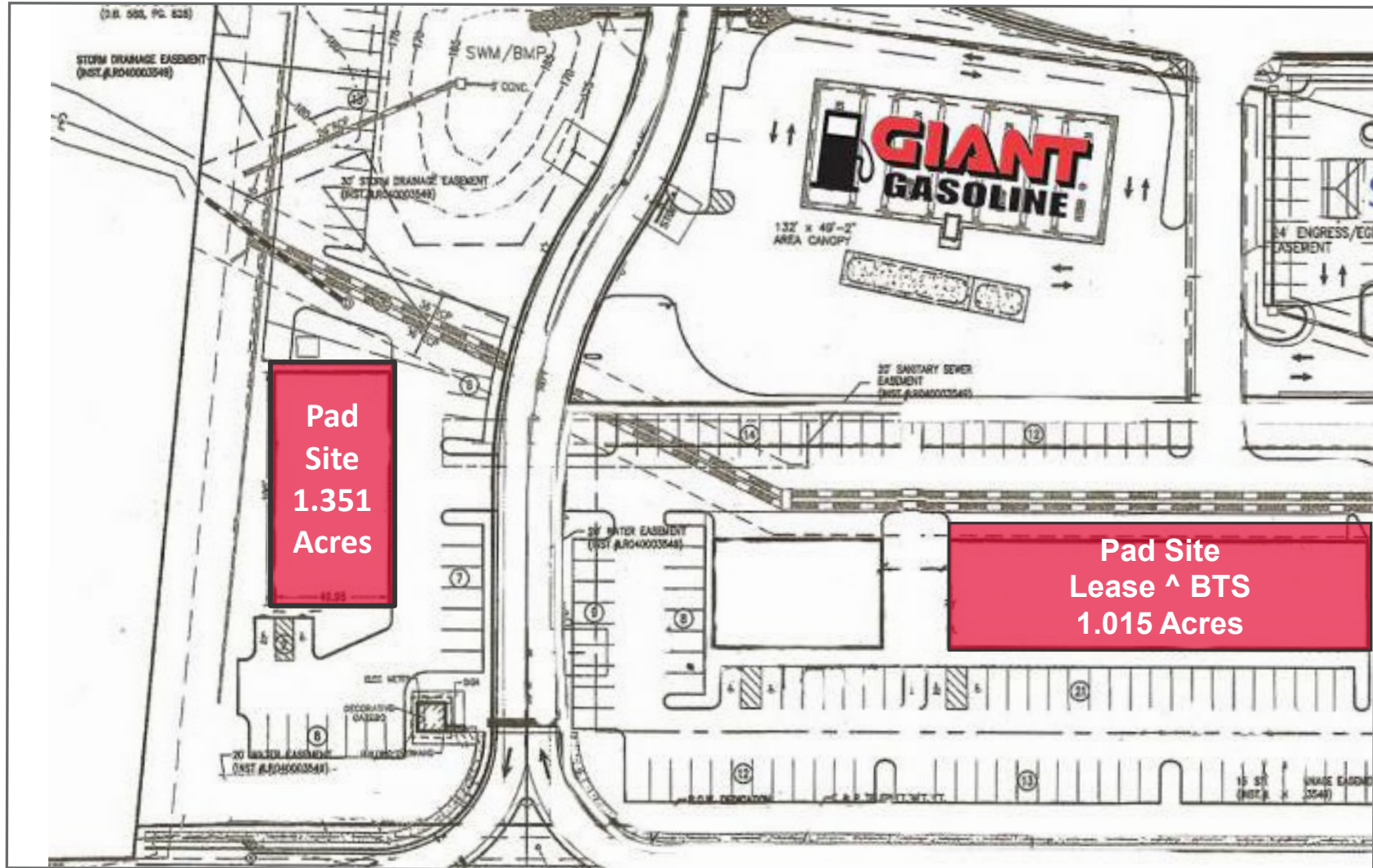

TOWN & COUNTRY MARKETPLACE

39 Town & Country Drive | Fredericksburg, VA



Sharon Schmidt

Senior Associate | 540 322 4155
Sharon.schmidt@thalhimer.com

1125 Emancipation Hwy. | Suite 350
Fredericksburg, VA 22401
www.thalhimer.com

Independently Owned and Operated / A Member of the Cushman & Wakefield Alliance

Cushman Wakefield | Thalhimer ©2023. No warranty or representation, express or implied, is made to the accuracy or completeness of the information contained herein, and same is submitted subject to errors, omissions, change of price, rental or other conditions, withdrawal without notice, and to any special listing conditions, imposed by the property owner(s). As applicable, we make no representation as to the condition of the property (or properties) in question.