

THE CROSSING AT KAPOELI BUSINESS PARK WEST

FOR SALE

📍 91-1965 Lauwiliwili Street, Units C-101 & 102, Kapolei, Hawai'i 96707



INDUSTRIAL
GROUP HAWAII



SIOR



PROPERTY HIGHLIGHTS

SIZE: 7,286 SF

PARKING AREA: 9 Reserved Stalls

ZONING: I-2 (Intensive Industrial)

POWER: Industrial Electrical Power
(HECO)

TENURE: Fee Simple

TMK: (1) 9-1-175-012

CONSTRUCTION: Concrete tilt-up

FIRE
PROTECTION: Fully sprinkled

LOADING: 3 Grade-level roll-up
doors + personnel doors

SPACE AVAILABLE: 7,286 Square Feet

ASKING PRICE: \$3,900,000



PROPERTY DESCRIPTION

An exceptional opportunity to own the only free-standing condominium building within The Crossing at Kapolei Business Park West—West O'ahu's newest industrial condominium project. Building C offers flexibility for owner-users or investors, with the ability to occupy as a single space or demised into two units (Units 101 & 102).

Constructed with concrete tilt-up design, the property features approximately 28' clear height, industrial electrical power provided by HECO, fully sprinkled fire protection, and ample on-site parking. Delivered in shell condition, Building C is ready for customization to suit your operational needs.



SITE PLAN

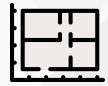

FIRST FLOOR

BUILDING C

7,286 SF

C101

2,880 SF

C102

4,406 SF

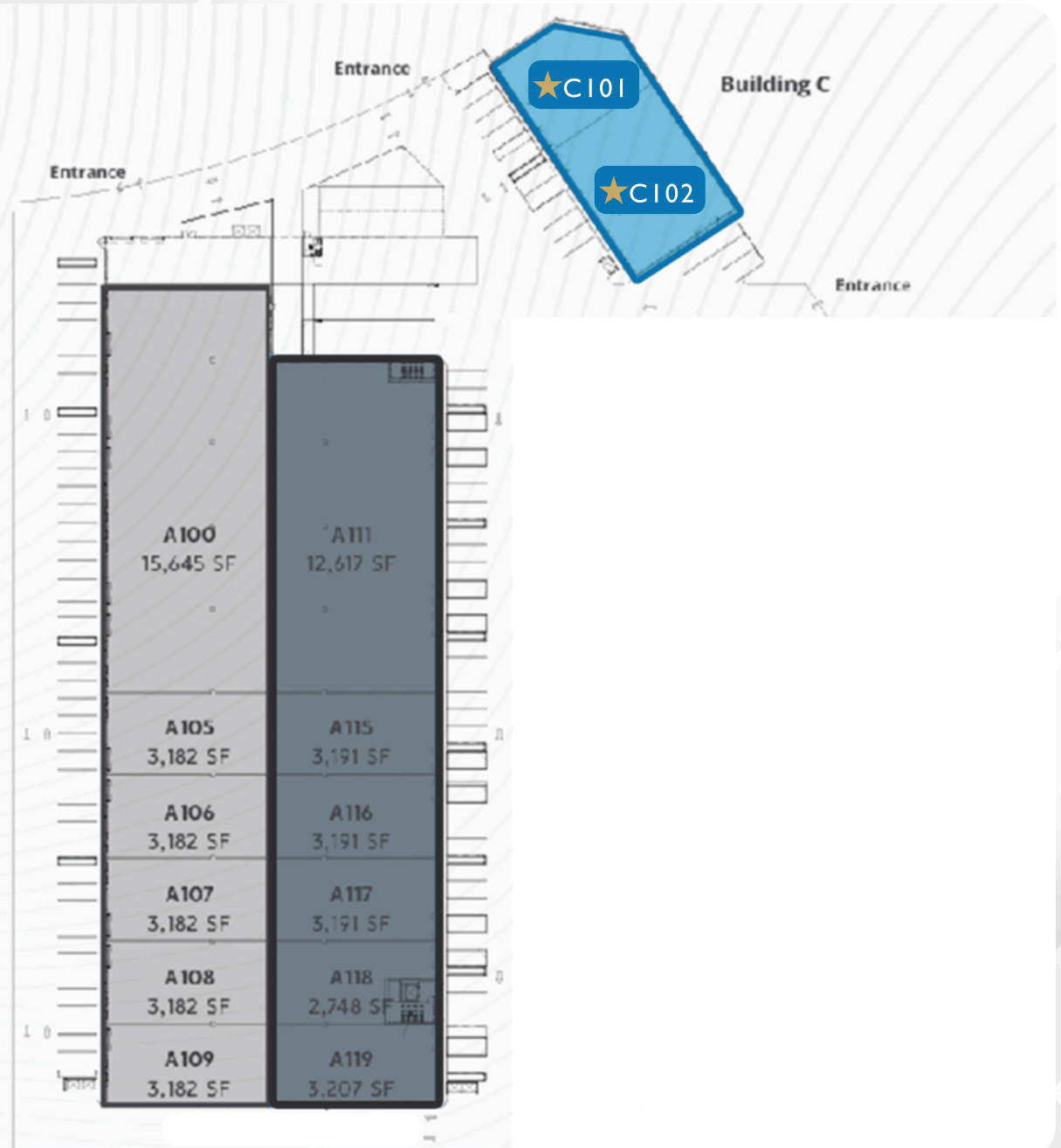



JAY K. ELICKER, (B) CCIM, SIOR
 Partner - Industrial Services · RB-21204
 (808) 218-8318
jelicker@caahawaii.com



SEAN K. DO, (S) CCIM
 Vice President · RS-75040
 (808) 387-6903
sdo@caahawaii.com



KEVIN KO (S)
 Senior Associate · RS-82504
 (808) 971-1986
kko@caahawaii.com

All information contained herein is obtained from sources deemed reliable. However, no representation or guarantee is made as to the accuracy thereof and is subject to errors, omissions, changes, or withdrawal without notice. Prospective purchasers should verify all information prior to acquisition.

