



For Sublease

2273 Research Blvd
Rockville, MD

Turnkey Opportunity, Move-in Ready!

- Suite 700: 13,688 sf (can be subdivided)
- Term Through June 2027 (flexible sublease terms available)
- Sublease Rental Rate: \$24.00 / SF, Full Service
- Furniture Can Be Made Available
- Spacious Board Room and Break Room located on the window line
- On-Site Amenities Include:
 - o Fitness center
 - o Conference center
 - o On-site café
 - o Park like setting with outdoor seating
 - o Abundant surface parking

Lauren Lang

(703)508-9013 cell

(301)287-9956 office

Lauren.Lang@am.jll.com

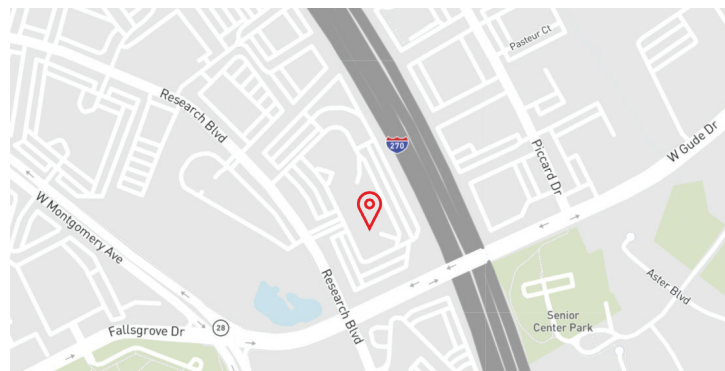

Suite 700

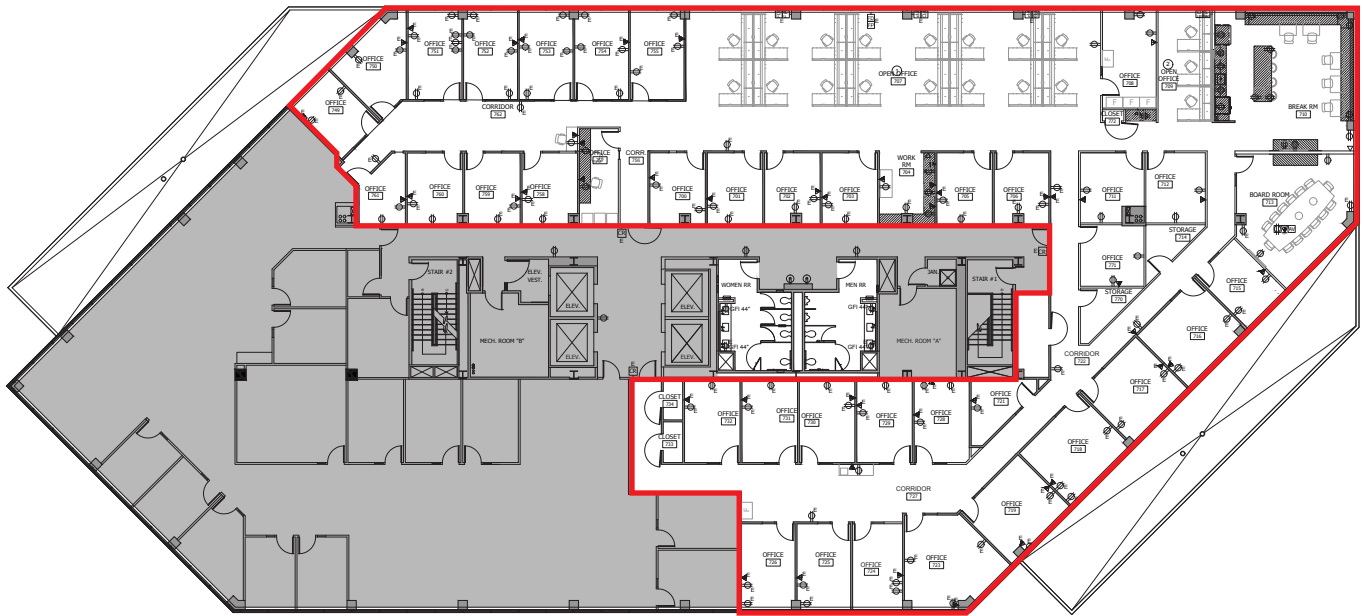

7th Floor

Amenities



On-site Cafe/Deli



Abundant Surface
Parking



Furniture Can Be
Made Available



Fitness Center



Conference Center



Fitness Center



On-site Cafe/Deli



On-site Cafe/Deli



Conference Center



Lobby

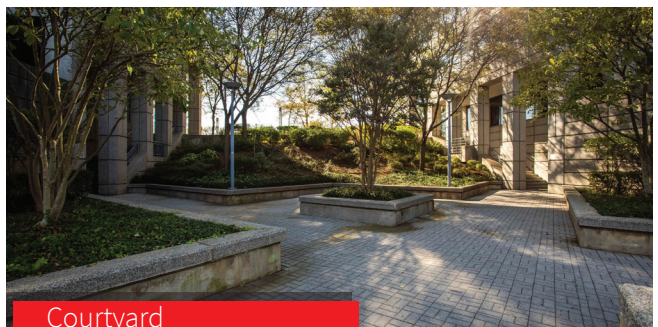

Courtyard

2273 Research Blvd
Rockville, MD

Suite 700

Lauren Lang

(703)508-9013 cell

(301)287-9956 office

Lauren.Lang@am.jll.com

Disclaimer: Although information has been obtained from sources deemed reliable, Owner, Jones Lang LaSalle, and/or their representatives, brokers or agents make no guarantees as to the accuracy of the information contained herein, and offer the Property without express or implied warranties of any kind. The Property may be withdrawn without notice.

© 2020. Jones Lang LaSalle. All rights reserved.

