

CENTRE LINE OF ASPHALT

EDGE OF ASPHALT

BOS

OHW

ASPHALT FROM ROAD  
TO PROPERTY LINE

N39°00'00"E  
23.19

157.28

163.05 m

N51°00'00"W

660m

N38°58'10"E 120.20

662m  
661.5m  
661m  
660.5m

GRAVEL DRIVEWAY

TREE LINE

CH STAKED LINE

121.92

N50°58'30"W

WATERCOURSE

WETLAND AS STAKED OUT  
BY HALTON CONSERVATION  
JULY 28, 2023

PART 1 PLAN 20R-3765

PIN 07196-0099

84.12

PART 1 PLAN 20R-16719

TREE LINE

CH STAKED LINE

659.5m  
659m

KEY MAP

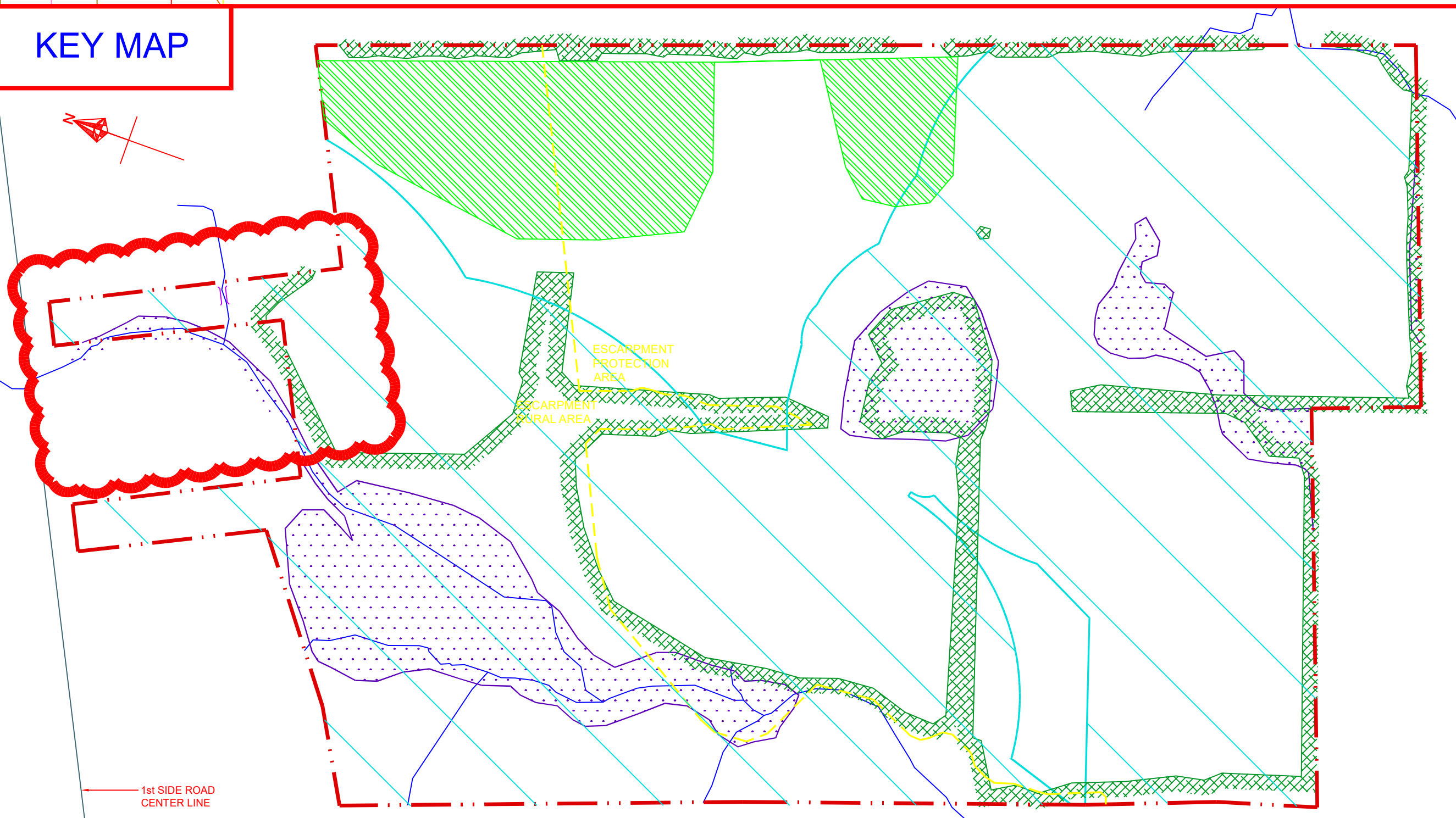

PROPOSED DRIVEWAY  
FOR ACCESS  
0000 1st SIDE ROAD  
BURLINGTON, ONTARIO

CURRENT ZONING: NEC  
DEVELOPMENT CONTROL AREA  
(ESCARPMENT RURAL /  
ESCARPMENT PROTECTION)

TOTAL SITE AREA: 231,600m² (57.24ac, 23.16ha)

PROPOSED DRIVEWAY TO  
CROSS CONSERVATION STAKED  
AREA FOR ACCESS TO FARMING  
FIELDS.  
DRIVEWAY TO BE 9m WIDE FOR  
EASY FARM EQUIPMENT  
ACCESS.

PROPOSED PRIVACY FENCE  
ALONG PROPERTY LINE JUST  
NORTH EAST OF DRIVEWAY.

PROPOSED BLACK CHAIN-LINK  
FENCE 0.5m FROM SOUTH WEST  
SIDE OF DRIVEWAY TO PREVENT  
FUTURE ENCROACHMENT.

SEE PRIVACY FENCE DETAIL  
AND CHAIN-LINK FENCE DETAIL  
FOR MORE SPECIFIC INFO.

-REVISIONS-  
2024/05/24: ADJUSTED DRIVEWAY TO EXTEND STRAIGHT ALONG  
NORTHERN LOT LINE, AVOIDING WETLANDS AS PER C.H.  
COMMENTS (J.T.)

- LEGEND:
- PROPERTY BOUNDS
  - TREELINE
  - CONSERVATION AREA EXTENT
  - WATERCOURSE
  - WETLAND AREA
  - PROPOSED ASPHALT/GRAVEL
  - VINEYARD
  - ESCARPMENT PROTECTION / RURAL BORDER
  - CONTOUR LINES
  - FENCE

NOTE: DRAWING IS FOR DISCUSSION PURPOSES ONLY.

PROJECT FILE NO.  
2022\_33

SCALE: 1:250  
(APPROXIMATE)  
WHEN PRINTED ON 24 X 36

DATE:  
DECEMBER 08, 2023

DRAWN BY: J.T.  
REVIEWED BY: T.G.



WWW.URBANINMIND.CA