

RETAIL PROPERTY FOR LEASE

CROSSINGS AT GUNN EDEN

702 - 780 NW WASHINGTON BLVD, HAMILTON, OH 45013



OFFERING SUMMARY

Lease Rate:	Negotiable
Building Size:	149,684 SF
Available SF:	18,029 SF
Year Built:	1999

PROPERTY OVERVIEW

- Junior Anchor Space
- Heart of Hamilton's Retail District
- Divisible to 2,000 SF
- Creative Landlord
- Abundant Parking
- Prominent Pylon Signage
- End Cap

POLLY BENZING

513.415.9513

polly@copperwoodrg.com

RETAIL PROPERTY FOR LEASE

CROSSINGS AT GUNN EDEN

702 - 780 NW WASHINGTON BLVD, HAMILTON, OH 45013



Additional Storefront Glass Can Be Added



Front Vestibule



POLLY BENZING

513.415.9513

polly@copperwoodrg.com

RETAIL PROPERTY FOR LEASE

CROSSINGS AT GUNN EDEN

702 - 780 NW WASHINGTON BLVD, HAMILTON, OH 45013

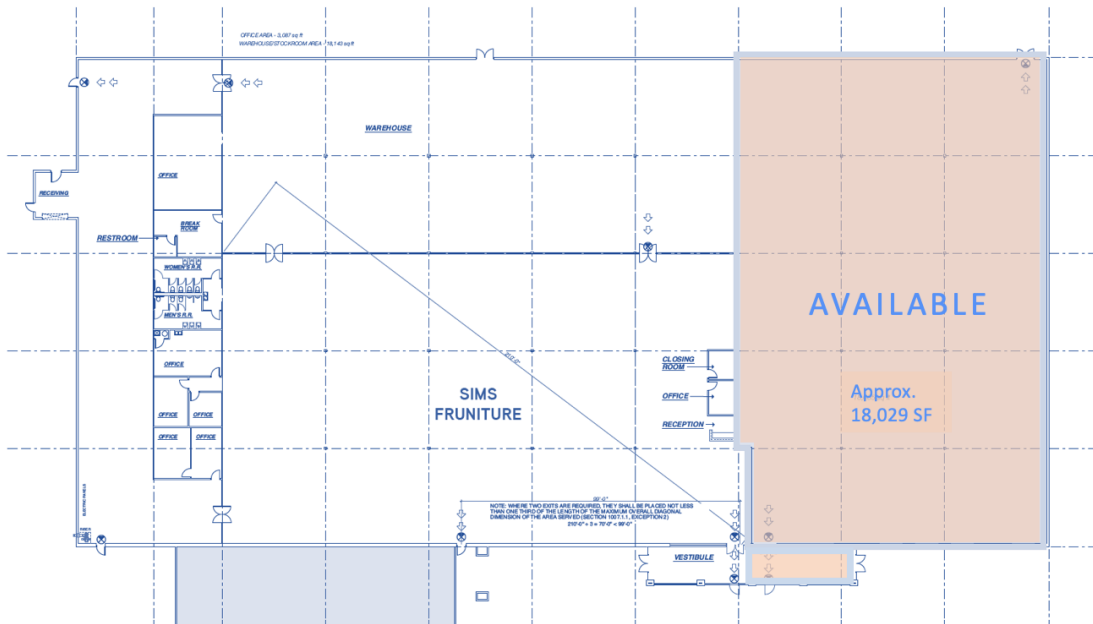

Floor Plan of Entire Anchor Space Showing Sims Furniture Portion and AVAILABLE Portion

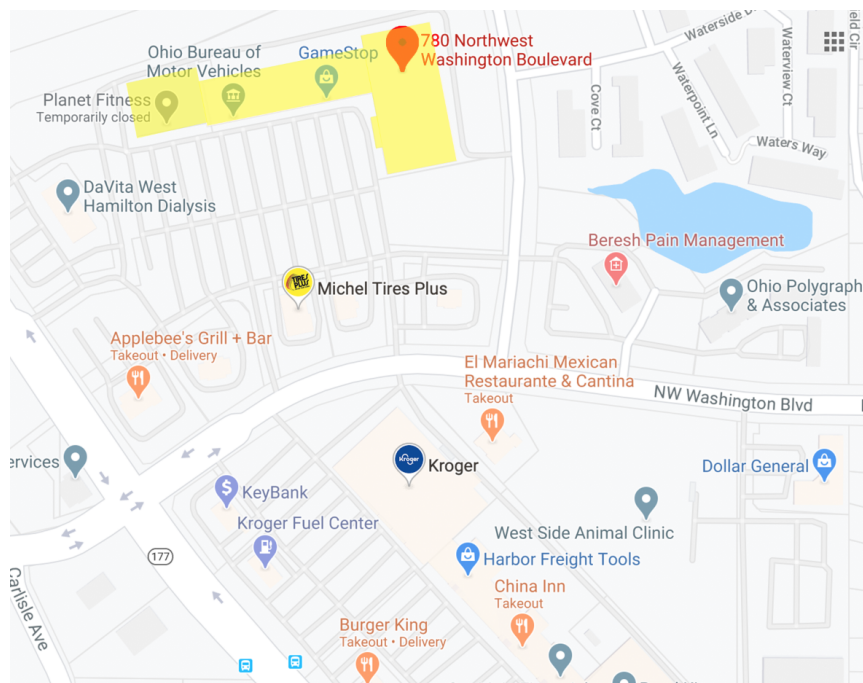

Adjacent to Numerous National Retailers Including Kroger, WalMart, Meijer, AMC Theater and Countless Restaurants

POLLY BENZING

513.415.9513

polly@copperwoodrg.com

CROSSINGS AT GUNN EDEN

702 - 780 NW WASHINGTON BLVD, HAMILTON, OH 45013

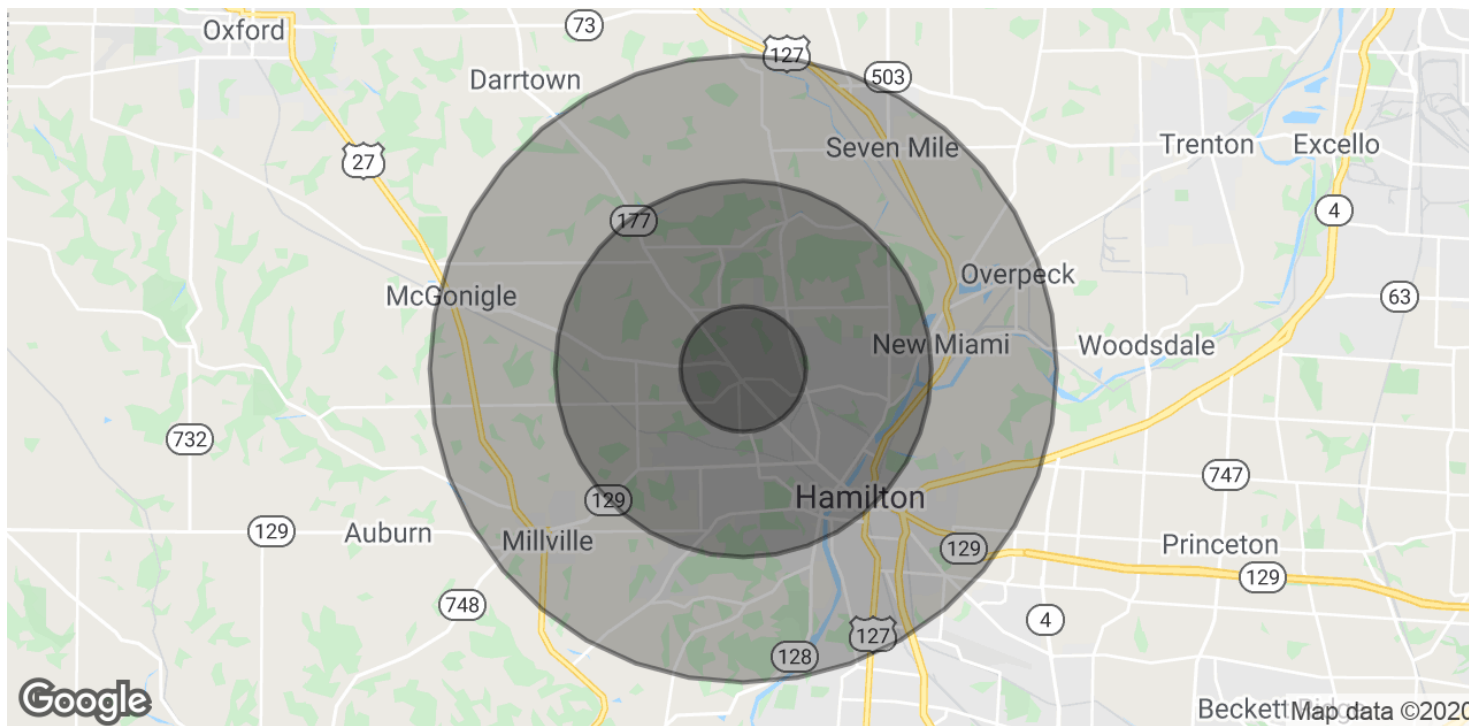

POPULATION	1 MILE	3 MILES	5 MILES
Total Population	7,242	44,457	85,961
Average age	39.4	38.4	37.0
Average age (Male)	37.3	36.4	35.5
Average age (Female)	40.1	40.4	38.8

HOUSEHOLDS & INCOME	1 MILE	3 MILES	5 MILES
Total households	3,053	18,235	33,609
# of persons per HH	2.4	2.4	2.6
Average HH income	\$50,709	\$53,302	\$52,111
Average house value	\$117,626	\$142,914	\$132,832

* Demographic data derived from 2010 US Census

POLLY BENZING

513.415.9513

polly@copperwoodrg.com