

# MAJESTIC CHINO HERITAGE

**FOR LEASE**

## 2 BUILDINGS

(SEC MOUNTAIN AVENUE & BICKMORE AVENUE, CHINO, CA)



### BUILDING 1 - 1,168,710 SF

Office: To Suit  
Clearance: 42' @ 1st Column  
Loading: 246 Dock High Doors  
4 Ground Level Ramps  
Bay Spacing: 60' x 58' (Typical)  
Power: To Suit  
Lighting: To Suit  
Auto Parking: 411  
Trailer Parking: 221  
Sprinkler System: ESRF

### BUILDING 2 - 914,040 SF

Office: To Suit  
Clearance: 42' @ 1st Column  
Loading: 146 Dock High Doors  
4 Ground Level Ramps  
Bay Spacing: 60' x 58' (Typical)  
Power: To Suit  
Lighting: To Suit  
Auto Parking: 347  
Trailer Parking: 179  
Sprinkler System: ESRF



**For further information, contact:**

**Trent Wylde**

R.E. License #01180856 (CA)  
562.948.4315  
twylde@majesticrealty.com

**Ed Konjayan**

R.E. License #01403186 (CA)  
562.948.4318  
ekonjayan@majesticrealty.com



# MAJESTIC CHINO HERITAGE

FOR LEASE

## 2 BUILDINGS

(SEC MOUNTAIN AVENUE & BICKMORE AVENUE, CHINO, CA)

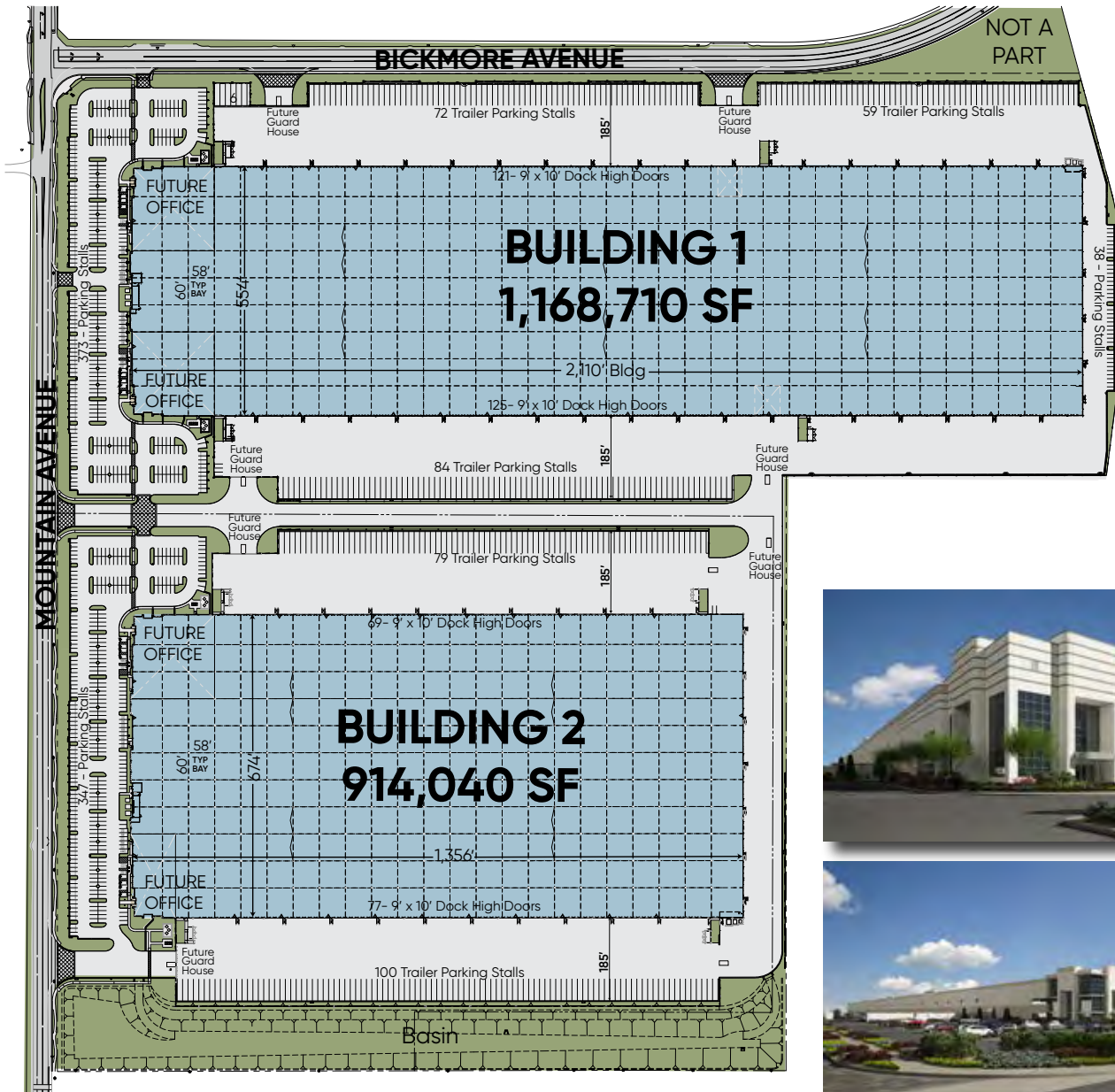

For further information, contact:

**Trent Wylde**

R.E. License #01180856 (CA)  
562.948.4315  
twylde@majesticrealty.com

**Ed Konjoyan**

R.E. License #01403186 (CA)  
562.948.4318  
ekonjoyan@majesticrealty.com



MajesticRealty.com | 13191 Crossroads Parkway North • Sixth Floor • City of Industry, CA 91746-3497 • Phone: 562.692.9581

This statement is based upon information which we believe to be correct and is obtained from sources we regard as reliable but we assume no liability for errors or omissions therein.