

FOR SALE OR LEASE
14,688 SF

14045
LAKE DRIVE NE
COLUMBUS, MN



PROPERTY INFORMATION

DANNY MCNAMARA
Director
+1 952 893 8895
danny.mcnamara@cushwake.com

BRENT MASICA
Senior Executive Director
+1 952 893 8231
brent.masica@cushwake.com



- BRAND NEW CONSTRUCTION
- OUTDOOR STORAGE AVAILABLE

Address 14045 Lake Drive NE
Columbus, MN

Lease Rates Negotiable

Sale Price Negotiable

Building Size
3,000 SF Office
4,920 SF Warehouse
4,512 SF Service Bay
2,256 SF Wash Bay
14,688 SF Total

Outdoor Storage +/- 2 acres

Yard Approx. 4 Acres of outdoor storage

Water/Sewer Brand new well and brand new septic system

Loading 4 oversized drive-in doors



PROPERTY PHOTOS



FLOOR PLAN

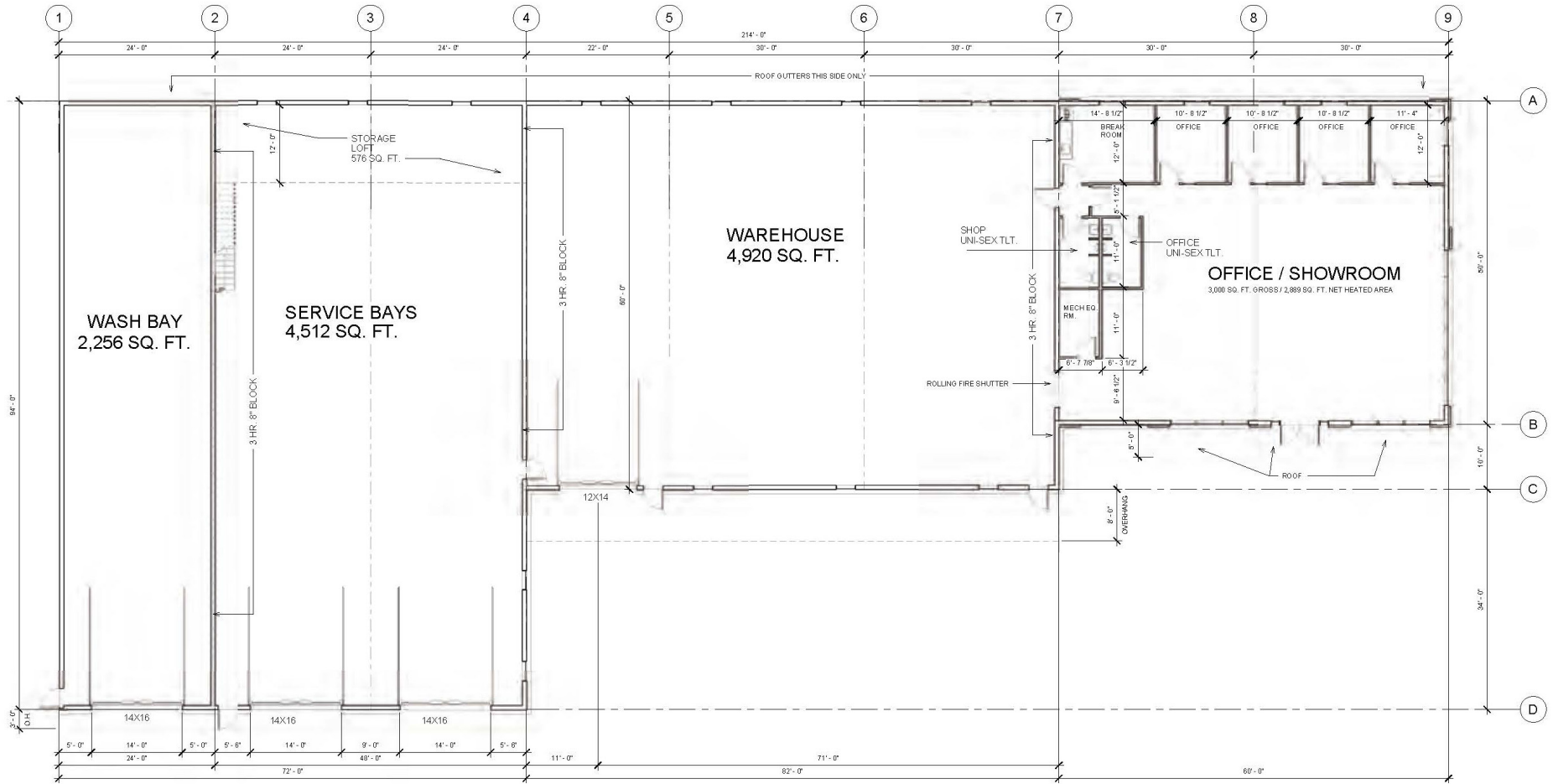

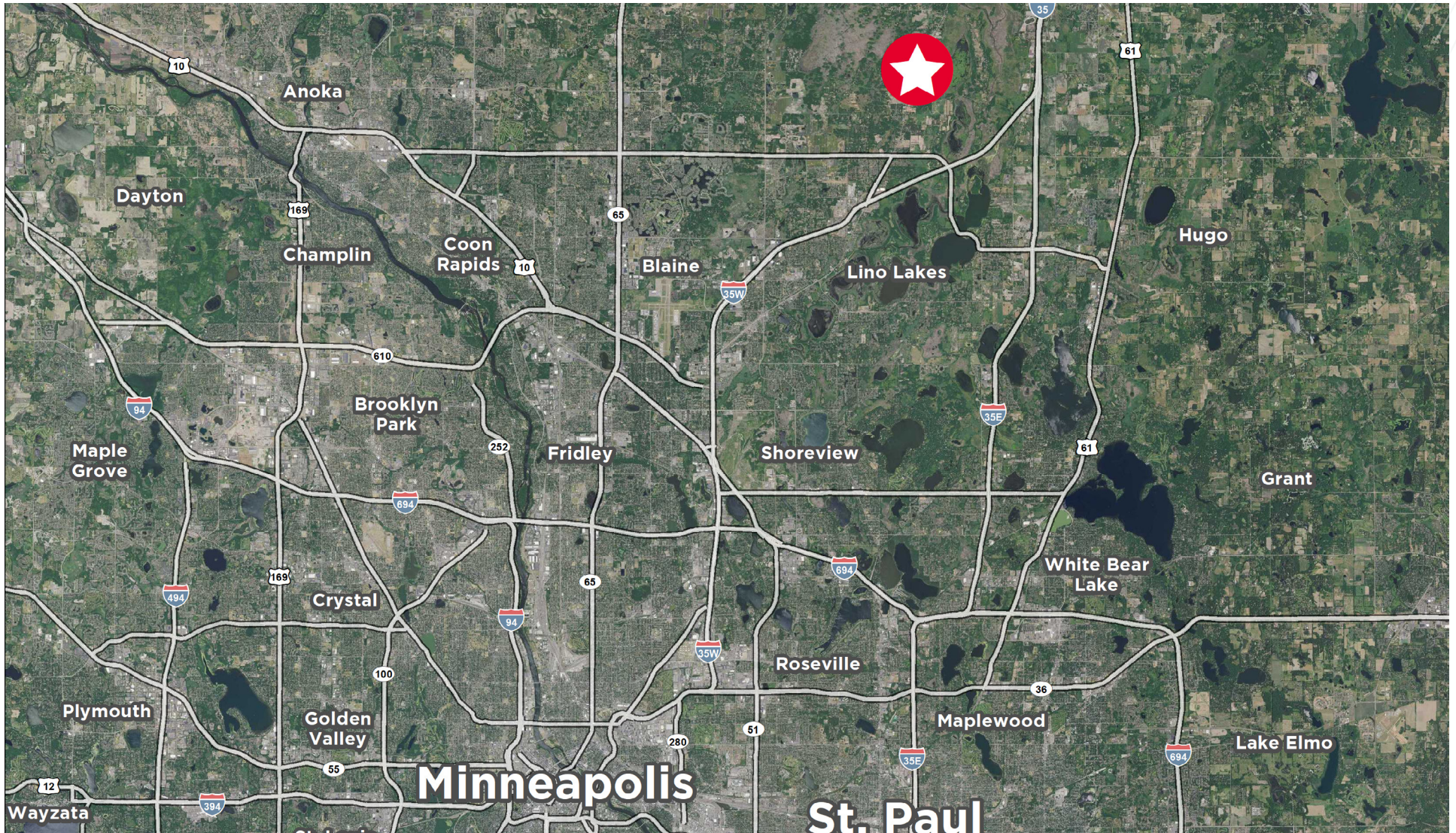

DANNY MCNAMARA
Director
+1 952 893 8895
danny.mcnamara@cushwake.com

BRENT MASICA
Senior Executive Director
+1 952 893 8231
brent.masica@cushwake.com

3500 American Blvd W, Suite 200
Minneapolis, MN 55431
952 831 1000
industrialmn.com

©2022 Cushman & Wakefield. All rights reserved. The information contained in this communication is strictly confidential. This information has been obtained from sources believed to be reliable but has not been verified. NO WARRANTY OR REPRESENTATION, EXPRESS OR IMPLIED, IS MADE AS TO THE CONDITION OF THE PROPERTY (OR PROPERTIES) REFERENCED HEREIN OR AS TO THE ACCURACY OR COMPLETENESS OF THE INFORMATION CONTAINED HEREIN, AND SAME IS SUBMITTED SUBJECT TO ERRORS, OMISSIONS, CHANGE OF PRICE, RENTAL OR OTHER CONDITIONS, WITHDRAWAL WITHOUT NOTICE, AND TO ANY SPECIAL LISTING CONDITIONS IMPOSED BY THE PROPERTY OWNER(S). ANY PROJECTIONS, OPINIONS OR ESTIMATES ARE SUBJECT TO UNCERTAINTY AND DO NOT SIGNIFY CURRENT OR FUTURE PROPERTY PERFORMANCE.