

## OFFERING SUMMARY

Building Size:	84,100 SF
Available SF:	1,500 - 1,700 SF
Lot Size:	9 Acres

## PROPERTY OVERVIEW

Storefronts for lease in grocery anchored center. Co-tenants include: Bravo Supermarket, Teacher's Federal Credit Union (TFCU), Family Dollar Store, Aid Auto Store, and more.

142 Wheeler Road - former restaurant with grease trap.  
158 Wheeler Road - former nail salon.

## LOCATION OVERVIEW

Prime grocery anchored shopping center just south of Motor Parkway and the Long Island Expressway and about a mile north of the court complex.

SPACES	LEASE RATE	SPACE SIZE
142 Wheeler Road	\$32.00 SF/yr	1,500 SF
158 Wheeler Road	\$32.00 SF/yr	1,700 SF

## ARIC SCHACHNER

MANAGING DIRECTOR /  
NYS LICENSED REAL ESTATE ASSOCIATE BROKER  
631.389.0263  
aric.schachner@camcocre.com

## LORRAINE O'HARA

NYS LICENSED REAL ESTATE ASSOCIATE BROKER  
631.389.0264  
lorraine.ohara@camcocre.com

The information presented here is deemed to be accurate, but it has not been independently verified. We make no guarantee, warranty or representation. It is your responsibility to independently confirm accuracy and completeness.

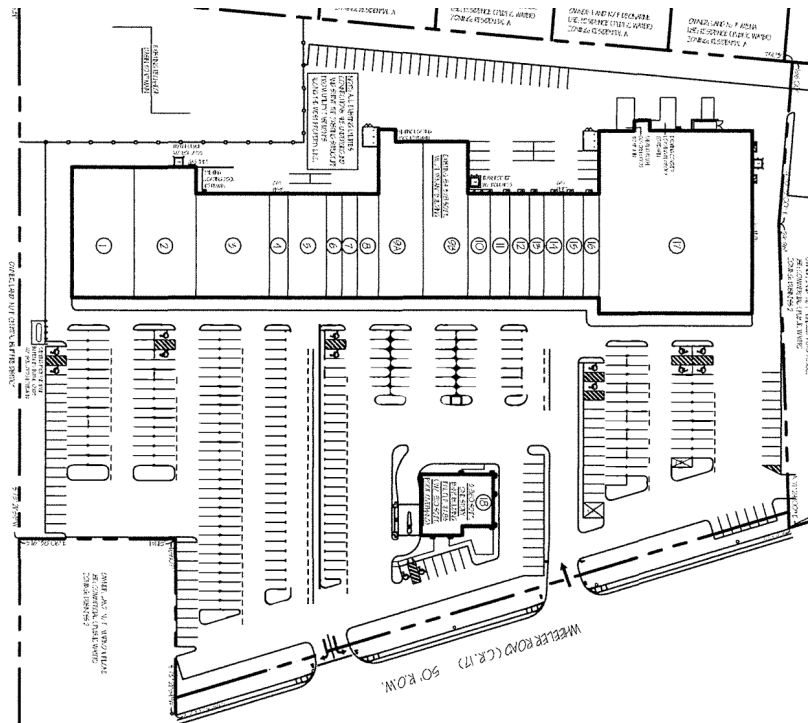

## ARIC SCHACHNER

MANAGING DIRECTOR /  
NYS LICENSED REAL ESTATE ASSOCIATE BROKER  
631.389.0263  
aric.schachner@camcocre.com

## LORRAINE O'HARA

NYS LICENSED REAL ESTATE ASSOCIATE BROKER  
631.389.0264  
lorraine.ohara@camcocre.com

The information presented here is deemed to be accurate, but it has not been independently verified. We make no guarantee, warranty or representation. It is your responsibility to independently confirm accuracy and completeness.



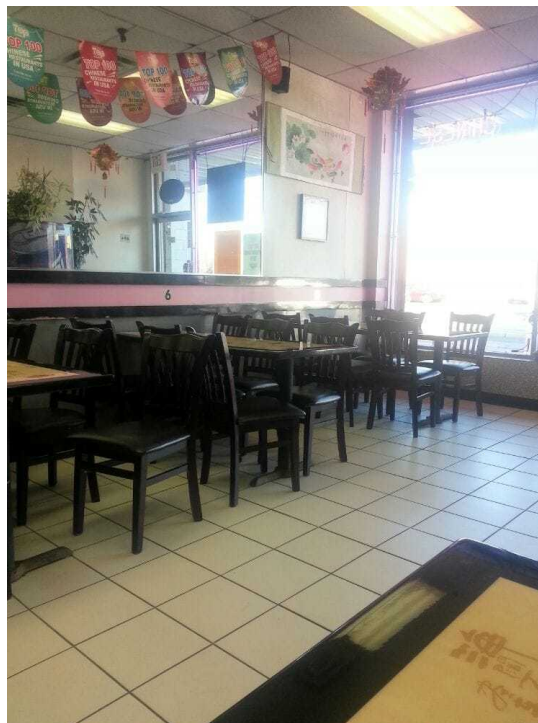

## ARIC SCHACHNER

MANAGING DIRECTOR /  
NYS LICENSED REAL ESTATE ASSOCIATE BROKER  
631.389.0263  
aric.schachner@camcocre.com

## LORRAINE O'HARA

NYS LICENSED REAL ESTATE ASSOCIATE BROKER  
631.389.0264  
lorraine.ohara@camcocre.com

The information presented here is deemed to be accurate, but it has not been independently verified. We make no guarantee, warranty or representation. It is your responsibility to independently confirm accuracy and completeness.



POPULATION	1 MILE	3 MILES	5 MILES
Total Population	14,488	112,614	271,257
Average age	32.8	34.5	36.3
Average age (Male)	31.5	32.5	34.7
Average age (Female)	34.1	36.6	37.9

HOUSEHOLDS & INCOME	1 MILE	3 MILES	5 MILES
Total households	4,093	30,939	78,550
# of persons per HH	3.5	3.6	3.5
Average HH income	\$83,123	\$87,154	\$97,527
Average house value	\$377,216	\$407,999	\$423,872

\* Demographic data derived from 2010 US Census

## ARIC SCHACHNER

MANAGING DIRECTOR /  
NYS LICENSED REAL ESTATE ASSOCIATE BROKER  
631.389.0263  
aric.schachner@camcocre.com

## LORRAINE O'HARA

NYS LICENSED REAL ESTATE ASSOCIATE BROKER  
631.389.0264  
lorraine.ohara@camcocre.com

The information presented here is deemed to be accurate, but it has not been independently verified. We make no guarantee, warranty or representation. It is your responsibility to independently confirm accuracy and completeness.