



Gall Real Estate  
Services, LLC

[www.Gallre.com](http://www.Gallre.com)

PO Box 1071  
Dallas, OR 97338

**\$0.70/SF/Mo.**  
**Approx.**  
**6,695 SF to**  
**32,228 SF**  
**Available**  
**Lease Type:**  
**NNN**  
**Zoned: IP**

*For additional information  
on this property please contact:*

**Jennifer Hand**  
**Broker**  
**[jhand@gallre.com](mailto:jhand@gallre.com)**  
**503.363.6051 (ph)**  
**503.363.1791 (fax)**  
**503.559.9839 (cell)**

**3220 Pringle Rd. SE**  
**Salem, OR 97302**

## **For Lease**



### **PROPERTY HIGHLIGHTS:**

- Warehouse spaces for lease in Southeast Salem.
- Near the Airport and easy I-5/Highway 22 access.
- Approximately 18' clear height.
- Sprinkled Fire System.
- On-site parking.
- Approximately 1200 amp/440 power total currently.
- On-site parking.
- 6,695 SF, 9,004 SF and 11,485 SF all available with an additional 5,000 that can be added if needed.
- Tenant to pay pro-rata share of water and sewer, shared Restrooms, plus all other utilities.

This information has been secured from sources we believe to be reliable, but we make no representations or warranties, expressed or implied, as to the accuracy of the information. Reference to square footage or age are approximate.

# 3220 Pringle Rd. SE Suite #120 Salem, OR 97302

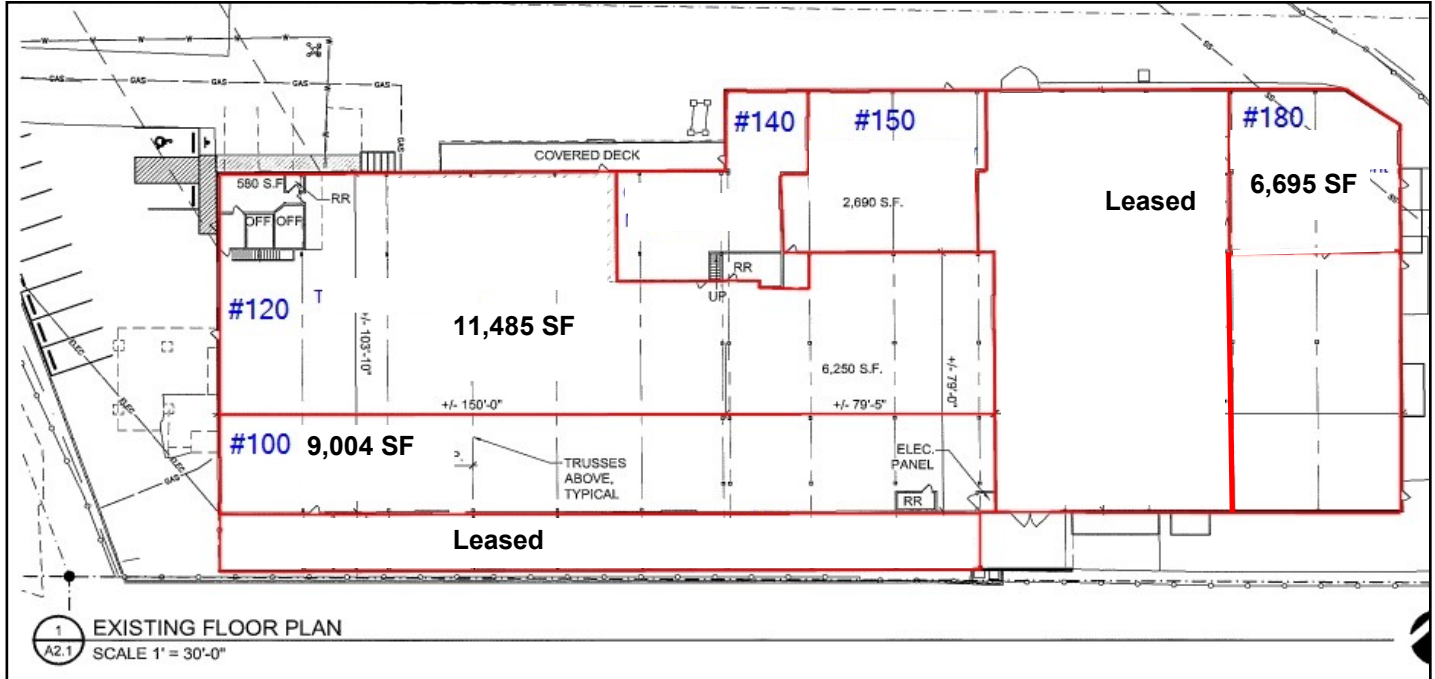

**For additional information on this property please contact:**

**Jennifer Hand, Broker**  
**[jhand@gallre.com](mailto:jhand@gallre.com)**  
**503.363.6051 (ph)**  
**503.363.1791 (fax)**  
**503.559.9839 (cell)**

**Gall Real Estate Services, LLC PO Box 1071 Dallas, OR 97338**

This information has been secured from sources we believe to be reliable, but we make no representations or warranties, expressed or implied, as to the accuracy of the information. Reference to square footage or age are approximate.