

FLEX
FOR LEASE



1001 INVESTMENT BLVD

1001 Investment Blvd. | Apex, NC 27502

PROPERTY HIGHLIGHTS

- » **Unit B: ±10,380 SF**
- » 34' building height, one oversized 14' x 16' drive-in door, 10-ton crane, and 17 parking spaces
- » Located in a prime industrial pocket of Apex, just minutes from US-1, Hwy. 55, and US-64
- » Numerous nearby retail amenities, including Peakway Market Square, Pine Plaza, and Waverly Place, provide a variety of dining, shopping, and service options
- » Subdivided space with ± 1,300 SF of new office and 9,080 SF of warehouse
- » Well appointed office area comprised of reception area, two offices, conference room, three restrooms, and a break room

RENTAL RATE Available 5/1/25

\$14.50 PSF, NNN | TICAM \$2.01 PSF

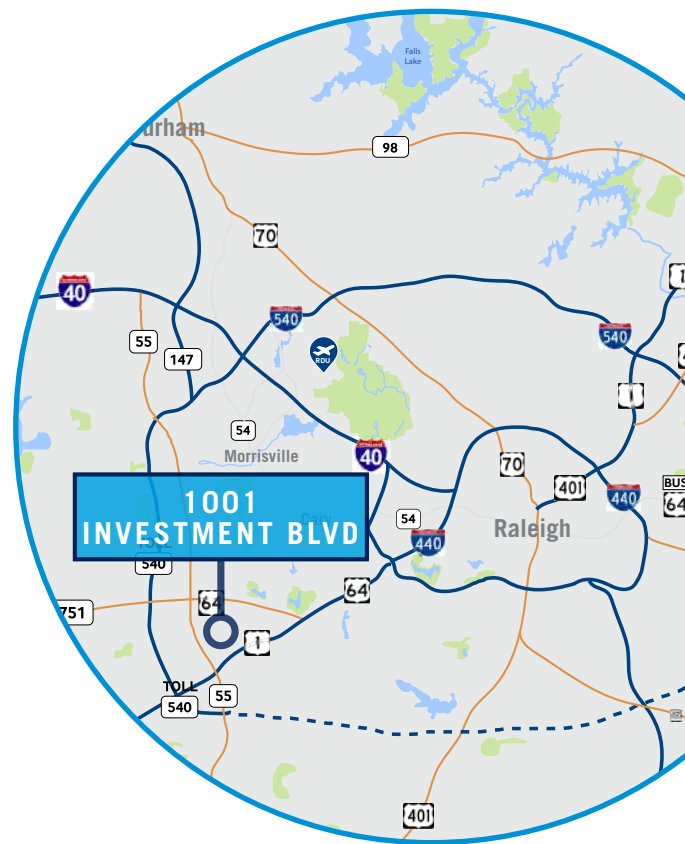

CONTACT:

Zach Miller | 919.418.5449 | zmiller@trinity-partners.com
Boss Poe | 919.868.0016 | bpoe@trinity-partners.com

TRINITY
PARTNERS

1001 INVESTMENT BLVD

1001 Investment Blvd. | Apex, NC 27502

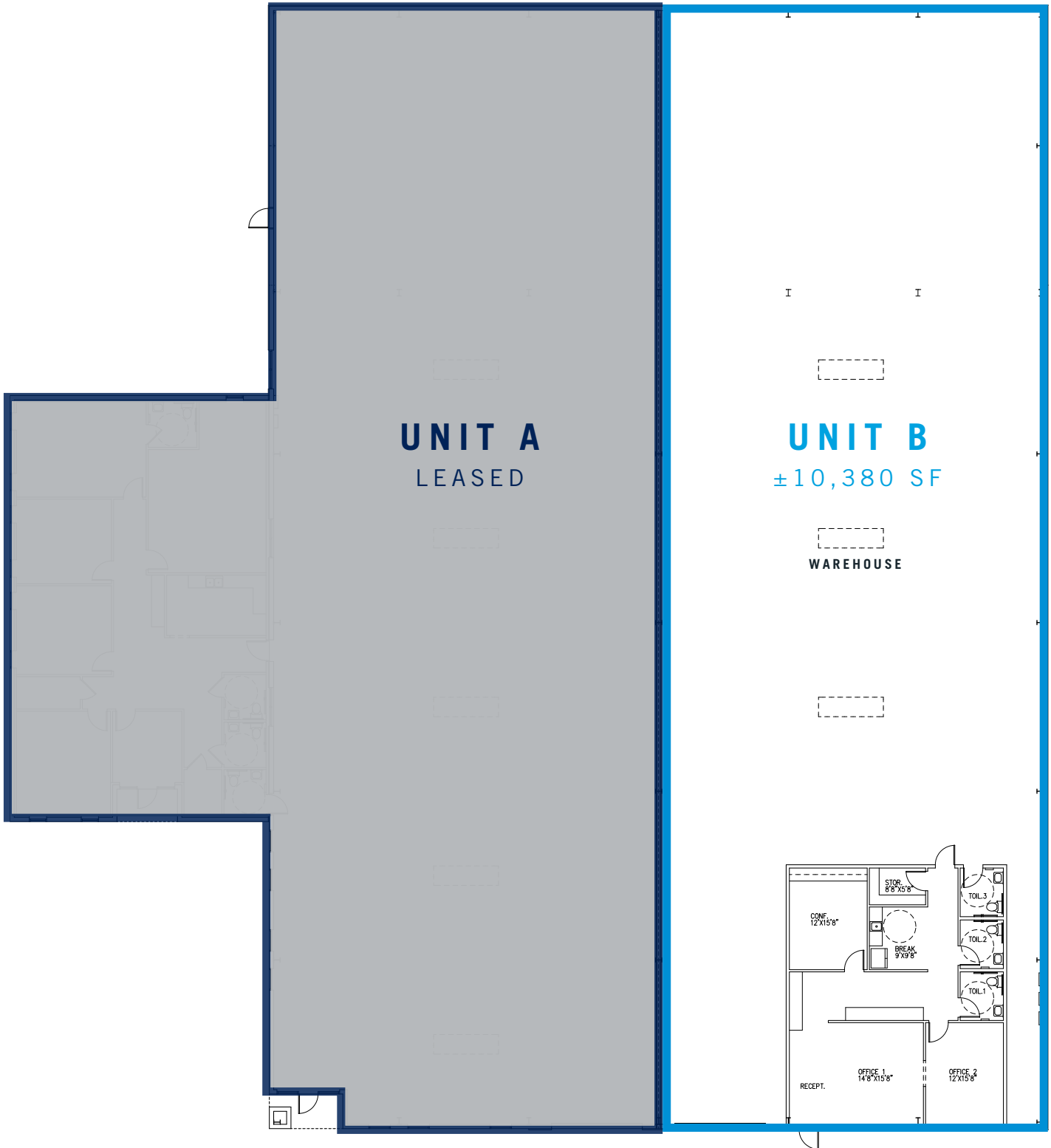

CONTACT:

Zach Miller | 919.418.5449 | zmiller@trinity-partners.com
Boss Poe | 919.868.0016 | bpoe@trinity-partners.com



1001 INVESTMENT BLVD

1001 Investment Blvd. | Apex, NC 27502



CONTACT:

Zach Miller | 919.418.5449 | zmiller@trinity-partners.com
Boss Poe | 919.868.0016 | bpoe@trinity-partners.com



1001 INVESTMENT BLVD

1001 Investment Blvd. | Apex, NC 27502



CONTACT:

Zach Miller | 919.418.5449 | zmiller@trinity-partners.com
Boss Poe | 919.868.0016 | bpoe@trinity-partners.com



1001 INVESTMENT BLVD

1001 Investment Blvd. | Apex, NC 27502



The information contained herein was obtained from sources believed reliable; however, Trinity Partners makes no guarantees, warranties, or representations as to the completeness or accuracy thereof. The presentation of this property is submitted subject to errors, omissions, changes of price or conditions prior to sale or lease, or withdrawal without notice.

CONTACT:

Zach Miller | 919.418.5449 | zmiller@trinity-partners.com

Boss Poe | 919.868.0016 | bpoe@trinity-partners.com

