

RETAIL FOR LEASE

# Parkside Towers

Foster City, CA







**±3,412 SQFT**  
**Second Generation**  
Restaurant Space Available





# Highlights

-  **Second generation** restaurant space available
-  **Class “A”** office development of 398,000 SF features 17,000 SF of retail on the project’s ground floor arcade
-  Shops, restaurants and other retail services will front on to the park at the corner of East Hillside Blvd & Shell Blvd
-  Parkside Towers integrates a **beautiful parklike environment** with a vital commercial center
-  **Retail parking available** in front of commercial plus parking in garage behind premises

## DEMOGRAPHICS

	1 Mile	3 Miles	5 Miles
Population	23,844	123,418	222,603
Average Household Income	\$127,707	\$129,438	\$128,050
Daytime Population	18,482	26,543	55,889

## TRAFFIC COUNTS

E Hillside Blvd & Foster City Blvd	19,994 ADT
Shell Ave & E Hillside Blvd	18,407 ADT

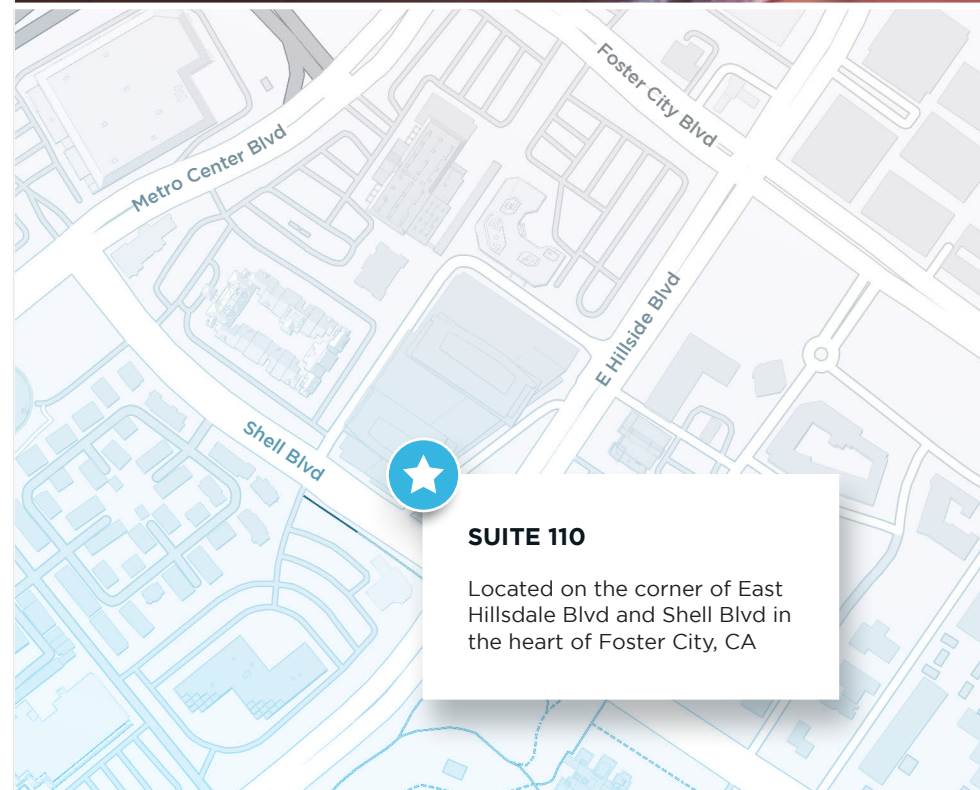

### SUITE 110

Located on the corner of East Hillside Blvd and Shell Blvd in the heart of Foster City, CA

**ASKING RENTS:** \$3.00 psf (NNN= \$0.75 psf) - Shop Space

Retail Garage  
Parking Entrance

METRO CENTER BLVD

SHELL BLVD

Retail Parking

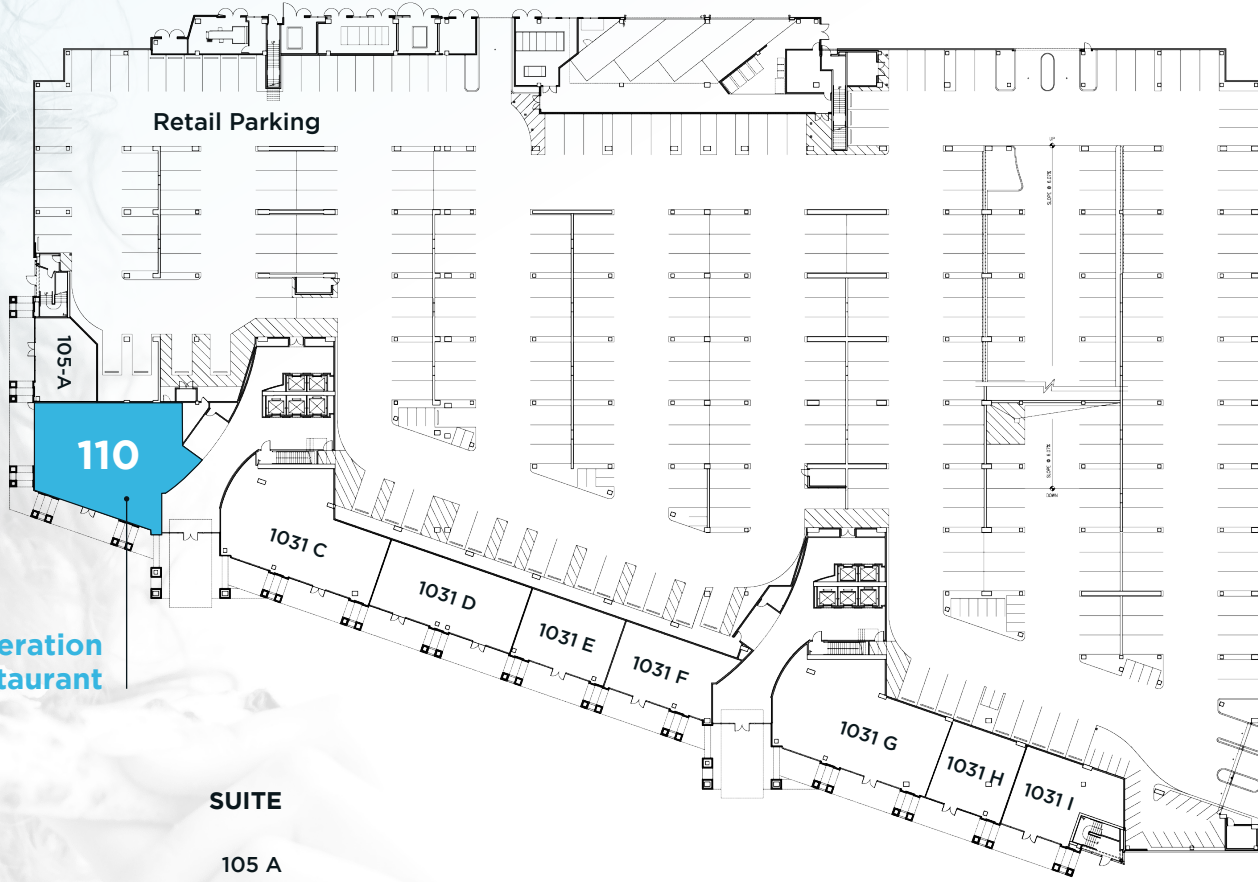

FOSTER CITY BLVD

2nd Generation  
Restaurant

**RETAILER**

**SUITE**

State Farm Insurance

105 A

**AVAILABLE 3,412 SF**

**110**

Gold Medal Fitness

1031 C

GolfTEC

1031 D

Harvest Management Office

1031 E

S.A.M. Tutoring School

1031 F

Conference Room & Fitness Center

1031 G-I

E HILLSIDE BLVD

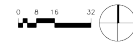



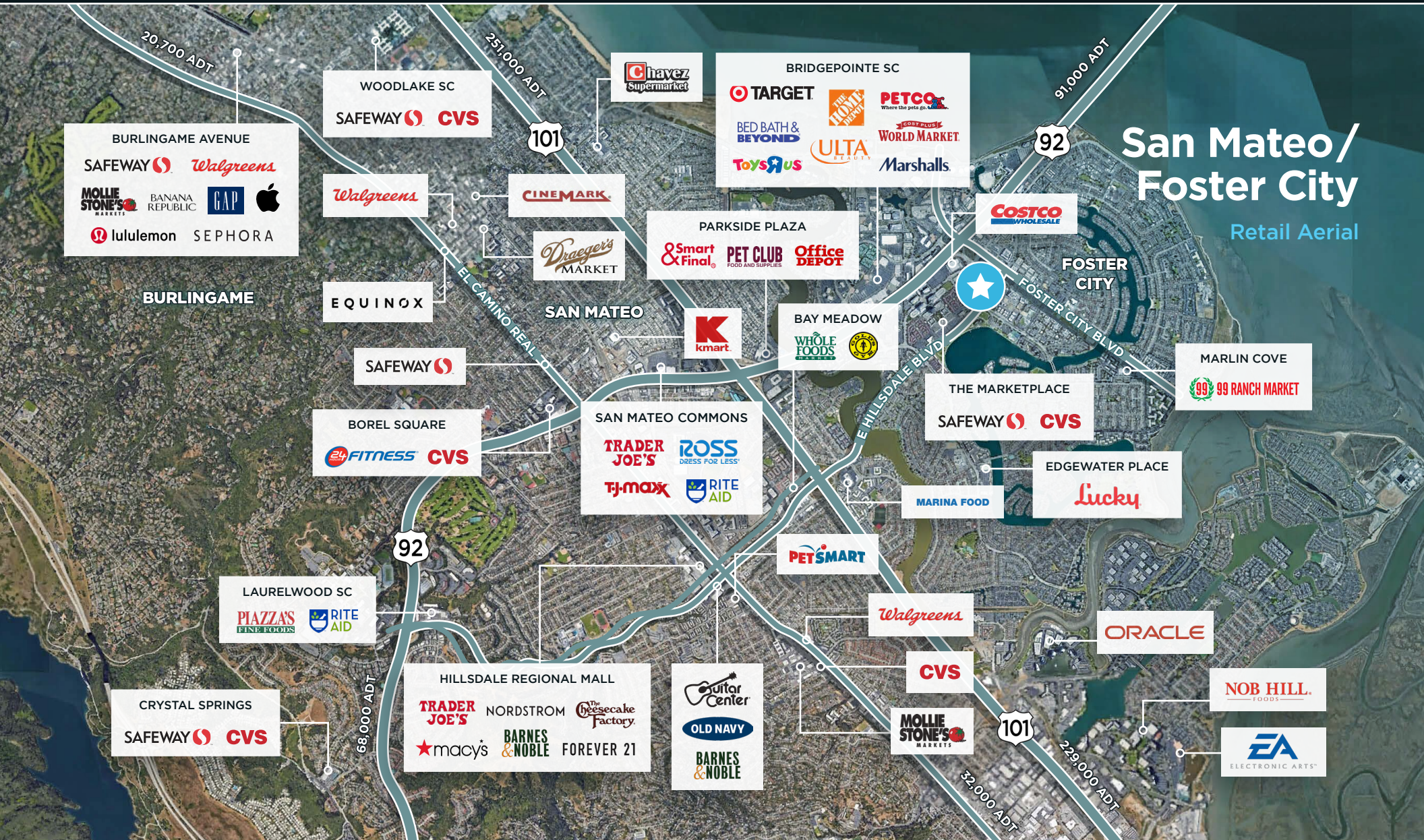

# San Mateo/ Foster City

Retail Aerial

**MIKE COSTA**

mcosta@the**econic**company.com  
 (408) 400-7011  
 LIC. 00415216

**MIKE CONROY**

mconroy@the**econic**company.com  
 (408) 400-7061  
 LIC. 02046912

**RON CRUZ**

rcruz@the**econic**company.com  
 (408) 400-7003  
 LIC. 02018499