

EXCELLENT ACCESS TO I-90 & SPOKANE AIRPORT



FOR LEASE | SECURED YARD WITH RAIL SPUR

2823 S CRAIG RD
AIRWAY HEIGHTS, WA 99001

Property Details

Airway Heights is experiencing rapid growth, with a major contributing factor being its proximity to the Spokane/Coeur d'Alene area. This property offers convenient access to both I-90 and State Highway 2.

**OPEN
LISTING
FOR ALL
BROKERS**

Property Details

East Yard Area: 178,076 SF

- BNSF 375' Rail Spur

Lease Rate

Call For Rates



FOR LEASE | OFFICE AND YARD

2823 S CRAIG RD | AIRWAY HEIGHTS, WA 99001

FLOOR PLAN

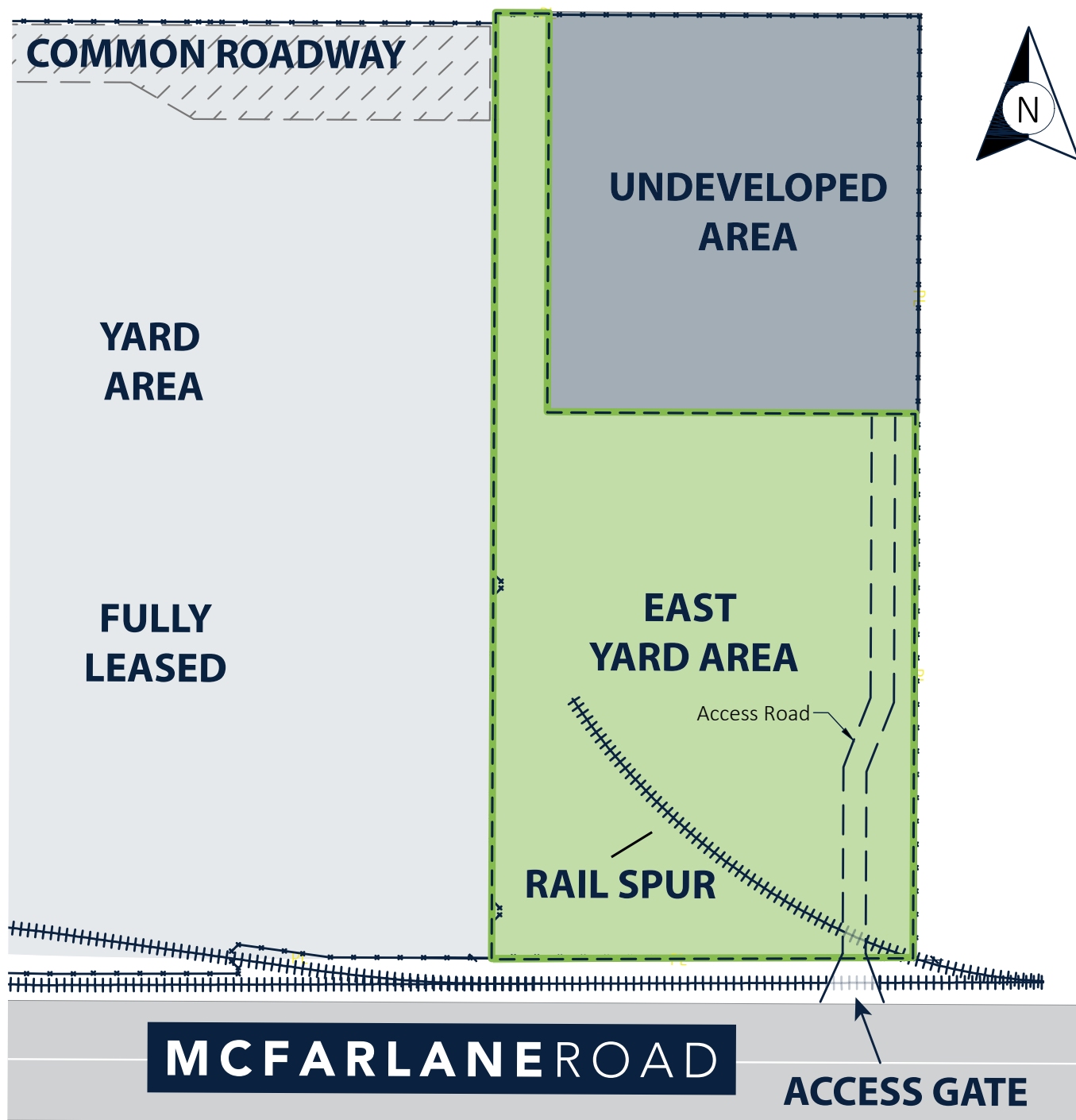

FOR LEASE | OFFICE AND YARD

2823 S CRAIG RD | AIRWAY HEIGHTS, WA 99001

MAP

