

CASTLETON CENTER

658 Genoa Way | Castle Rock, CO 80109

1,600 SF AVAILABLE / FOR LEASE



Patrick McGlinchey / Managing Director / +1 210 303 3149 / patrick.mcglinc@cushwake.com
Justin Gregory / Managing Director / +1 303 803 7170 / justin.gregory@cushwake.com



PROPERTY FEATURES

1,600 SF AVAILABLE / FOR LEASE

AVAILABLE

1,600 SF

RATE

\$30.00/SF

MONTHLY

\$6,469.33

NNN

\$18.52/SF

CITY/COUNTY

Castle Rock/Douglas

ABOUT THE PROPERTY

- Upcoming Lease Expiration:
Tenant lease expires 6/30/2026
- Second generation optometrist
- Located directly to the south of Castle Rock outlets with over 6 million unique customers
- One of the few remaining vacancies near the Castle
- Join Safe Splash, Fierce45 and Rock Salt Spa at The Castle Rock Outlets
- Great access and adjacency to I-25

DEMOGRAPHICS

Year: 2023 | Source: Esri

	1 Mile	3 Miles	5 Miles
Population	3,122	49,407	89,432
Daytime Population	10,545	48,338	76,664
Avg. Household Income	\$115,073	\$168,325	\$177,241
Estimated Households	1,358	17,358	31,749

TRAFFIC COUNTS

Year: 2023 | Source: Esri

Meadows Parkway	50,307 VPD
I-25	96,000 VPD



SITE PLAN

1,600 SF AVAILABLE / FOR LEASE

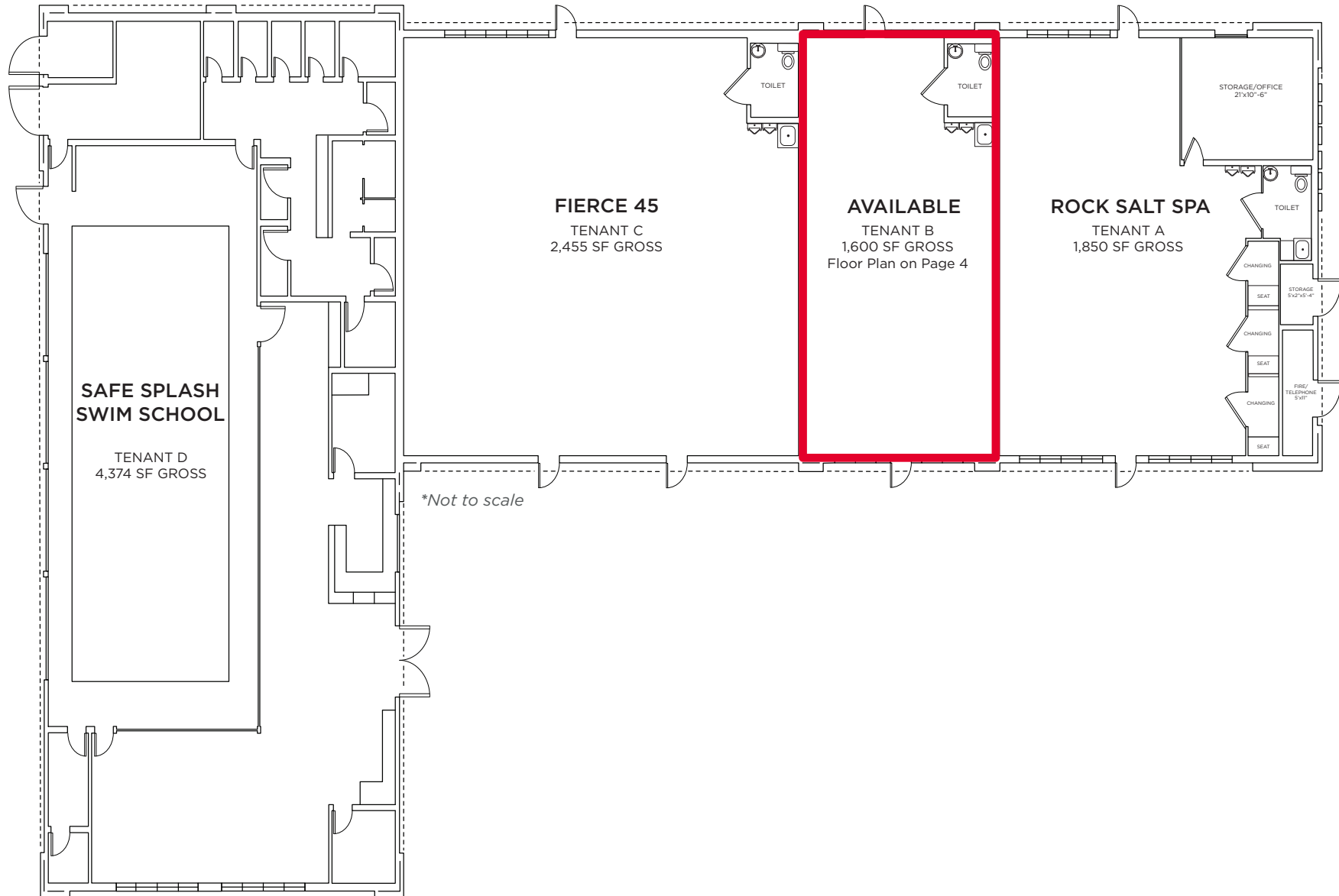

FLOOR PLAN

1,600 SF AVAILABLE / FOR LEASE

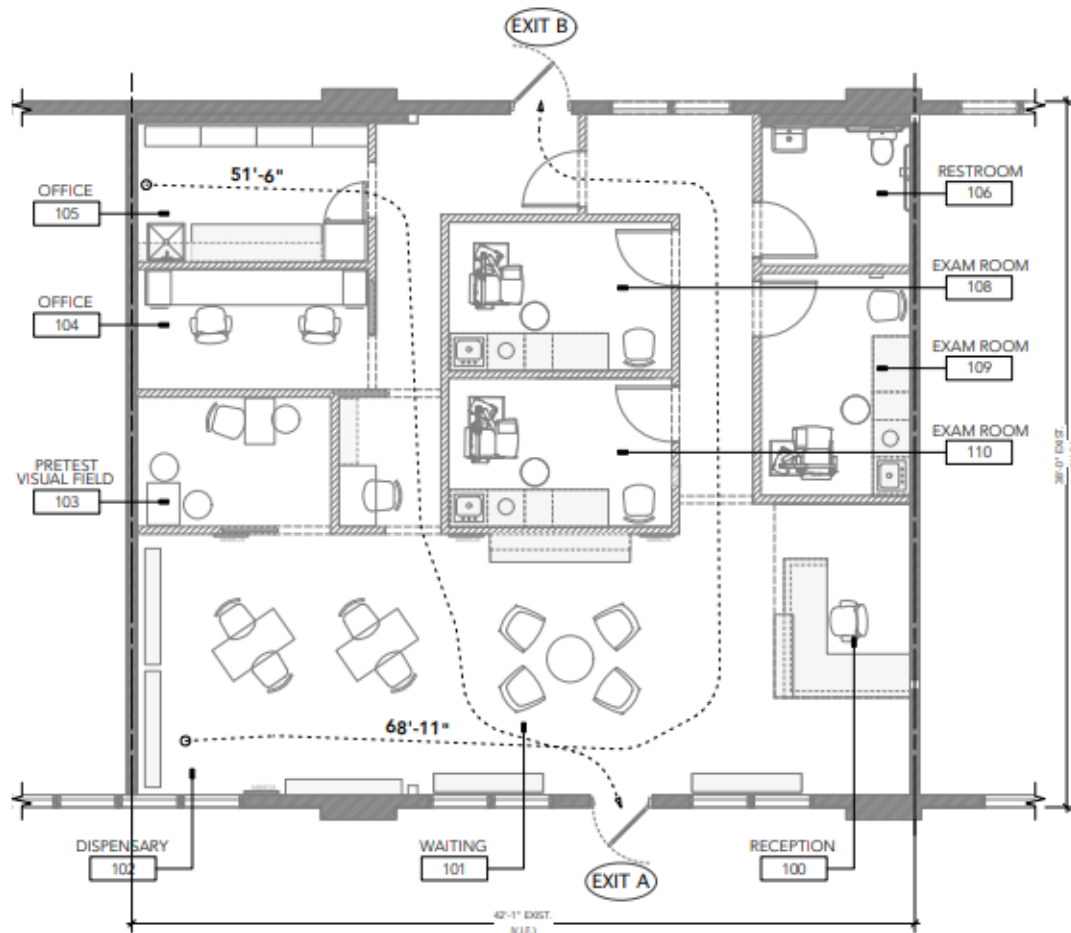

CASTLETON CENTER

658 Genoa Way | Castle Rock, CO 80109

AERIAL MAP

1,600 SF AVAILABLE / FOR LEASE



CASTLETON CENTER

658 Genoa Way | Castle Rock, CO 80109

Patrick McGlinchey / Managing Director / +1 210 303 3149 / patrick.mcglinche@cushwake.com

Justin Gregory / Managing Director / +1 303 803 7170 / justin.gregory@cushwake.com

[CUSHMANWAKEFIELD.COM](https://www.cushmanwakefield.com)



©2026 Cushman & Wakefield. All rights reserved. The information contained in this communication is strictly confidential. This information has been obtained from sources believed to be reliable but has not been verified. NO WARRANTY OR REPRESENTATION, EXPRESS OR IMPLIED, IS MADE AS TO THE CONDITION OF THE PROPERTY (OR PROPERTIES) REFERENCED HEREIN OR AS TO THE ACCURACY OR COMPLETENESS OF THE INFORMATION CONTAINED HEREIN, AND SAME IS SUBMITTED SUBJECT TO ERRORS, OMISSIONS, CHANGE OF PRICE, RENTAL OR OTHER CONDITIONS, WITHDRAWAL WITHOUT NOTICE, AND TO ANY SPECIAL LISTING CONDITIONS IMPOSED BY THE PROPERTY OWNER(S). ANY PROJECTIONS, OPINIONS OR ESTIMATES ARE SUBJECT TO UNCERTAINTY AND DO NOT SIGNIFY CURRENT OR FUTURE PROPERTY PERFORMANCE. PD-178169 V5