



COLUMBIA UNIVERSITY -
MANHATTANVILLE

RETAIL SPACE

F O R L E A S E

COLUMBIA BUSINESS SCHOOL

HARLEM, MORNINGSIDЕ HEIGHTS, HAMILTON HEIGHTS, MANHATTANVILLE

Over the past few years, the trade area surrounding the site has attracted significant commercial, educational, residential and retail investments that have significantly added to the neighborhood's vibrancy and quality of life.



TRADE AREA



155TH STREET - IND - ST NICHOLAS AV

148TH ST - LENOX AVE - HARLEM

145TH STREET - BWAY

145TH STREET

145TH STREET - L

RIVERBANK PARK

137TH STREET - City College

CITY COLLEGE

STRIVER'S ROW

MANHATTANVILLE CAMPUS

135TH STREET

ABYSSINIAN BAPTIST CHURCH

135TH STREET - LENOX

DINOSAUR BBQ

BSB RESTAURANT

THE COTTON CLUB

125TH STREET - BROADWAY

JIN RAMEN

GRANT'S TOMB

STARBUCKS

MANHATTANVILLE FACTORY DISTRICT

STATE OFFICE BUILDING

SYLVIA'S RESTAURANT

MORNINGSIDE HEIGHTS CAMPUS

BARNARD COLLEGE

DSW BLINK

NEW VICTORY THEATER

125TH STREET

APOLLO THEATER

125TH STREET - LENOX

HARLEM USA

RED ROOSTER HARLEM

ALOFT HOTEL

THE STUDIO MUSEUM IN HARLEM

116TH STREET

116TH STREET

116TH STREET - BWAY - Columbia Univ

110TH STREET - BWAY - Cathedral Pkwy

110TH STREET CATHEDRAL PKWY

110 STREET - LENOX (CENTRAL

MANHATTANVILLE

The Manhattanville campus is situated between City College just to the north, Columbia's Morningside campus just to the south and the Manhattanville Factory District to the east.

The campus plan includes up to 6.8 million square feet of space for teaching, research, university housing and support services. It features new facilities for civic, cultural, recreational and commercial activity. Its improved pedestrian-friendly streets and new publicly accessible open spaces will connect Harlem to the new Hudson River waterfront park.

The Campus currently includes: the 450,000 SF Jerome L. Greene Science Center, the 60,000 SF Lenfest Center for the Arts, the 56,000 SF, 430+ seat Forum, the 210,000 SF Studebaker Hall, and the 100,000 SF Prentiss Hall.

Scheduled for opening in 2022 is the Columbia Business School which consists of two buildings — Henry R. Kravis Hall and David Geffen Hall — for a total of 480,000 additional square feet.



GAMPPUS



Manhattanville in West Harlem



AVAILABILITY

Two retail spaces are available to lease in Kravis Hall, including the corner of 130th street.

ADDRESS

Henry R. Kravis Hall — Columbia Business School
2285 and 2287 12th Avenue
New York, NY 10027

PREMISES

SPACE A1: 1,397 SF

SPACE A2: 848 SF

Ground Floor

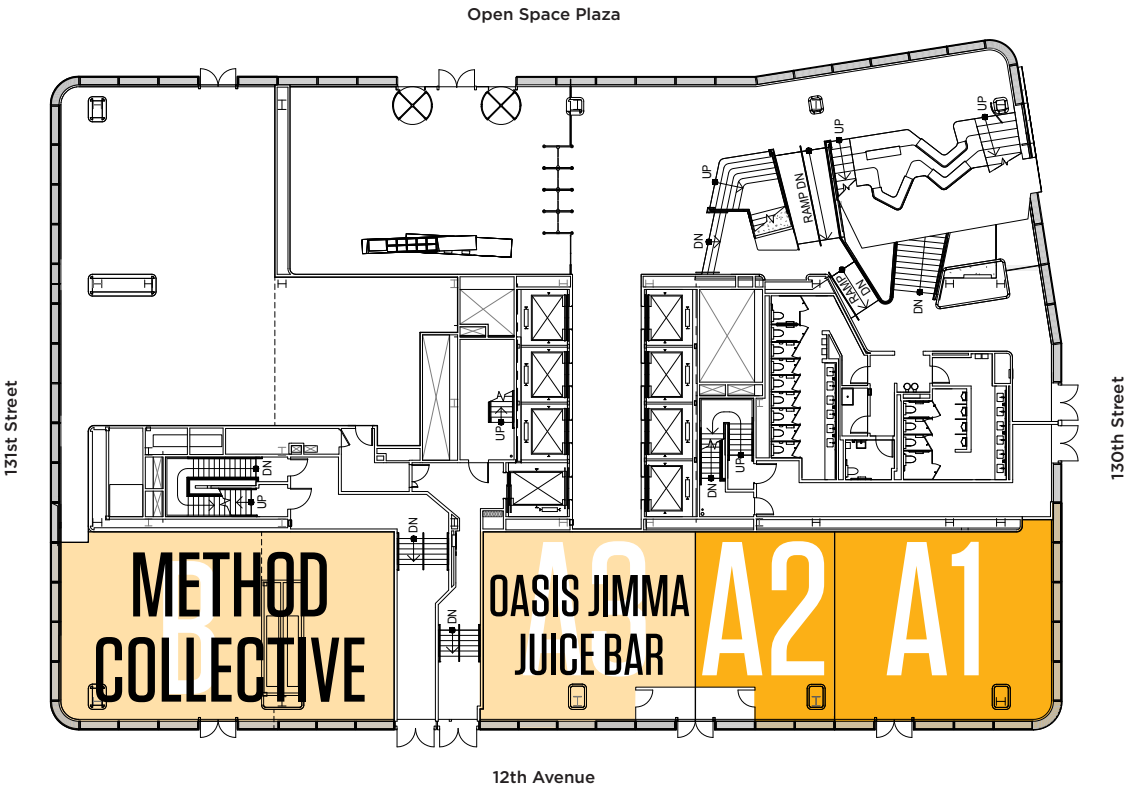

RETAIL

ILLUSTRATIVE RENDERING



ILLUSTRATIVE RENDERING





COLUMBIA UNIVERSITY
IN THE CITY OF NEW YORK

COLUMBIA UNIVERSITY – MANHATTANVILLE

R E T A I L

For more information, please contact the exclusive agents:

KENNETH HOCHHAUSER

212.792.2605

khochhauser@winick.com

YOEL GORJIAN

212.792.2646

ygorjian@winick.com

WRG | WINICK
REALTY
GROUP



COLUMBIA UNIVERSITY
IN THE CITY OF NEW YORK

Winick Realty Group LLC - Licensed Real Estate Brokers
655 Third Avenue, 24th Floor • New York, NY 10017 • T. (212) 792.2600 • www.winick.com

ALTHOUGH ALL INFORMATION REGARDING PROPERTY FOR SALE, RENTAL OR FINANCING IS FROM SOURCES DEEMED RELIABLE SUCH INFORMATION HAS NOT BEEN VERIFIED, AND NO EXPRESS REPRESENTATION IS MADE NOR IS ANY TO BE IMPLIED AS TO THE ACCURACY THEREOF, AND IT IS SUBMITTED SUBJECT TO ERRORS, OMISSIONS, CHANGE OF PRICE, RENTAL OR OTHER CONDITIONS, PRIOR SALE, LEASE OR FINANCING, OR WITHDRAWAL WITHOUT NOTICE.