



2905 Two Notch Road

Columbia, South Carolina

Property Features

- ±22,722 SF
- ±12,922 SF office
- ±9,800 SF warehouse
- Zoning: GC, Richland County
- 400 AMP / 3 Phase Power
- Traffic Count: 16,900 VPD (Station 110)
- Sale Price: \$850,000 (\$37.41/SF)
- Lease Rates:
 - Office: \$6.00 SF NNN
 - Warehouse: \$4.00 SF NNN

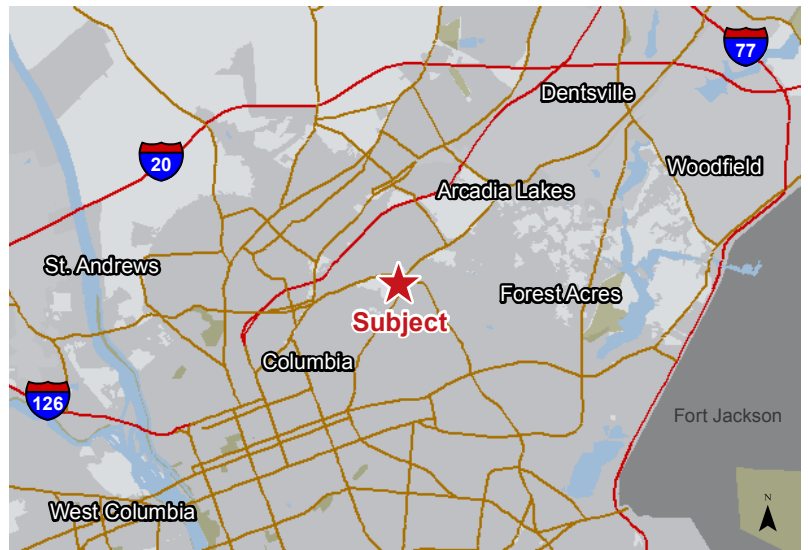

For more information: **John Gregory, PE**

+1 803 744 9896
jgregory@naicolumbia.com

Lee Bussell, Jr.

+1 803 744 9865
lbussell@naicolumbia.com

For Sale or Lease

±22,722 SF

Flex Space/Warehouse



Additional Building Features

- (4) Loading Docks
- (2) 10' x 10' Overhead Doors
- Center height: 14'-16"
- Eave: 13'-8"
- Natural Gas Connection
- Showroom quality office space
- Secure fence
- Possible laydown yard in back



For Sale or Lease

+22,722 SF

Flex Space/Warehouse



For Sale or Lease

±22,722 SF

Flex Space/Warehouse

Floor Plan

2905 Two Notch Road - Columbia, South Carolina

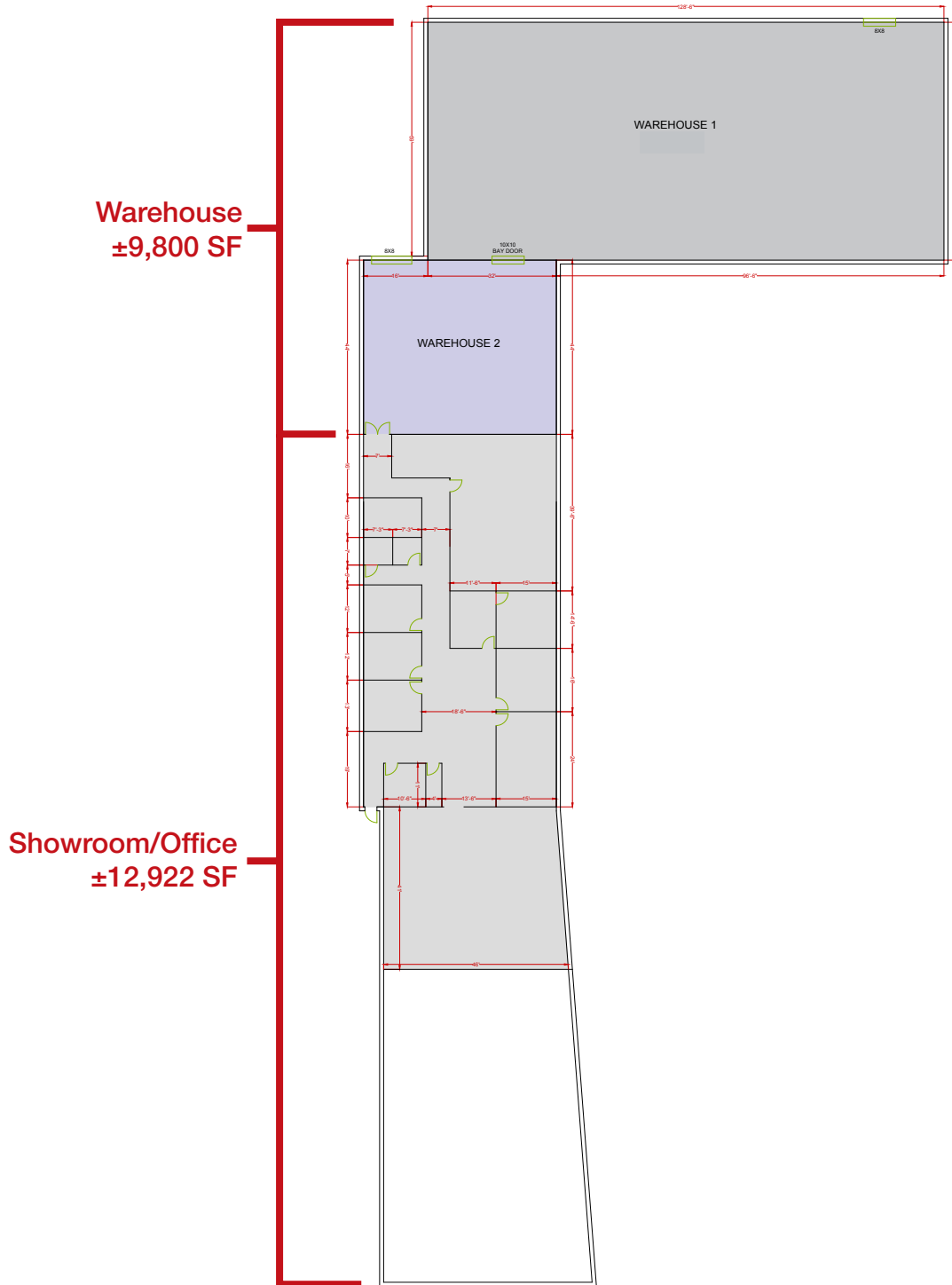

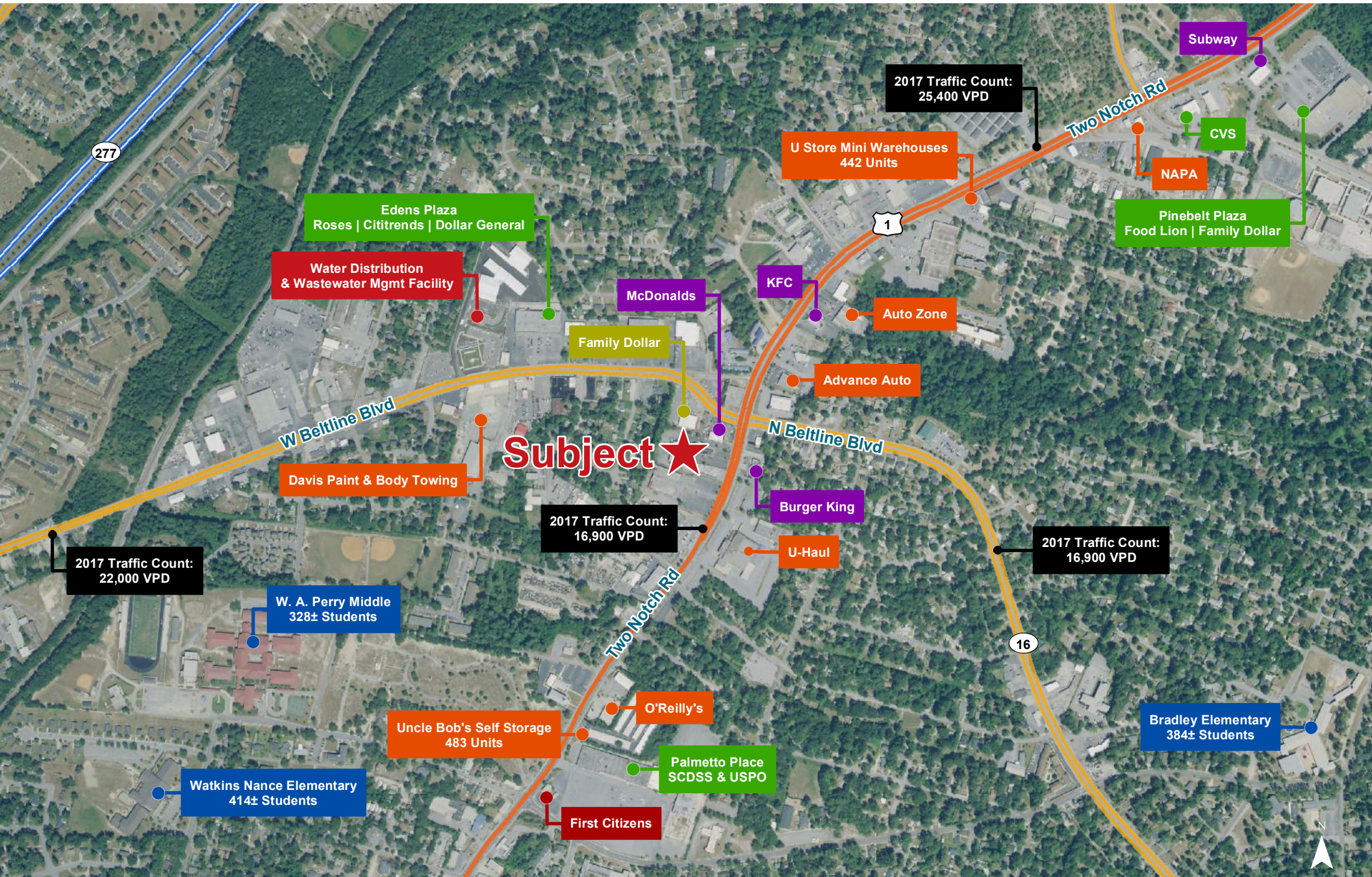

Map Updated: Monday, March 4, 2019. This information submitted is not guaranteed. Although obtained from reliable sources, all information should be confirmed prior to use or reliance upon the information. This document may not be reproduced in whole or in part without the express written consent of NAI Avant.