

2900
EAST 11TH STREET

LOS ANGELES, CA



FOR LEASE

±18,240 SF BUILDING SITUATED ON ±33,325 SF OF LAND



**CUSHMAN &
WAKEFIELD**

GILL | BURNS | YOO



Recently
Refurbished Dock
High Warehouse



Well Maintained
and Move-In Ready
Condition



Large Fenced Yard
Area for Excess
Parking and Storage



Capacity to
Accommodate
Multiple 53'
Containers



Immediate
Access to East LA
Interchange and
Freeways



Abundance of
Natural Light
in Office and
Warehouse Area

HIGHLIGHTS



 **TOTAL BUILDING**
±18,240 SF

 **YEAR BUILT**
1930

 **LOADING**
2 DH / 1 GL

 **LAND SIZE**
±33,325 SF
(±0.76 AC)

 **CLEAR HEIGHT**
±12'

 **PARKING**
±28 SPACES

 **OFFICE SIZE**
±3,897 SF

 **POWER**
200 AMPS

 **ZONING**
M3

SPECIFICATIONS

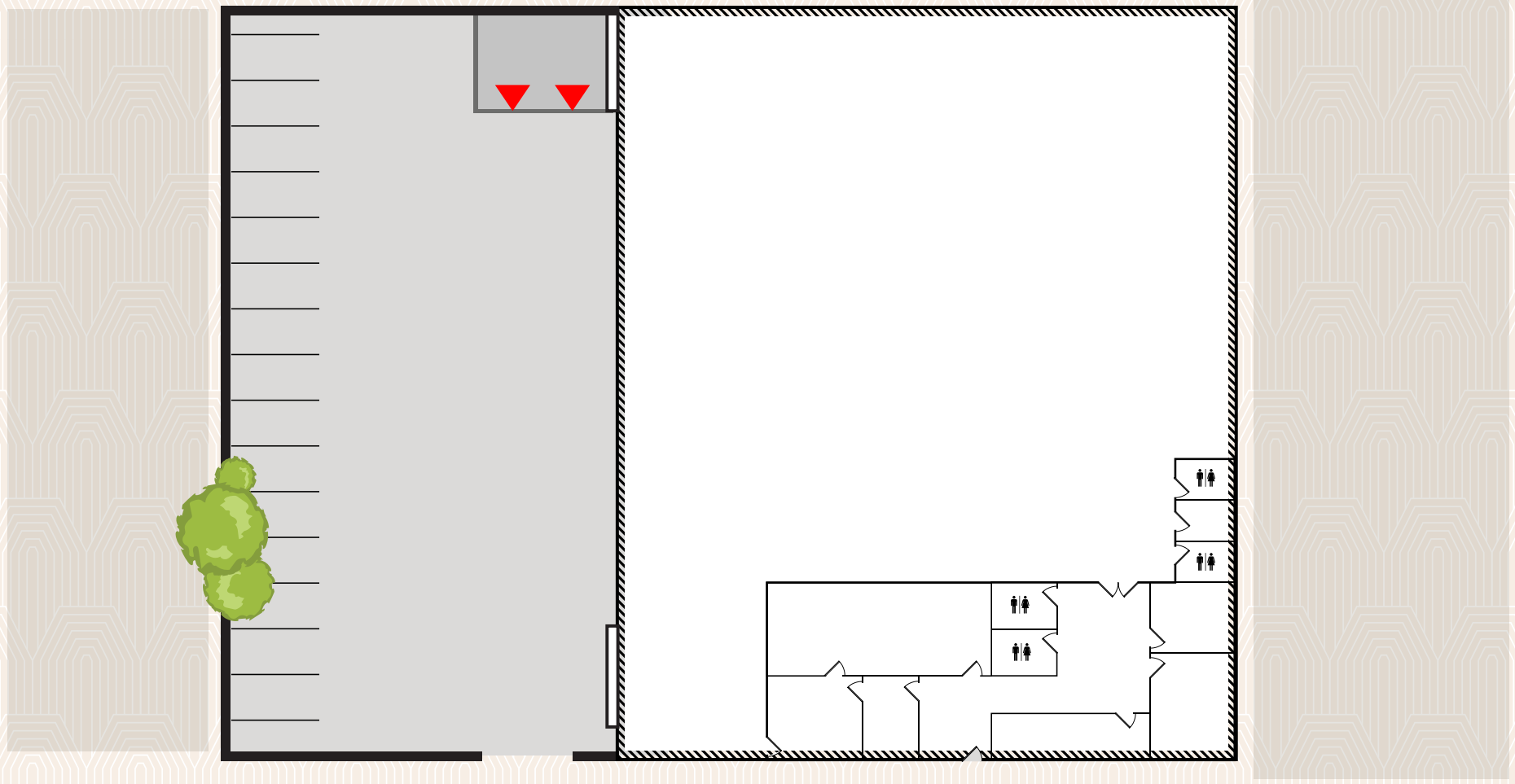

E 11TH STREET

 DOCK HIGH

NOTE: * THE ABOVE SITE PLAN IS NOT TO SCALE AND SIZES ARE APPROXIMATE - FOR DISCUSSION PURPOSES ONLY

SITE PLAN





2900
EAST 11TH STREET

POPULATION

3,398,405
Within a 10 Mile Radius of Property

\$87,526 Avg. Household Income	37.4 Median Age	26% College Degrees

DRIVING DISTANCE FROM PROPERTY

CHINATOWN:	3 MILES
DOWNTOWN:	4 MILES
KOREATOWN:	6 MILES
PASADENA:	11 MILES
BEVERLY HILLS:	12 MILES
LAX:	17 MILES
PORT OF LONG BEACH:	21 MILES

ACCESSIBILITY

BRANDON GILL

Executive Director

+1 213 629 6528

brandon.gill@cushwake.com

Lic 01262330

BRANDON BURNS

Executive Director

+1 213 629 6541

brandon.burns@cushwake.com

Lic 01194796

JAE YOO

Executive Director

+1 213 629 6551

jae.yoo@cushwake.com

Lic 01503567

DILLON KNEAFSEY

Associate

+1 213 629 6519

dillon.kneafsey@cushwake.com

Lic 02439066



©2026 Cushman & Wakefield. No warranty or representation, express or implied, is made to the accuracy or completeness of the information contained herein, and same is submitted subject to errors, omissions, change of price, rental or other conditions, withdrawal without notice, and to any special listing conditions imposed by the property owner(s). As applicable, we make no representation as to the condition of the property (or properties) in question.