

AOL.

3700 O'DONNELL STREET AT BREWERS HILL

CONTACT US TODAY

DAVID FIELDS
Senior Vice President
+1 410 244 3130
david.fields@cbre.com

ALEC MITCHELL
Associate
+1 410 244 3124
alexander.mitchell@cbre.com

www.cbre.com

CBRE

© 2016 CBRE, Inc. This information has been obtained from sources believed reliable. We have not verified it and make no guarantee, warranty or representation about it. Any projections, opinions, assumptions or estimates used are for example only and do not represent the current or future performance of the property. You and your advisors should conduct a careful, independent investigation of the property to determine to your satisfaction the suitability of the property for your needs. CBRE and the CBRE logo are service marks of CBRE, Inc. and/or its affiliated or related companies in the United States and other countries. All other marks displayed on this document are the property of their respective owners. PMStudio_March2016



PRIME SUBLEASE OPPORTUNITY

3700 O'DONNELL STREET AT BREWERS HILL

CBRE

PLUG & PLAY SPACE WITH FURNITURE AVAILABLE

PROPERTY HIGHLIGHTS

- 46,587 SF
- Q3 2016 Occupancy
- Sublease through June 30, 2022
- Rent is Negotiable
- Located at the historic Baltimore staple, former Natty Boh Beer brewery headquarters
- In the Natty East Building that is part of the Brewers Hill Project
- Parking is 3.0/1,000 SF lease with potential for free reserved spaces

AMENITIES

- Amenities in Brewers Hill include Panera Bread, Five Guys, PNC Bank, M•Power Yoga and Dunkin Donuts
- Located across the street from the amenities at Canton Crossing which include Harris Teeter, Chick-fil-A, Farmstead Shack, Iron Rooster, Mission BBQ, and Target

SPACE FEATURES

- 2nd floor mezzanine overlooking entire 1st floor
- Gym with showers
- Large outdoor roof deck that only future subtenant can access
- Large training/conference center



FLOORPLANS

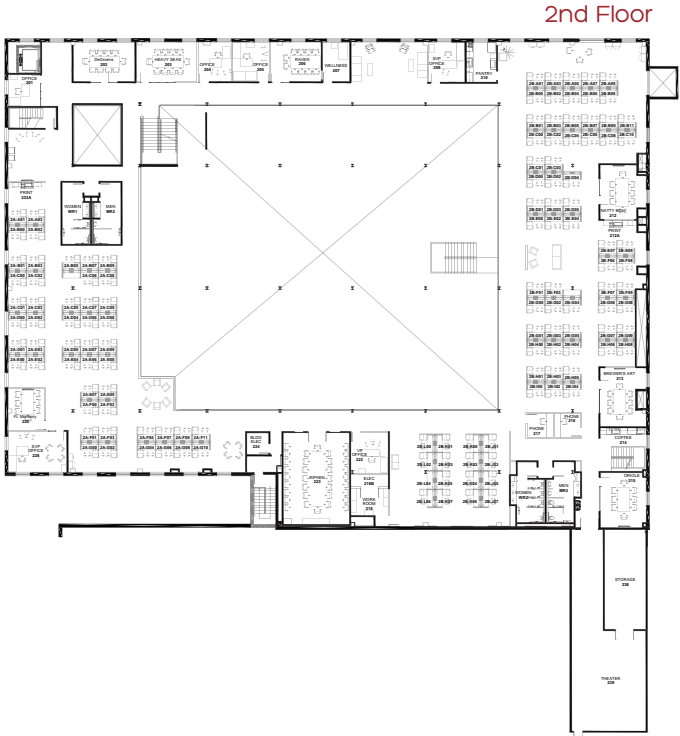
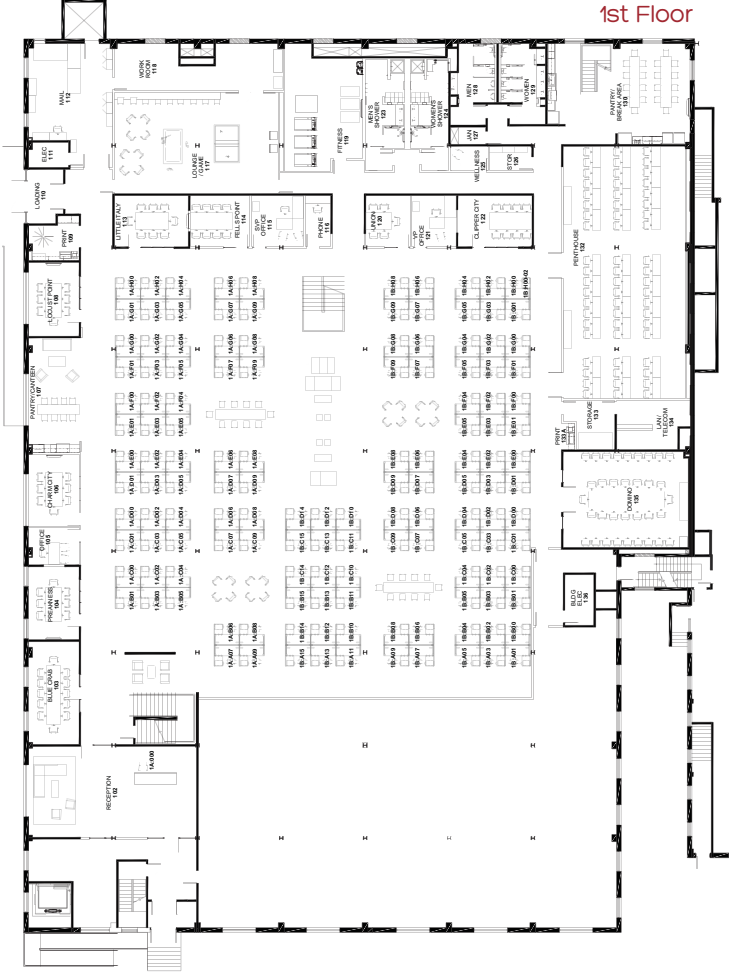

3700 O'DONNELL STREET
AT BREWERS HILL