

390-398 VIA EL CENTRO



OWNED &
OPERATED

FOR LEASE



SITE FEATURES

390-398 VIA EL CENTRO
OCEANSIDE, CALIFORNIA 92058



CAPITAL IMPROVEMENTS RENOVATIONS COMPLETED

- | NEW BUILDING BRANDING
- | NEW EXTERIOR LIGHTING
- | NEW EXTERIOR PAINT
- | NEW LANDSCAPE
- | NEW SIGNAGE



GAS |
SERVICE



PARKING |
AMPLE



PROXIMITY |
CLOSE TO AMENITIES



ACCESS |
OFF HIGHWAY 76 NEAR I-5 FREEWAY



YARDS |
FENCED & SECURED

SITE PLAN

390-398 VIA EL CENTRO
OCEANSIDE, CALIFORNIA 92058



| Suite | Suite SF | Yard & Loading Area | Asking Rate | Available Date |
|-------|-----------|--|------------------------|----------------|
| 392 | ±4,157 SF | 1 GL Roll-Up Door, Private Office, Reception, & Secured Yard | Negotiable + *Est. NNN | June 1, 2026 |

Est. NNN: \$0.32/SF



FLOOR PLAN

390-398 VIA EL CENTRO
OCEANSIDE, CALIFORNIA 92058

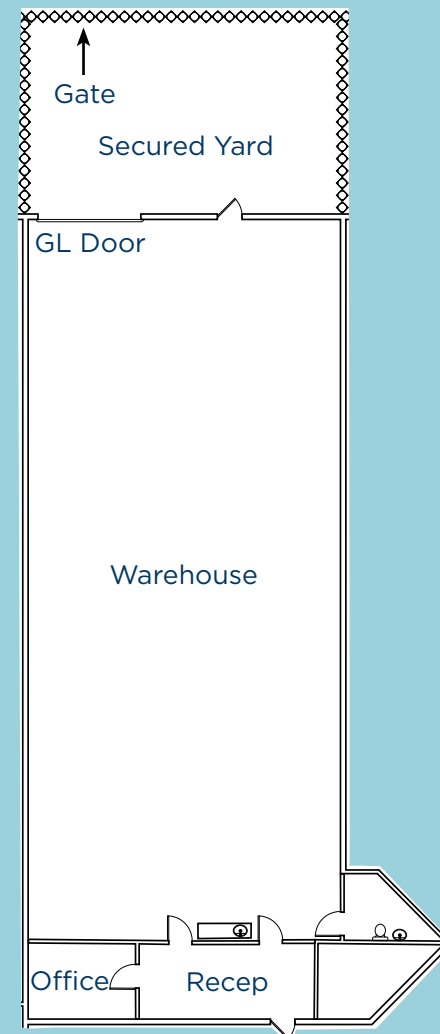

LOCATION

390-398 VIA EL CENTRO
OCEANSIDE, CALIFORNIA 92058

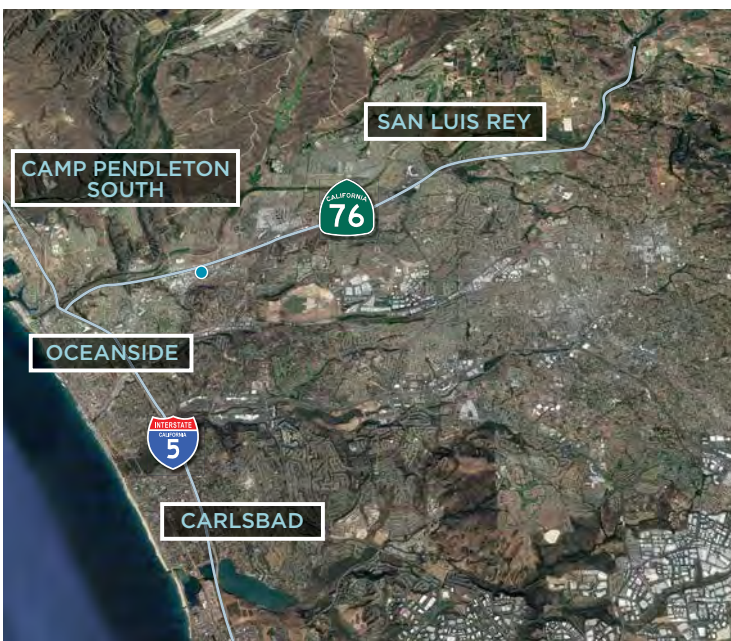

28,313 SF
MULTI-TENANT
INDUSTRIAL PROJECT

+ SECURED FENCED
YARD AREAS

DRIVE TIMES

MILES FROM PROPERTY

390-398 VIA EL CENTRO
OCEANSIDE, CALIFORNIA 92058



SAN DIEGO

REGIONAL OVERVIEW



Located along the Pacific Coast in Southern California, San Diego is world-famous for its 70 miles of pristine coastline, abundant sunshine and vast array of tourist attractions and amenities. As a scenic backdrop in which to live, work and play, the region is home to residents and businesses that have transformed San Diego into an economic powerhouse.

San Diego County attracts companies seeking a well-educated workforce, multifaceted transportation infrastructure, desirable quality of life and access throughout the region and around the globe.

\$91K \$282B +1.6M

MEDIAN INCOME

PRODUCED OF GRP

JOBS GENERATED

POPULAR ATTRACTIONS



HOTEL DEL CORONADO



2023

31.8M
VISITORS

\$14.3B
VISITOR SPENDING

22B
ANNUAL ECONOMIC
IMPACT

557K
ATTENDEES AT THE
CONVENTION CENTER

NORTH COUNTY

REGIONAL OVERVIEW



BUILDING & DESIGN

Hunter Industries

Nitto Group - Hydranautics | Watkins Manufacturing Group



CLEAN TECHNOLOGY

Baker Electric Solar | Poseidon Water
NRG Energy | Air Products and Chemicals, Inc.



INFORMATION & COMMUNICATIONS TECHNOLOGIES

ViaSat | Activision | Nordson Corp.
L3 Communications | Max-Linear



BIOTECHNOLOGY, BIOMEDICAL DEVICES & HEALTHCARE

DJO Global | Thermo Fischer Scientific | Genentech, Inc.
Ionis Pharmaceuticals | Breg, Inc. | Alphatec Spine
Gilead Sciences | GenMark Diagnostics | Zimmer Dental



ACTIVE LIFESTYLE SPORT

Taylormade | Callaway Golf | Puma Golf | GoPro | Stone Brewing
Titleist - Acushnet | Suja Juice | Columbia Sportswear | Reef



E. COMMERCE

Wayfair | Amazon

LIFESTYLE

126

MILES OF
HIKING TRAILS

57%

OF SAN DIEGO
GOLF COURSES

28

BEACHES

58

SCHOOLS

(RECEIVED 35% AWARDS)

45+

BREWERIES

JOB GROWTH FASTEST IN NORTH COUNTY

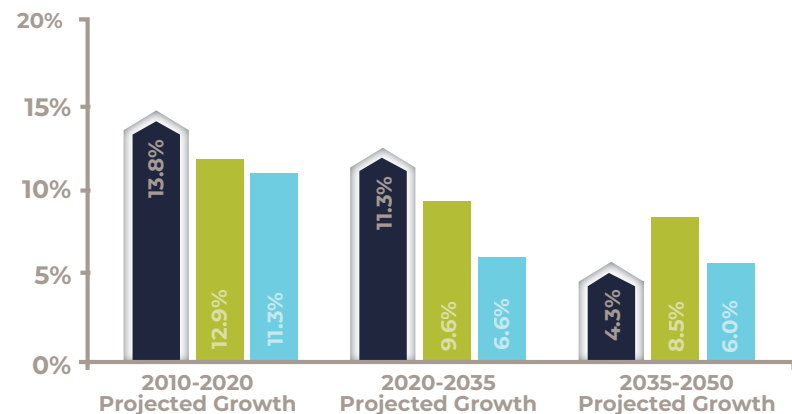

■ North County ■ San Diego County ■ Central County



©2026 Cushman & Wakefield. All rights reserved. The information contained in this communication is strictly confidential. This information has been obtained from sources believed to be reliable but has not been verified. NO WARRANTY OR REPRESENTATION, EXPRESS OR IMPLIED, IS MADE AS TO THE CONDITION OF THE PROPERTY (OR PROPERTIES) REFERENCED HEREIN OR AS TO THE ACCURACY OR COMPLETENESS OF THE INFORMATION CONTAINED HEREIN, AND SAME IS SUBMITTED SUBJECT TO ERRORS, OMISSIONS, CHANGE OF PRICE, RENTAL OR OTHER CONDITIONS, WITHDRAWAL WITHOUT NOTICE, AND TO ANY SPECIAL LISTING CONDITIONS IMPOSED BY THE PROPERTY OWNER(S). ANY PROJECTIONS, OPINIONS OR ESTIMATES ARE SUBJECT TO UNCERTAINTY AND DO NOT SIGNIFY CURRENT OR FUTURE PROPERTY PERFORMANCE.

TYLER STEMLEY

Director
San Diego Region
Dir +1 760 908 4270
tyler.stemley@cushwake.com
LIC #02003867

JOE CROTTY

Senior Director
San Diego Region
Dir +1 760 473 1811
joe.crotty@cushwake.com
LIC #01369821

CONOR BOYLE

Senior Director
San Diego Region
Dir +1 760 458 5739
conor.boyle@cushwake.com
LIC #01813305



Cushman & Wakefield
12830 El Camino Real
Suite 100
San Diego, CA 92130
cushmanwakefield.com