

CONTACT INFORMATION	
WATER:	CITY OF GREER 310 EAST FORTNEY STREET GREER, SC 29615 PHONE: (864) 881-2800
STORM DRAINAGE:	CITY OF GREER 310 EAST FORTNEY STREET GREER, SC 29615 PHONE: (864) 881-2800
SANITARY SEWER:	CITY OF GREER 310 EAST FORTNEY STREET GREER, SC 29615 PHONE: (864) 881-2800
ELECTRIC:	CITY OF GREER 310 EAST FORTNEY STREET GREER, SC 29615 PHONE: (864) 881-2800
PLANNING/ENGINEERING:	CITY OF GREER 310 EAST FORTNEY STREET GREER, SC 29615 PHONE: (864) 881-2800

SITE DATA	
SITE ADDRESS:	3248 BRUSHY CREEK ROAD GREER, SC 29615
OWNER/ENGINEER:	MAY GREENE 1710 W. GREENVILLE AVENUE RICHMOND, VA 23227
CIVIL ENGINEER:	SITE DESIGN, INC. 222 ROCKY CREEK ROAD GREENVILLE, SC 29615
ZONING:	RD MULTI-FAMILY RESIDENTIAL
PROJECT NAME:	13A MAY # 2
TAX MAP #:	806, 14, 17
BUILDING SETBACK:	FRONT: 30 FT SIDE: 14 FT REAR: 30 FT
BUILDING FOOTPRINT:	3,300 SQ. FT.
RETAINING WALL PRESENT:	NO

TOTAL SITE AREA	1.89 ACRES
DISTURBED AREA	1.6 ACRES
DEVELOP IMPERVIOUS AREA	0.73 ACRES
OPEN SPACE AREA	1.2 ACRES
RECEIVING STREAM	UNNAMED TRIBUTARY EMBORNE RIVER
ULTIMATE RECEIVING STREAM	EMBORNE RIVER
CUT/FILL ESTIMATE	Cut: 2100 Cy / Fill: 2850 Cy

The contractor shall coordinate with the engineer of record for a staking plan to be used for the construction of the project. The contractor shall be responsible for survey stakes and field conditions shall be reported to the engineer of record immediately for resolution prior to installation of proposed improvements.

24-HOUR CONTACT
MAY GREENE
MANAGER
909-666-0335

ENGINEER'S CERTIFICATION STATEMENT
I have prepared my signature and seal on this design document in accordance with the provisions of the South Carolina Code of Laws, Title 46, Chapter 14, of the Code of Laws of S.C., 1976 as amended, and the provisions of the South Carolina Code of Regulations, 73-20, and I am a duly Licensed Professional Engineer in the State of South Carolina, License No. 34002.

MIRASOL VILLAS

(FORMERLY BRUSHY CREEK TRIPLEXES)

CITY OF GREER
GREENVILLE COUNTY, SOUTH CAROLINA

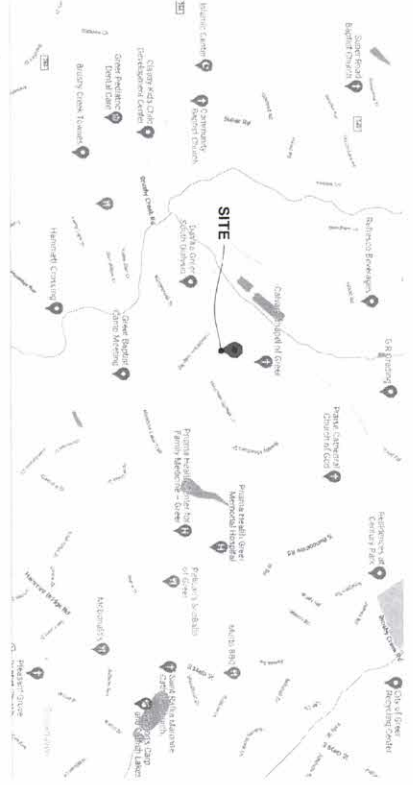

I certify that the land disturbing activity will be accomplished to the plan approved by the City of Greer and SOUCCS.

I acknowledge as the property owner and person ultimately responsible for the land disturbing activity at on-site inspection.

- ENCROACHMENT NOTES**
1. PRIOR TO CONSTRUCTION, ALL ENCROACHMENT FEATURES SHALL BE IDENTIFIED PER THE SWAMP AND FOREWATER MAP.
 2. CONSTRUCTION SHALL OCCUR AT ALL COSTS TO AVOID ANY ENCROACHMENT ON TO SWAMP AND FOREWATER AREAS.
 3. ANY ENCROACHMENT SHALL BE IDENTIFIED AND REMOVED PRIOR TO CONSTRUCTION.
 4. ANY ENCROACHMENT SHALL BE IDENTIFIED AND REMOVED PRIOR TO CONSTRUCTION.
 5. ANY ENCROACHMENT SHALL BE IDENTIFIED AND REMOVED PRIOR TO CONSTRUCTION.
 6. ANY ENCROACHMENT SHALL BE IDENTIFIED AND REMOVED PRIOR TO CONSTRUCTION.

TASKS	MONTHS												
	1	2	3	4	5	6	7	8	9	10	11	12	
DETERMINE LIMITS OF CONDT.													
INITIAL CONSTRUCTION PERMIT													
INITIAL UTILITY CONSTRUCTION													
DEVELOP AND CONSTRUCT													
FINAL UTILITY CONSTRUCTION													
FINAL CONSTRUCTION													
FINAL OPERATIONS													
FINAL SWAMP AND FOREWATER													
FINAL SWAMP AND FOREWATER													

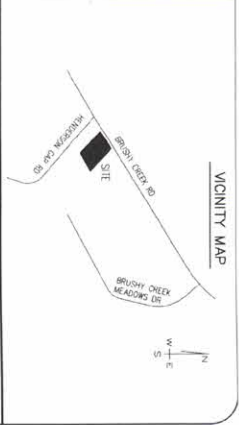

SHEET INDEX

COVER:	1	OF	17
C01 EXISTING CONDITIONS AND	2	OF	17
C02 SITE PLAN	3	OF	17
C03 SITE PLAN DETAILS	4	OF	17
C04 SWAMPY PHASE PLAN	5	OF	17
C05 SWAMPY NOTES	6	OF	17
C06 SWAMPY NOTES	7	OF	17
C07 SWAMPY NOTES	8	OF	17
C08 SWAMPY NOTES	9	OF	17
C09 SWAMPY NOTES	10	OF	17
C10 SWAMPY NOTES	11	OF	17
C11 SWAMPY NOTES	12	OF	17
C12 SWAMPY NOTES	13	OF	17
C13 SWAMPY NOTES	14	OF	17
C14 SWAMPY NOTES	15	OF	17
C15 SWAMPY NOTES	16	OF	17
C16 SWAMPY NOTES	17	OF	17

811
Know what's below
Call before you dig

CAUTION
Know what's below
Call before you dig

THE INFORMATION CONTAINED ON THIS DRAWING IS THE PROPERTY OF SITE DESIGN, INC. AND IS NOT TO BE REPRODUCED OR TRANSMITTED IN ANY FORM OR BY ANY MEANS, ELECTRONIC OR MECHANICAL, INCLUDING PHOTOCOPYING, RECORDING, OR BY ANY INFORMATION STORAGE AND RETRIEVAL SYSTEM, WITHOUT THE WRITTEN PERMISSION OF SITE DESIGN, INC.

SITE DESIGN, INC.
CIVIL ENGINEERS - SURVEYORS - LANDSCAPE ARCHITECTS

WWW.SITEDSIGN-INC.COM
222 ROCKY CREEK ROAD
GREENVILLE, SC 29615
PH: (864) 271-0496

MIRASOL VILLAS

SEAL C.O.A. REVISIONS

NO.	DATE	REVISIONS
1		
2		
3		
4		
5		
6		
7		
8		
9		
10		
11		
12		

SHEET NUMBER 1 OF 12

SITE PLAN KEY	
1	CONCRETE DRIVEWAY
2	12" CONCRETE UTILITY TRENCH
3	4" PAINTED ASPHALT DRIVEWAY
4	FULL ACCESS DRIVEWAY
5	8" TOP ROAD & 3" TOP DRIVE
6	4" CHAIN LINK FENCE
7	MAIL ROOM
8	CONCRETE FLOOR
9	UNDERGROUND UTILITY TRENCH
10	UNDERGROUND UTILITY TRENCH
11	UNDERGROUND UTILITY TRENCH
12	PER WASTE STATION
13	STEPS
14	LIGHT TOWER

SITE DATA	
SITE ADDRESS	3346 BRUSHY CREEK ROAD
OWNER/CLIENT/OWNER	DAVID G. HARRIS & SONS, LLC
CONTRACT NUMBER	18-0000000011
DATE	08/23/2022
DESIGNER	DAVID G. HARRIS & SONS, LLC
PROJECT USE	RESIDENTIAL
TAX MAP #	000000000011
BUILDING SETBACK	5.0 FT
DRAINAGE ESTIMATE	0.5% (SEE PLAN)
PERMISSING AGENCY	DAVID G. HARRIS & SONS, LLC
PERMISSING DATE	08/23/2022

ACCESS NOTE
 EACH PROPERTY OWNER IS PROVIDED ACCESS TO A PUBLIC ROAD BY A PRIVATE ROAD OR WHICH EACH PROPERTY OWNER HAS THE RIGHT TO USE. ACCESS SHALL NOT BE ACCEPTED AND MAINTAINED AS A PUBLIC ROAD UNLESS THE PROPERTY OWNER HAS BEEN ADVISED BY THE CITY ENGINEER.

PARKING DATA:

MIN. TRUCKS - 3	SERVICE (INCLUDING 2 SERVICES)	11 SPACES	MIN. SPACES	33 SPACES
TOTAL SITE - 36 SPACES (12 MIN. MIN. TRUCKS)				
ZONING - CONCURRENT (MULTI-FAMILY)				
PROPOSED DRD				
SETBACKS - 5'				
REAR - 20'				
SIDES - 10'				

SITE DATA:

PERM. 0000000011				
TOTAL SITE - 36 SPACES (12 MIN. MIN. TRUCKS)				
ZONING - CONCURRENT (MULTI-FAMILY)				
PROPOSED DRD				
SETBACKS - 5'				
REAR - 20'				
SIDES - 10'				

LOCATION MAP

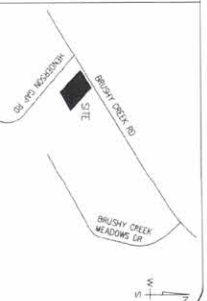

NOT TO SCALE

SITE NOTES:

- THE CONTRACTOR SHALL VERIFY THE LOCATION OF ALL UNDERGROUND UTILITIES BY CALLING JETTY LOCATION SERVICE AT 311 THREE (3) DAYS PRIOR TO CONSTRUCTION. PROPERTY ARE TO STATE OF DATA. STATEMENT OF PARKING SHALL ON FACE OF BUILDING UNLESS OTHERWISE NOTED.
- REFER TO THE ARCHITECTURAL DRAWINGS FOR EXACT INCLUDING DIMENSIONS AND ENTRY/EXIT POSITIONS.
- ASPHALT DRIVEWAYS SHALL BE CONSTRUCTED PER THE DETAILS.
- CONCRETE DRIVEWAYS SHALL BE CONSTRUCTED WITH 3000 PSI CONCRETE 4" THICK WITH EXPANSION JOINTS AND SCORING PER DETAIL.
- THE CONTRACTOR SHALL CONDUCT ALL WORK IN ACCORDANCE WITH THE LATEST REQUIREMENTS OF THE OCCUPATIONAL SAFETY AND HEALTH ADMINISTRATION.
- ALL WORK ON SITE SHALL BE IN ACCORDANCE WITH THE LATEST REQUIREMENTS OF THE OCCUPATIONAL SAFETY AND HEALTH ADMINISTRATION.
- ALL CONCRETE SHALL BE 3000 PSI CONCRETE WITH 3000 PSI CONCRETE.
- ANY MATERIALS UNLAWFULLY AS INDICATED ON THIS PLAN IS TO BE REMOVED OFF-SITE.
- UNLAWFULLY AS INDICATED ON THIS PLAN IS TO BE REMOVED OFF-SITE.
- UNLAWFULLY AS INDICATED ON THIS PLAN IS TO BE REMOVED OFF-SITE.
- UNLAWFULLY AS INDICATED ON THIS PLAN IS TO BE REMOVED OFF-SITE.
- UNLAWFULLY AS INDICATED ON THIS PLAN IS TO BE REMOVED OFF-SITE.
- UNLAWFULLY AS INDICATED ON THIS PLAN IS TO BE REMOVED OFF-SITE.
- UNLAWFULLY AS INDICATED ON THIS PLAN IS TO BE REMOVED OFF-SITE.
- UNLAWFULLY AS INDICATED ON THIS PLAN IS TO BE REMOVED OFF-SITE.

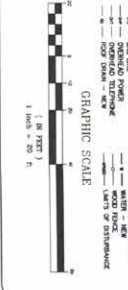
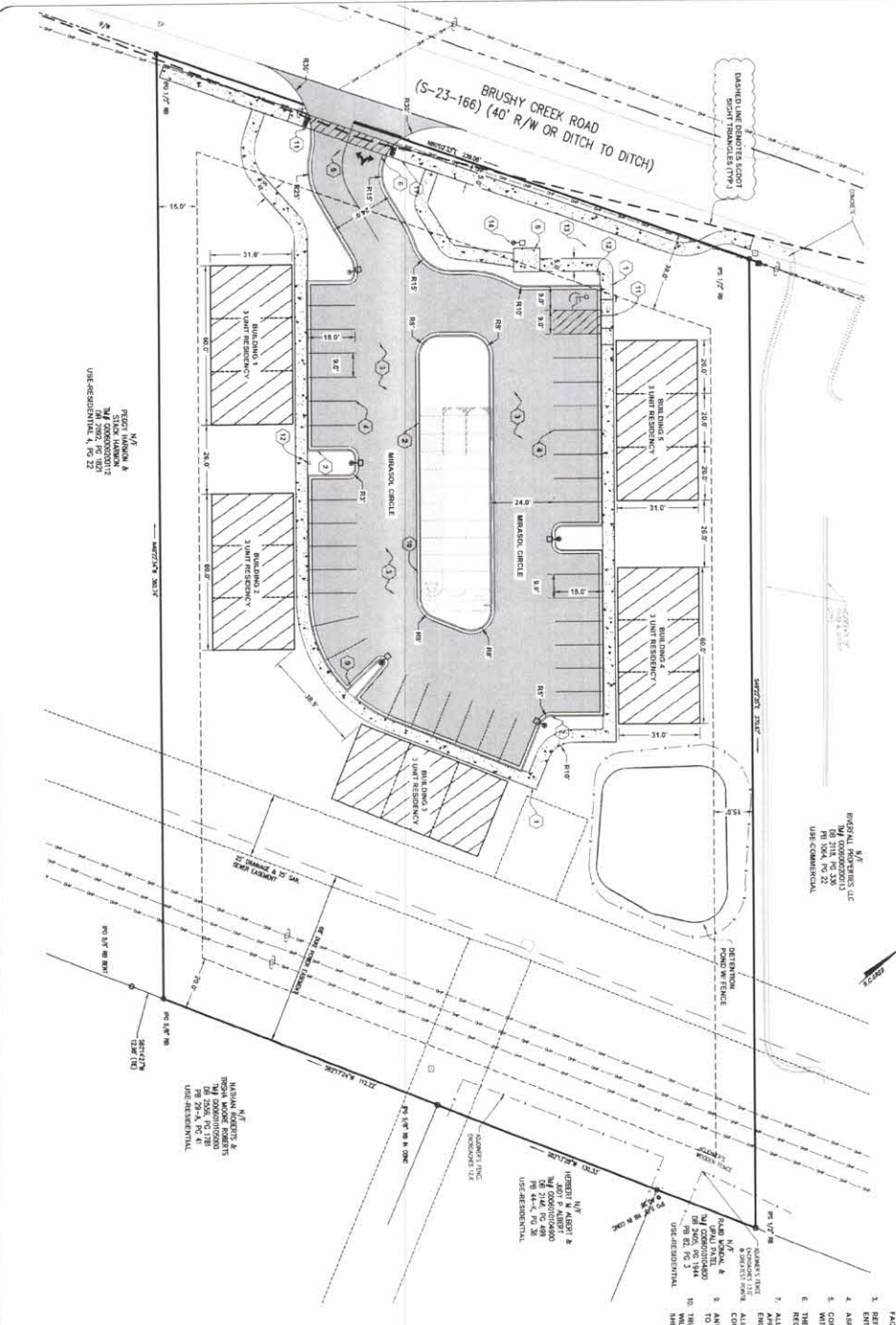

GRAPHIC SCALE
 0 10 20 30 40 50 60 70 80 90 100 FEET

LEGEND

SYMBOL	DESCRIPTION
1	CONCRETE DRIVEWAY
2	12" CONCRETE UTILITY TRENCH
3	4" PAINTED ASPHALT DRIVEWAY
4	FULL ACCESS DRIVEWAY
5	8" TOP ROAD & 3" TOP DRIVE
6	4" CHAIN LINK FENCE
7	MAIL ROOM
8	CONCRETE FLOOR
9	UNDERGROUND UTILITY TRENCH
10	UNDERGROUND UTILITY TRENCH
11	UNDERGROUND UTILITY TRENCH
12	PER WASTE STATION
13	STEPS
14	LIGHT TOWER



CAUTION
 Call before you dig.

MIRASOL VILLAS (TRIPLE EXES)
 CITY OF GREER, GREENVILLE COUNTY, SOUTH CAROLINA

SITE DESIGN, INC.
 CIVIL ENGINEERS - SURVEYORS - LANDSCAPE ARCHITECTS

www.sitedesign-inc.com
 225 ROCKY CREEK ROAD
 GREENVILLE, SC 29615
 PH: 864.381.0999

NO.	DESCRIPTION	DATE
1	FINAL CITY OF GREER PLAN SET	08/23/2022
2	REVISIONS PER CITY OF GREER COMMENTS	05/12/2022
3	REVISIONS PER CITY OF GREER COMMENTS	04/12/2022

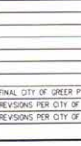

S.C. REG. NO. 2280

NO.	DESCRIPTION	DATE
1	FINAL CITY OF GREER PLAN SET	08/23/2022
2	REVISIONS PER CITY OF GREER COMMENTS	05/12/2022
3	REVISIONS PER CITY OF GREER COMMENTS	04/12/2022

GRAPHIC SCALE
 0 10 20 30 40 50 60 70 80 90 100 FEET

C200
 SHEET 1 OF 18

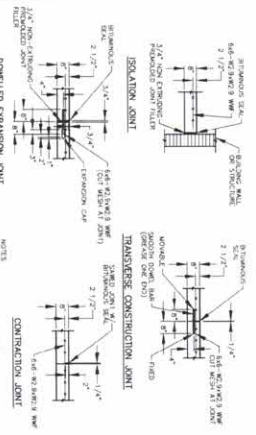
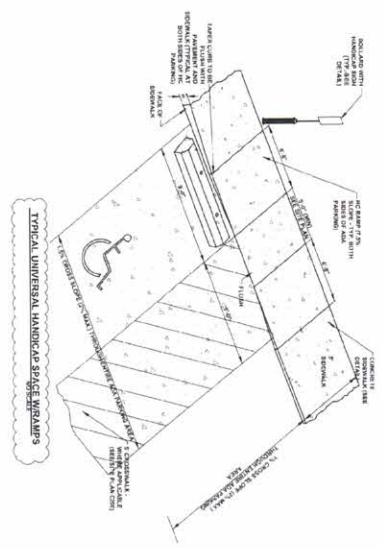
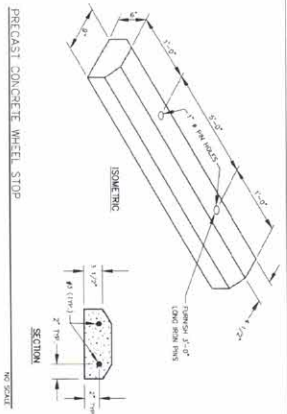

TYPICAL CONCRETE PAVEMENT JOINTS

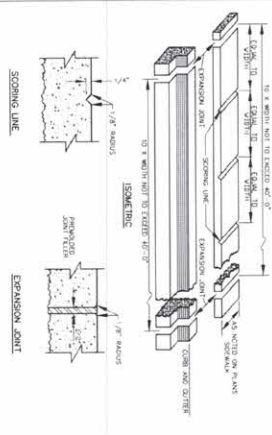

TYPICAL CONCRETE PAVEMENT JOINTS

NOTES:
 1. EXPANSION JOINTS, 3/4" THICK, SHALL BE PLACED AT THE P.C. AND P.T. OF ALL CONCRETE AT THE OUTER EDGES OF THE PAVEMENT.
 2. JOINTS SHALL BE PLACED AT THE P.C. AND P.T. OF ALL CONCRETE AT THE OUTER EDGES OF THE PAVEMENT.
 3. JOINTS SHALL BE PLACED AT THE P.C. AND P.T. OF ALL CONCRETE AT THE OUTER EDGES OF THE PAVEMENT.
 4. JOINTS SHALL BE PLACED AT THE P.C. AND P.T. OF ALL CONCRETE AT THE OUTER EDGES OF THE PAVEMENT.
 5. JOINTS SHALL BE PLACED AT THE P.C. AND P.T. OF ALL CONCRETE AT THE OUTER EDGES OF THE PAVEMENT.
 6. JOINTS SHALL BE PLACED AT THE P.C. AND P.T. OF ALL CONCRETE AT THE OUTER EDGES OF THE PAVEMENT.
 7. JOINTS SHALL BE PLACED AT THE P.C. AND P.T. OF ALL CONCRETE AT THE OUTER EDGES OF THE PAVEMENT.

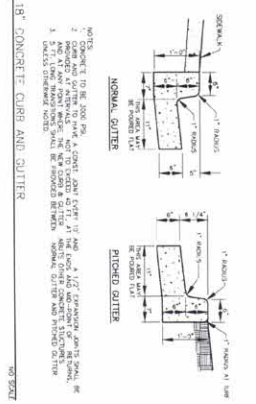

TYPICAL CONCRETE CURB AND GUTTER

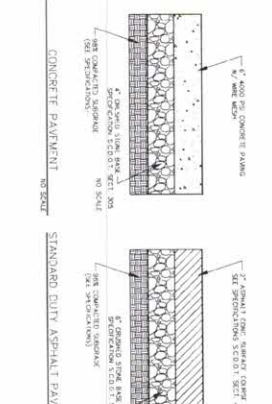

TYPICAL CONCRETE CURB AND GUTTER

NOTES:
 1. CONCRETE TO BE 4000 PSI.
 2. REINFORCEMENT SHALL BE #4 BARS.
 3. JOINTS SHALL BE PLACED AT THE P.C. AND P.T. OF ALL CONCRETE AT THE OUTER EDGES OF THE PAVEMENT.
 4. JOINTS SHALL BE PLACED AT THE P.C. AND P.T. OF ALL CONCRETE AT THE OUTER EDGES OF THE PAVEMENT.
 5. JOINTS SHALL BE PLACED AT THE P.C. AND P.T. OF ALL CONCRETE AT THE OUTER EDGES OF THE PAVEMENT.

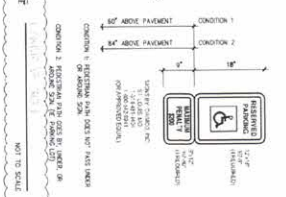
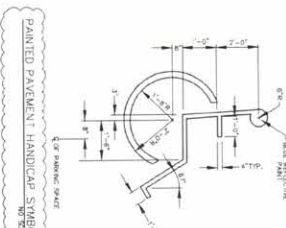

SITE DESIGN, INC.
 CIVIL ENGINEERS - SURVEYORS - LANDSCAPE ARCHITECTS

www.sitedesigninc.com
 205 ROCKY CREEK ROAD
 GREENVILLE, SC 29615
 PH: 864.627.0499

NO.	DATE	REVISIONS
1	06/23/2022	FINAL CITY OF GREER PLAN SET
2	05/27/2022	REVISIONS PER CITY OF GREER COMMENTS
3	04/12/2022	REVISIONS PER CITY OF GREER COMMENTS

MIRASOL VILLAS
 (BRUSHY CREEK TRIPLEXES)

CITY OF GREER
 GREENVILLE COUNTY
 SOUTH CAROLINA

S.C. REG NO 2280

C250

SHEET 4 OF 19

SITE PLAN DETAILS

DATE: 05/24/2022
 CHECKED BY: CH
 DESIGNED BY: CH
 SCALE: N/A
 SHEET NO: C250



I have prepared my signature and seal on the design documents submitted applying that I accept responsibility for the design of the project. I have prepared this design in accordance with the requirements of the NC Code Chapter 14, General Engineering, and the Rules and Regulations of the Board of Professional Engineers, Surveyors and Landscapers, and I am not aware of any conditions of disqualification.

MAINTENANCE STATEMENT

EROSION CONTROL MEASURES SHALL BE MAINTAINED AT ALL TIMES. IF FULL IMPLEMENTATION OF THE APPROVED PLAN, DESIGN, CONSTRUCTION AND EROSION CONTROL MEASURES SHALL BE IMPLEMENTED TO CONTROL OR TREAT THE SEDIMENT FROM THE SITE.

24-HOUR CONTACT

MANAGER GENERAL CORP
565-466-4933

STABILIZED STATES WITHIN 7 DAYS

STABILIZED STATES WITHIN 7 DAYS OF CONSTRUCTION SHALL BE BROUGHT TO FINISHED GRADE.

ALL DISTURBED AREAS WHICH HAVE NOT BEEN PAVED OR LANDSCAPED PLANTS & MULCH SHALL BE GRESSED WITH PERMANENT MULCH. ALL MULCH SHALL BE THE CONTRACTOR'S RESPONSIBILITY TO ESTABLISH THE STABILIZATION PRIOR TO CERTIFICATE OF OCCUPANCY. CONTRACTOR SHALL WATER AS NECESSARY TO PROVIDE WORKABLE STAND OF GRASS.

CONSTRUCTION SHALL COMPLY WITH ALL LOCAL, STATE AND FEDERAL REGULATIONS AND ORDINANCES RELATIVE TO EROSION CONTROL AND SEDIMENT CONTROL. THE CONTRACTOR SHALL BE RESPONSIBLE FOR OBTAINING ALL NECESSARY PERMITS AND APPROVALS FROM THE CITY OF GREER.

TOTAL SITE DISTURBANCE:

12 ACRES

LOCATION MAP



CONSTRUCTION SEQUENCE

1. THE CONTRACTOR WILL CONTACT THE ENGINEER OF RECORD WHO WILL SET UP A CONSTRUCTION SEQUENCE.
2. DETERMINE LIMITS OF CONSTRUCTION.
3. INSTALL Silt Fence and other initial erosion prevention & sediment control.
4. INITIAL STORM DRAINAGE FACILITIES WITH Silt FENCE PROTECTION SHALL BE INSTALLED AT EACH INLET AT THE END OF EVERY DAY OPERATIONS OR BEFORE SIGNIFICANT RAIN.
5. GRADE FOR BUILDING PAD AND THE GRADE FOR PAVING OR DRIVING PAD SHALL BE ESTABLISHED AND MAINTAINED THROUGHOUT CONSTRUCTION TO PREVENT EROSION.
6. ROADWAY OPERATIONS SHALL BE PAVED, CONVERT THE Silt FENCE PROTECTION TO TYPE C.
7. MAINTAIN ALL DISTURBED AREAS INCLUDING THE ROAD IMMEDIATELY WITH THE GRASSING WORKSHOPS STAND OF GRADE.
8. MAINTAIN ALL DISTURBED AREAS INCLUDING THE ROAD IMMEDIATELY WITH THE GRASSING WORKSHOPS STAND OF GRADE.
9. MAINTAIN ALL DISTURBED AREAS INCLUDING THE ROAD IMMEDIATELY WITH THE GRASSING WORKSHOPS STAND OF GRADE.
10. AFTER COMPLETION OF CONSTRUCTION AND SITE IS STABILIZED, REMOVE Silt FENCE.
11. AFTER COMPLETION OF CONSTRUCTION AND SITE IS STABILIZED, REMOVE Silt FENCE.
12. AFTER COMPLETION OF CONSTRUCTION AND SITE IS STABILIZED, REMOVE Silt FENCE.

SMPPP CLOSURE PROCEDURES

1. NO LATER THAN 30 DAYS BEFORE PROJECT COMPLETION, THE CONTRACTOR SHALL REQUEST AN INITIAL CLOSURE INSPECTION WITH THE ENGINEER OF RECORD TO DETERMINE IF THE SITE IS READY FOR CLOSURE.
2. UPON COMPLETION OF THE CLOSURE INSPECTION, THE ENGINEER WILL SIGNIFY AN APPLICATION FOR PERMIT CLOSURE TO THE CITY OF GREER FOR ACCEPTANCE AND APPROVAL.
3. UPON ACCEPTANCE AND APPROVAL, OR CLOSURE APPLICATION, SCHEDULE A FINAL SHPPP CLOSURE INSPECTION WITH THE CITY OF GREER PRIOR TO RECEIVING OF THE CLOSURE PERMIT.
4. FINAL SHPPP CLOSURE INSPECTION WITH THE CITY OF GREER PRIOR TO RECEIVING OF THE CLOSURE PERMIT.

USE RESIDENTIAL

1. MAINTAIN ALL DISTURBED AREAS INCLUDING THE ROAD IMMEDIATELY WITH THE GRASSING WORKSHOPS STAND OF GRADE.

2. MAINTAIN ALL DISTURBED AREAS INCLUDING THE ROAD IMMEDIATELY WITH THE GRASSING WORKSHOPS STAND OF GRADE.

3. MAINTAIN ALL DISTURBED AREAS INCLUDING THE ROAD IMMEDIATELY WITH THE GRASSING WORKSHOPS STAND OF GRADE.

USE RESIDENTIAL

1. MAINTAIN ALL DISTURBED AREAS INCLUDING THE ROAD IMMEDIATELY WITH THE GRASSING WORKSHOPS STAND OF GRADE.

2. MAINTAIN ALL DISTURBED AREAS INCLUDING THE ROAD IMMEDIATELY WITH THE GRASSING WORKSHOPS STAND OF GRADE.

3. MAINTAIN ALL DISTURBED AREAS INCLUDING THE ROAD IMMEDIATELY WITH THE GRASSING WORKSHOPS STAND OF GRADE.

USE RESIDENTIAL

1. MAINTAIN ALL DISTURBED AREAS INCLUDING THE ROAD IMMEDIATELY WITH THE GRASSING WORKSHOPS STAND OF GRADE.

2. MAINTAIN ALL DISTURBED AREAS INCLUDING THE ROAD IMMEDIATELY WITH THE GRASSING WORKSHOPS STAND OF GRADE.

3. MAINTAIN ALL DISTURBED AREAS INCLUDING THE ROAD IMMEDIATELY WITH THE GRASSING WORKSHOPS STAND OF GRADE.

USE RESIDENTIAL

1. MAINTAIN ALL DISTURBED AREAS INCLUDING THE ROAD IMMEDIATELY WITH THE GRASSING WORKSHOPS STAND OF GRADE.

2. MAINTAIN ALL DISTURBED AREAS INCLUDING THE ROAD IMMEDIATELY WITH THE GRASSING WORKSHOPS STAND OF GRADE.

3. MAINTAIN ALL DISTURBED AREAS INCLUDING THE ROAD IMMEDIATELY WITH THE GRASSING WORKSHOPS STAND OF GRADE.

USE RESIDENTIAL

1. MAINTAIN ALL DISTURBED AREAS INCLUDING THE ROAD IMMEDIATELY WITH THE GRASSING WORKSHOPS STAND OF GRADE.

2. MAINTAIN ALL DISTURBED AREAS INCLUDING THE ROAD IMMEDIATELY WITH THE GRASSING WORKSHOPS STAND OF GRADE.

3. MAINTAIN ALL DISTURBED AREAS INCLUDING THE ROAD IMMEDIATELY WITH THE GRASSING WORKSHOPS STAND OF GRADE.

USE RESIDENTIAL

1. MAINTAIN ALL DISTURBED AREAS INCLUDING THE ROAD IMMEDIATELY WITH THE GRASSING WORKSHOPS STAND OF GRADE.

2. MAINTAIN ALL DISTURBED AREAS INCLUDING THE ROAD IMMEDIATELY WITH THE GRASSING WORKSHOPS STAND OF GRADE.

3. MAINTAIN ALL DISTURBED AREAS INCLUDING THE ROAD IMMEDIATELY WITH THE GRASSING WORKSHOPS STAND OF GRADE.

USE RESIDENTIAL

1. MAINTAIN ALL DISTURBED AREAS INCLUDING THE ROAD IMMEDIATELY WITH THE GRASSING WORKSHOPS STAND OF GRADE.

2. MAINTAIN ALL DISTURBED AREAS INCLUDING THE ROAD IMMEDIATELY WITH THE GRASSING WORKSHOPS STAND OF GRADE.

3. MAINTAIN ALL DISTURBED AREAS INCLUDING THE ROAD IMMEDIATELY WITH THE GRASSING WORKSHOPS STAND OF GRADE.

USE RESIDENTIAL

1. MAINTAIN ALL DISTURBED AREAS INCLUDING THE ROAD IMMEDIATELY WITH THE GRASSING WORKSHOPS STAND OF GRADE.

2. MAINTAIN ALL DISTURBED AREAS INCLUDING THE ROAD IMMEDIATELY WITH THE GRASSING WORKSHOPS STAND OF GRADE.

3. MAINTAIN ALL DISTURBED AREAS INCLUDING THE ROAD IMMEDIATELY WITH THE GRASSING WORKSHOPS STAND OF GRADE.

USE RESIDENTIAL

1. MAINTAIN ALL DISTURBED AREAS INCLUDING THE ROAD IMMEDIATELY WITH THE GRASSING WORKSHOPS STAND OF GRADE.

2. MAINTAIN ALL DISTURBED AREAS INCLUDING THE ROAD IMMEDIATELY WITH THE GRASSING WORKSHOPS STAND OF GRADE.

3. MAINTAIN ALL DISTURBED AREAS INCLUDING THE ROAD IMMEDIATELY WITH THE GRASSING WORKSHOPS STAND OF GRADE.

USE RESIDENTIAL

1. MAINTAIN ALL DISTURBED AREAS INCLUDING THE ROAD IMMEDIATELY WITH THE GRASSING WORKSHOPS STAND OF GRADE.

2. MAINTAIN ALL DISTURBED AREAS INCLUDING THE ROAD IMMEDIATELY WITH THE GRASSING WORKSHOPS STAND OF GRADE.

3. MAINTAIN ALL DISTURBED AREAS INCLUDING THE ROAD IMMEDIATELY WITH THE GRASSING WORKSHOPS STAND OF GRADE.

USE RESIDENTIAL

1. MAINTAIN ALL DISTURBED AREAS INCLUDING THE ROAD IMMEDIATELY WITH THE GRASSING WORKSHOPS STAND OF GRADE.

2. MAINTAIN ALL DISTURBED AREAS INCLUDING THE ROAD IMMEDIATELY WITH THE GRASSING WORKSHOPS STAND OF GRADE.

3. MAINTAIN ALL DISTURBED AREAS INCLUDING THE ROAD IMMEDIATELY WITH THE GRASSING WORKSHOPS STAND OF GRADE.

USE RESIDENTIAL

1. MAINTAIN ALL DISTURBED AREAS INCLUDING THE ROAD IMMEDIATELY WITH THE GRASSING WORKSHOPS STAND OF GRADE.

2. MAINTAIN ALL DISTURBED AREAS INCLUDING THE ROAD IMMEDIATELY WITH THE GRASSING WORKSHOPS STAND OF GRADE.

3. MAINTAIN ALL DISTURBED AREAS INCLUDING THE ROAD IMMEDIATELY WITH THE GRASSING WORKSHOPS STAND OF GRADE.

SITE DESIGN, INC.
SUE ENGINEERS - SURVEYORS - LANDSCAPE ARCHITECTS

105 PERRY GREEN ROAD
GREENVILLE, SOUTH CAROLINA 29615
PHONE: (864) 271-0499

DATE: 08/15/2022
REVISIONS PER CITY OF GREER COMMENTS: 08/24/2022
REVISIONS PER CITY OF GREER COMMENTS: 04/11/2022

MIRASOL VILLAS (BRUSHY CREEK TRIPLEDECK)

CITY OF GREER GREENVILLE COUNTY SOUTH CAROLINA

SC REG NO 2280

DATE: 08/15/2022

C300

SHEET 2 OF 19

DATE: 08/15/2022

DESIGNED BY: CH

CHECKED BY: CH

SCALE: 1" = 50'

PROJECT: MIRASOL VILLAS (BRUSHY CREEK TRIPLEDECK)

NO.	DATE	REVISIONS PER CITY OF GREER COMMENTS
1	06/13/2022	FINAL CITY OF GREER PLAN SET
2	09/24/2022	REVISIONS PER CITY OF GREER COMMENTS
3	04/15/2023	REVISIONS PER CITY OF GREER COMMENTS

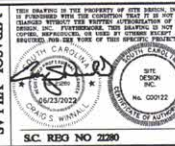

THIS DRAWING IS THE PROPERTY OF SITE DESIGN, INC. IT IS TO BE USED ONLY FOR THE PROJECT AND SITE SPECIFICALLY IDENTIFIED HEREON. ANY REUSE OR REPRODUCTION OF THIS DRAWING FOR ANY OTHER PROJECT WITHOUT THE WRITTEN PERMISSION OF SITE DESIGN, INC. IS STRICTLY PROHIBITED. PROJECT: MIRASOL VILAS GREENVILLE COUNTY SOUTH CAROLINA

MIRASOL VILAS
GREENVILLE COUNTY
SOUTH CAROLINA
TRIPLELEXES

CITY OF GREER
 GREENVILLE COUNTY
 SOUTH CAROLINA

DATE: 09/24/2022
 CHECKED BY: CH
 DRAWN BY: CH
 DESIGNED BY: N/A
 VERT. SCALE: N/A
 HORIZ. SCALE: N/A

C350

SHEET 8 OF 10

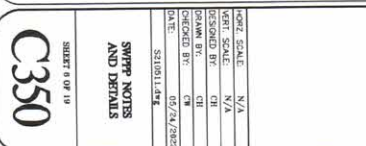
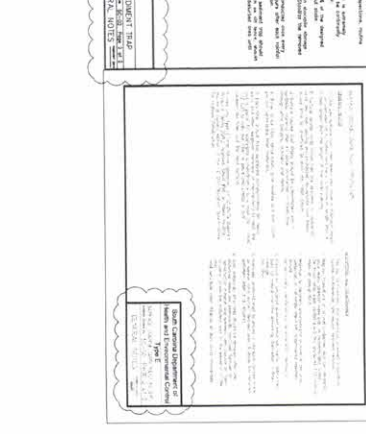
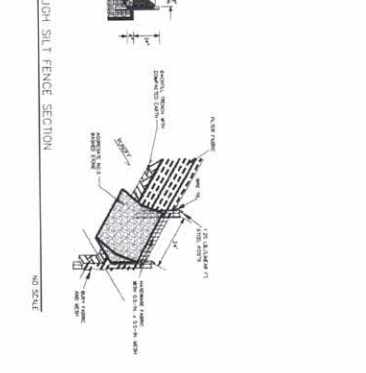
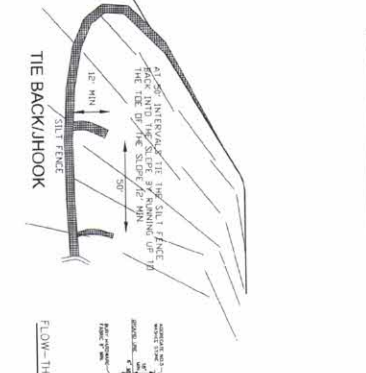
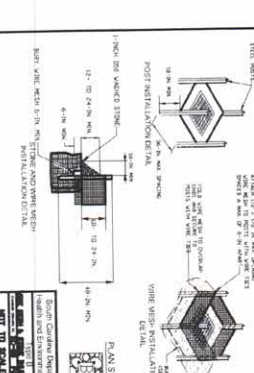
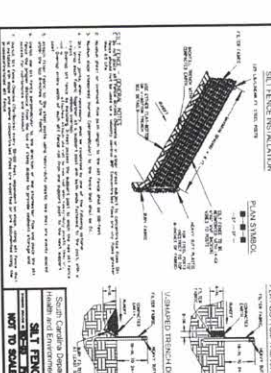
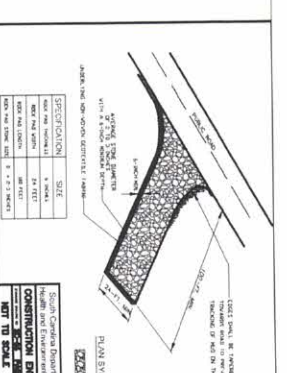
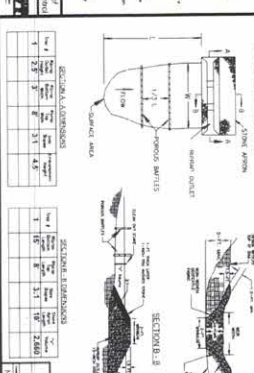
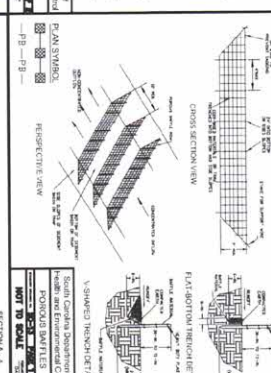
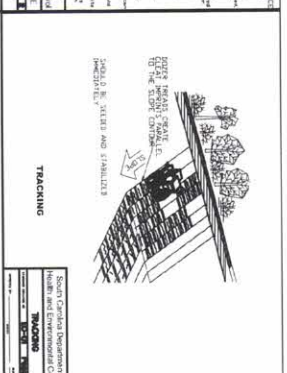
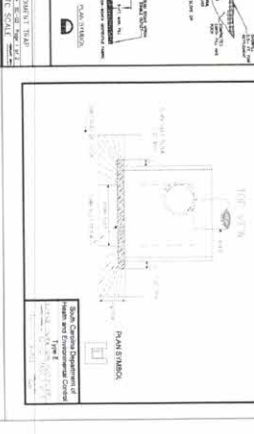
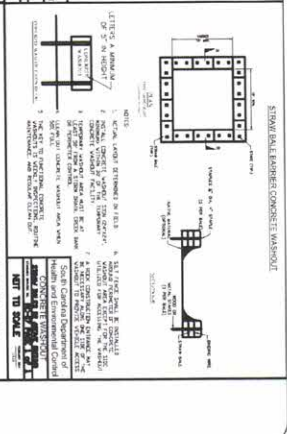

City of Greer: Storm Water

...and other documents...
 ...and other documents...
 ...and other documents...

City of Greer: Storm Water

...and other documents...
 ...and other documents...
 ...and other documents...

City of Greer: Storm Water

...and other documents...
 ...and other documents...
 ...and other documents...

...and other documents...
 ...and other documents...
 ...and other documents...

...and other documents...
 ...and other documents...
 ...and other documents...

...and other documents...
 ...and other documents...
 ...and other documents...

...and other documents...
 ...and other documents...
 ...and other documents...

...and other documents...
 ...and other documents...
 ...and other documents...

...and other documents...
 ...and other documents...
 ...and other documents...

...and other documents...
 ...and other documents...
 ...and other documents...

...and other documents...
 ...and other documents...
 ...and other documents...

...and other documents...
 ...and other documents...
 ...and other documents...

...and other documents...
 ...and other documents...
 ...and other documents...

...and other documents...
 ...and other documents...
 ...and other documents...

...and other documents...
 ...and other documents...
 ...and other documents...

Table 1: Riprap Specifications

Material	Quantity	Notes
3/4" - 1 1/2" Riprap	1000	For outlet
1 1/2" - 2" Riprap	500	For outlet

Table 2: Riprap Specifications

Material	Quantity	Notes
3/4" - 1 1/2" Riprap	1000	For outlet
1 1/2" - 2" Riprap	500	For outlet

Table 3: Riprap Specifications

Material	Quantity	Notes
3/4" - 1 1/2" Riprap	1000	For outlet
1 1/2" - 2" Riprap	500	For outlet

Table 4: Riprap Specifications

Material	Quantity	Notes
3/4" - 1 1/2" Riprap	1000	For outlet
1 1/2" - 2" Riprap	500	For outlet

Table 5: Riprap Specifications

Material	Quantity	Notes
3/4" - 1 1/2" Riprap	1000	For outlet
1 1/2" - 2" Riprap	500	For outlet

Table 6: Riprap Specifications

Material	Quantity	Notes
3/4" - 1 1/2" Riprap	1000	For outlet
1 1/2" - 2" Riprap	500	For outlet

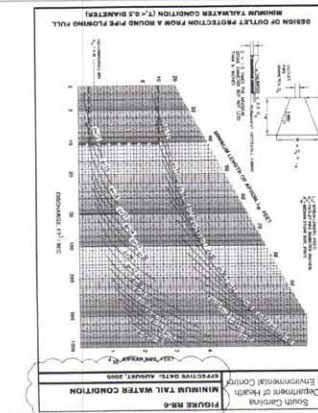
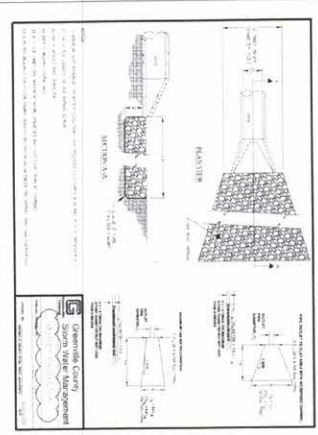
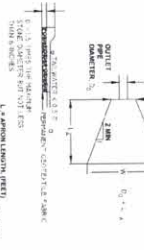

Table 7: Riprap Dimensions

Structure	Length	Width	Height
15"	14.0 FT	8.0 FT	6.0 FT
24"	14.0 FT	8.0 FT	6.0 FT



SWPP NOTES AND DETAILS

C351

Sheet 7 of 18

PORT SCALE: N/A
 VERT SCALE: N/A
 DESIGNED BY: CH
 DRAWN BY: CH
 CHECKED BY: CH
 DATE: 09/24/2022

MIRASOL VILLAS (BRUSHY CREEK TRIPLEXES)

CITY OF GREER GREENVILLE COUNTY SOUTH CAROLINA

South Carolina Department of Health and Environmental Control
 PREVENTIVE WATER MONITORING

SC. REG. NO. 2280

Professional Engineer Seal for Site Design, Inc.

SITE DESIGN, INC.
 CIVIL ENGINEERS - SURVEYORS - LANDSCAPE ARCHITECTS

www.sitedesign-inc.com
 200 HICKORY CREEK ROAD
 GREENVILLE, SC 29615
 PH: 864.627.0499

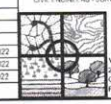

DATE

NO.	REVISIONS PER CITY OF GREER COMMENTS	DATE
1.	REVISIONS PER CITY OF GREER COMMENTS	04/12/2022
2.	REVISIONS PER CITY OF GREER COMMENTS	09/24/2022
3.	FINAL CITY OF GREER PLAN SET	06/23/2022

STORMWATER NOTE

THE CITY STORMWATER DEPT WILL BE ADVISED OF THE TIME THE CONSTRUCTION WILL BE BACKFILL AND IN ORDER TO PREVENT THE CONSTRUCTION FROM BEING STOPPED BY THE CITY STORMWATER DEPARTMENT. THE CONTRACTOR SHALL BE RESPONSIBLE FOR PROVIDING PROPER DRAINAGE TO MAINTAIN PROPER FLOW AND TO PREVENT ANY EXCESSIVE WATER FROM ACCUMULATING ON THE PROPERTY. THE CONTRACTOR SHALL BE RESPONSIBLE FOR MAINTAINING PROPER DRAINAGE THROUGHOUT THE CONSTRUCTION PERIOD AND FOR REPAIRING ANY DAMAGE TO THE DRAINAGE SYSTEM AND ANY OTHER STRUCTURAL WORK ON THE SITE. ALL WORK SHALL BE DONE IN ACCORDANCE WITH THE CITY STORMWATER DEPARTMENT'S STANDARD SPECIFICATIONS FOR CONSTRUCTION.

STRUCTURE NO.	STRUCTURE TYPE	LENGTH	WIDTH	DEPTH	CONCRETE	E-IP
CS-1	CS-1	15.00'	12.00'	10.00'	4010S	2010S
CS-2	CS-2	15.00'	12.00'	10.00'	4010S	2010S
CS-3	CS-3	15.00'	12.00'	10.00'	4010S	2010S
CS-4	CS-4	15.00'	12.00'	10.00'	4010S	2010S
CS-5	CS-5	15.00'	12.00'	10.00'	4010S	2010S
CS-6	CS-6	15.00'	12.00'	10.00'	4010S	2010S
CS-7	CS-7	15.00'	12.00'	10.00'	4010S	2010S
CS-8	CS-8	15.00'	12.00'	10.00'	4010S	2010S
CS-9	CS-9	15.00'	12.00'	10.00'	4010S	2010S
CS-10	CS-10	15.00'	12.00'	10.00'	4010S	2010S
CS-11	CS-11	15.00'	12.00'	10.00'	4010S	2010S
CS-12	CS-12	15.00'	12.00'	10.00'	4010S	2010S
CS-13	CS-13	15.00'	12.00'	10.00'	4010S	2010S
CS-14	CS-14	15.00'	12.00'	10.00'	4010S	2010S
CS-15	CS-15	15.00'	12.00'	10.00'	4010S	2010S
CS-16	CS-16	15.00'	12.00'	10.00'	4010S	2010S
CS-17	CS-17	15.00'	12.00'	10.00'	4010S	2010S
CS-18	CS-18	15.00'	12.00'	10.00'	4010S	2010S
CS-19	CS-19	15.00'	12.00'	10.00'	4010S	2010S
CS-20	CS-20	15.00'	12.00'	10.00'	4010S	2010S

DRAINAGE NOTE

ALL UNDERGROUND DRAINAGE SHALL BE CONSTRUCTED WITH CONCRETE. ANY EXCESSIVE WATER EXCEEDING 2% DRAINAGE SLOPE IS CONSIDERED A RAIN. ANY EXCESSIVE WATER MUST BE DIRECTED TO THE DRAINAGE SYSTEM AND NOT TO ANY ADJACENT AREAS. THE CONTRACTOR SHALL BE RESPONSIBLE FOR MAINTAINING PROPER DRAINAGE THROUGHOUT THE CONSTRUCTION PERIOD AND FOR REPAIRING ANY DAMAGE TO THE DRAINAGE SYSTEM AND ANY OTHER STRUCTURAL WORK ON THE SITE. ALL WORK SHALL BE DONE IN ACCORDANCE WITH THE CITY STORMWATER DEPARTMENT'S STANDARD SPECIFICATIONS FOR CONSTRUCTION.

STRUCTURE NO.	STRUCTURE TYPE	LENGTH	WIDTH	DEPTH	CONCRETE	E-IP
CS-21	CS-21	15.00'	12.00'	10.00'	4010S	2010S
CS-22	CS-22	15.00'	12.00'	10.00'	4010S	2010S
CS-23	CS-23	15.00'	12.00'	10.00'	4010S	2010S
CS-24	CS-24	15.00'	12.00'	10.00'	4010S	2010S
CS-25	CS-25	15.00'	12.00'	10.00'	4010S	2010S
CS-26	CS-26	15.00'	12.00'	10.00'	4010S	2010S
CS-27	CS-27	15.00'	12.00'	10.00'	4010S	2010S
CS-28	CS-28	15.00'	12.00'	10.00'	4010S	2010S
CS-29	CS-29	15.00'	12.00'	10.00'	4010S	2010S
CS-30	CS-30	15.00'	12.00'	10.00'	4010S	2010S
CS-31	CS-31	15.00'	12.00'	10.00'	4010S	2010S
CS-32	CS-32	15.00'	12.00'	10.00'	4010S	2010S

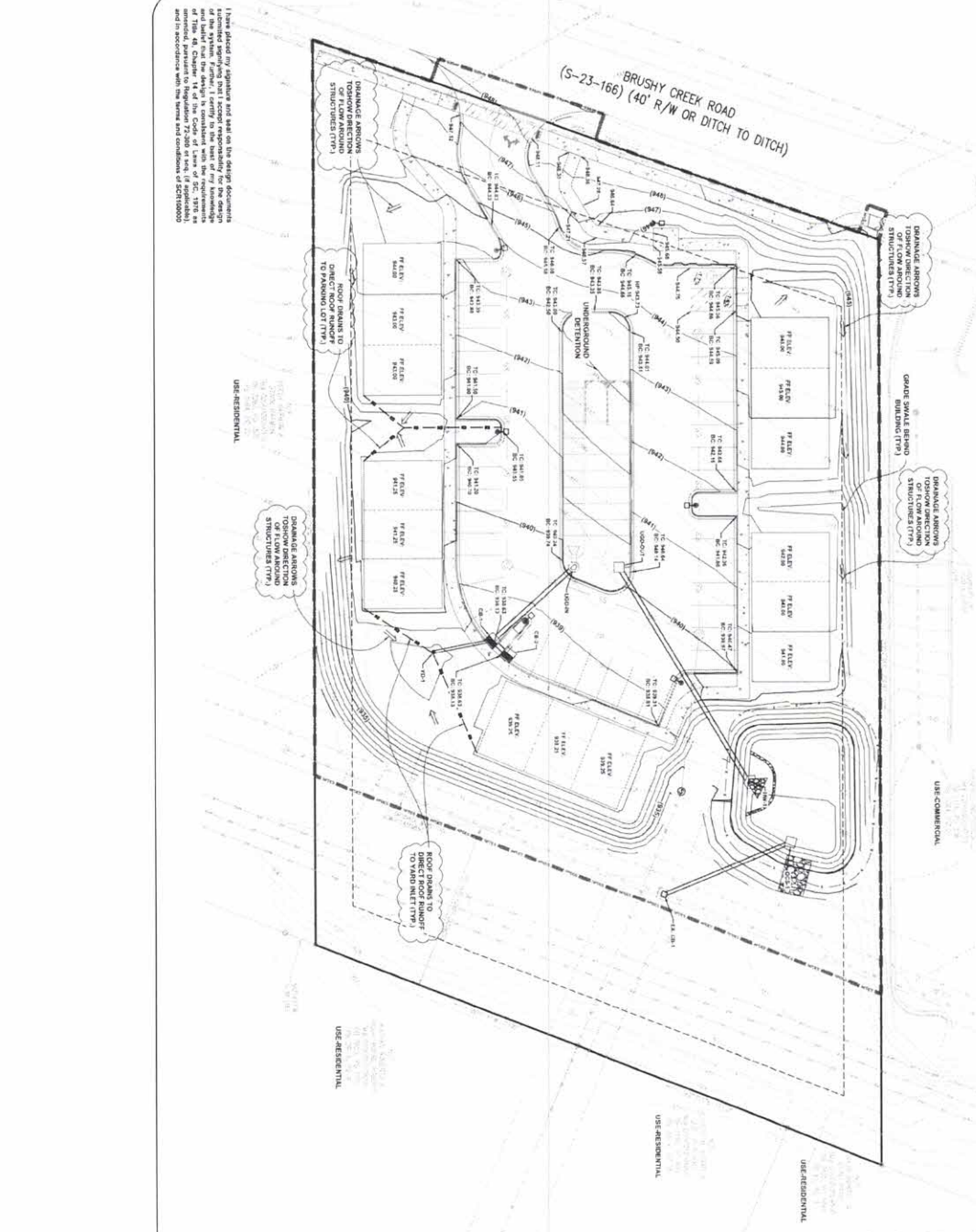

NOTES

- ALL GRADING SHALL BE DONE TO BE CONSTRUCTED WITH CONCRETE.
- ANY EXCESSIVE WATER EXCEEDING 2% DRAINAGE SLOPE IS CONSIDERED A RAIN. ANY EXCESSIVE WATER MUST BE DIRECTED TO THE DRAINAGE SYSTEM AND NOT TO ANY ADJACENT AREAS.
- THE CONTRACTOR SHALL BE RESPONSIBLE FOR MAINTAINING PROPER DRAINAGE THROUGHOUT THE CONSTRUCTION PERIOD AND FOR REPAIRING ANY DAMAGE TO THE DRAINAGE SYSTEM AND ANY OTHER STRUCTURAL WORK ON THE SITE.
- ALL WORK SHALL BE DONE IN ACCORDANCE WITH THE CITY STORMWATER DEPARTMENT'S STANDARD SPECIFICATIONS FOR CONSTRUCTION.
- THE CONTRACTOR SHALL BE RESPONSIBLE FOR OBTAINING NECESSARY PERMITS FROM THE CITY STORMWATER DEPARTMENT AND THE HEALTH DEPARTMENT.
- ALL UNDERGROUND DRAINAGE SHALL BE CONSTRUCTED WITH CONCRETE.
- ANY EXCESSIVE WATER EXCEEDING 2% DRAINAGE SLOPE IS CONSIDERED A RAIN. ANY EXCESSIVE WATER MUST BE DIRECTED TO THE DRAINAGE SYSTEM AND NOT TO ANY ADJACENT AREAS.
- THE CONTRACTOR SHALL BE RESPONSIBLE FOR MAINTAINING PROPER DRAINAGE THROUGHOUT THE CONSTRUCTION PERIOD AND FOR REPAIRING ANY DAMAGE TO THE DRAINAGE SYSTEM AND ANY OTHER STRUCTURAL WORK ON THE SITE.
- ALL WORK SHALL BE DONE IN ACCORDANCE WITH THE CITY STORMWATER DEPARTMENT'S STANDARD SPECIFICATIONS FOR CONSTRUCTION.
- THE CONTRACTOR SHALL BE RESPONSIBLE FOR OBTAINING NECESSARY PERMITS FROM THE CITY STORMWATER DEPARTMENT AND THE HEALTH DEPARTMENT.

DEFLECTION BASIN MAINTENANCE SCHEDULE

- THE LANDOWNER, ITS SUCCESSORS AND ASSIGNS, SHALL MAINTAIN THE WORK NECESSARY TO KEEP THESE FACILITIES IN GOOD WORKING ORDER AND MAINTAINING THEM AS DESCRIBED IN THESE NOTES.
- LAID, U.C. RAMPING ON A REGULAR BASIS (MINIMUM 2 TIMES A YEAR, AREA NOT YET DETAIL SHOULD BE STABILIZED IMMEDIATELY.)
- REPAIRS TO BE MADE TO THE SURFACE OF ANY EXCESSIVE AREAS AND NO OTHER CATCHING TRAP SHALL BE REQUIRED TO BE MAINTAINED.
- TRASH AND DEBRIS TO BE REMOVED FROM WITHIN AND AROUND THE POOP ON A REGULAR BASIS.
- OUTLET STRUCTURES TO BE INSPECTED FOR STRUCTURE INTEGRITY AND SEWAGE TO BE NEEDED TO BE REPAIRED TO MAINTAIN PROPER FLOW.
- REPAIRS TO BE MADE TO THE SURFACE OF ANY EXCESSIVE AREAS AND NO OTHER CATCHING TRAP SHALL BE REQUIRED TO BE MAINTAINED.
- REPAIRS TO BE MADE TO THE SURFACE OF ANY EXCESSIVE AREAS AND NO OTHER CATCHING TRAP SHALL BE REQUIRED TO BE MAINTAINED.
- REPAIRS TO BE MADE TO THE SURFACE OF ANY EXCESSIVE AREAS AND NO OTHER CATCHING TRAP SHALL BE REQUIRED TO BE MAINTAINED.
- REPAIRS TO BE MADE TO THE SURFACE OF ANY EXCESSIVE AREAS AND NO OTHER CATCHING TRAP SHALL BE REQUIRED TO BE MAINTAINED.

SITE DATA:

- PIN: 0688900811
- TOTAL DEFLECTION AREA: 4.14 AC
- ZONING: C-2 (COMMERCIAL)
- PROPOSED USE: 2.0
- FRONT SETBACK: 10'
- REAR SETBACK: 10'
- LEFT SIDE SETBACK: 5'
- RIGHT SIDE SETBACK: 5'

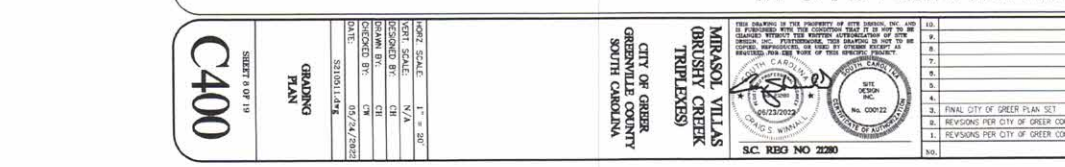

GRADING NOTES:

- THE CONTRACTOR SHALL VERIFY THE LOCATION OF ALL UNDERGROUND UTILITIES BY CALLING UTILITY LOCATION SERVICE AT 811 THREE (1) DAYS PRIOR TO ANY CONSTRUCTION.
- THE CONTRACTOR SHALL NOTIFY THE ENGINEER FOR A REVIEW SHOULD ANY PROFOUNDING AND CONNECTION TESTS SHALL BE ACCOMPANIED IN THE FIELD TO TEST FIELD TESTS. SHALL CONNECTION TESTS FOR PROFOUNDING AND CONNECTION TESTS SHALL BE ACCOMPANIED IN THE FIELD TO TEST FIELD TESTS. SHALL CONNECTION TESTS FOR PROFOUNDING AND CONNECTION TESTS SHALL BE ACCOMPANIED IN THE FIELD TO TEST FIELD TESTS.
- THE CONTRACTOR SHALL VERIFY THE LOCATION OF ALL UNDERGROUND UTILITIES BY CALLING UTILITY LOCATION SERVICE AT 811 THREE (1) DAYS PRIOR TO ANY CONSTRUCTION.
- THE CONTRACTOR SHALL NOTIFY THE ENGINEER FOR A REVIEW SHOULD ANY PROFOUNDING AND CONNECTION TESTS SHALL BE ACCOMPANIED IN THE FIELD TO TEST FIELD TESTS. SHALL CONNECTION TESTS FOR PROFOUNDING AND CONNECTION TESTS SHALL BE ACCOMPANIED IN THE FIELD TO TEST FIELD TESTS.
- THE CONTRACTOR SHALL VERIFY THE LOCATION OF ALL UNDERGROUND UTILITIES BY CALLING UTILITY LOCATION SERVICE AT 811 THREE (1) DAYS PRIOR TO ANY CONSTRUCTION.
- THE CONTRACTOR SHALL NOTIFY THE ENGINEER FOR A REVIEW SHOULD ANY PROFOUNDING AND CONNECTION TESTS SHALL BE ACCOMPANIED IN THE FIELD TO TEST FIELD TESTS. SHALL CONNECTION TESTS FOR PROFOUNDING AND CONNECTION TESTS SHALL BE ACCOMPANIED IN THE FIELD TO TEST FIELD TESTS.
- THE CONTRACTOR SHALL VERIFY THE LOCATION OF ALL UNDERGROUND UTILITIES BY CALLING UTILITY LOCATION SERVICE AT 811 THREE (1) DAYS PRIOR TO ANY CONSTRUCTION.
- THE CONTRACTOR SHALL NOTIFY THE ENGINEER FOR A REVIEW SHOULD ANY PROFOUNDING AND CONNECTION TESTS SHALL BE ACCOMPANIED IN THE FIELD TO TEST FIELD TESTS. SHALL CONNECTION TESTS FOR PROFOUNDING AND CONNECTION TESTS SHALL BE ACCOMPANIED IN THE FIELD TO TEST FIELD TESTS.
- THE CONTRACTOR SHALL VERIFY THE LOCATION OF ALL UNDERGROUND UTILITIES BY CALLING UTILITY LOCATION SERVICE AT 811 THREE (1) DAYS PRIOR TO ANY CONSTRUCTION.
- THE CONTRACTOR SHALL NOTIFY THE ENGINEER FOR A REVIEW SHOULD ANY PROFOUNDING AND CONNECTION TESTS SHALL BE ACCOMPANIED IN THE FIELD TO TEST FIELD TESTS. SHALL CONNECTION TESTS FOR PROFOUNDING AND CONNECTION TESTS SHALL BE ACCOMPANIED IN THE FIELD TO TEST FIELD TESTS.

NO.	REVISION	DATE
1	FINAL CITY OF GREER PLAN SET	06/22/2022
2	REVISED PER CITY OF GREER COMMENTS	06/24/2022
3	REVISED PER CITY OF GREER COMMENTS	06/27/2022

MIRASOL VILLAS (BRUSHY CREEK TRIPLEXES)

CITY OF GREER GREENVILLE COUNTY SOUTH CAROLINA

811 Know what's below. Call before you dig.

SCALE: 1" = 50'

DATE: 05/27/2022

PROJECT NO.: 2022-0122

DRAWN BY: V.H.

CHECKED BY: C.H.

DATE: 05/27/2022

SCALE: 1" = 50'

PROJECT NO.: 2022-0122

DATE: 05/27/2022

SCALE: 1" = 50'

PROJECT NO.: 2022-0122

DATE: 05/27/2022

SITE DESIGN, INC.

CIVIL, ARCHITECTURAL, INTERIOR ARCHITECTURE

www.sitedesign-inc.com

225 ROCKY CREEK ROAD

GREENVILLE, SC 29615

PH: 864.921.6495

C400

GRADING PLAN

SHEET 6 OF 19

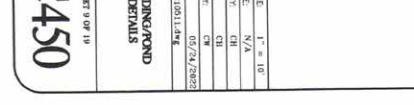
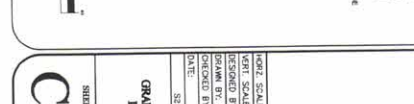
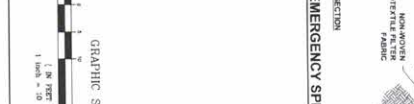
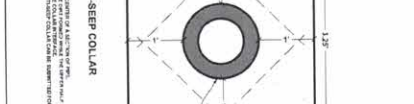
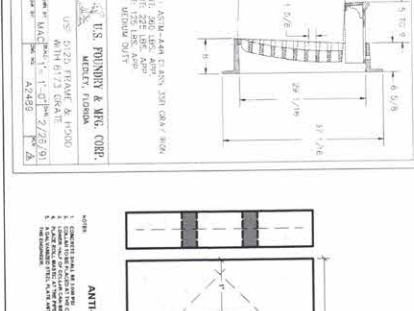
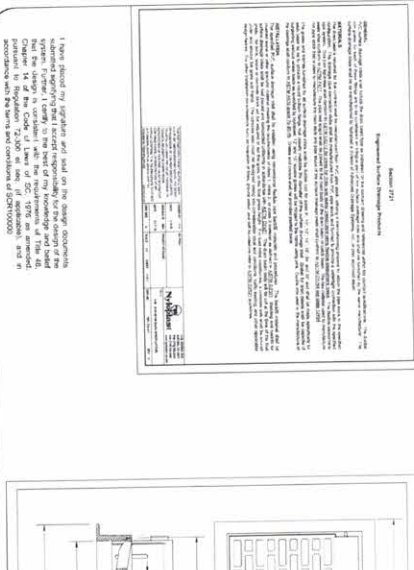
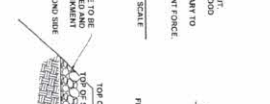
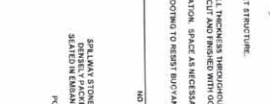
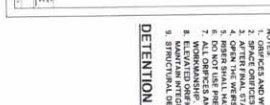
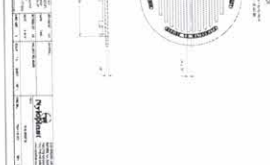
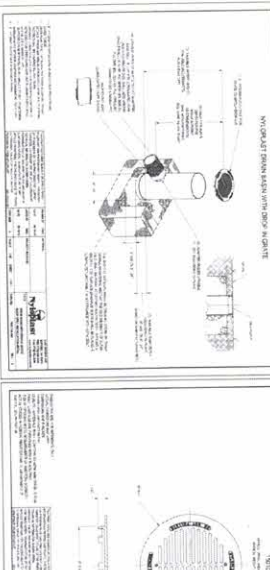
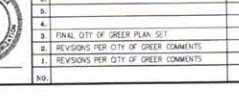
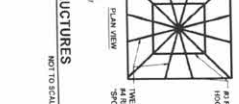
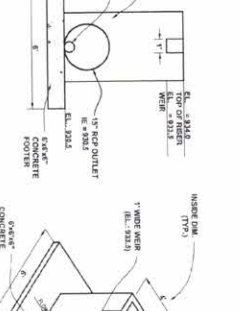
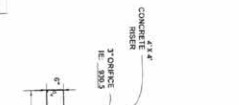
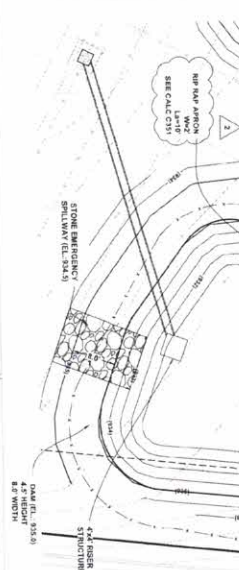
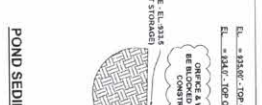
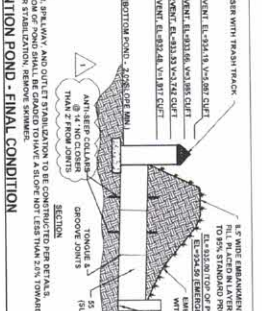
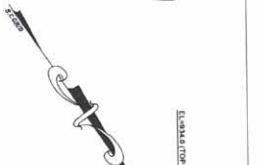
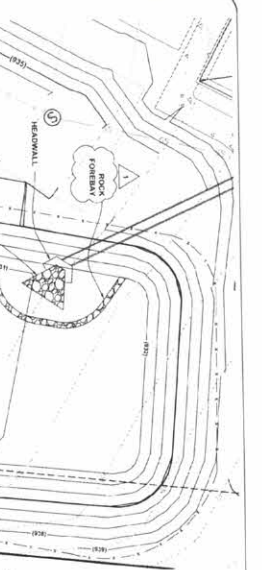

Notes:
 1. OWNER AND USER TO BE RESPONSIBLE FOR ANY AND ALL CHANGES DURING CONSTRUCTION.
 2. ALL MATERIALS SHALL BE SUBJECT TO INSPECTION AND APPROVAL BY THE LOCAL AUTHORITY.
 3. ALL MATERIALS SHALL BE SUBJECT TO INSPECTION AND APPROVAL BY THE LOCAL AUTHORITY.
 4. ALL MATERIALS SHALL BE SUBJECT TO INSPECTION AND APPROVAL BY THE LOCAL AUTHORITY.
 5. ALL MATERIALS SHALL BE SUBJECT TO INSPECTION AND APPROVAL BY THE LOCAL AUTHORITY.
 6. ALL MATERIALS SHALL BE SUBJECT TO INSPECTION AND APPROVAL BY THE LOCAL AUTHORITY.
 7. ALL MATERIALS SHALL BE SUBJECT TO INSPECTION AND APPROVAL BY THE LOCAL AUTHORITY.
 8. ALL MATERIALS SHALL BE SUBJECT TO INSPECTION AND APPROVAL BY THE LOCAL AUTHORITY.
 9. ALL MATERIALS SHALL BE SUBJECT TO INSPECTION AND APPROVAL BY THE LOCAL AUTHORITY.
 10. ALL MATERIALS SHALL BE SUBJECT TO INSPECTION AND APPROVAL BY THE LOCAL AUTHORITY.

Approved by: _____
 Date: _____

Scale: _____

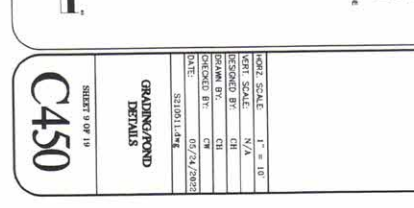
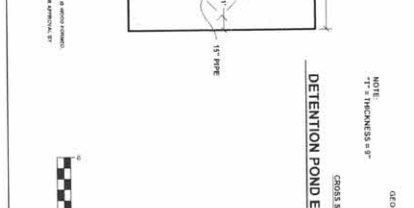
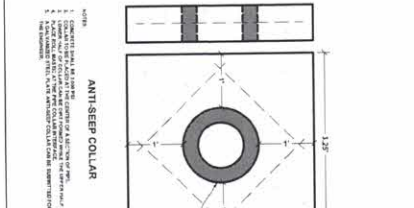

SITE DESIGN, INC.
 CIVIL ENGINEERS - SURVEYORS - LANDSCAPE ARCHITECTS

www.sitedesign-inc.com
 225 ROCK CREEK ROAD
 GREENVILLE, SOUTH CAROLINA 29615
 (864) 271-8499

NO.	REVISIONS PER CITY OF GREER COMMENTS	DATE
1	REVISIONS PER CITY OF GREER COMMENTS	04/11/2021
2		
3		
4		
5		
6		
7		
8		
9		
10		

MARSOUL VILLAS
(BRUSHY CREEK TRIM LEXES)

CITY OF GREER
GREENVILLE COUNTY
SOUTH CAROLINA

SC REG NO 2280

C450

SHEET 9 OF 19

GRADING/POND DETAILS

DATE: 04/28/2021

SCALE: 1" = 10'

DESIGNED BY: CH

CHECKED BY: CH

DRAWN BY: CH

DATE: 04/28/2021

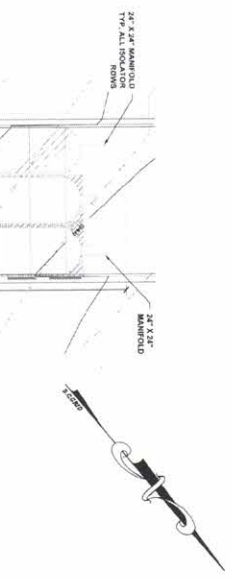

PROPOSED LAYOUT

3 STORMTECH CHAMBERS
 INSTALLED WITH 12 COVER STONE, 9' SLIDE STONE, 40%
 STONE VOID
 INSTALLED SYSTEM VOLUME = 164.8 CF

PROPOSED ELEVATIONS

MAX GRADE TOP OF PAVEMENT	944.50
MIN GRADE (BASE OF FLEETED PAVEMENT)	939.50
TOP OF STONE	939.50
24" MANHOLE INVERT	934.50
24" MANHOLE HUB	932.00
24" MANHOLE BOTTOM OF STONE	931.75
UNDERGROUND	931.75

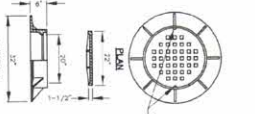

NOTE: FRAME SHALL BE CONCRETE FRAME
 MANHOLE SHALL BE COVERED BY 9" SLIDE STONE
 THE 9" SLIDE COVER OR APPROXIMATE EQUAL

STANDARD MANHOLE FRAME & COVER
 NO SCALE

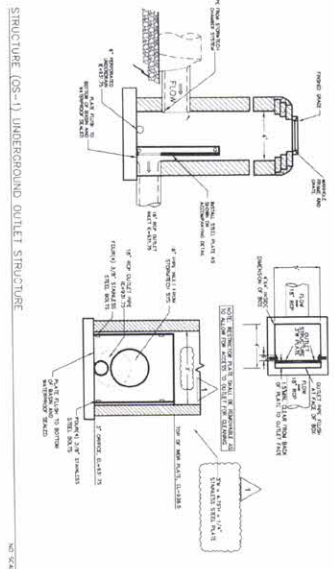

STRUCTURE (OS-1) UNDERGROUND OUTLET STRUCTURE
 NO SCALE

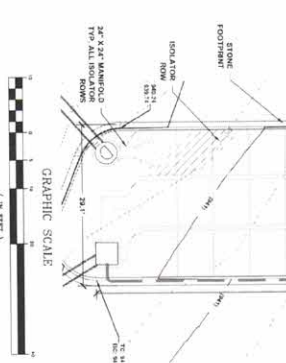

PROJECT INFORMATION

PROJECT NAME	MIRASOL VILLAS
PROJECT LOCATION	10000 W. STATE ST. GREENVILLE, SC 29615
CLIENT	BRUSHY CREEK GREEN, SC
DATE	05/24/2022



MC-7200 STORMTECH CHAMBER SPECIFICATIONS

1. CHAMBER SHALL BE 30" DIA. x 36" HIGH. SHALL BE CAST IN PLACE CONCRETE.
2. CHAMBER SHALL BE 30" DIA. x 36" HIGH. SHALL BE CAST IN PLACE CONCRETE.
3. CHAMBER SHALL BE 30" DIA. x 36" HIGH. SHALL BE CAST IN PLACE CONCRETE.
4. CHAMBER SHALL BE 30" DIA. x 36" HIGH. SHALL BE CAST IN PLACE CONCRETE.
5. CHAMBER SHALL BE 30" DIA. x 36" HIGH. SHALL BE CAST IN PLACE CONCRETE.
6. CHAMBER SHALL BE 30" DIA. x 36" HIGH. SHALL BE CAST IN PLACE CONCRETE.
7. CHAMBER SHALL BE 30" DIA. x 36" HIGH. SHALL BE CAST IN PLACE CONCRETE.
8. CHAMBER SHALL BE 30" DIA. x 36" HIGH. SHALL BE CAST IN PLACE CONCRETE.
9. CHAMBER SHALL BE 30" DIA. x 36" HIGH. SHALL BE CAST IN PLACE CONCRETE.
10. CHAMBER SHALL BE 30" DIA. x 36" HIGH. SHALL BE CAST IN PLACE CONCRETE.

IMPORTANT NOTES FOR THE ORDERING AND INSTALLATION OF MC-7200 CHAMBER SYSTEM

1. CHAMBER SHALL BE 30" DIA. x 36" HIGH. SHALL BE CAST IN PLACE CONCRETE.
2. CHAMBER SHALL BE 30" DIA. x 36" HIGH. SHALL BE CAST IN PLACE CONCRETE.
3. CHAMBER SHALL BE 30" DIA. x 36" HIGH. SHALL BE CAST IN PLACE CONCRETE.
4. CHAMBER SHALL BE 30" DIA. x 36" HIGH. SHALL BE CAST IN PLACE CONCRETE.
5. CHAMBER SHALL BE 30" DIA. x 36" HIGH. SHALL BE CAST IN PLACE CONCRETE.
6. CHAMBER SHALL BE 30" DIA. x 36" HIGH. SHALL BE CAST IN PLACE CONCRETE.
7. CHAMBER SHALL BE 30" DIA. x 36" HIGH. SHALL BE CAST IN PLACE CONCRETE.
8. CHAMBER SHALL BE 30" DIA. x 36" HIGH. SHALL BE CAST IN PLACE CONCRETE.
9. CHAMBER SHALL BE 30" DIA. x 36" HIGH. SHALL BE CAST IN PLACE CONCRETE.
10. CHAMBER SHALL BE 30" DIA. x 36" HIGH. SHALL BE CAST IN PLACE CONCRETE.

NOTES FOR CONSTRUCTION EQUIPMENT

1. CHAMBER SHALL BE 30" DIA. x 36" HIGH. SHALL BE CAST IN PLACE CONCRETE.
2. CHAMBER SHALL BE 30" DIA. x 36" HIGH. SHALL BE CAST IN PLACE CONCRETE.
3. CHAMBER SHALL BE 30" DIA. x 36" HIGH. SHALL BE CAST IN PLACE CONCRETE.
4. CHAMBER SHALL BE 30" DIA. x 36" HIGH. SHALL BE CAST IN PLACE CONCRETE.
5. CHAMBER SHALL BE 30" DIA. x 36" HIGH. SHALL BE CAST IN PLACE CONCRETE.
6. CHAMBER SHALL BE 30" DIA. x 36" HIGH. SHALL BE CAST IN PLACE CONCRETE.
7. CHAMBER SHALL BE 30" DIA. x 36" HIGH. SHALL BE CAST IN PLACE CONCRETE.
8. CHAMBER SHALL BE 30" DIA. x 36" HIGH. SHALL BE CAST IN PLACE CONCRETE.
9. CHAMBER SHALL BE 30" DIA. x 36" HIGH. SHALL BE CAST IN PLACE CONCRETE.
10. CHAMBER SHALL BE 30" DIA. x 36" HIGH. SHALL BE CAST IN PLACE CONCRETE.

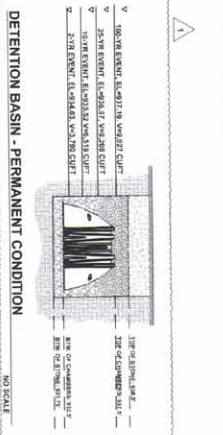

DETENTION BASIN - PERMANENT CONDITION
 NO SCALE

REVISIONS

NO.	DATE	DESCRIPTION
1	06/21/2022	FINAL CITY OF GREER PLAN SET
2	05/24/2022	REVISING PER CITY OF GREER COMMENTS
3	04/12/2022	REVISING PER CITY OF GREER COMMENTS



MIRASOL VILLAS
 BRUSHY CREEK
 TRIM EXES

CITY OF GREER
 GREENVILLE COUNTY
 SOUTH CAROLINA

PROJECT SCALE

PORT SCALE	1" = 10'
VERT SCALE	N/A
SCHEMATIC	1/4" = 1'
PLAN	1/4" = 1'
SECTION	1/4" = 1'
DATE	05/24/2022

UNDERGROUND DETAILS
C451

SITE DESIGN, INC.
 CIVIL ENGINEERS SURVEYORS LANDSCAPE ARCHITECTS

www.sitedesign-inc.com
 226 ROCKY CREEK ROAD
 GREENVILLE, SC 29615
 PH: 864.631.0496

1. This drawing represents the design of the detention basin...
 2. The design of the detention basin shall be in accordance with the...
 3. The design of the detention basin shall be in accordance with the...
 4. The design of the detention basin shall be in accordance with the...
 5. The design of the detention basin shall be in accordance with the...
 6. The design of the detention basin shall be in accordance with the...
 7. The design of the detention basin shall be in accordance with the...
 8. The design of the detention basin shall be in accordance with the...
 9. The design of the detention basin shall be in accordance with the...
 10. The design of the detention basin shall be in accordance with the...

INSPECTION & MAINTENANCE

1. CHAMBER SHALL BE 30" DIA. x 36" HIGH. SHALL BE CAST IN PLACE CONCRETE.
2. CHAMBER SHALL BE 30" DIA. x 36" HIGH. SHALL BE CAST IN PLACE CONCRETE.
3. CHAMBER SHALL BE 30" DIA. x 36" HIGH. SHALL BE CAST IN PLACE CONCRETE.
4. CHAMBER SHALL BE 30" DIA. x 36" HIGH. SHALL BE CAST IN PLACE CONCRETE.
5. CHAMBER SHALL BE 30" DIA. x 36" HIGH. SHALL BE CAST IN PLACE CONCRETE.
6. CHAMBER SHALL BE 30" DIA. x 36" HIGH. SHALL BE CAST IN PLACE CONCRETE.
7. CHAMBER SHALL BE 30" DIA. x 36" HIGH. SHALL BE CAST IN PLACE CONCRETE.
8. CHAMBER SHALL BE 30" DIA. x 36" HIGH. SHALL BE CAST IN PLACE CONCRETE.
9. CHAMBER SHALL BE 30" DIA. x 36" HIGH. SHALL BE CAST IN PLACE CONCRETE.
10. CHAMBER SHALL BE 30" DIA. x 36" HIGH. SHALL BE CAST IN PLACE CONCRETE.

1. This sheet for general use on the design documents submitted herewith is the property of SITE DESIGN, INC. and shall remain the property of SITE DESIGN, INC. if the design documents are used for any other project. The user of this sheet shall be responsible for the design of the project and shall be responsible for the coordination of the design with the design of the other sheets of the design documents. The user of this sheet shall be responsible for the coordination of the design with the design of the other sheets of the design documents. The user of this sheet shall be responsible for the coordination of the design with the design of the other sheets of the design documents.

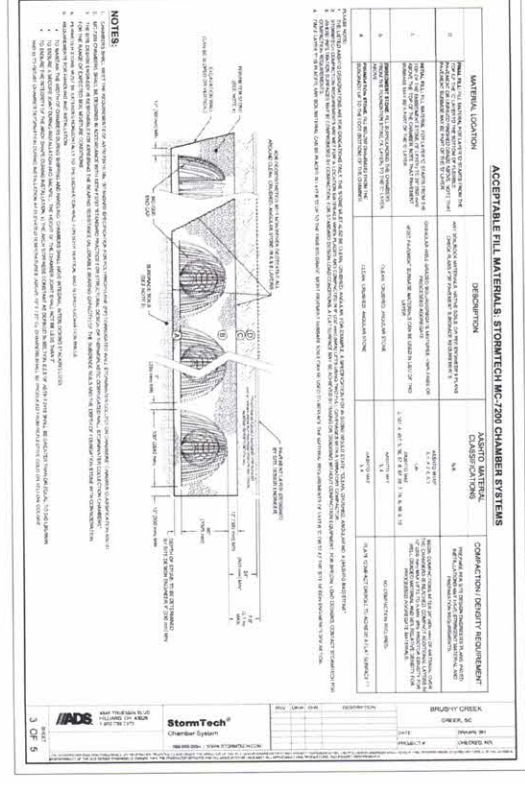
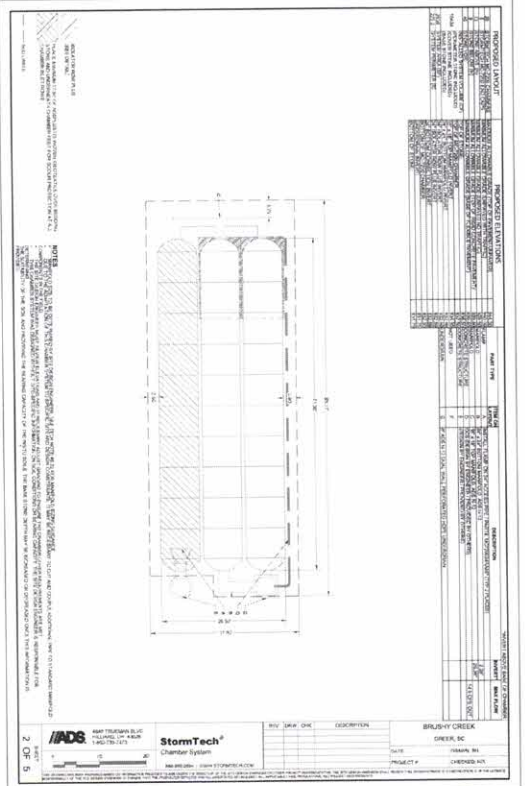
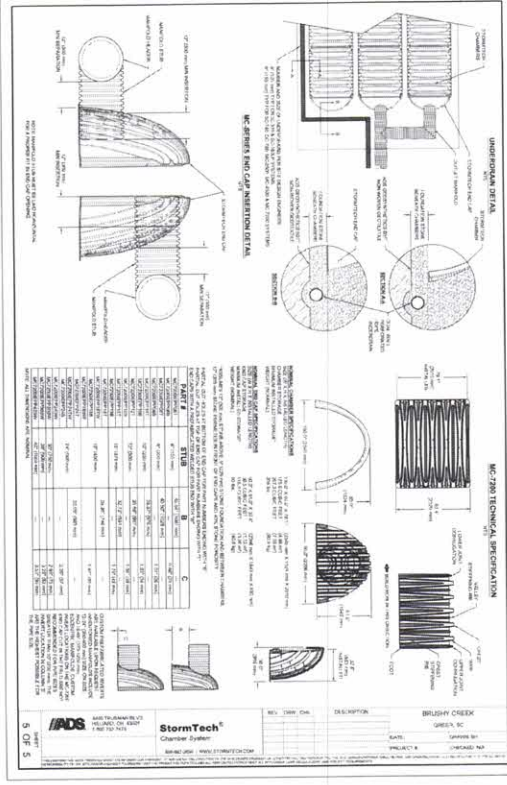
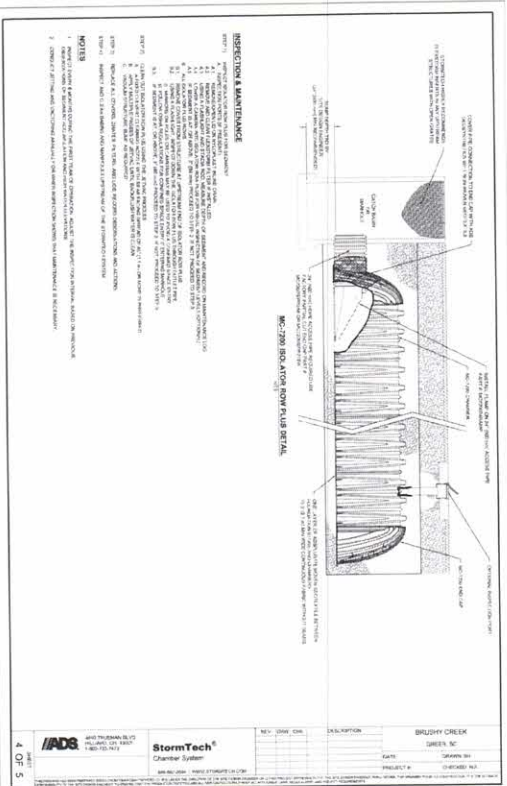

SHEET 1109 19
C452

UNDERBOARD
DETAILS

DATE	SY 09/11/14
CHECKED BY	CH
DRAWN BY	CH
DESIGNED BY	CH
VERT SCALE	N/A
HORIZ SCALE	N/A

CITY OF GREER
GREENVILLE COUNTY
SOUTH CAROLINA

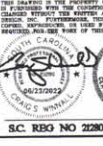

NO.	DATE	DESCRIPTION
1	06/21/2022	FINAL CITY OF GREER PLAN SET
2	05/24/2022	REVISION PER CITY OF GREER COMMENTS
3	04/12/2022	REVISIONS PER CITY OF GREER COMMENTS

SITE DESIGN, INC.
SITE ENGINEERS - SURVEYORS - LANDSCAPE ARCHITECTS

www.sitedesign-inc.com
225 ROCKY CREEK ROAD
GREENVILLE, SOUTH CAROLINA 29615
PH: (803) 271-0499

SITE DATA:

PN: C500000111
 TOTAL SITE: 7.78 ACRES (32,481 S.F.)
 ZONING: COMMERCIAL (MULTI-FAMILY)
 PROJECTED: 2020

OWNER: 31 MICHAEL JAMES
 CIVIL ENGINEER
 225 ROCKY CREEK ROAD
 GREENVILLE, SC 29615

SITE DATA		SITE DATA	
PROJECT USE	MULTI-FAMILY RESIDENTIAL	PROJECT ADDRESS	225 ROCKY CREEK ROAD
TAX MAP #	000000000111	OWNER/DEVELOPER	31 MICHAEL JAMES
BLDG. FOOTPRINT	15,000 S.F.	CIVIL ENGINEER	225 ROCKY CREEK ROAD
RETAINING WALL PRESENT	NO	PROJECTED	2020

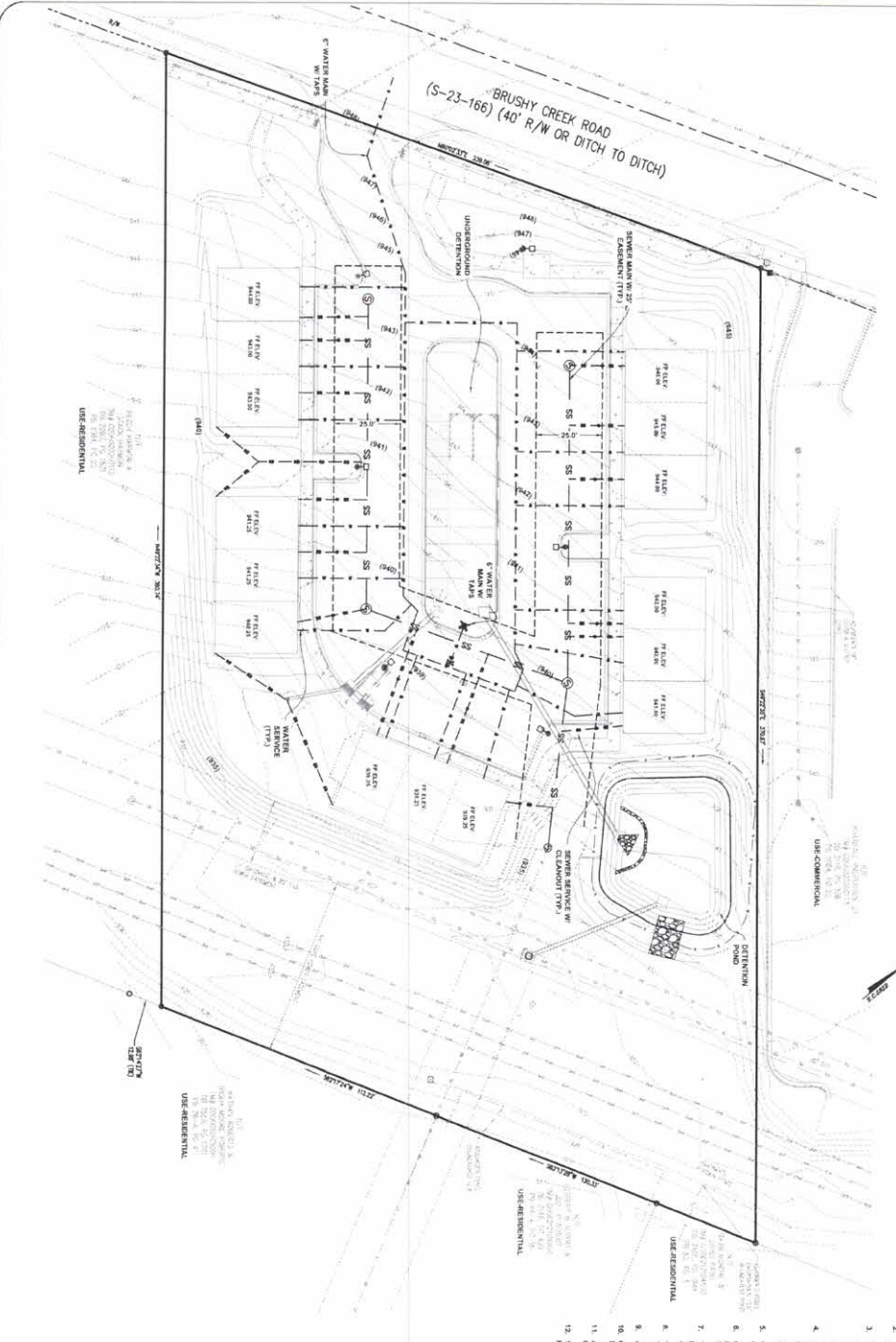

UTILITY NOTES:

- CONTRACTOR SHALL VERIFY ALL UTILITIES PRIOR TO CONSTRUCTION WITH THE UTILITY LOCATING SERVICE BY CALLING 811 THREE TO SIX DAYS PRIOR TO CONSTRUCTION.
- CONTRACTOR SHALL VERIFY THE DEPT. FOR A UTILITY LOCATING SERVICE.
- NEW UTILITY TRENCH BUCKETS SHALL BE COMPLETED TO AT LEAST 5% OF MANUAL DIG DEPTHS AND RETURNED TO THE STANARDS PRODUCTION FLOOR STAGES AND PAYMENTS SHALL BE COMPLETED TO AT LEAST 5% OF THE MANUAL DIG DEPTHS (AS PER CODES).
- CONTRACTOR SHALL CONTRACTOR OF THE WATER SERVICE TO BUILDINGS AND COORDINATED WITH ALL PLANS AND THE GOVERNING UTILITY AUTHORITY. THE AUTHORITY SHALL BE DETERMINED BY THE CONTRACTOR.
- CONTRACTOR SHALL SCHEDULE PRE-CONSTRUCTION CONFERENCE WITH OTHER CPW PRIOR TO WATER LINE CONSTRUCTION.
- CONTRACTOR SHALL COORDINATE ALL OTHER UTILITY CONNECTIONS WITH SPECIFICATIONS AND REQUIREMENTS OF THE ACCEPTING UTILITY AUTHORITY.
- THE CONTRACTOR SHALL CONDUCT ALL WORK IN ACCORDANCE WITH THE LATEST REQUIREMENTS OF THE OCCUPANCY, SAFETY AND HEALTH ADMINISTRATION.
- CONTRACTOR SHALL PROVIDE ALL NECESSARY UTILITY SCREENING TO MEET THE REQUIREMENTS OF FEDERAL CODE.
- ALL WATER SERVICES SHALL BE COMPLETED TO MEET THE REQUIREMENTS OF FEDERAL CODE.
- CONNECTION STOPS SHALL NOT BE LOCATED UNDERNEATH ANY DRIVEWAY OR SIDEWALK.
- ALL TRENCH HYDRANTS MUST BE INSTALLED WITH 4" STONG CONNECTION ON THE CENTER OF OUTLET.
- "4" MINIMUM DISTANCE FROM BOTTOM OF CENTER OF OUTLET HYDRANT TO HORIZONTAL DISTANCE.

LOCATION MAP



NOT TO SCALE

- CONTRACTOR SHALL VERIFY ALL UTILITIES PRIOR TO CONSTRUCTION WITH THE UTILITY LOCATING SERVICE BY CALLING 811 THREE TO SIX DAYS PRIOR TO CONSTRUCTION.
- CONTRACTOR SHALL VERIFY THE DEPT. FOR A UTILITY LOCATING SERVICE.
- NEW UTILITY TRENCH BUCKETS SHALL BE COMPLETED TO AT LEAST 5% OF MANUAL DIG DEPTHS AND RETURNED TO THE STANARDS PRODUCTION FLOOR STAGES AND PAYMENTS SHALL BE COMPLETED TO AT LEAST 5% OF THE MANUAL DIG DEPTHS (AS PER CODES).
- CONTRACTOR SHALL CONTRACTOR OF THE WATER SERVICE TO BUILDINGS AND COORDINATED WITH ALL PLANS AND THE GOVERNING UTILITY AUTHORITY. THE AUTHORITY SHALL BE DETERMINED BY THE CONTRACTOR.
- CONTRACTOR SHALL SCHEDULE PRE-CONSTRUCTION CONFERENCE WITH OTHER CPW PRIOR TO WATER LINE CONSTRUCTION.
- CONTRACTOR SHALL COORDINATE ALL OTHER UTILITY CONNECTIONS WITH SPECIFICATIONS AND REQUIREMENTS OF THE ACCEPTING UTILITY AUTHORITY.
- THE CONTRACTOR SHALL CONDUCT ALL WORK IN ACCORDANCE WITH THE LATEST REQUIREMENTS OF THE OCCUPANCY, SAFETY AND HEALTH ADMINISTRATION.
- CONTRACTOR SHALL PROVIDE ALL NECESSARY UTILITY SCREENING TO MEET THE REQUIREMENTS OF FEDERAL CODE.
- ALL WATER SERVICES SHALL BE COMPLETED TO MEET THE REQUIREMENTS OF FEDERAL CODE.
- CONNECTION STOPS SHALL NOT BE LOCATED UNDERNEATH ANY DRIVEWAY OR SIDEWALK.
- ALL TRENCH HYDRANTS MUST BE INSTALLED WITH 4" STONG CONNECTION ON THE CENTER OF OUTLET.
- "4" MINIMUM DISTANCE FROM BOTTOM OF CENTER OF OUTLET HYDRANT TO HORIZONTAL DISTANCE.



CAUTION!!!
 Excavate below
 Call before you dig.

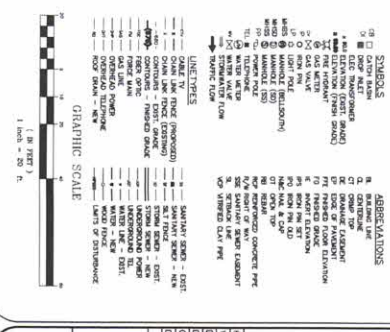

CITY OF GREER GREENVILLE COUNTY SOUTH CAROLINA

MIRASOL VILLAS (BRUSHY CREEK TRIPLEXES)

UTILITY PLAN

C5000

SITE DESIGN, INC.
 CIVIL ENGINEERS - SURVEYORS - LANDSCAPE ARCHITECTS

WWW.SITEDSIGN-INC.COM
 225 ROCKY CREEK ROAD
 GREENVILLE, SC 29615
 PH: (864)711-6667

DATE: 06/23/2022

NO. 1: REVISIONS PER CITY OF GREER COMMENTS 05/24/2022

NO. 2: REVISIONS PER CITY OF GREER COMMENTS 04/12/2022

NO. 3: FINAL CITY OF GREER PLAN SET 06/23/2022

NO. 4: REVISIONS PER CITY OF GREER COMMENTS 05/24/2022

NO. 5: REVISIONS PER CITY OF GREER COMMENTS 04/12/2022

NO. 6: REVISIONS PER CITY OF GREER COMMENTS 04/12/2022

NO. 7: REVISIONS PER CITY OF GREER COMMENTS 04/12/2022

NO. 8: REVISIONS PER CITY OF GREER COMMENTS 04/12/2022

NO. 9: REVISIONS PER CITY OF GREER COMMENTS 04/12/2022

NO. 10: REVISIONS PER CITY OF GREER COMMENTS 04/12/2022

NO. 11: REVISIONS PER CITY OF GREER COMMENTS 04/12/2022

NO. 12: REVISIONS PER CITY OF GREER COMMENTS 04/12/2022

NO. 13: REVISIONS PER CITY OF GREER COMMENTS 04/12/2022

NO. 14: REVISIONS PER CITY OF GREER COMMENTS 04/12/2022

NO. 15: REVISIONS PER CITY OF GREER COMMENTS 04/12/2022

NO. 16: REVISIONS PER CITY OF GREER COMMENTS 04/12/2022

NO. 17: REVISIONS PER CITY OF GREER COMMENTS 04/12/2022

NO. 18: REVISIONS PER CITY OF GREER COMMENTS 04/12/2022

NO. 19: REVISIONS PER CITY OF GREER COMMENTS 04/12/2022

NO. 20: REVISIONS PER CITY OF GREER COMMENTS 04/12/2022

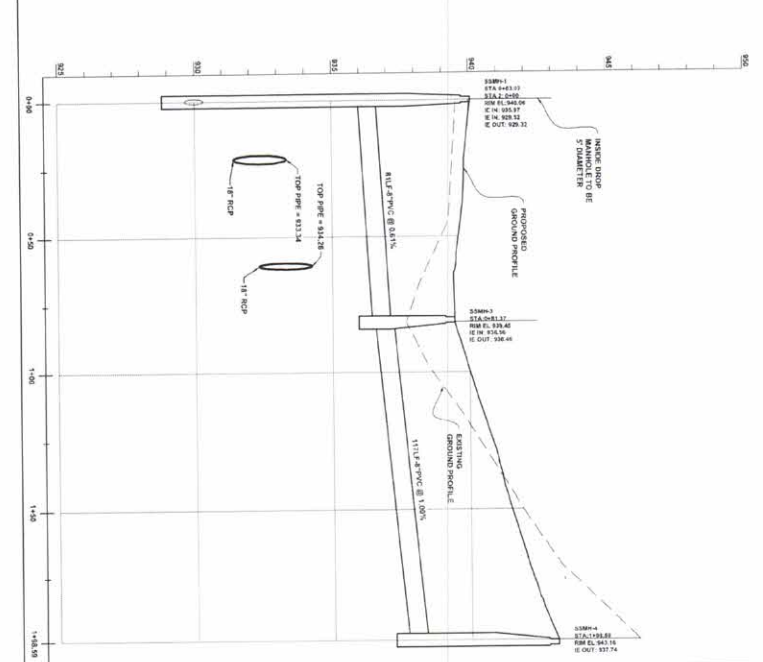
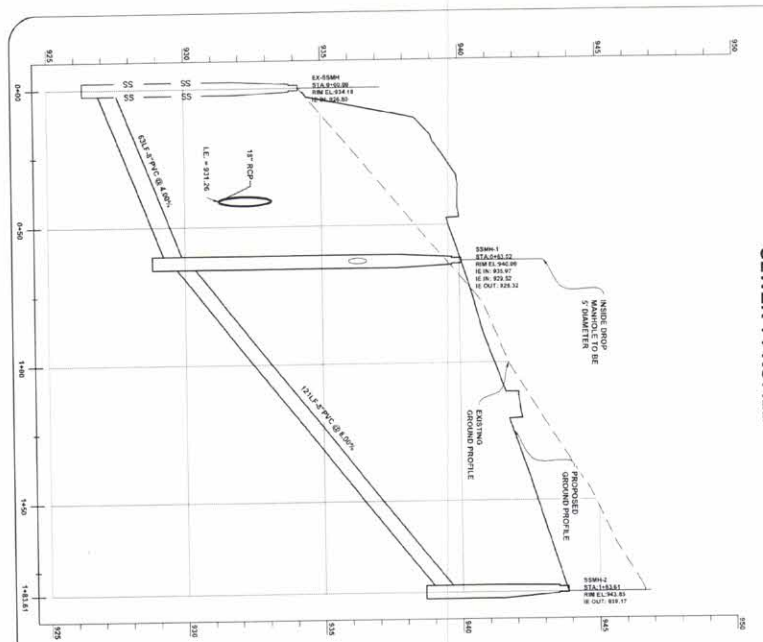
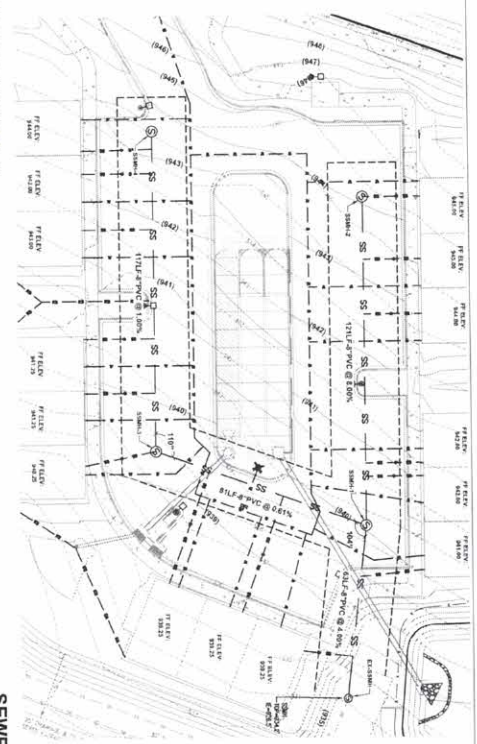

LOCATION MAP
NOT TO SCALE

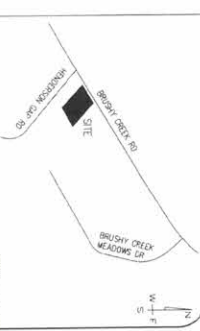

- UTILITY NOTES:**
1. ALL UTILITIES LOCATED ON THIS PLAN SHOULD BE CORROBORATED APPROXIMATELY. THE UTILITY LOCATING SERVICE, BY CALLING IN THREE (3) DAYS PRIOR TO CONSTRUCTION, AND UTILITY PROVIDERS.
 2. CONTRACTOR SHALL NOTIFY THE ENGINEER FOR ANY DISCREPANCIES IN ANY DISCREPANCIES. DISCREPANCIES SHALL BE CORRECTED TO AT LEAST 5% OF LOCAL CODES. IN ADDITION, THE UTILITY BE CALLED TO AT LEAST 5% OF THE MAXIMUM CITY DESIRTY (45% CAL).
 3. CONTRACTOR SHALL CONSTRUCT DOMESTIC WATER SERVICE TO BUILDINGS AND CONDUITS WITH WEP PLANS AND THE GOVERNING UTILITY AUTHORITY. THIS TO BE INSTALLED TO THE SPECIFICATIONS OF THE GOVERNING UTILITY AUTHORITY.
 4. CONTRACTOR SHALL SECURE THE CONSTRUCTION COMPLIANCE WITH GREEN CFW FROM TO WATER LINE CONSTRUCTION.
 5. CONTRACTOR SHALL COORDINATE ALL OTHER UTILITY CONNECTIONS WITH LOCAL PROVIDERS. CONTRACTOR SHALL INSTALL ALL UTILITIES TO THE SPECIFICATIONS AND REQUIREMENTS OF THE GOVERNING UTILITY AUTHORITY. THE LOCAL REQUIREMENTS OF THE OCCUPATIONAL SAFETY AND HEALTH ADMINISTRATION.
 6. THE CONTRACTOR SHALL PROVIDE ALL NECESSARY UTILITY SCREENINGS TO MEET THE REQUIREMENTS OF GREEN CFW.
 7. ALL WATER SERVICES SHALL BE COPPER PROGRAM TO MEET.
 8. CONDUIT/PIPE SHALL NOT BE LOCATED UNDERNEATH ANY DRIVEWAY OR SIDEWALK.
 9. CONDUIT/PIPE SHALL NOT BE LOCATED UNDERNEATH ANY DRIVEWAY OR SIDEWALK.
 10. CONDUIT/PIPE SHALL NOT BE LOCATED UNDERNEATH ANY DRIVEWAY OR SIDEWALK.
 11. CONDUIT/PIPE SHALL NOT BE LOCATED UNDERNEATH ANY DRIVEWAY OR SIDEWALK.
 12. 12" MINIMUM DISTANCE FROM BOTTOM OF CENTER OUTLET OR BERE HEADRANT TO FINISHED GRADE.



*****CAUTION*****
Know what's below.
Call before you dig.

LEGEND

□	CONCRETE	○	MANHOLE
○	CAST-IRON	○	SEWER
○	CLAY	○	WATER
○	GLASS	○	TELEPHONE
○	STEEL	○	CABLE
○	ALUMINUM	○	PLUMBING
○	PLASTIC	○	OTHER
○	WOOD	○	UNIDENTIFIED
○	ASBESTOS	○	UNKNOWN
○	OTHER	○	UNIDENTIFIED



SITE DESIGN, INC.
200 E. HICKORY STREET, SUITE 100 - ANDERSON ARCHITECTS
www.sitedesign-inc.com
226 HICKORY CREEK ROAD
GREENVILLE, SC 29615
PH: (864) 71-0491

MIRASOL VILLAS (TRIPLETS) GREENVILLE, SOUTH CAROLINA

CITY OF GREER GREENVILLE COUNTY SOUTH CAROLINA

SEWER PLAN & PROFILE

PROJECT NO. 19

C501

DATE

NO.	DATE	REVISIONS PER CITY OF GREER COMMENTS
1	06/23/2022	FINAL CITY OF GREER PLAN SET
2	06/24/2022	REVISING PER CITY OF GREER COMMENTS
3	04/12/2022	REVISING PER CITY OF GREER COMMENTS

GRAPHIC SCALE

1 inch = 20 ft

NOTES:

1. ALL UTILITIES LOCATED ON THIS PLAN SHOULD BE CORROBORATED APPROXIMATELY.
2. CONTRACTOR SHALL NOTIFY THE ENGINEER FOR ANY DISCREPANCIES IN ANY DISCREPANCIES. DISCREPANCIES SHALL BE CORRECTED TO AT LEAST 5% OF LOCAL CODES. IN ADDITION, THE UTILITY BE CALLED TO AT LEAST 5% OF THE MAXIMUM CITY DESIRTY (45% CAL).
3. CONTRACTOR SHALL CONSTRUCT DOMESTIC WATER SERVICE TO BUILDINGS AND CONDUITS WITH WEP PLANS AND THE GOVERNING UTILITY AUTHORITY. THIS TO BE INSTALLED TO THE SPECIFICATIONS OF THE GOVERNING UTILITY AUTHORITY.
4. CONTRACTOR SHALL SECURE THE CONSTRUCTION COMPLIANCE WITH GREEN CFW FROM TO WATER LINE CONSTRUCTION.
5. CONTRACTOR SHALL COORDINATE ALL OTHER UTILITY CONNECTIONS WITH LOCAL PROVIDERS. CONTRACTOR SHALL INSTALL ALL UTILITIES TO THE SPECIFICATIONS AND REQUIREMENTS OF THE GOVERNING UTILITY AUTHORITY. THE LOCAL REQUIREMENTS OF THE OCCUPATIONAL SAFETY AND HEALTH ADMINISTRATION.
6. THE CONTRACTOR SHALL PROVIDE ALL NECESSARY UTILITY SCREENINGS TO MEET THE REQUIREMENTS OF GREEN CFW.
7. ALL WATER SERVICES SHALL BE COPPER PROGRAM TO MEET.
8. CONDUIT/PIPE SHALL NOT BE LOCATED UNDERNEATH ANY DRIVEWAY OR SIDEWALK.
9. CONDUIT/PIPE SHALL NOT BE LOCATED UNDERNEATH ANY DRIVEWAY OR SIDEWALK.
10. CONDUIT/PIPE SHALL NOT BE LOCATED UNDERNEATH ANY DRIVEWAY OR SIDEWALK.
11. CONDUIT/PIPE SHALL NOT BE LOCATED UNDERNEATH ANY DRIVEWAY OR SIDEWALK.
12. 12" MINIMUM DISTANCE FROM BOTTOM OF CENTER OUTLET OR BERE HEADRANT TO FINISHED GRADE.

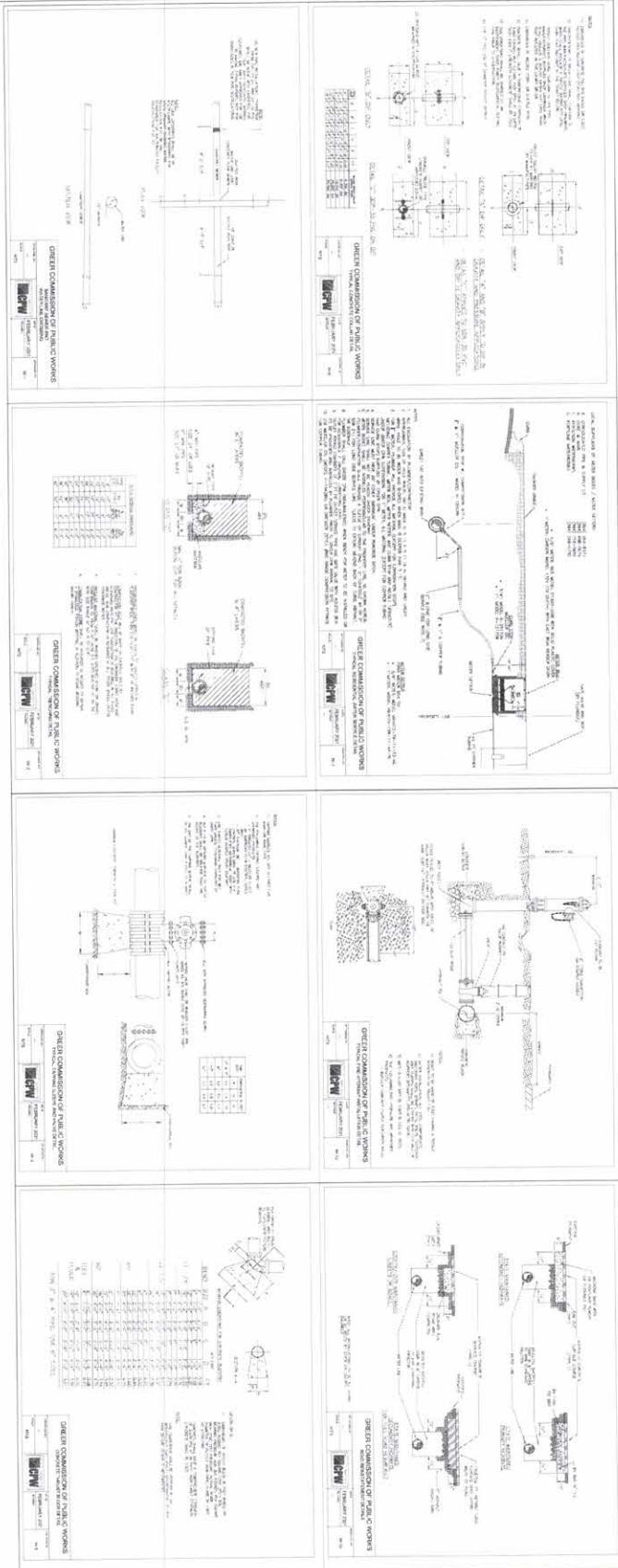

SHEET 1107 19
C550
 UTILITY
 DETAILS
 SHEET SCALE: 1" = 8'-0"
 NEXT SCALE: N/A
 DESIGNED BY: CI
 DRAWN BY: CI
 CHECKED BY: CW
 DATE: 05/24/2022
 S110411.dwg

MIRRASOL VILAS
 (BRUSHY CREEK
 TRIPLEXES)
 CITY OF GREER
 GREENVILLE COUNTY
 SOUTH CAROLINA

THIS DRAWING IS THE PROPERTY OF SITE DESIGN, INC. IT IS PROVIDED TO THE CITY OF GREER FOR THE PROJECT DESCRIBED HEREIN. IT IS NOT TO BE REPRODUCED, COPIED, OR TRANSMITTED IN ANY FORM OR BY ANY MEANS, ELECTRONIC OR MECHANICAL, INCLUDING PHOTOCOPYING, RECORDING, OR BY ANY INFORMATION STORAGE AND RETRIEVAL SYSTEM, WITHOUT THE WRITTEN PERMISSION OF SITE DESIGN, INC.

S.C. REG NO 2280

NO.	REVISION	DATE
1	ISSUING PER CITY OF GREER COMMENTS	06/13/2022
2	REVISION PER CITY OF GREER COMMENTS	05/24/2022
3	FINAL CITY OF GREER PLAN SET	06/13/2022

SITE DESIGN, INC.
 CIVIL ENGINEERS - SURVEYORS - LANDSCAPE ARCHITECTS

www.sitedesign-inc.com
 205 ROCKY CREEK ROAD
 GREENVILLE, SC 29611
 PH: 864.521.6493

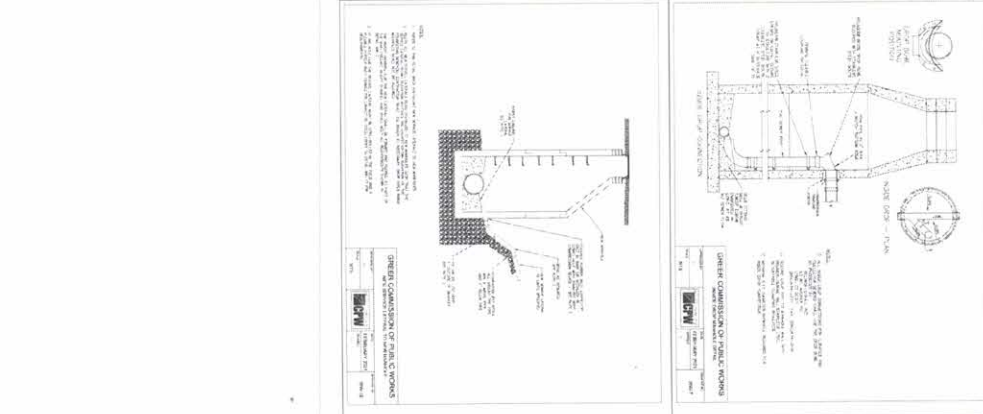
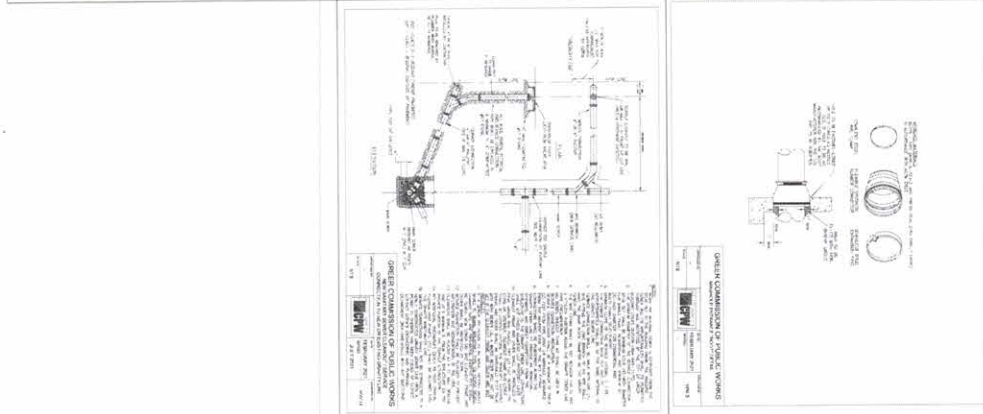
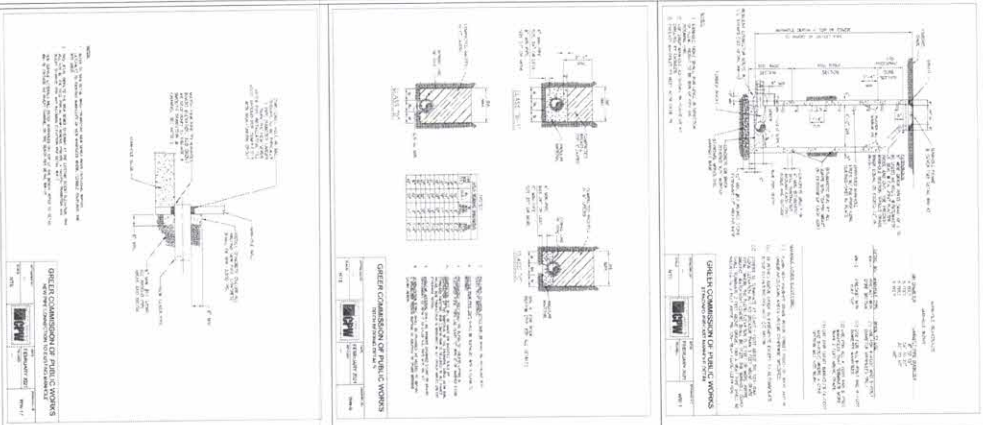

CS51
 UILITY
 DETAILS

VERT. SCALE: 1" = 30'
 HORIZ. SCALE: N/A
 DESIGNED BY: CR
 DRAWN BY: CR
 CHECKED BY: CR
 DATE: 05/24/2022

MIRASOL VILLAS
GRUSHY CREEK
TRIPLE EXES
 CITY OF GREER
 GREENVILLE COUNTY
 SOUTH CAROLINA



1	REVISIONS PER CITY OF GREER COMMENTS	06/23/2022
2	REVISIONS PER CITY OF GREER COMMENTS	07/21/2022
3	REVISIONS PER CITY OF GREER COMMENTS	04/13/2022
4	FINAL CITY OF GREER PLAN SET	06/23/2022
5		
6		
7		
8		
9		
10		

SITE DESIGN, INC.
 CIVIL ENGINEERS - SURVEYORS - LANDSCAPE ARCHITECTS

www.sitedesign-inc.com
 528 ROCKY CREEK ROAD
 GREENVILLE, SC 29615
 PH: (864)211-0491

SITE DATA:
 PWS 0068359311
 TOTAL SITE - 3.66 AC (241,812 S.F.)
 80% LOT COVERED AREA - 2,83,434 S.F. (6.48 AC)
 ZONING - RM-2 (MULTIFAMILY)
 SETBACKS:
 FRONT - 20'
 SIDE - 15'

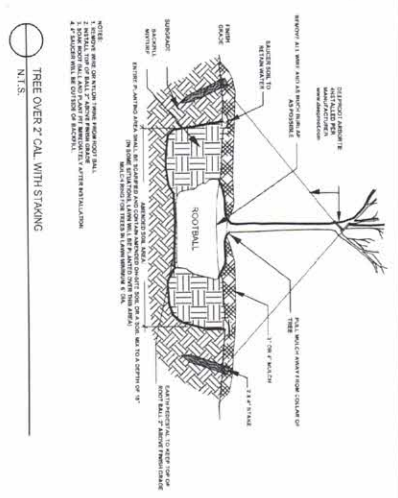
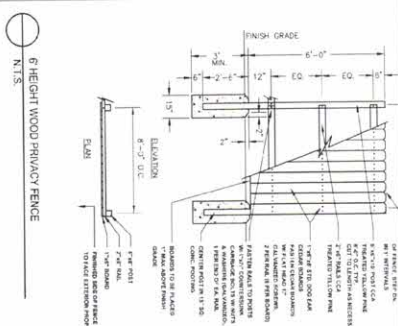
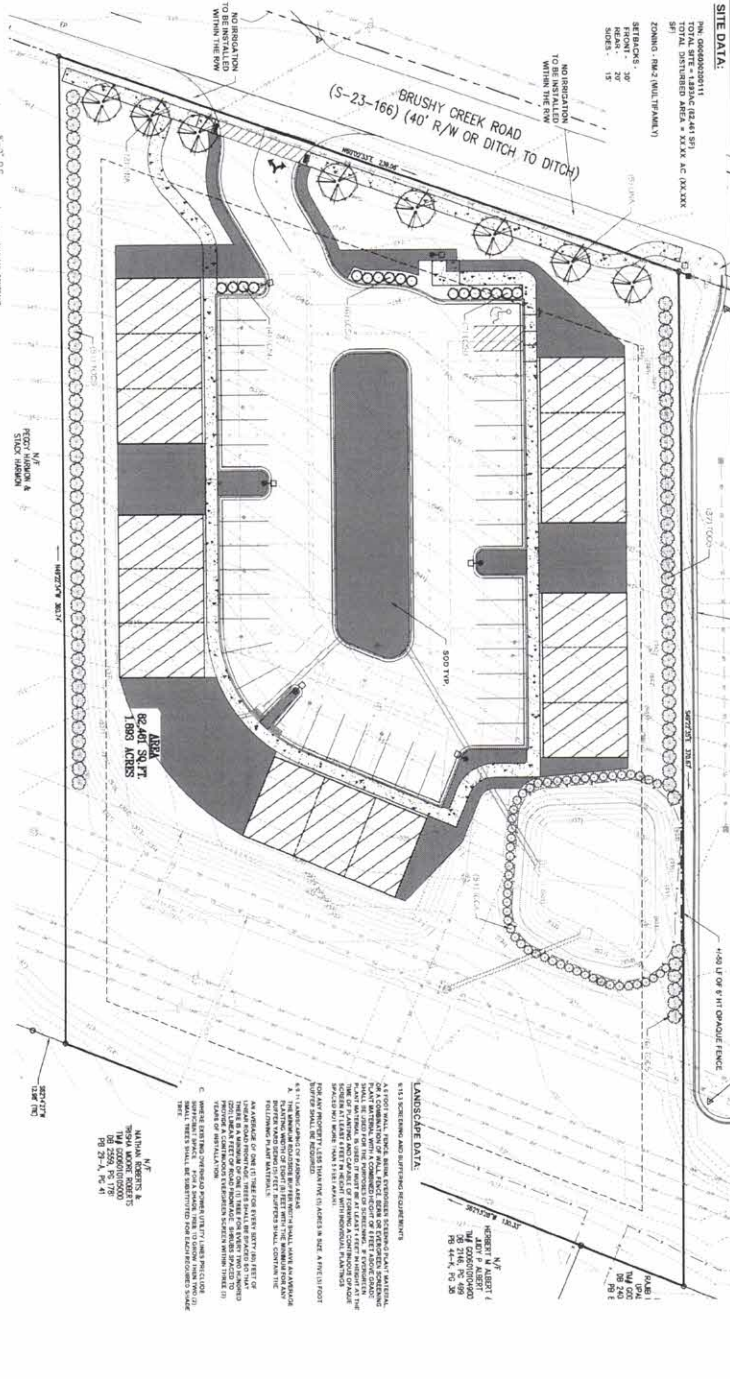

PLANT SCHEDULE

TREES	CODE	QTY	BOTANICAL NAME	COMMON NAME	SIZE	REMARKS
	L100	2	Lagerflora's Florida Magnolia	Magnolia Grandiflora	27" Cal. B. HT.	3 CHAINS MIN.
	E100	2	Black-leafed Sycamore	Plantago lanceolata	3.5 gal.	
	L150	2	Lagerflora's Florida Magnolia	Magnolia Grandiflora	3.5 gal.	
	S100	2	Shrub	Shrub	4" HT.	

GRAPHIC SCALE
 1" = 20' FT
 1" = 10' FT

CAUTION
 Know what's Below.
 Call before you dig.

811
 Know what's Below.
 Call before you dig.

LOCATION MAP
 NOT TO SCALE
 BRUSHY CREEK RD
 ROCKY CREEK RD
 BRUSHY CREEK MEADOWS DR

GENERAL NOTES:
 1. ALL DIMENSIONS ARE SHOWN UNLESS OTHERWISE NOTED.
 2. ALL DIMENSIONS ARE TO FACE UNLESS OTHERWISE NOTED.
 3. ALL DIMENSIONS ARE TO CENTERLINE UNLESS OTHERWISE NOTED.
 4. ALL DIMENSIONS ARE TO CENTERLINE UNLESS OTHERWISE NOTED.
 5. ALL DIMENSIONS ARE TO CENTERLINE UNLESS OTHERWISE NOTED.
 6. ALL DIMENSIONS ARE TO CENTERLINE UNLESS OTHERWISE NOTED.
 7. ALL DIMENSIONS ARE TO CENTERLINE UNLESS OTHERWISE NOTED.
 8. ALL DIMENSIONS ARE TO CENTERLINE UNLESS OTHERWISE NOTED.
 9. ALL DIMENSIONS ARE TO CENTERLINE UNLESS OTHERWISE NOTED.
 10. ALL DIMENSIONS ARE TO CENTERLINE UNLESS OTHERWISE NOTED.

SITE DESIGN, INC.
 CIVIL ENGINEERS - SURVEYORS - LANDSCAPE ARCHITECTS

www.sitedesign-inc.com
 275 ROCKY CREEK ROAD
 GREENVILLE, SC 29615
 PH: 864.271.6464

MIRASOL VILLAS
 S.C. REG NO 532

DATE: _____

LANDSCAPE PLAN

PROJECT: MIRASOL VILLAS
 DATE: 06/22/2021
 DRAWN BY: JLM
 CHECKED BY: AJG
 SITE NO: 1100