

PLAN KEYNOTES	
MARK	DESCRIPTION
A-07	BIKE RACKS - FREE-STANDING, HIGH DENSITY, VERTICAL BIKE RACK SYSTEMS W/ LOCKING LOOP, 10 BIKE CAPACITY, BLACK-PAINTED STEEL FRAME, OFFSET VR2 BY GROUND CONTROL SYSTEMS OR EQUAL.

- GENERAL NOTES**
- 0'-0" = EL. 538.75. SEE CIVIL DRAWINGS.
 - REFER TO CIVIL ENGINEERING PLANS FOR ALL GRADES, SLAB ELEVATIONS AND UTILITY CONNECTIONS.
 - REFER TO STRUCTURAL ENGINEERING PLANS FOR FOUNDATION ELEVATION.
 - SLOPE SLAB TO DRAINS - REFER TO PLUMBING DRAWINGS FOR DRAIN LOCATIONS AND CIVIL DRAWINGS FOR SLAB ELEVATIONS.
 - DO NOT SCALE DRAWINGS. VERIFY DIMS PRIOR TO FRAMING. ALL DIMS ARE TO ROUGH FRAMING.
 - REFER TO BUILDING ELEVATIONS FOR WINDOW TYPES/INFO AND FOR INDICATION OF MASONRY CONTROL JOINTS.
 - ALL ANGLED PARTITIONS ARE 45° U.N.O.
 - REFER TO SHEET A-030 AND A-031 FOR PARTITION TYPES.
 - TYPICAL EXTERIOR FRAME WALL DIMS TO BE 6" NOMINAL U.N.O.
 - PLUMBING WALLS TO BE 2X6 AT 16" O.C. OR DOUBLED EXTERIOR WALLS WITH INSULATION AND THERMOPLY UNLESS WATER SUPPLIED THROUGH FLOOR.
 - AT ALL WET AREAS PROVIDE MOISTURE RESISTANT WALL BOARD AND AT TILED AREAS PROVIDE CEMENT BOARD.
 - PROVIDE BUILDING WRAP ON ALL SHEATHING, ALL SEAMS TO BE LAPPED, AND TAPED PER MANUFACTURER. LAP AND TAPE OVER FLASHING.
 - INSULATE ALL CONCEALED SPACES AT EXTERIOR WALLS.
 - CAULK SILL PLATES, JOINTS BETWEEN MULTIPLE STUDS, PIPE AND VENT PENETRATIONS, WINDOW AND DOOR OPENINGS, AND WHEREVER AIR INFILTRATION MAY OCCUR.
 - PROVIDE ALUMINUM FLASHING AT ALL ROOF/WALL INTERSECTIONS, ABOVE WINDOW DOOR HEADS AND BAND BOARDS, AND CHIMNEY PENETRATIONS AT ROOF.
 - FIRESTOP BETWEEN VERTICAL AND HORIZONTAL CONCEALED SPACES SUCH AS SOFFITS, STAIR FRAMING, AND MECHANICAL CHASES WITH SOLID 2X DIMENSIONAL LUMBER OR 1/2" DRYWALL DRAFTSTOP IN FIRESTOP AREAS WITH CAULK OR FOAM SEALER.
 - CARPENTER, HVAC, PLUMBING, AND ELECTRICAL CONTRACTORS TO COORDINATE PLACEMENT OF ALL DUCTS, PIPES, AND WIRING PRIOR TO FRAMING. ELECTRICAL AND MECHANICAL EQUIPMENT AND METERS ARE SUBJECT TO RELOCATION DUE TO FIELD CONDITIONS.
 - PROVIDE AND INSTALL INCOMBUSTIBLE VENT AT KITCHEN COOKTOP AND MICROWAVE PER OWNER REQUIREMENTS.
 - PROVIDE AND INSTALL SHELVING AT ALL CLOSETS PER OWNER REQUIREMENTS.
 - ALL INTERIOR WALLS TO BE FINISHED WITH 5/8" DRYWALL U.N.O.
 - ELEVATOR TO BE SCHINDLER 3300 XL MRL TRACTION ELEVATOR OR EQUAL.
 - PROVIDE SILANE SEALER AT TRASH ROOM.
 - PROVIDE VAPOR BARRIER AT ALL CONDITIONED SLAB ON GRADE AREAS.
 - SLOPE AND CROSS SLOPES AT HANDICAP PARKING SPACES NOT TO EXCEED 1:48.

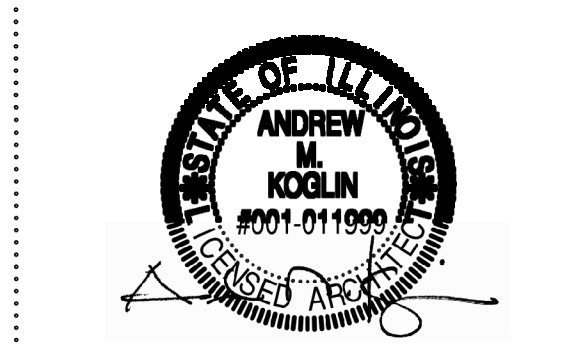
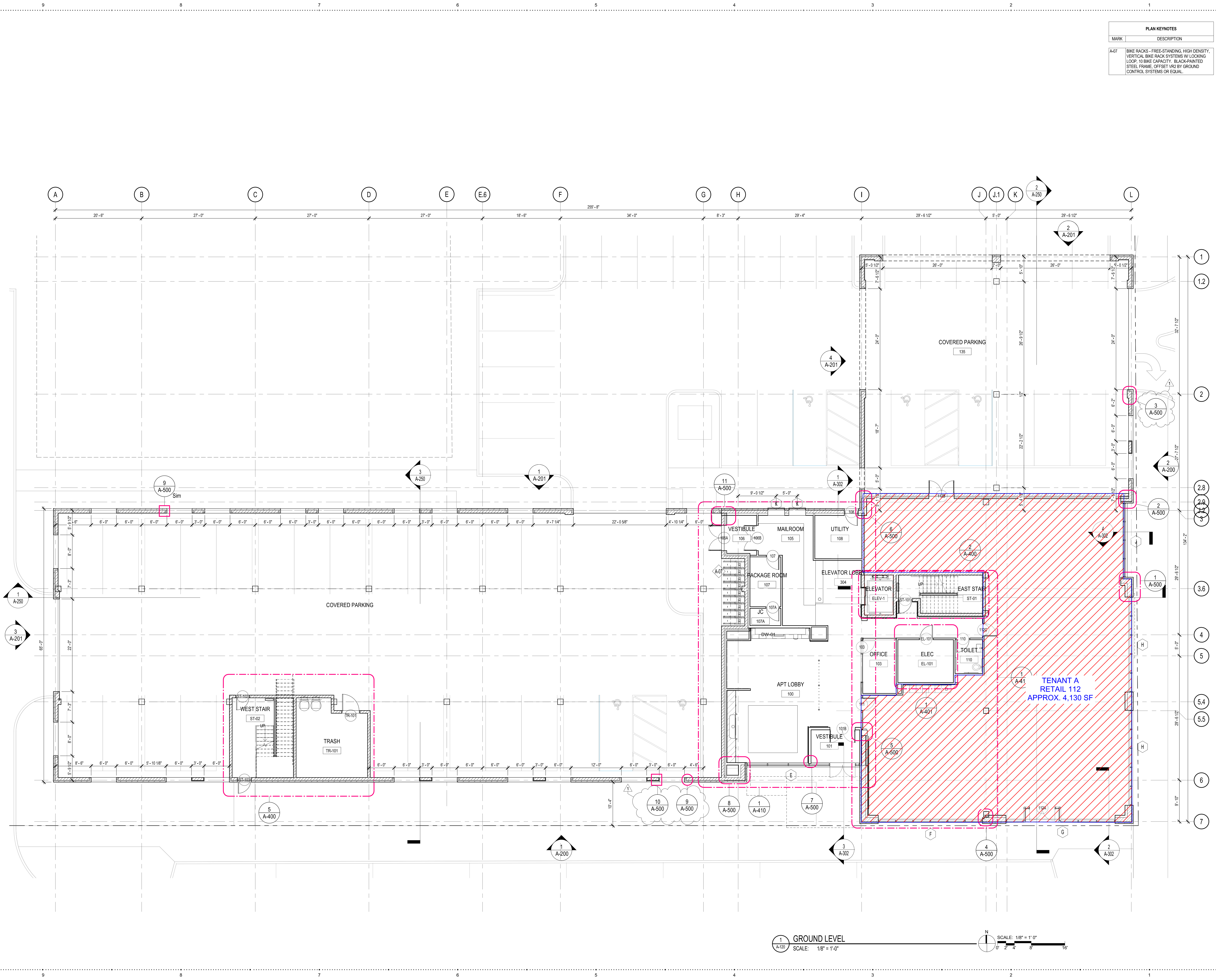

NO.	REVISION	DATE
1	ISSUED FOR PERMIT REVISIONS	2022.09.21
2	ISSUED FOR PERMIT	2022.09.21
3	ISSUED FOR 100% CDD	2022.09.21
4	ISSUED FOR 90% CDD	2022.09.21
5	ISSUED FOR SCHEMATIC DESIGN	2022.01.20
6	ISSUED FOR	DATE

OKW Architects

OKW Architects
600 West Jackson Blvd
Chicago, IL 60661
T 312.798.7700
F 312.798.7777
www.okwarchitects.com

OAK FOREST MIXED-USE

157TH & CICERO
OAK FOREST, IL

GROUND LEVEL PLAN

DRAWN BY: AS, SD CHECKED: AR

DATE: 05/06/22 SHEET NO.: A-120

PROJ. NO.: 21030

GROUND LEVEL
SCALE: 1/8" = 1'-0"

N

SCALE: 1/8" = 1'-0"