

30 JEFFERSON PARK ROAD WARWICK, RI

FLEX OFFICE SPACE ± 6,845 – 15,920 SF AVAILABLE / FOR LEASE



DAVE LUCIVERO / dlucivero@hayessherry.com / +1 401 273 2068



**CUSHMAN &
WAKEFIELD**

HAYES & SHERRY

30 JEFFERSON PARK ROAD

WARWICK, RI

FLEX OFFICE SPACE ± 6,845 – 15,920 SF AVAILABLE / FOR LEASE

LOCATION

30 Jefferson Park Road is located in the Jefferson Boulevard business/industrial corridor of Warwick, RI with easy access on or off I95. The location offers excellent regional accessibility and benefits from strong transportation connections and a central location within Rhode Island's primary business corridor.

PROPERTY FEATURES

- ± 51,082 SF Multi-tenant flex building
- 16' Ceiling heights
- One (1) loading dock
- Unit 1: ± 9,075 SF
- Unit 2: ± 6,845 SF
 - ± 15,920 SF Contiguous

AVAILABILITY

Immediate

ASKING RENT

\$10.00 / SF, NNN

NEIGHBORS

Courtyard Providence Warwick, Dogtopia, Motel 6 Warwick, The Cookie Countess, Kenilworth Creations Fashion Accessories, Wyndham and more...

DEMOGRAPHICS

<u>Mi.</u>	<u>Population</u>	<u>Daytime Pop</u>
0.5	1,797	2,582
1.0	9,902	8,462
2.0	43,491	47,269

<u>Mi.</u>	<u>Est HH Income</u>	<u>Total Businesses</u>
0.5	\$100,353	266
1.0	\$87,814	694
2.0	\$88,704	3,468

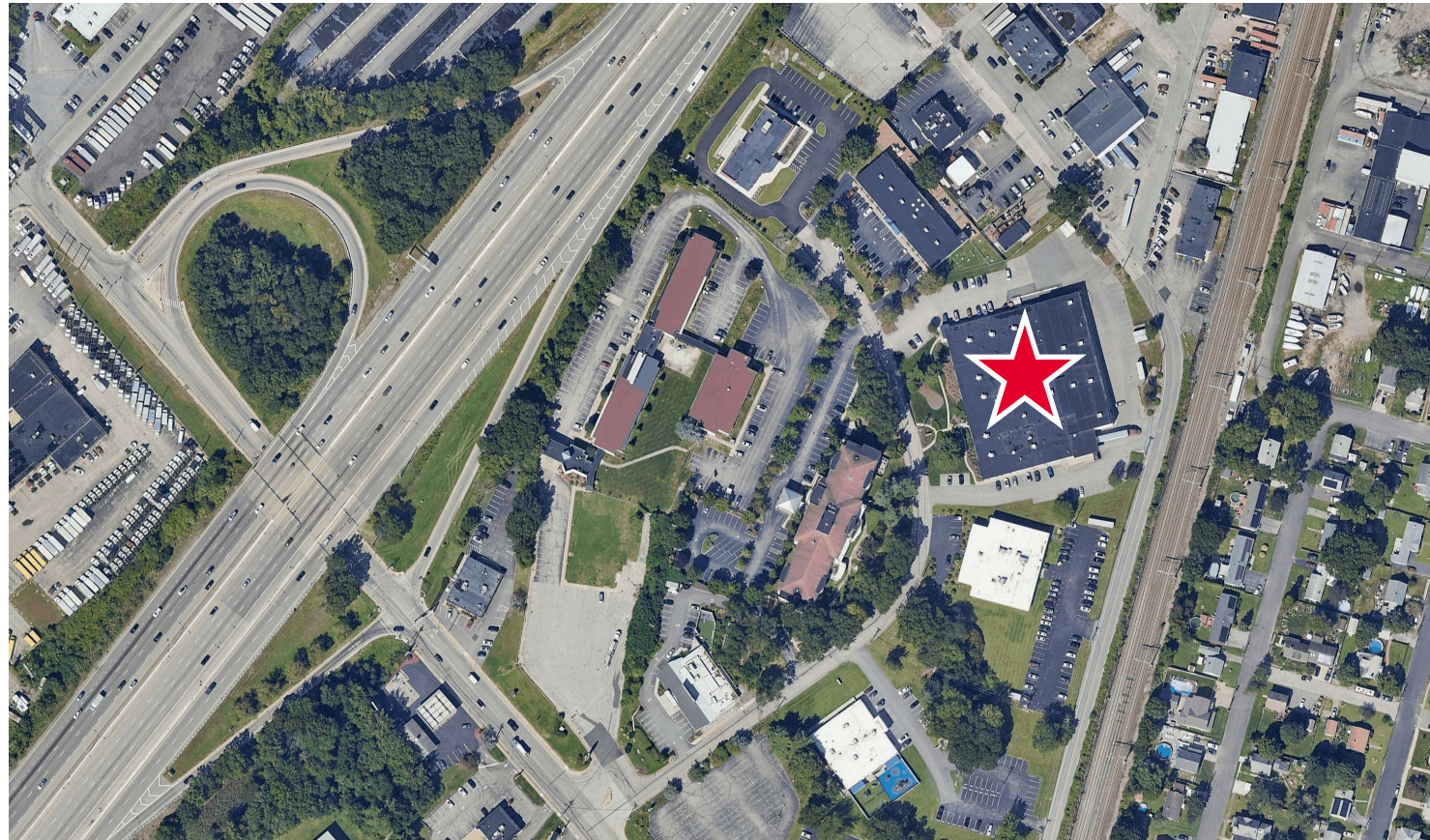

30 JEFFERSON PARK ROAD WARWICK, RI

FLOORPLAN

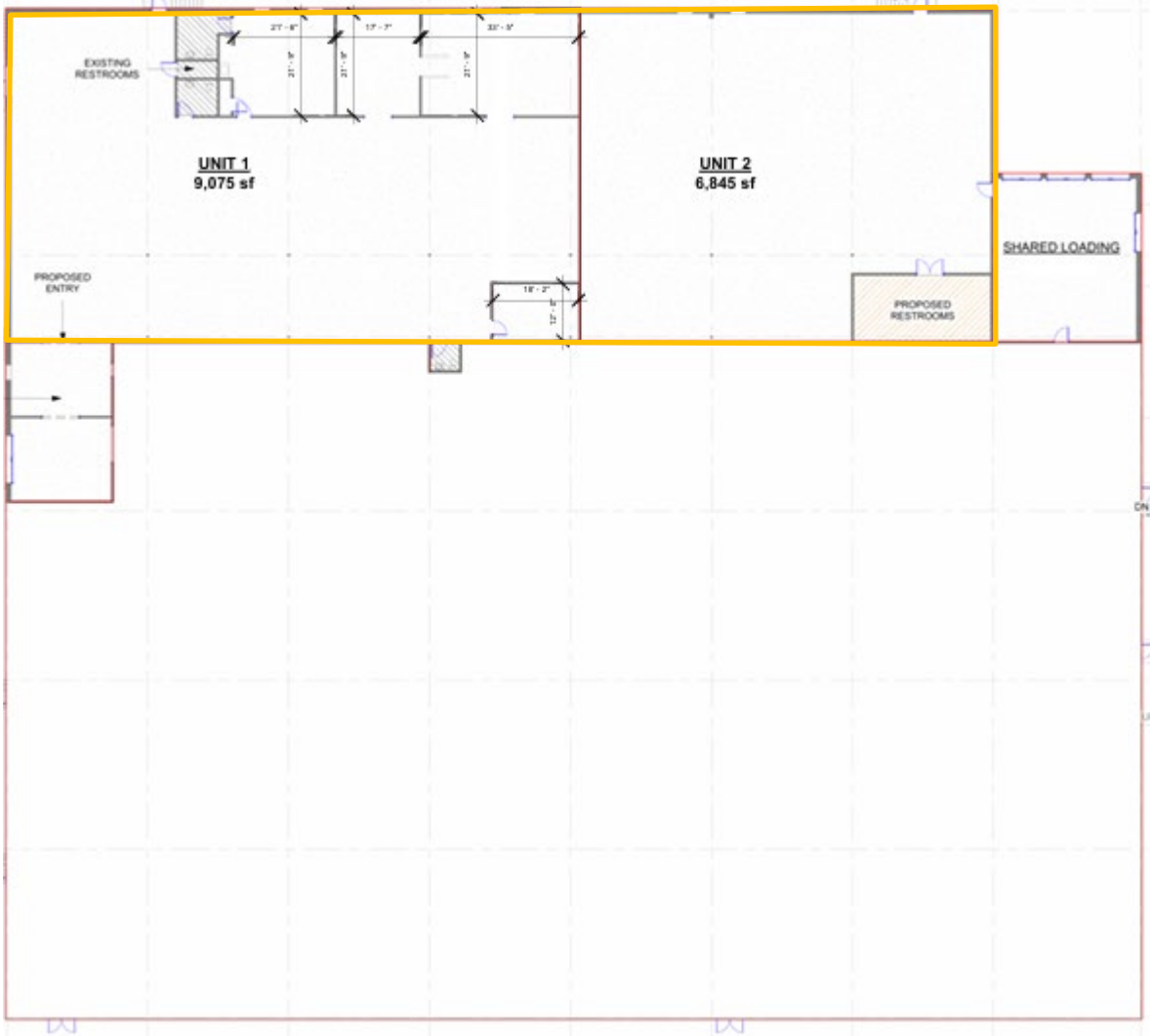

30 JEFFERSON PARK ROAD WARWICK, RI

AERIAL

