

# Carillon Court

402-440 N. Weber Rd.  
Romeoville, IL 60446  
Will County

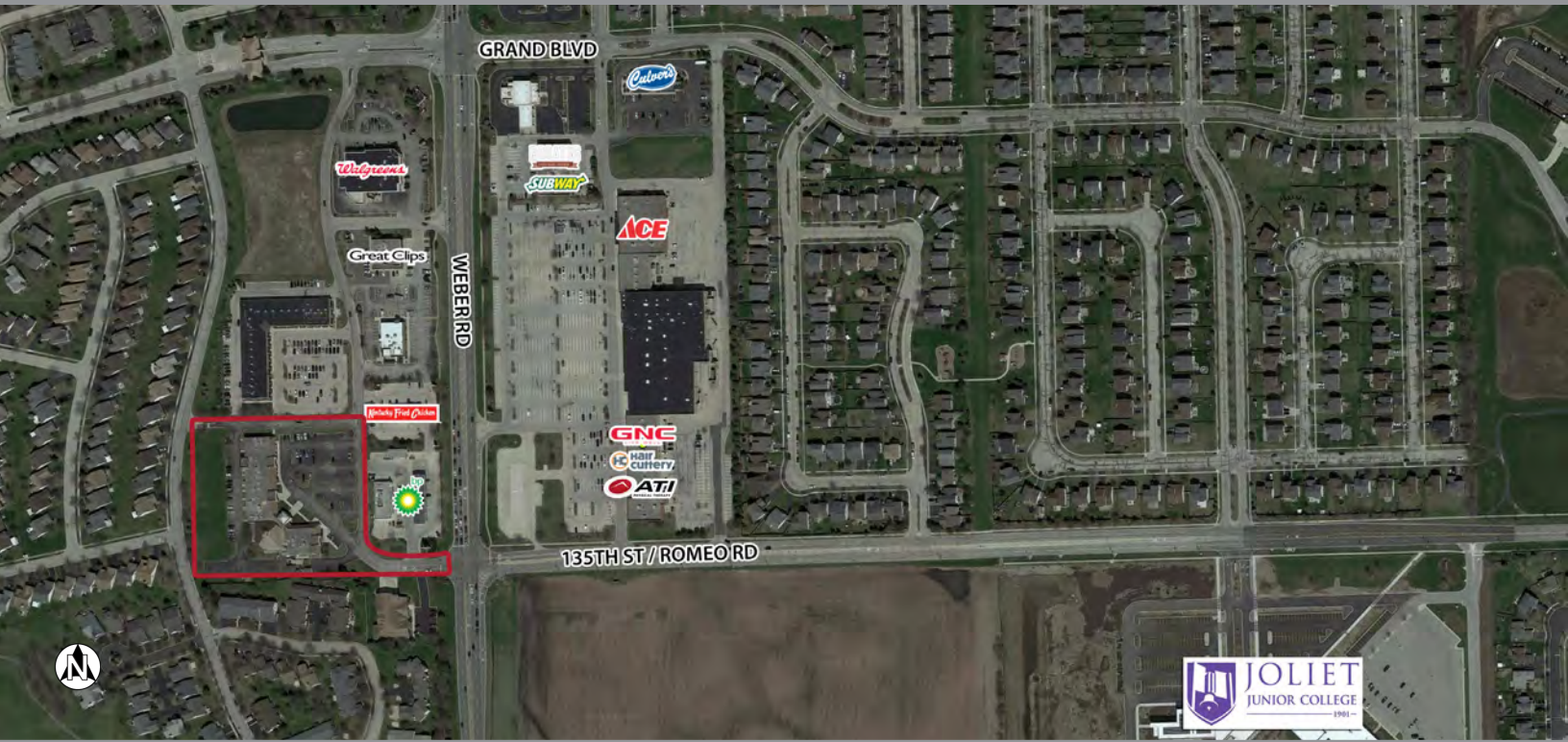

## key features

- highly visible 29,209-sf shopping center located at the signalized intersection of Weber Road and 135th Street
- co-tenancy includes Planet Chiropractic, Michael's Pizza, and Stella's Grill
- beautiful new façade renovation
- less than one mile from I-55 interchange at Weber Road and only 30 minutes from downtown Chicago
- daily traffic counts: 34,700 on Weber Road and 6,650 on 135th Street/Romeo Road

## demographics

	1 mile	3 miles	5 miles
population	8,045	61,696	147,988
households	3,674	21,211	49,404
avg. household income	\$95,589	\$117,478	\$127,079
daytime population	4,987	38,230	103,579

2024 Estimates. Source: Applied Geographic Solutions 5/2024, TIGER Geography

**retail space for lease** 1,370 – 3,500 sf

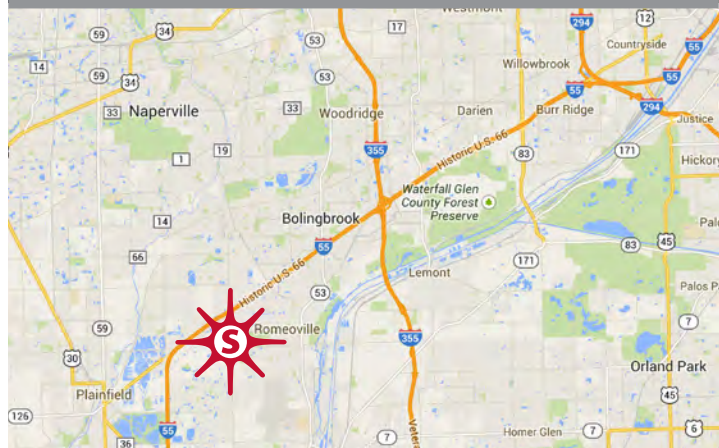

Nick Orozco 480.385.1316 [norozco@sandordev.com](mailto:norozco@sandordev.com)

5725 N. Scottsdale Rd., Suite C-195, Scottsdale, AZ 85250

[www.sandordev.com](http://www.sandordev.com)

**sandor**

# Carillon Court

402-440 N. Weber Rd.  
Romeoville, IL 60446  
Will County

UNIT	TENANT	DIMS.	S.F.	UNIT	TENANT	DIMS.	S.F.
402	STELLA'S GRILL	39 x 70	2,718	430	LA MICHOCANA TROPICAL ICE CREAM	20 x 70	1,400
408	AVAILABLE - <i>CAN BE COMBINED</i>	30 x 70	2,100	432	PLANET CHIROPRACTIC	31.4 x 70	2,200
410	AVAILABLE - <i>WHITE BOX / CAN BE COMBINED</i>	20 x 70	1,400	436A	AVAILABLE	20 x 70	1,400
412	VERILIFE	10.5 x 70 IRR	7,639	438	BOTTOM SIP LIQUORS	30 x 70	2,100
416	AVAILABLE	19.6 x 70	1,370	438A	AVAILABLE	25 x 70	1,750
422	MICHAEL'S PIZZA	28.5 x 70	2,000	440	ROSA'S SALON	20 x 70	1,400
426	CARILLON CLEANERS	24.7 x 70	1,732				

