



THERM-ALL

www.therm-all.com | 888-2-INSUL-8

ProLiner™ Banded Liner System (Ls)

Provides OSHA-Compliant
Fall Protection and Meets
Energy Code Requirements



- **Fall Protection:** Provides leading-edge fall protection¹
- **Thermal Performance:** Full range of R-values to meet energy code requirements in ALL climate zones²
- **Noise control:** Reduces noise transfer from inside and outside of the building, providing superior sound abatement
- **Durable finished appearance:** A low permeance fabric serves as the vapor retarder, preventing condensation, contributing to air barrier integrity, and providing a brighter, resilient finish
- **Meets fire code ratings**
- **GREENGUARD Certified**

For more information about **ProLiner™**,
contact your local Therm-All representative,
visit therm-all.com or call **888-2-INSUL-8**.



ASHRAE 90.1 (2013) Table A2.3.3

Insulation System¹ Rated R-Value of Insulation Overall U-Factor for Entire Base Roof Assembly

Standing Seam Roof with Thermal Spacer Blocks ^{a,b} (see below)

Liner System	R-19 + R-11	0.037
	R-25 + R-8	0.037
	R-25 + R-11	0.031
	R-30 + R-11	0.029
	R-25 + R-11 + R-11	0.026

Standing Seam Roofs without Thermal Spacer Blocks

Liner System	R-19 + R-11	0.040
--------------	-------------	-------

Through-Fastened Roofs without Thermal Spacer Blocks

Liner System	R-19 + R-11	0.044
--------------	-------------	-------

- a. A standing seam roof clip that provides a minimum clip height of 1.5" from underside of roof and top of purlin.
- b. A minimum R-3 thermal spacer is required.

Wall Assembly U-Values

Thermal Break	Cavity Insulation	Wall U-Factor
None	R-19 MBI+	0.066
1/8" Foam	R-25 MBI+	0.057
1/8" Foam	R-30 MBI+	0.049
Certified R-13	R-30 MBI+	0.042

Calculations based on 8" girts spaced 5' on center.

- 1 Meets the requirements of OSHA Standard 29 CFR 1926.502 (c)(4)(i) and OSHA Standard 29 CFR 1926.760 (a) (1) for leading edge fall protection and OSHA Standard 29 CFR 1926.754 (e)(3)(i) covers for roof and floor openings.
- * ProLiner™ meets the definition of Liner System (Ls) as described in ASHRAE 90.1 and IECC requirements.

ProLiner™ Roof

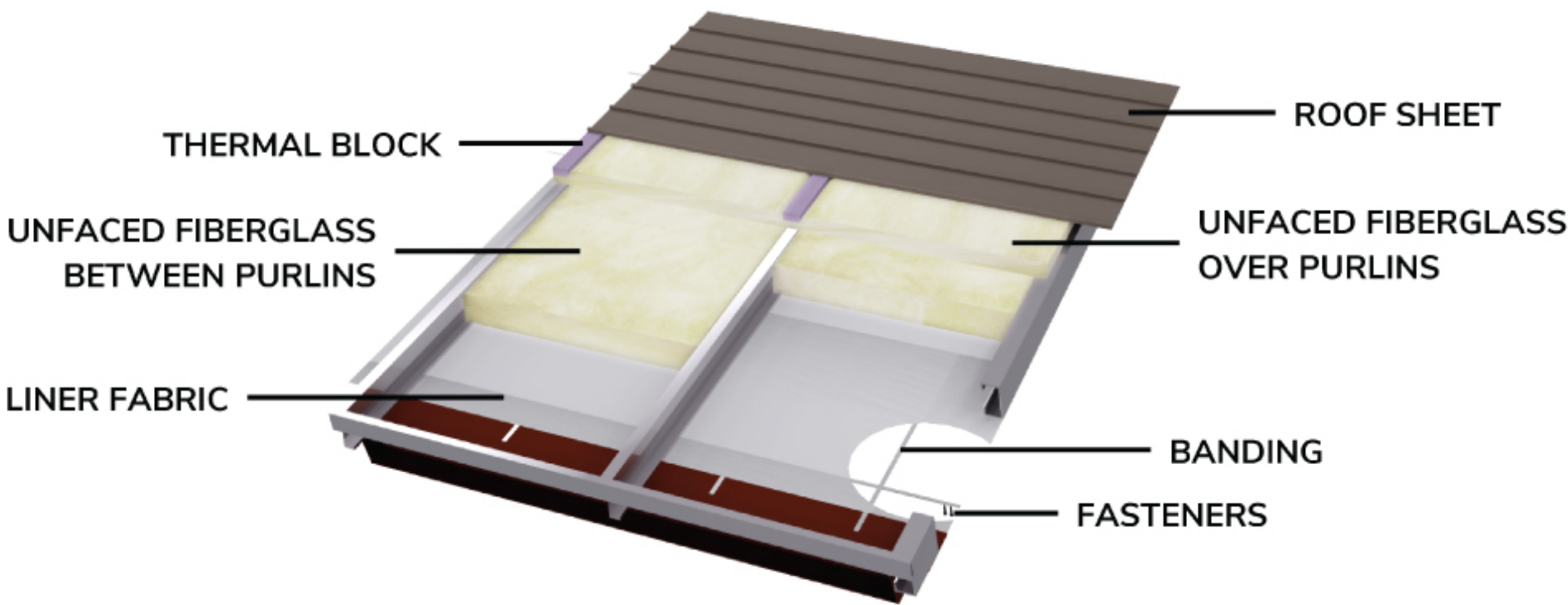

ProLiner™ Wall

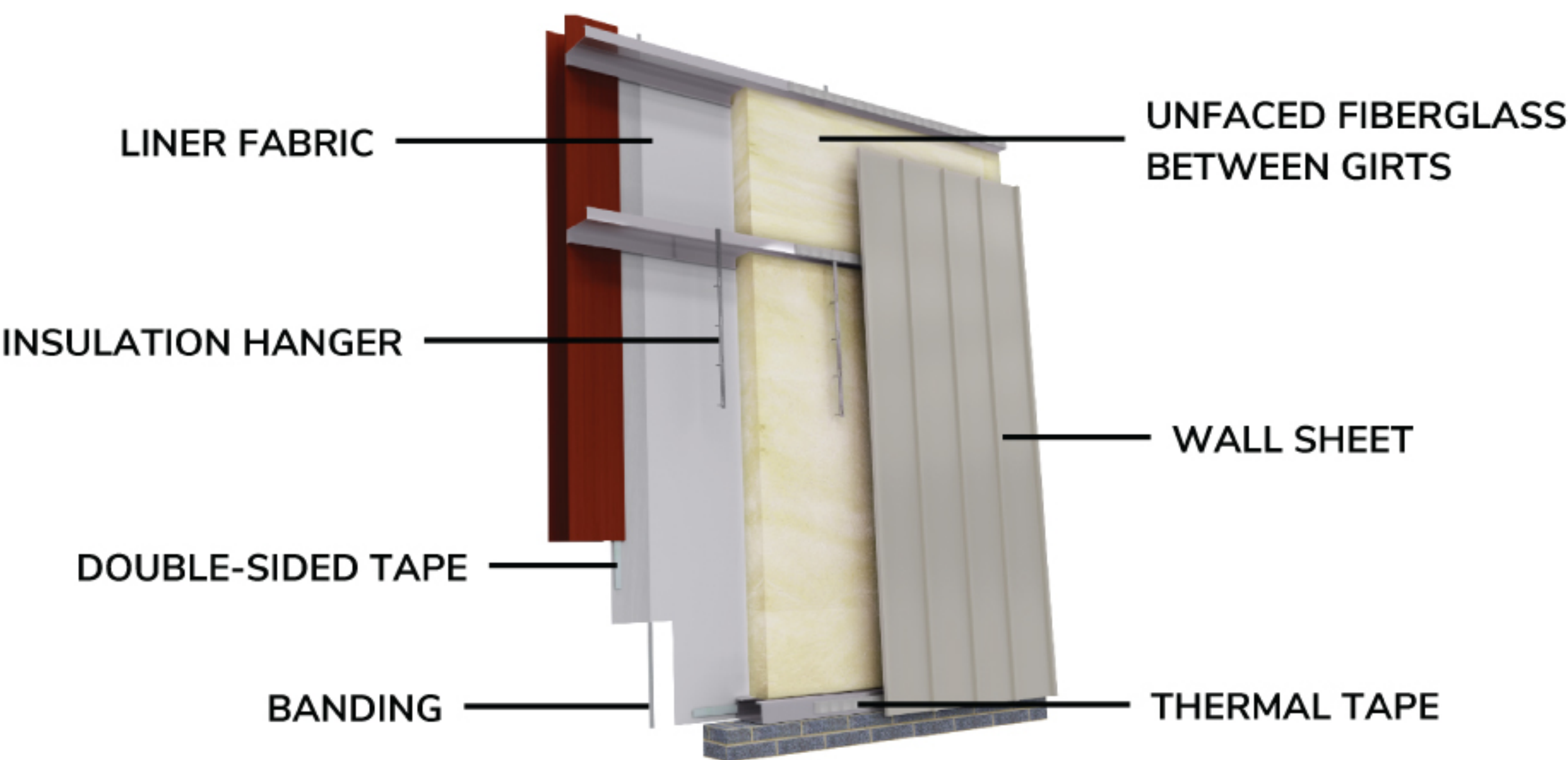

Learn more at therm-all.com.

Find more information about ProLiner™, including specification guidelines, install instructions and more on our brand new website.

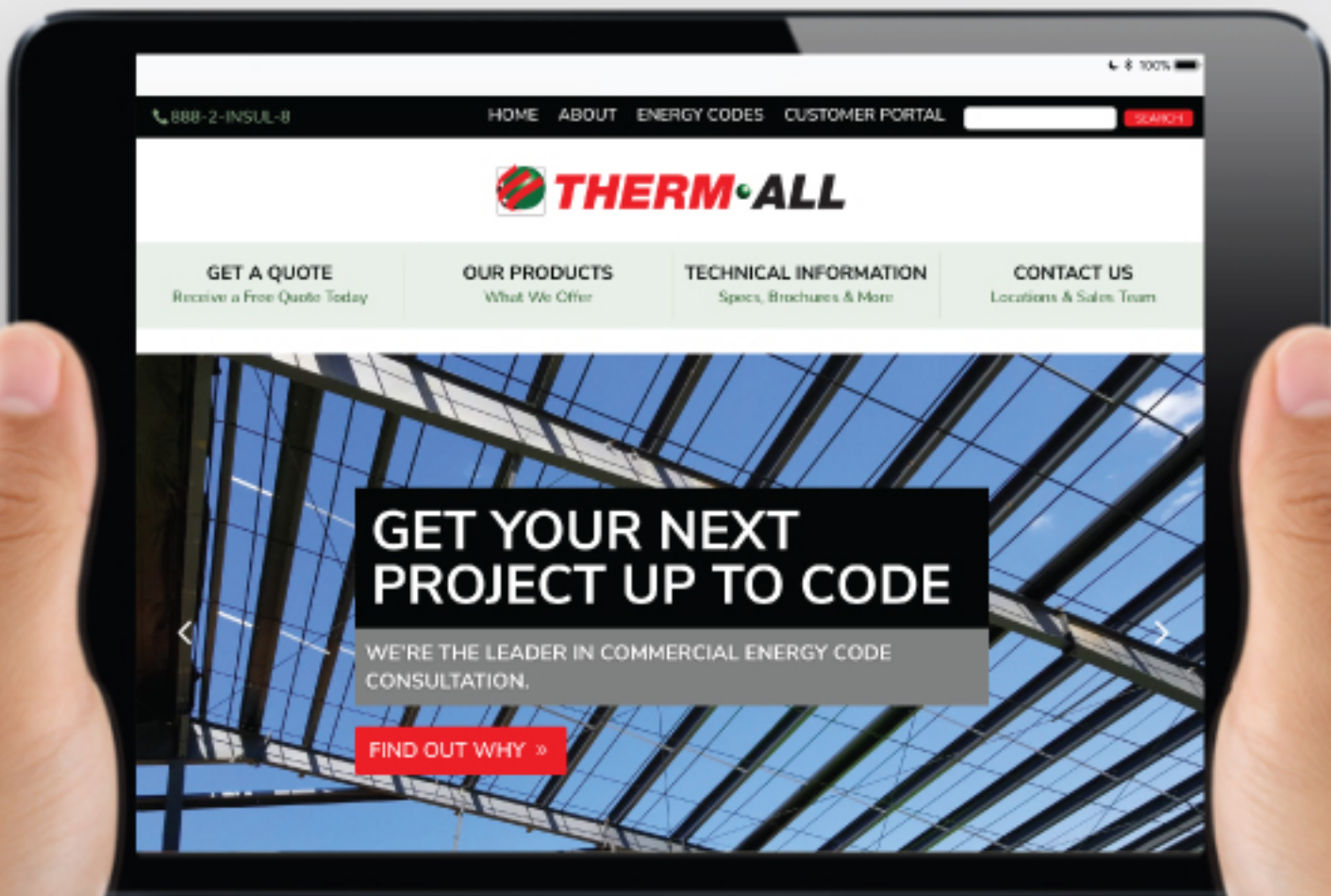

For more information about ProLiner™, contact your local Therm-All representative, visit therm-all.com or call 888-2-INSUL-8.