

FOR LEASE | CENTENNIAL INDUSTRIAL PARK

501 Westland Drive, Edmond, OK 73013

WIGGIN
PROPERTIES, LLC

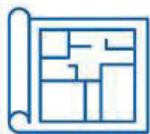

6,000
Square feet

Available SF



\$10.00
+ Modified Gross

Lease Rate



Warehouse
Built-to-suit

Property Type



HIGHLIGHTS

- ✓ Remodeled offices and breakroom
- ✓ Multiple overhead doors
- ✓ Fenced-in yard
- ✓ Excellent Edmond location

AREA DEMOGRAPHICS

	2025	1 Mile	3 Miles	5 Miles
Total Households		3,398	30,553	68,508
Total Population		7,972	75,112	169,183
Average HH Income		\$126,659	\$113,870	\$101,107

Michael Raff

VP of Brokerage

405.418.7118

mraff@wigginprop.com

FOR LEASE | CENTENNIAL INDUSTRIAL PARK

501 Westland Drive, Edmond, OK 73013

WIGGIN
PROPERTIES, LLC

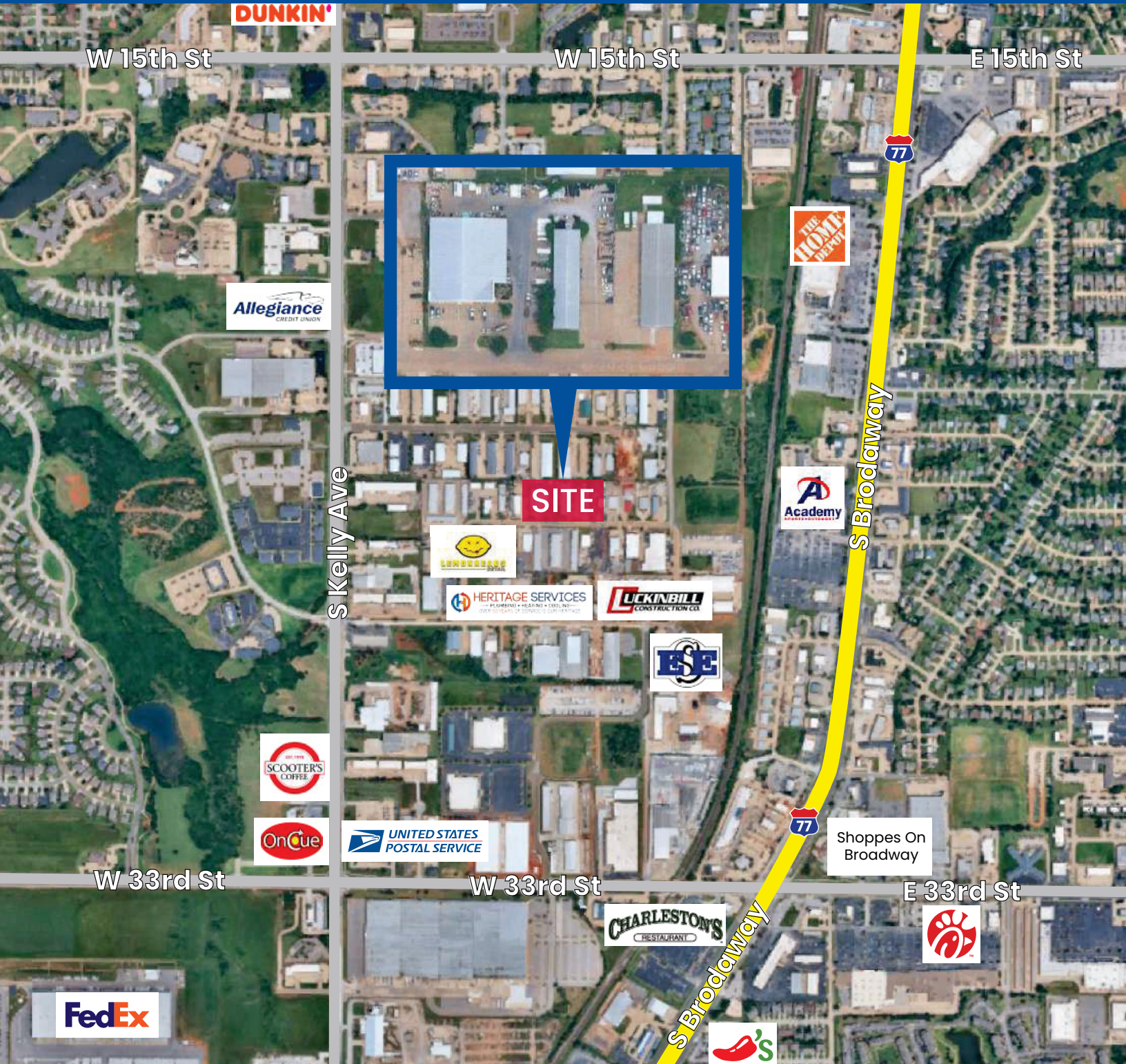

Michael Raff

VP of Brokerage

405.418.7118

mraff@wigginprop.com