

901 GATEWAY BOULEVARD

SOUTH SAN FRANCISCO

REDUCED RATE \$4.50 NNN

**MARKET READY LAB COMPLETE
MOVE IN READY**

LIFE SCIENCE SUBLEASE OPPORTUNITY

±78,070 RSF OFFICE & LAB, DIVISIBLE TO ±23,000 RSF
VIVARIUM AVAILABLE FOR SINGLE OR FULL FLOOR USER

CBRE

AVAILABILITY HIGHLIGHTS



SIZE

±78,070 RSF office & lab,
divisible to ±23,000 RSF



HOUSE SYSTEMS

DI Water, CO₂, N₂,
CDA, & Vacuum



AMENITIES

Standalone Amenity Center
Common Conferencing, Café, &
Catering Facility



AVAILABILITY

Upon Receipt of Consent



FLOORPLATE

60-40 Office-to-Lab



BUILDING INFRASTRUCTURE



**SHARED AUTOCLAVE
& GLASSWASH**



**4,070 SF VIVARIUM
AVAILABLE FOR SINGLE USER/
FULL FLOOR USER**

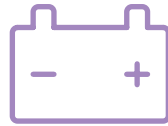

E-POWER

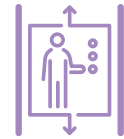

FREIGHT ELEVATOR



**WASTE DISPOSAL
ROOM**



**SHARED SHIPPING
& RECEIVING**

LOCAL AMENITIES



ACCESSIBILITY

Transit	Distance
SOUTH SAN FRANCISCO (CALTRAIN)	5 Minute Walk
MILLBRAE TRANSIT CENTER	6 Miles
SAN FRANCISCO (CALTRAIN)	18 Minutes
SAN JOSE (FROM SSF VIA CALTRAIN)	78 Minutes
SSF TO ALAMEDA (VIA FERRY)	40 Minutes
MILLBRAE STATION TO SF (VIA BART)	25 Minutes

SHUTTLE SERVICE AVAILABLE

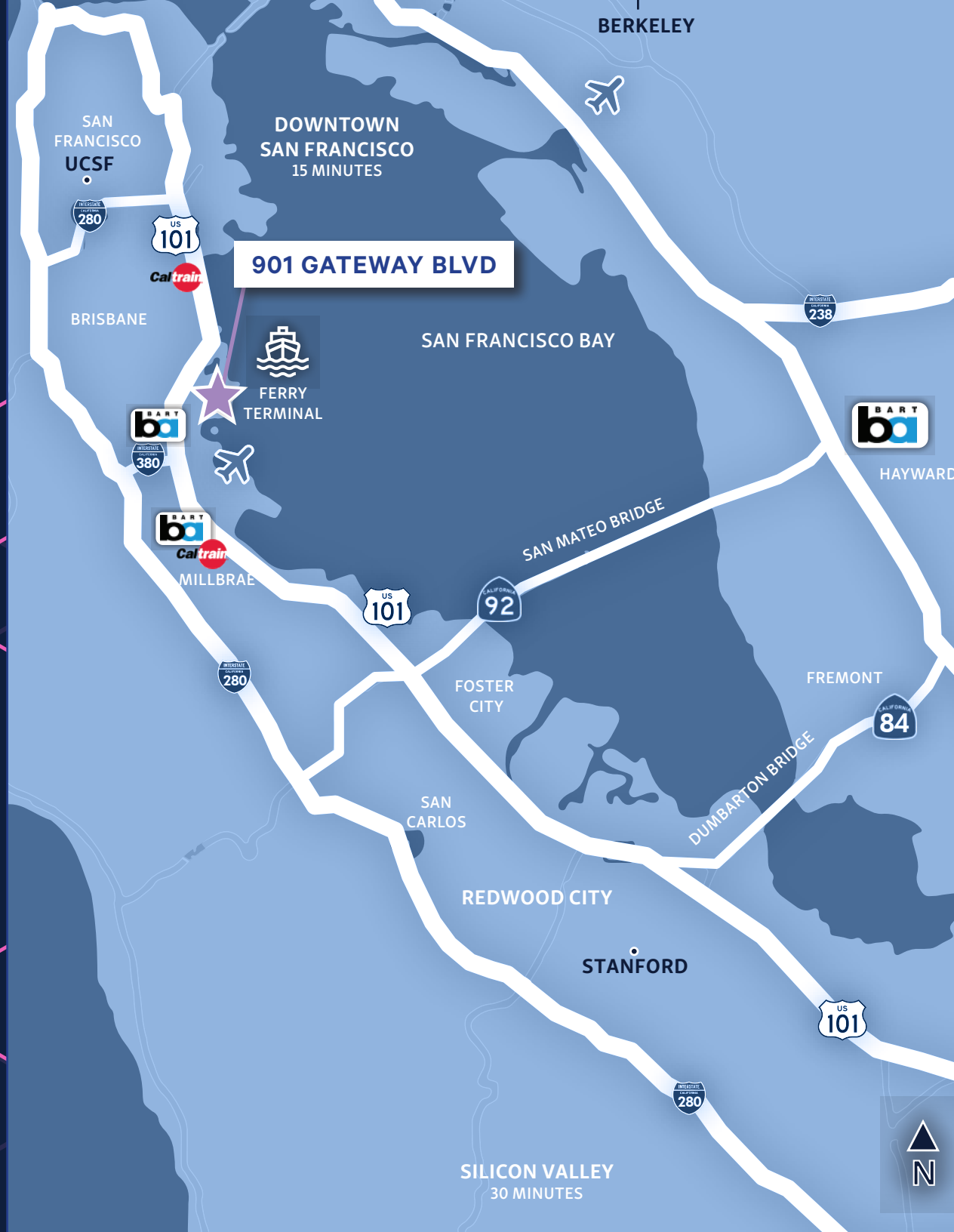

2ND FLOOR | FLOOR PLAN

37,000 SF

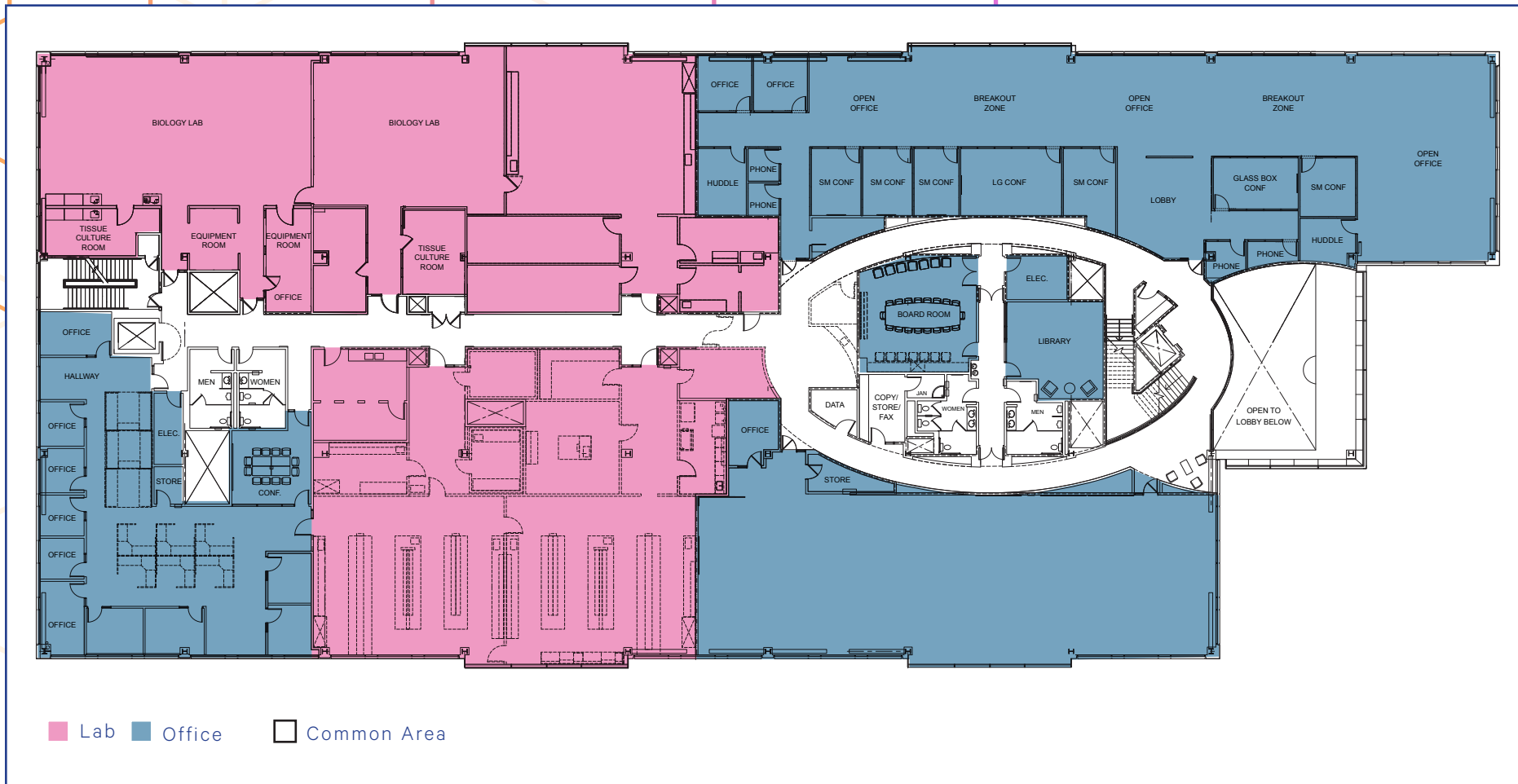

LIFE SCIENCE

SUBLEASE OPPORTUNITY

3RD FLOOR | FLOOR PLAN

37,000 SF

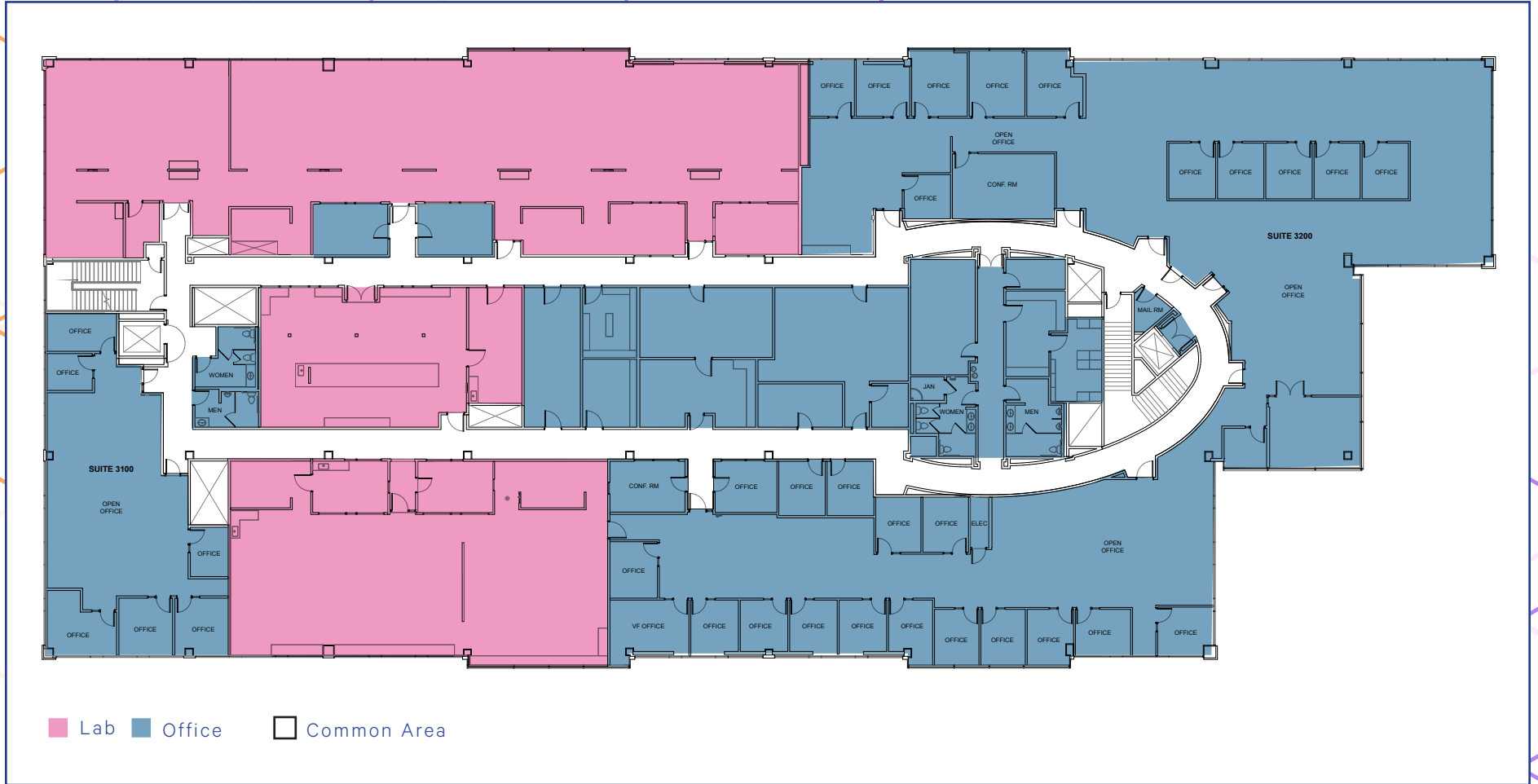



CBRE

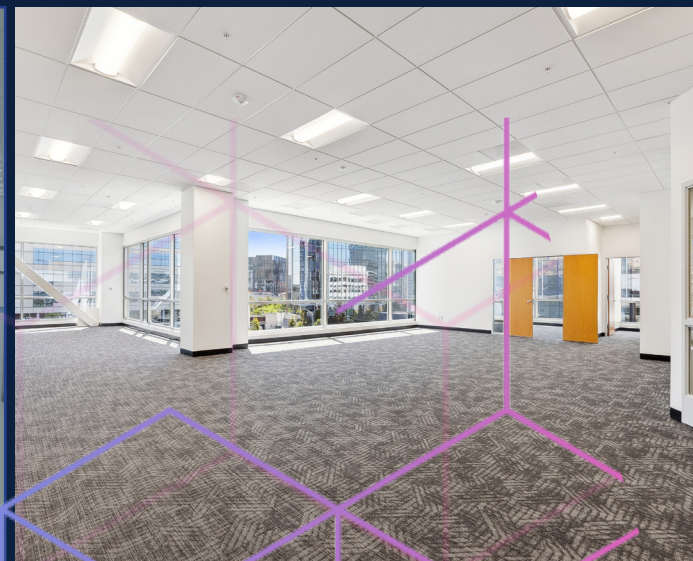

JENNY HAEG

Vice Chairman
+1 415 772 0435
jenny.haeg@cbre.com
Lic. 01390302

SIMON CLARK

Executive Vice President
+1 650 577 2938
simon.clark@cbre.com
Lic. 01318652

EVAN CHANG

Vice President
+1 650 577 2962
evan.chang@cbre.com
Lic. 02010044